

LEGEND

LIGHTING FIXTURES

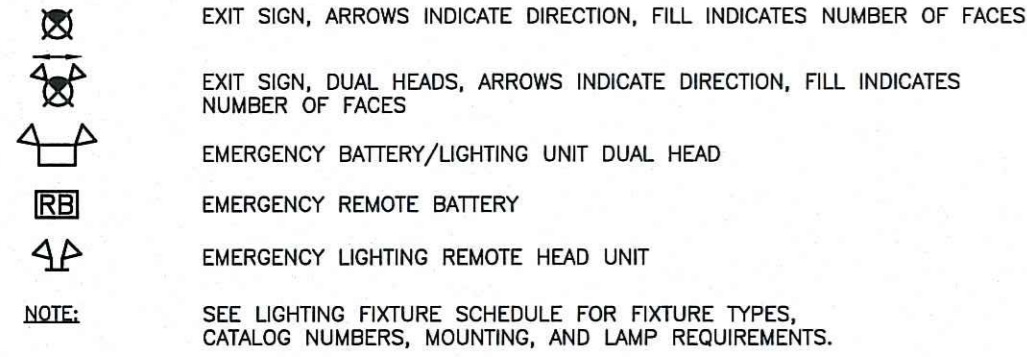

SWITCHING

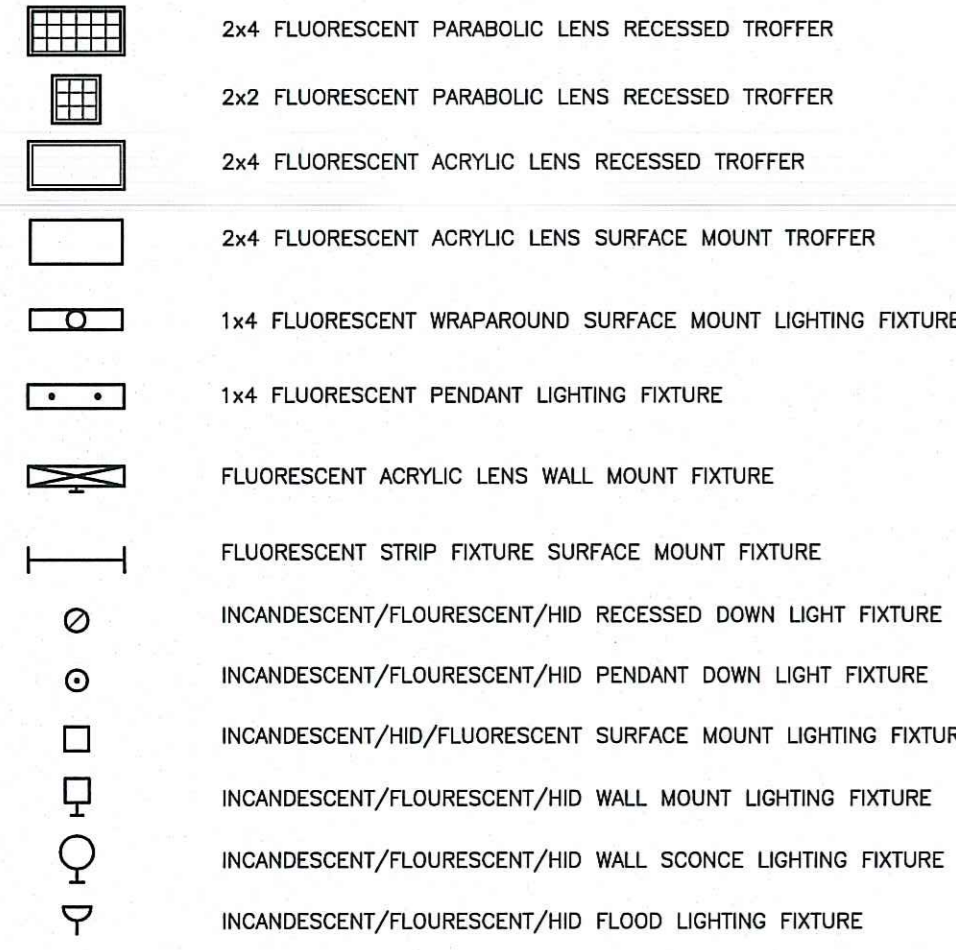
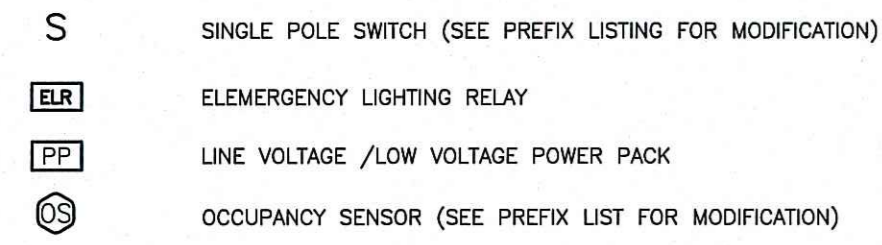

NOTE: 1. FOR GENERAL USE, OFFICES, OTHER, MEETING ROOMS, COMMON AREAS USE SPECIFICATION GRADE DEVICES WITH PLASTIC FINISH PLATE, EQUAL TO LEVITON CS SERIES 20A 120/277V FLUSH MOUNTED (DEVICE COLOR: IVORY)
 2. FOR MECHANICAL, NON FINISH SPACES USE SPECIFICATION GRADE DEVICES WITH GALVANIZED STEEL PLATE, EQUAL TO LEVITON CS SERIES 20A 120/277V SURFACE MOUNTED (DEVICE COLOR: IVORY)

SWITCHING PREFIX LISTING

2	DOUBLE POLE	LV	LOW VOLTAGE
3	THREE WAY	M	MOTOR RATED TOGGLE
4	FOUR WAY	OS	OCCUPANCY SENSOR
D	DIMMER	OB	OIL BURNER SHUT OFF
DT	DUAL TECHNOLOGY	P	PILOT LIGHT
F	FAN	PC	PHOTO CELL
FD	FLUORESCENT DIMMER	SV	SERVICE DISCONNECT
K	KEYED	T	THERMOSTAT
L	LIMIT	US	ULTRASONIC

LIGHTING SWITCH DESIGNATION KEY

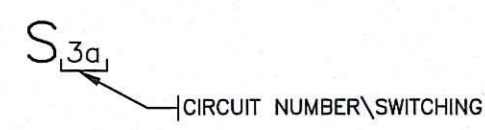

ABBREVIATIONS

AFF	ABOVE FINISHED FLOOR	GF	FLEXIBLE METALLIC CONDUIT	PWR	POWER
AFG	ABOVE FINISHED GRADE	GRS	GALVANIZED RIGID STEEL CONDUIT	RSC	RIGID STEEL CONDUIT
BLDG	BUILDING	HVAC	HEATING/VENTILATING AIR CONDITIONING	S.P.C.	SPRINKLER CONTRACTOR
C/L	CENTER LINE	IMC	INTERMEDIATE METAL CONDUIT	ST	PVC COATED FLEXIBLE CONDUIT
CKT	CIRCUIT	LF	LINEAR FEET	TBB	TELEPHONE BACKBOARD
CM	CILING MOUNTED	LTG	LIGHTING	TMH	TELEPHONE MANHOLE
CM	EXHAUST FAN	MC	METAL CLAD CABLE	TP	TWISTED PAIR
ELEC	ELECTRICAL	M.C.	MECHANICAL CONTRACTOR	TSP	TWISTED SHIELDED PAIR
E.C.	ELECTRICAL CONTRACTOR	MECH	MECHANICAL	UG	UNDER GROUND
EMT	ELECTRICAL METALLIC TUBING	NL	NIGHT LIGHT	UGFA	UNDER GROUND FIRE ALARM
ENT	ELECTRICAL NONMETALLIC TUBING	NEC	NATIONAL ELECTRIC CODE	UGPE	UNDER GROUND PRIMARY ELECTRIC
EW	ELECTRIC WATER COOLER	NFPA	NATIONAL FIRE PREVENTION AGENCY	UGSE	UNDER GROUND SECONDARY ELECTRIC
EQUIP	EQUIPMENT	N.T.S.	NOT TO SCALE	UGT	UNDER GROUND TELECOMMUNICATIONS
FBO	FURNISHED BY OTHERS	OEM	ORIGINAL EQUIPMENT MANUFACTURE	UN	UNLESS OTHERWISE NOTED
G	GROUNDING CONDUCTOR	P.C.	PLUMBING CONTRACTOR	UN	UNDER SLAB
G.C.	GENERAL CONTRACTOR	PVC	POLY VINYL CHLORIDE	WP	WEATHER PROOF

POWER/GROUNDING RECEPTACLES AND OUTLETS

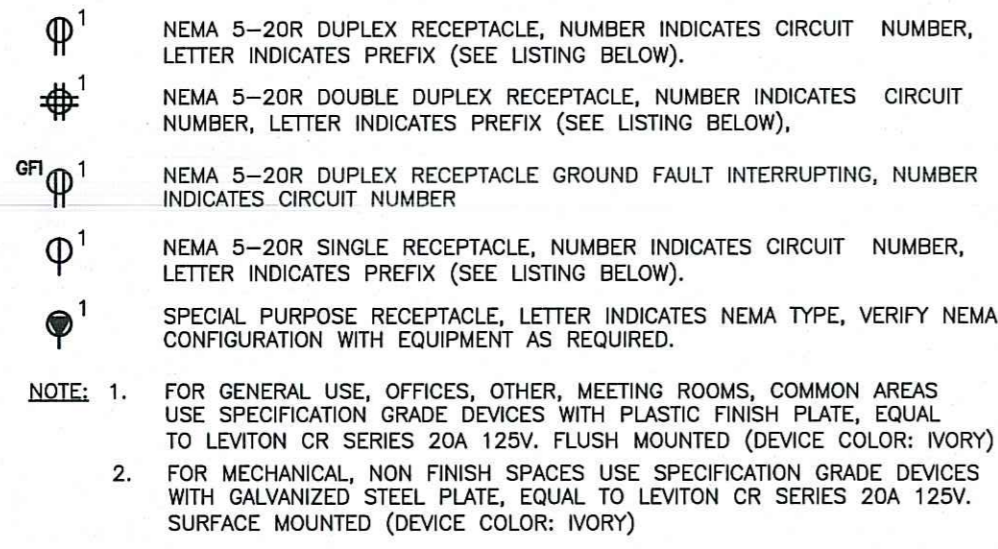

RECEPTACLE PREFIX LISTING

C	COUNTER TOP MOUNTED	HG	HOSPITAL GRADE
CD	CORD DROP	HV	HOOD VENT
CL	CLOCK	IG	ISOLATED GROUND
CM	CILING MOUNTED	MW	MICROWAVE
D	DEDICATED	OV	OVEN
DW	DISHWASHER	P	PEDESTAL
DR	DRYER	PT	POKE THRU
EWC	ELECTRIC WATER COOLER	PT	RANGE
EXP	EXPLOSION PROOF	SS	SURGE SUPPRESSOR
GD	GARAGE DISPOSAL	TV	TELEVISION
GF	GROUND FAULT INTERRUPTER	WP	WEATHERPROOF

MISCELLANEOUS POWER AND EQUIPMENT

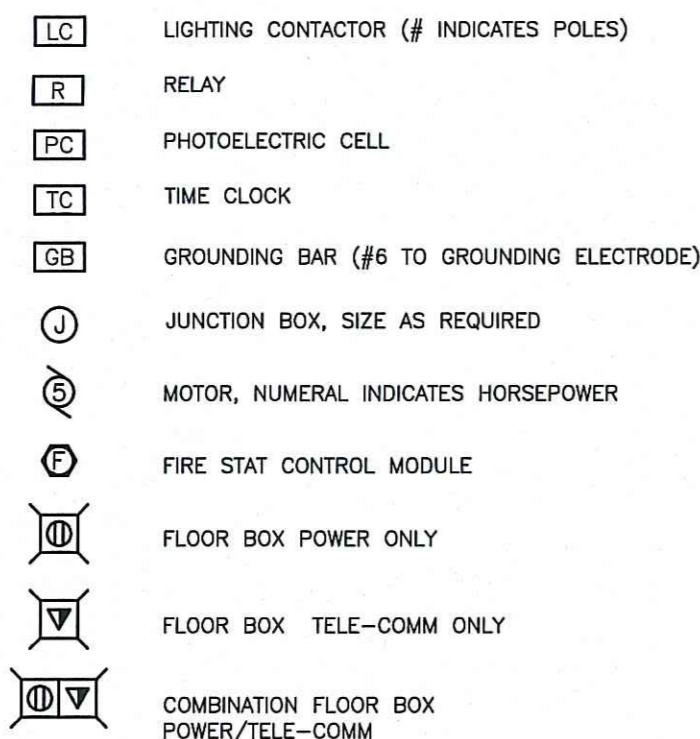

TELECOMMUNICATION DEVICES

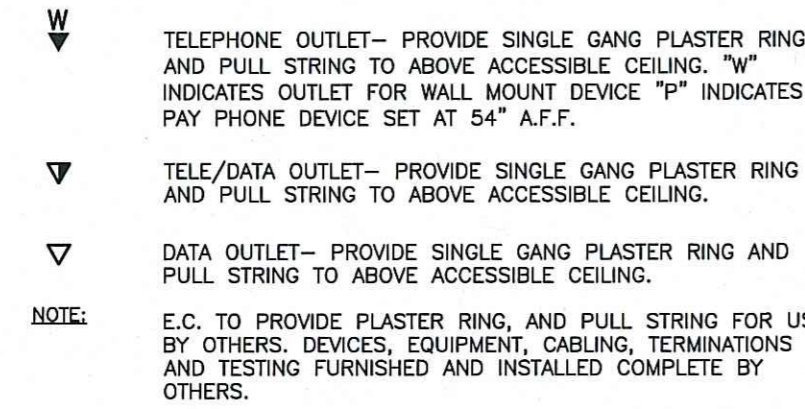

FIRE ALARM DEVICES



MECHANICAL EQUIPMENT

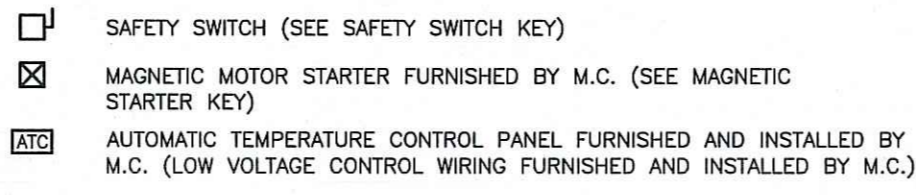

SAFETY SWITCH DESIGNATION KEY

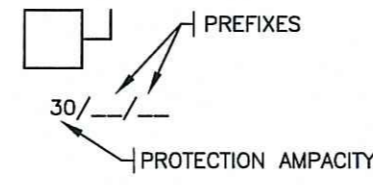

- NOTES:
- VOLTAGE, CURRENT, AND QUANTITY OF TERMINATION POLES SHALL MEET OR EXCEED THE SOURCE CAPACITY AND WIRING REQUIREMENTS OF THE BRANCH CIRCUIT.
 - ALL MOTOR STARTERS FOR MECHANICAL EQUIPMENT ARE FURNISHED AND INSTALLED BY M.C., WIRED BY E.C. COORDINATE WITH HVAC DRAWINGS.
 - ALL DISTRIBUTION EQUIPMENT SHALL HAVE ADHESIVE BACKED IDENTIFICATION LABELS.
 - COORDINATE FUSE SIZE AND TYPE PER EQUIPMENT NAME PLATE.

SAFETY SWITCH PREFIX LISTING

WP	WEATHER PROOF	I	THERMAL OVERLOAD
CB	CIRCUIT BREAKER	F	FUSED
MP	HACR BREAKER	NF	NON-FUSED

MAGNETIC STARTER DESIGNATION KEY

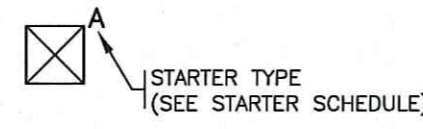

EQUIPMENT DESIGNATION KEY

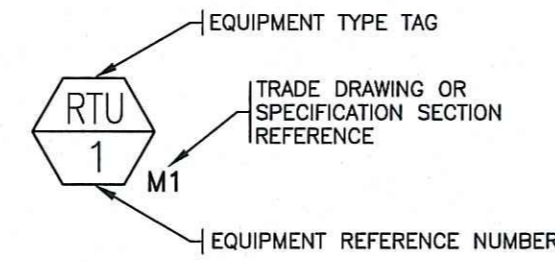

PANEL BOARD SYMBOL KEY

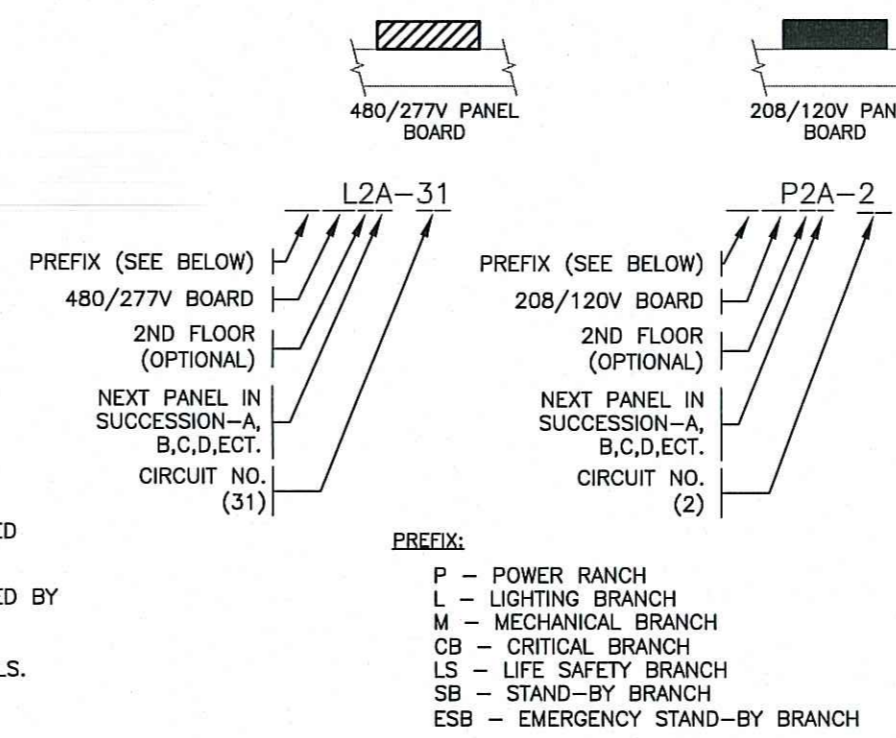

HOME RUN SYMBOL KEY

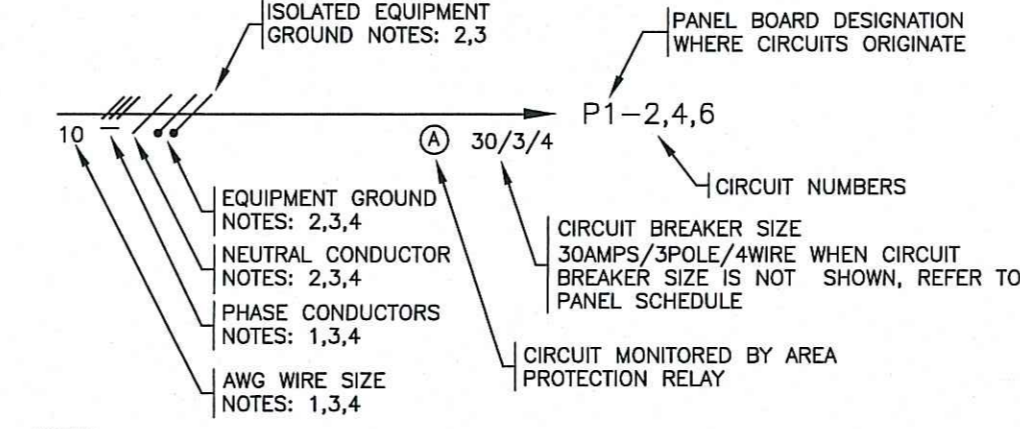

- NOTES:
- WIRE SIZE IS BASED ON THE NATIONAL ELECTRICAL CODE, NFPA 70-2011, TABLE 310-16, COLUMN 75° C (167° F) FOR COPPER CONDUCTORS.
 - WIRE SIZE IS BASED ON THE NATIONAL ELECTRICAL CODE, NFPA 70-2008, TABLE 250-122 (A) THROUGH (F), FOR COPPER CONDUCTORS.
 - WHEN NO SLASHES OR WIRE SIZES ARE SHOWN, WIRES SHALL CONSIST OF ONE PHASE, ONE NEUTRAL, AND ONE EQUIPMENT GROUND, WIRE SIZE AWG 12 MINIMUM, REFER TO PANEL SCHEDULES FOR CIRCUIT AMPACITY.
 - SLASHES MAY BE REPLACED BY NUMERICAL IDENTIFICATION (EXAMPLE: 2#11#80-3/4")
 - METALLIC CONDUIT MAY BE USED AS EQUIPMENT GROUND IN ACCORDANCE WITH NEC ARTICLE 250-118.

LIGHTING FIXTURE SCHEDULE

TYPE	MANUFACTURER	CATALOG NO.	LAMPS	VOLTS	WATTS	MOUNTING	DESCRIPTION
A	METALUX	WN-232A-UNV-EB81	(2) F32T8	120	65	SURFACE/CEILING	4' FLUORESCENT ACRYLIC WRAPAROUND
B	METALUX	SSF-232-UNV-HB81N-WG/SSF4FT	(2) F28T8	120	65	SUSPENDED/CEILING	4' FLUORESCENT STRIP W/WIRE GUARD
C	METALUX	HB-654HTB-L5	(6) F54T5HO	120	351	SUSPENDED/CEILING	HIGH OUTPUT FLUORESCENT HI-BAY
D	BRILUCK	3600/5MC (3 HEAD SET)	(3) 20W MR16	120/12	60	SURFACE/CEILING	2' LV TRACK KIT W/3 SPOT TRACK HEADS
E	BRILUCK	340096MC (5 HEAD SET)	(5) 50W MR16	120/12	250	SURFACE/CEILING	8' LV TRACK KIT W/5 SPOT TRACK HEADS
F	TERON	VEN5-F226Q-120E-PSL-AL-35K	(2) F226Q	120	45	SURFACE/WALL	COMPACT FLUORESCENT DECORATIVE WALL SCIENCE
G	TERON	VEN5-F226Q-120E-PSL-AL-DIM-35K	(2) F226Q	120	45	SURFACE/WALL	COMPACT FLUORESCENT DECORATIVE WALL SCIENCE (DIMMABLE)
H	TERON	AR24-217E-120E-SM	(2) F17T8	120	36	SURFACE/WALL	2' FLUORESCENT DECORATIVE WALL BRACKET
W1	MCGRAW EDISON	IST-B02-LED-E1-BL3-BZ	(2) 21W LED	120	42	SURFACE/WALL	EXTERIOR LED WALL PACK TYPE III DISTRIBUTION
W2	MCGRAW EDISON	IST-B02-LED-E1-BL4-BZ	(2) 21W LED	120	42	SURFACE/WALL	EXTERIOR LED WALL PACK TYPE IV DISTRIBUTION
EX	SURE-LITES	LPXH-7-DH	(2) 5.4W INC.	120	7.8	UNIVERSAL	SELF CONTAINED EXIT SIGN W/DUAL HEADS & REMOTE CAPACITY
ER	SURE-LITES	6X54DWHH	(2) 5.4W INC.	6	10.8	SURFACE/WALL	EMERGENCY WEATHER PROOF REMOTE HEAD
EBU1	SURE-LITES	CC2	(2) 5.4W INC.	120	14.4	SURFACE/WALL	EMERGENCY BATTERY UNIT

LIGHTING FIXTURE NOTES

- MANUFACTURERS AND CATALOG NUMBERS INDICATE QUALITY AND INTENT OF LIGHTING FIXTURES TO BE FURNISHED AND ARE NOT INTENDED TO LIMIT ALTERNATE MANUFACTURERS.
- BALLAST FOR FLUORESCENT FIXTURES SPECIFIED WILL BE HIGH POWER FACTOR TYPE ELECTRONIC WITH T-8 LAMPS AND BEAR CBM-ETL LABEL.
- REVIEW ARCHITECTURAL DRAWING TO COORDINATE FIXTURE MOUNTING AND FINISH CEILING MATERIAL PRIOR TO ORDERING FIXTURES.
- LIGHTING SUPPLIER SHALL COORDINATE COMPACT FLUORESCENT LAMP BASE TYPE WITH FIXTURE LAMP SOCKET AND BALLAST TYPE PER MANUFACTURER'S REQUIREMENTS
- LIGHTING SUPPLIER SHALL COORDINATE HID LAMP BASE TYPE AND BURNING POSITION WITH FIXTURE LAMP SOCKET TYPE AND POSITION PER MANUFACTURER'S REQUIREMENTS

GENERAL NOTES

- CONDUITS AND CIRCUITRY INDICATED ON THE DRAWINGS ARE DIAGRAMMATIC ONLY AND DO NOT INDICATE SPECIFIC ROUTES, SPECIFIC CONDITIONS OR HOMERUNS. FINAL ROUTING SHALL BE COORDINATED IN THE FIELD TO AVOID CONFLICTS WITH OTHER TRADES. PULLING FITTINGS AND BOXES IN ADDITION TO THOSE DETAILED SHALL BE ADDED TO MAINTAIN NO MORE THAN 360° BETWEEN PULLING POSITIONS. CLEAR ACCESS TO PULLING POSITIONS SHALL BE MAINTAINED.
- EXPOSED EQUIPMENT AND RACEWAYS SHALL BE INSTALLED LEVEL AND PLUMB.
- EXPOSED RACEWAYS SHALL RUN PARALLEL OR PERPENDICULAR TO BUILDING WALLS AND OR STRUCTURAL MEMBERS.
- EXACT LOCATION OF DOORS, TRANSOMS, WINDOWS, CASEWORK, PLUMBING FIXTURES ECT. IN FINISHED AREAS SHALL BE COORDINATED IN THE FIELD WITH OTHER TRADES.
- EXACT LOCATION OF EQUIPMENT WITHIN MECHANICAL SPACES, CEILINGS AND FLOOR VOIDS ABOUT MECHANICAL EQUIPMENT SHALL BE COORDINATED IN THE FIELD WITH OTHER TRADES.
- ALL ELECTRICAL WORK TO BE IN ACCORDANCE WITH LICENSED ELECTRICIANS IN ACCORDANCE WITH NFPA 70 2011 NATIONAL ELECTRICAL CODE (NEC), NFPA 101 2009 LIFE SAFETY CODE AND ALL APPLICABLE STATE AND LOCAL CODES AND REGULATIONS.
- LIGHTING AND POWER SYSTEM TO BE INSTALLED IN ACCORDANCE WITH THE REQUIREMENTS OF THE STATES ENERGY EFFICIENCY CODE AND LOCAL REGULATIONS.
- ALL EQUIPMENT AND WIRING SHALL BE SUSPENDED FROM AND/OR TO THE BUILDING STRUCTURE.
- SEE MOUNTING HEIGHT DETAIL FOR WALL MOUNTED EQUIPMENT AND DEVICE MOUNTING HEIGHTS.
- SEE LIGHTING FIXTURE SCHEDULE AND DESIGNATION DETAIL FOR FIXTURE TYPE, BRANCH CIRCUIT, SWITCH CONTROL AND PHASING.
- PROVIDE ADHESIVE BACKED IDENTIFICATION LABELS ON ALL ELECTRICAL DISTRIBUTION EQUIPMENT INCLUDING PANEL BOARDS AND DISCONNECTS

LOCATION	RACEWAY	FITTINGS	SUPPORTS (NOTE 2)	REMARKS
UNDERGROUND	PVC-SHC 40	GLUED	N/A	(2)(3)(4)
EXPOSED EXTERIOR	PVC-SCH 40	GLUED	SEE TABLE 347-8	(1)
EXPOSED INTERIOR	EMT MC CABLE	SET SCREW CLAMP	3'/10' 1'/8'	
CONCEALED INTERIOR FEEDERS	EMT MC CABLE	SET SCREW CLAMP	3'/10' 1'/8'	
CONCEALED INTERIOR BRANCH	MC CABLE	CLAMP	1'/8'	

WIRING METHODS NOTES

- NOTES:
- WIRING METHODS AND MATERIALS TO BE PROVIDED IN ACCORDANCE WITH APPLICABLE SECTIONS OF NEC ARTICLE 300
 - FLEXIBLE METALLIC CONDUIT (LIQUID TIGHT WHERE SUBJECT TO MOISTURE) SHALL BE UTILIZED BETWEEN NON-FLEXIBLE AND VIBRATING COMPONENTS, IN ACCORDANCE WITH NFPA-70-2011 PER ARTICLES 348 & 350.
 - MAXIMUM DISTANCE FROM CONNECTOR OR COUPLING/MAXIMUM DISTANCE BETWEEN SUPPORTS PER NFPA 70.
 - EXPANSION FITTINGS AS SUGGESTED BY THE MANUFACTURER AND/OR AS REQUIRED BY PROJECT.
 - BENDS SHALL NOT EXCEED FOUR QUARTER BENDS (360° DEGREES TOTAL) BETWEEN PULL POINTS, CONDUIT BODIES OR BOXES CLEAR PULLING POSITIONS SHALL BE MAINTAINED.
 - CONDUIT PENETRATIONS AND ELECTRICAL INSTALLATIONS SHALL BE MADE AS REQUIRED TO LIMIT THE SPREAD OF FIRE AND PRODUCTS OF COMBUSTION IN ACCORDANCE WITH SECTION 300.21.
 - CONDUIT PENETRATIONS THROUGH FIRE RATED ASSEMBLIES SHALL BE SEALED WITH A U.L. LISTED FIRE STOPPING SYSTEM INSTALLED PER MANUFACTURER'S RECOMMENDATIONS.

REMARKS:

- USE PVC SCHD 80, IMC, OR, GRG AS REQUIRED OR WHERE SUBJECT TO DAMAGE.
- SEE TRENCH DETAIL FOR PLACEMENT, ELEVATION AND WARNINGS.
- COORDINATE UTILITY REQUIREMENTS WHERE APPLICABLE.
- UNDER GROUND CONDUITS TO BE 3/4" DIAMETER MINIMUM.

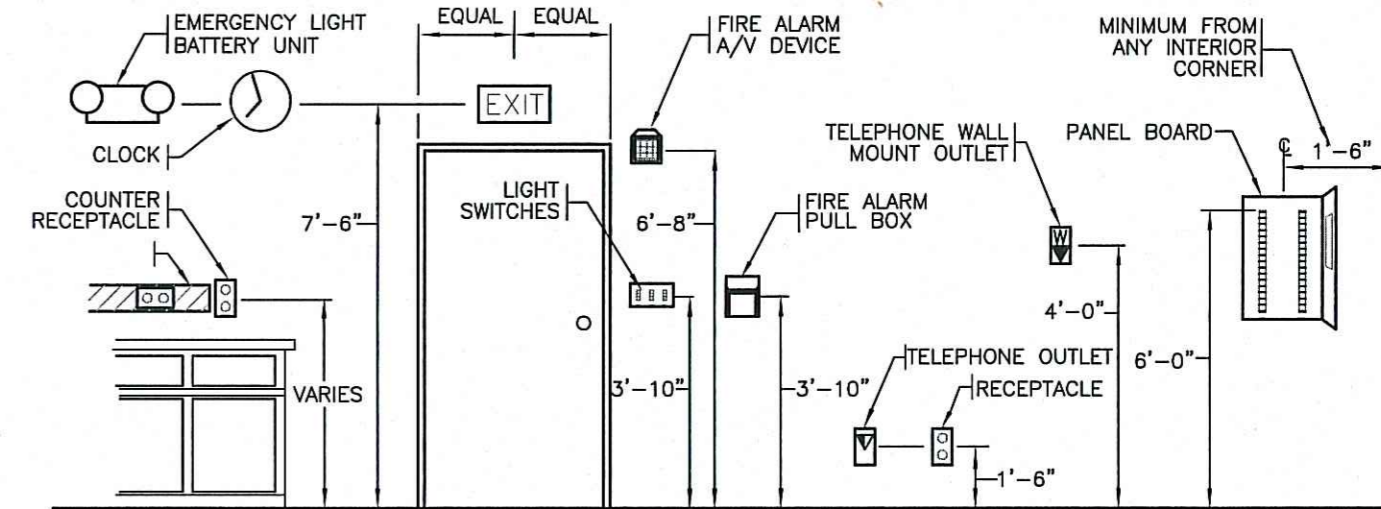

TYPICAL MOUNTING LOCATIONS

MOUNTING LOCATION NOTES:

- MOUNTING HEIGHTS ARE TO CENTER OF DEVICE AND TYPICAL UNLESS OTHERWISE NOTED.
- MOUNTING HEIGHTS FOR CONTROL DEVICES/OPERATING MECHANISMS SHALL CONFORM TO APPLICABLE REQUIREMENTS OF THE AMERICANS WITH DISABILITIES ACT ACCESSIBILITY GUIDE LINES SECTION 4.28
- MOUNTING HEIGHTS FOR ALARM SIGNALING APPLIANCES SHALL CONFORM TO APPLICABLE REQUIREMENTS OF THE AMERICANS WITH DISABILITIES ACT ACCESSIBILITY GUIDE LINES SECTION 4.27
- MOUNTING HEIGHTS FOR OUTLETS SERVING ACCESSIBLE TELEPHONES SHALL CONFORM TO APPLICABLE REQUIREMENTS OF THE AMERICANS WITH DISABILITIES ACT ACCESSIBILITY GUIDE LINES SECTION 4.31
- COORDINATE AND VERIFY COUNTER TOP AND BACK SPLASH HEIGHTS IN FIELD WITH MILL WORK CONTRACTOR.
- MOUNTING HEIGHTS SHOWN ARE BASED ON CEILING HEIGHTS GREATER THAN 8'-0" COORDINATE DEVICE LOCATION IN AREAS WITH LOWER CEILINGS.

NO.	ISSUE/REVISION	DATE	BY
1	ISSUED FOR PROGRESS	1/13/14	J.LESSARD
2	ISSUED FOR PROGRESS	2/5/14	J.LESSARD
3	ISSUED FOR CONSTRUCTION	6/5/14	B.HARLOW

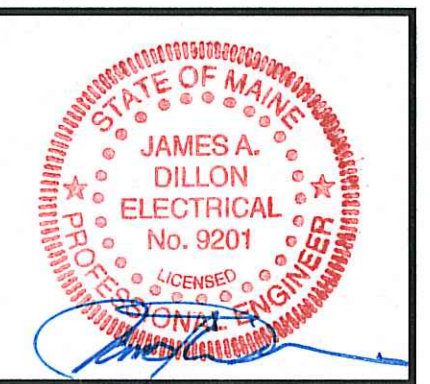

Interstate Electrical Services
 THE DIFFERENCE IS ATTITUDE
 15 COTTE LANE BEDFORD, N.H. 03110
 P: (603) 657-3320 F: (603) 657-3480
 www.interstate1.com

PROJECT:
EVO ROCK & FITNESS
 65 WARREN AVE
 PORTLAND, MAINE

DATE: 12-6-13
 DRAWN BY: B.HARLOW
 DESIGNED BY: M.WHITE
 CHECKED BY: M. WHITE
 SCALE: AS SHOWN
 PROJECT NUMBER: 631940

DRAWING TITLE:
LEGEND SCHEDULES NOTES AND KEYS

DRAWING NUMBER
E1
 SHEET 1 OF 4

