

HILARY HARRIS, AIA  
LEED AP

PO BOX 22  
CONCORD, NH 03302  
PH: (603) 499-1239

EMAIL:  
hlyharris@gmail.com

**EVO ROCK & FITNESS**  
PORTLAND, ME

ISSUE

DATE	BY	REMARKS
07JUL13	HBH	PLANNING BOARD REVIEW
08APR14	HBH	FOR CONSTRUCTION

DRAWING TITLE:

**1ST FLOOR PLAN**

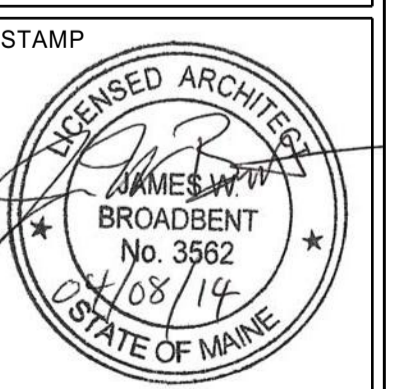

SCALE: 1/8"=1'-0"

DSN TEAM:

SHEET NUMBER:

**A-1.1**

LIFE SAFETY NOTES:  
1. DIAGONAL = 145'-1", THEREFORE 2ND  
MEANS OF EGRESS MUST BE 72'-7"  
EXIT SEPARATION: 112'

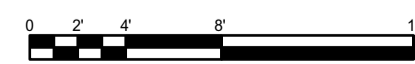
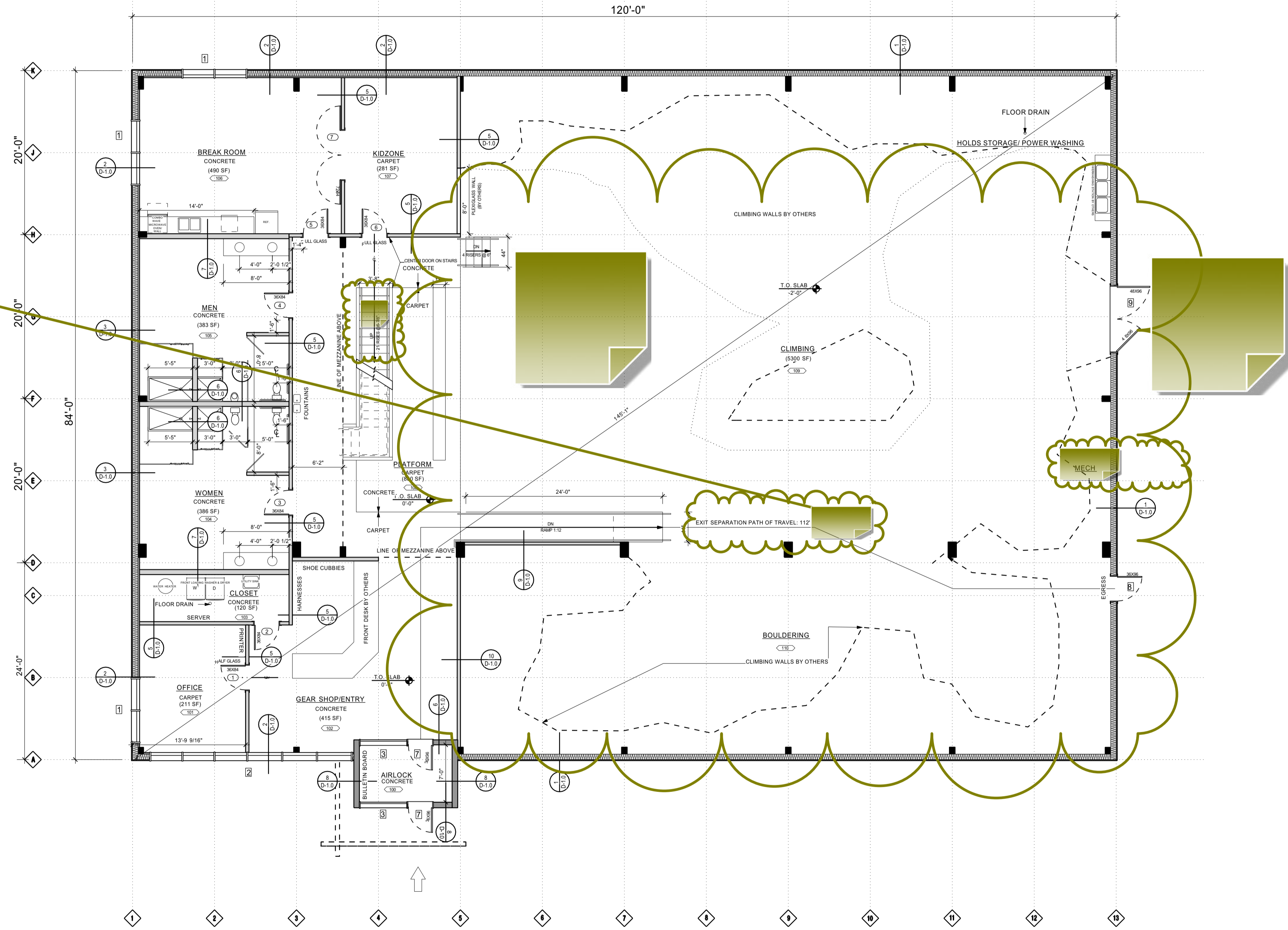

FOR CONSTRUCTION