

STANDARD FASTENER LIST OF KIRBY BUILDING SYSTEMS

12-14 X 1 1/2" HWH DP2 BLAZER ZINC HEAD FA01	12-14 X 2" HWH BLAZER FLANGE DP3 FA08	#14 X 1 1/4" TEK/3 W/O WASHER FC20	10 X 1" SDS #2 PHIL PANCAKE HEAD FD19
12-14 X 1 1/2" HWH DP2 BLAZER ZINC HEAD FA02	12-14 X 2" HWH BLAZER DP3, NO WASHER FA09	#12 - 14 X 1 1/2" S.D.S. SHOULDER TEK W/WASHER (REQUIRES ADDITION GIRT BRACING.) FC21	1/4"-14 X 1 1/8" SCOTS TEK/1 W/WASHER FD25
1/4-14 X 3/8" HWH VRT DP1 BLAZER ZINC HEAD FA03	1/4-14 X 3/8" HWH BLAZER FLANGE VRT DP1 FA10	1/4"-14 X 1 1/4" SHOULDER TEK2 SDS W/O WASHER FD05	1/4"-14 X 1 1/4" TEK/2 W/WASHER FD26
14 X 1" HHAB BLAZER ZINC HEAD FA04	1/4-14 X 3/8" HWH BLAZER VRT DP1, NO WASHER FA11	1/4"-20 X 1 1/4" SHOULDER TEK4 W/O WASHER FD07	10-16 X 5/8" HWH SD #2 FD28
17-14 X 1" HHAB BLAZER ZINC HEAD FA05	1/4-14 X 1 1/4" HWH DP3 BLAZER ZINC HEAD FA12	12-24 X 2" IMPAX-45 W/WASHER FD13	1/4"-14 X 1 1/2" TEK/2 W/WASHER FD29
12-14 X 1 1/4" HWH BLAZER FLANGE DP2 FA06	12-24 X 1 1/2" HWH BLAZER DP5 W/ BONDED WASHER FA13	10 X 2" SDS #2 PHIL PANCAKE HEAD FD18	#14 X 7/8" S.D.S. ZAC (REPLACED BY FA03 UNLESS USED W/ FZ09) FZ08
12-14 X 1 1/4" HWH BLAZER DP2, NO WASHER FA07			#12 X 2 1/2" S.D.S. ZAC (REQUIRES FZ08 STITCH) (REQUIRES PURLIN BRACING.) FZ09

STANDING SEAM ROOF SYSTEMS
INSULATION & FASTENER RECOMMENDATIONS

INSULATION/FASTENERS	KLS/KLM "LOW SYSTEM"	KLS/KLM "HIGH SYSTEM"	KLM W/ TALL CLIP	RL/RL+ "LOW SYSTEM"	RL/RL+ "HIGH SYSTEM"
NO INSULATION THERMAL BLOCK FASTENER	OK 3/8" SYB05A FD26CP	N/R	N/R	OK 3/8" SYB11 FA07CP	N/R
R10 THERMAL BLOCK FASTENER	OK NONE FD26CP	OK 1" SYB05C FD26CP	N/R	OK NONE FA07CP	OK 5/8" SYB12 FA07CP
R11 THERMAL BLOCK FASTENER	OK NONE FD26CP	OK 1" SYB05C FD26CP	N/R	OK NONE FA07CP	OK 5/8" SYB12 FA07CP
R13 THERMAL BLOCK FASTENER	OK NONE FD26CP	OK 1" SYB05C FD26CP	N/R	OK NONE FA07CP	OK 5/8" SYB12 FA07CP
R16 THERMAL BLOCK FASTENER	OK* NONE FD29CP	OK 3/4" SYB07 FD29CP	N/R	N/R	OK 3/8" SYB11 FC08CP
R19 THERMAL BLOCK FASTENER	OK* NONE FD29CP	OK 3/4" SYB07 FD29CP	N/R	N/R	OK 3/8" SYB11 FC08CP
R25 THERMAL BLOCK FASTENER	N/R	OK 3/4" SYB07 FD29CP	N/R	N/R	N/R
R30 THERMAL BLOCK FASTENER	N/R	N/R	OK 1" SYB05C FD29CP	N/R	N/R

REFERENCE NOTES
OK - Kirby approved application
OK* - Kirby application conditionally approved. Application requires extra effort during erection to hold panel coverage and may induce oil canning or pillowing.
N/R - Not Recommended due to aesthetic issues or difficulty of installation. (REQUIRES MANAGEMENT APPROVAL)

NOMINAL INSULATION THICKNESSES (OVER PURLINS ONLY)

R10 - 3.25" (range of 2.95" to 3.4")
R11 - 3.5" (range of 3.3" to 3.75")
R13 - 4.25" (range of 3.85" to 4.375")
R16 - 5" (range of 5.0" to 5.3")
R19 - 6.25" (range of 5.6" to 6.375")

THRU-FASTENED ROOF & WALL SYSTEMS
INSULATION & FASTENER RECOMMENDATIONS

INSULATION/FASTENERS	KIRBY RIB ROOF PANEL	KR, KW & KRP WALL PANEL
NO INSULATION FASTENER	OK FA01	OK FA07
R10, R11 FASTENER	OK FA01	OK FA07
R13, R16 FASTENER	OK FA02	OK FC08
R19 FASTENER	OK* FA02	OK* FC21
R19 THERMAL BLOCK FASTENER	OK* 1" SYB08 FZ09/FZ08**	N/R

REFERENCE NOTES
OK - Kirby approved application
OK* - Kirby application conditionally approved. Application requires extra effort during erection to hold panel coverage and may induce oil canning or pillowing.
N/R - Not Recommended due to aesthetic issues or difficulty of installation. (REQUIRES MANAGEMENT APPROVAL)
** - Requires an EPH10A at the eave strut.

50# CAPACITY WITHOUT 2"x2" ANGLE,
ROOF SLOPE 1:12 MAX
(WITHOUT BEVEL WASHER)

200# CAPACITY WITH 2"x2" ANGLE,
ROOF SLOPE 1:12 MAX
(WITHOUT BEVEL WASHER)

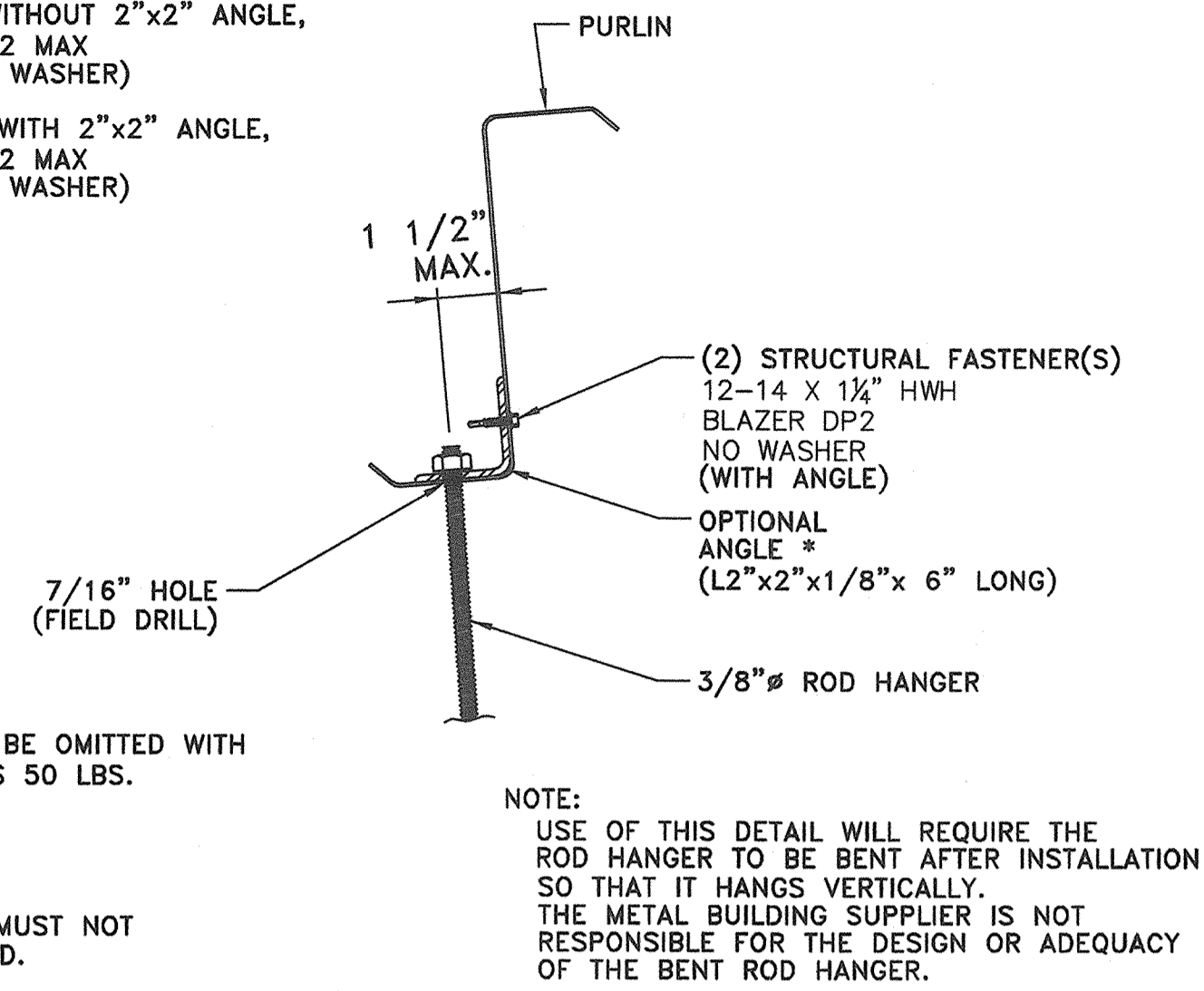

* ANGLE MAY BE OMITTED WITH HANGER LOADS 50 LBS. OR LESS.

NOTE:
PURLIN LIP MUST NOT BE DISTORTED.

HANGER DETAIL AT PURLINS

500# CAPACITY
ROOF SLOPE LESS THAN OR EQUAL TO 1:12

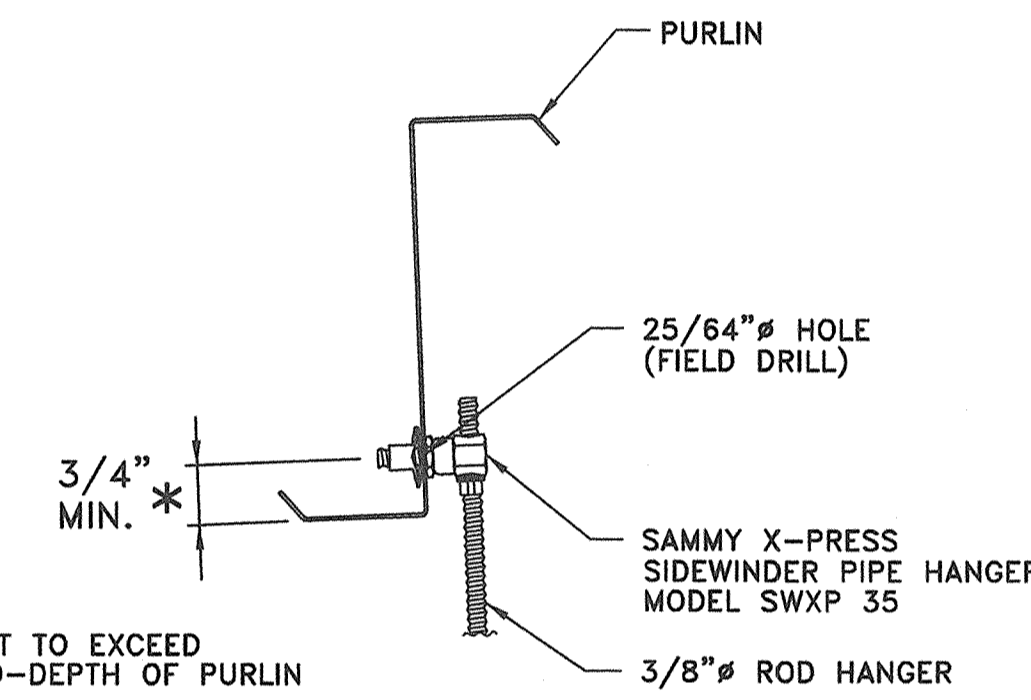

* NOT TO EXCEED MID-DEPTH OF PURLIN

NOTE:
USE OF THIS DETAIL WILL REQUIRE THE ROD HANGER TO BE BENT AFTER INSTALLATION SO THAT IT HANGS VERTICALLY. THE METAL BUILDING SUPPLIER IS NOT RESPONSIBLE FOR THE DESIGN OR ADEQUACY OF THE BENT ROD HANGER.

HANGER DETAIL AT PURLINS

ROOF SLOPES LESS THAN OR EQUAL TO 1:12

400# CAPACITY PROVIDED ROD HANGER IS WITHIN CENTER ONE-THIRD OF 3"x3" ANGLE SPAN (200# CAPACITY OTHERWISE)

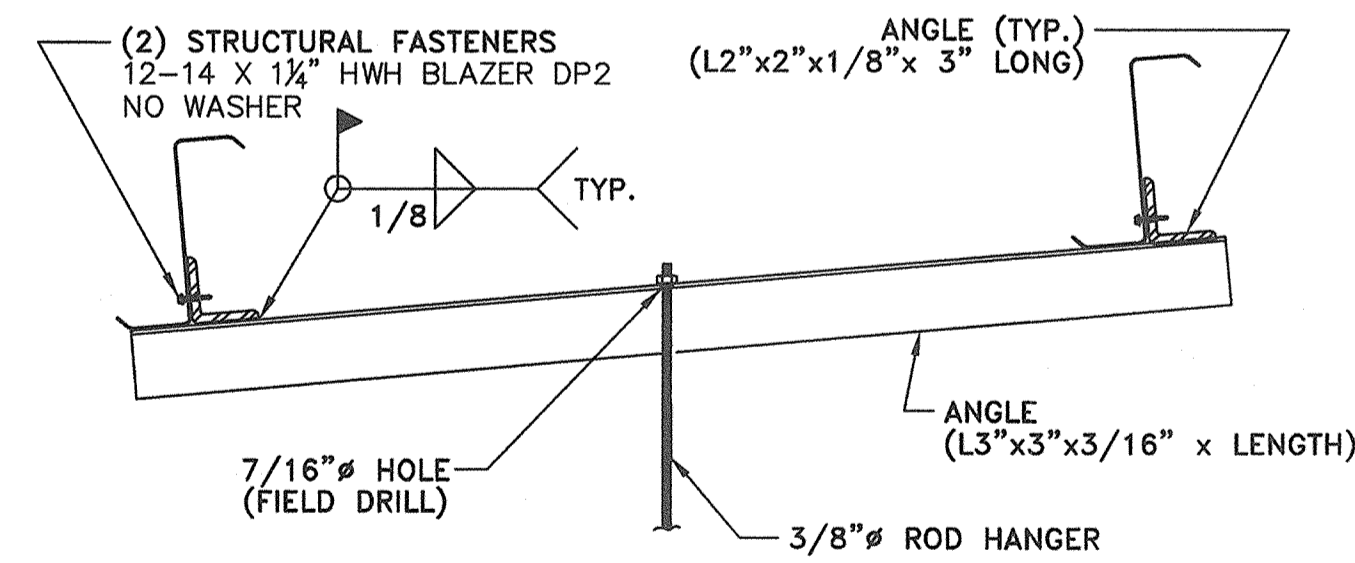

NOTE: FIELD WELDING REQUIRED.

NOTE:
USE OF THIS DETAIL WILL REQUIRE THE ROD HANGER TO BE BENT AFTER INSTALLATION SO THAT IT HANGS VERTICALLY. THE METAL BUILDING SUPPLIER IS NOT RESPONSIBLE FOR THE DESIGN OR ADEQUACY OF THE BENT ROD HANGER.

HANGER DETAIL BETWEEN PURLINS

250# CAPACITY WITHOUT 2"x2" ANGLE,
ROOF SLOPE LESS THAN OR EQUAL TO 4:12

500# CAPACITY WITH 2"x2" ANGLE,
ROOF SLOPE LESS THAN OR EQUAL TO 4:12

250# CAPACITY WITH 2"x2" ANGLE,
ROOF SLOPE GREATER THAN 4:12, BUT LESS THAN 8:12

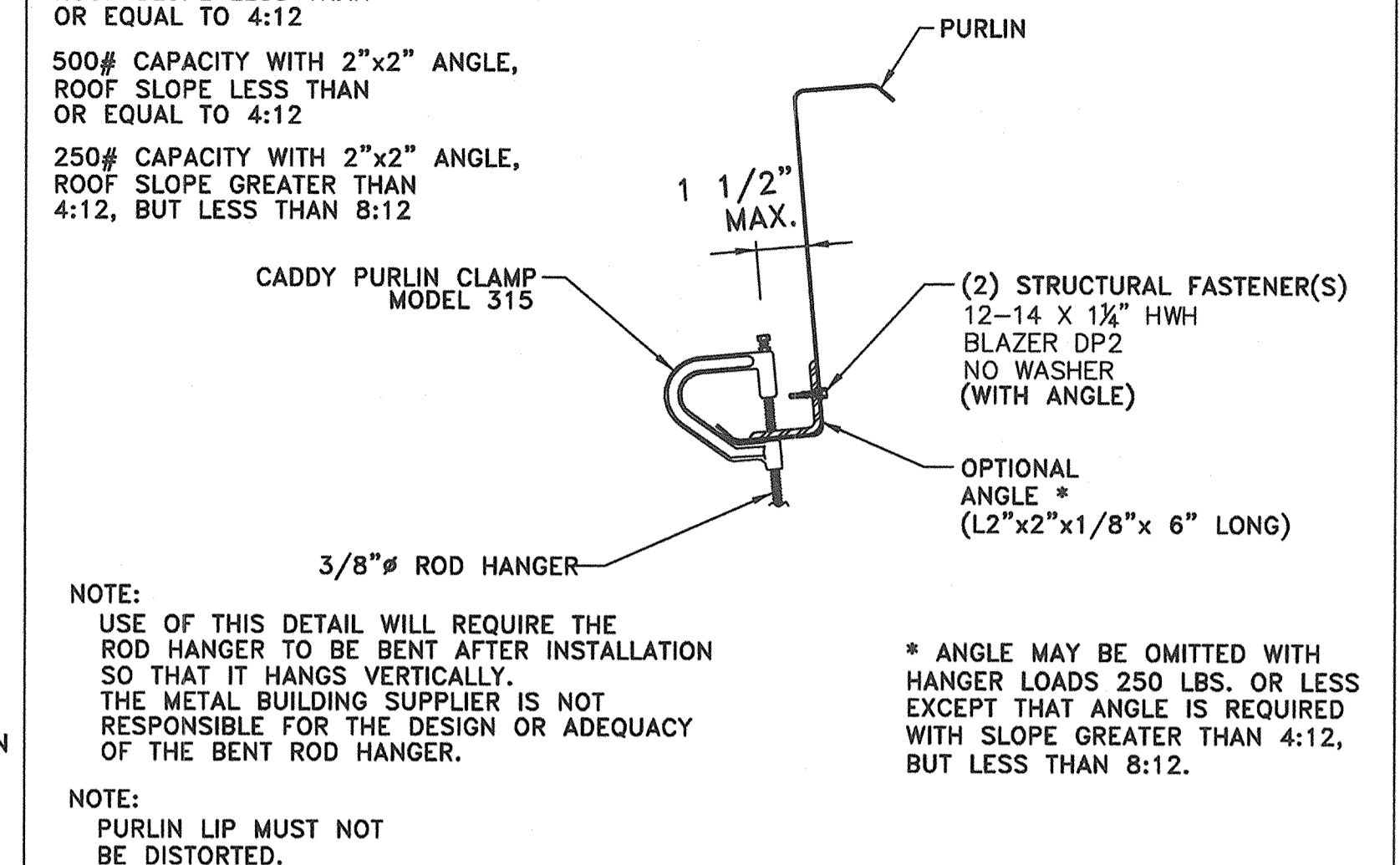

NOTE:
USE OF THIS DETAIL WILL REQUIRE THE ROD HANGER TO BE BENT AFTER INSTALLATION SO THAT IT HANGS VERTICALLY. THE METAL BUILDING SUPPLIER IS NOT RESPONSIBLE FOR THE DESIGN OR ADEQUACY OF THE BENT ROD HANGER.

NOTE:
PURLIN LIP MUST NOT BE DISTORTED.

HANGER DETAIL AT PURLINS

PURLIN CLAMP

375# CAPACITY
ROOF SLOPE LESS THAN OR EQUAL TO 4:12

250# CAPACITY
ROOF SLOPE GREATER THAN 4:12, BUT LESS THAN 8:12

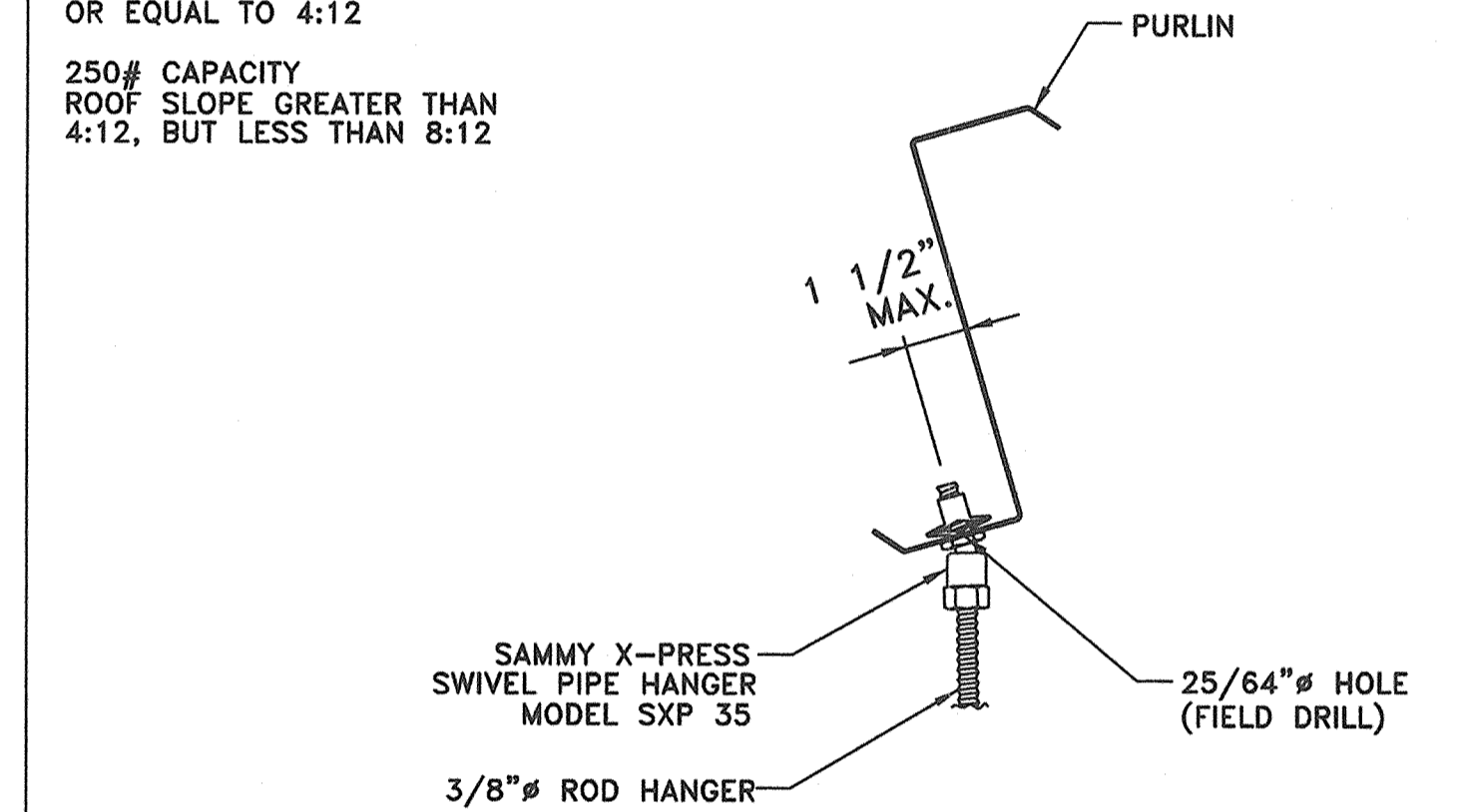

NOTE:
PURLIN LIP MUST NOT BE DISTORTED.

HANGER DETAIL AT PURLINS

ROOF SLOPES LESS THAN 8:12

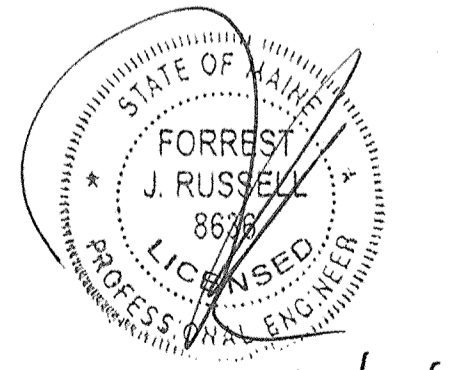

17/14

NOTE:
ALL CAPACITIES THAT ARE SHOWN ON THIS DRAWING ARE MAXIMUM HANGER LOADS FOR THESE DETAILS ONLY. THE PURLINS MAY OR MAY NOT BE DESIGNED FOR THE REQUIRED HANGER LOADS. CONTACT KIRBY BUILDING SYSTEMS FOR SUSPENDED LOADS THAT EXCEED THE DESIGN COLLATERAL LOAD SPECIFIED FOR THIS PROJECT.

ISSUE	DESCRIPTION	BY	DATE
A	APPROVAL	JLA	12-23-13

KIRBY BUILDING SYSTEMS 124 KIRBY DRIVE PORTLAND, TN 37148	
TITLE: FASTENER CHART	DRN. BY:
BUILDER: FLYNN CONSTRUCTION	DATE:
CUSTOMER: EVOLUTION ROCK	CKD. BY:
LOCATION: PORTLAND, ME	DATE:
ID NUMBER: K13B0648A	MBS
JOB NO. K13B0648A	DWG. NO. C1 OF 1