

SPECIAL BOLTS					
Q ID	QUAN	TYPE	DIA	LENGTH	WASH
2	4	A325	1/2"	1 1/2"	0

MEMBER TABLE			
QUAN	MARK	LINE	PART
8	DJ-3	BC060	
4	DH-2	BC060	
6	G-16	BZ060	
12	G-17	BZ060	
2	G-18	BZ075	
2	G-19	BZ075	
4	CB-1	BR16	
4	CB-2	BR10	
4	CB-11	BR16	

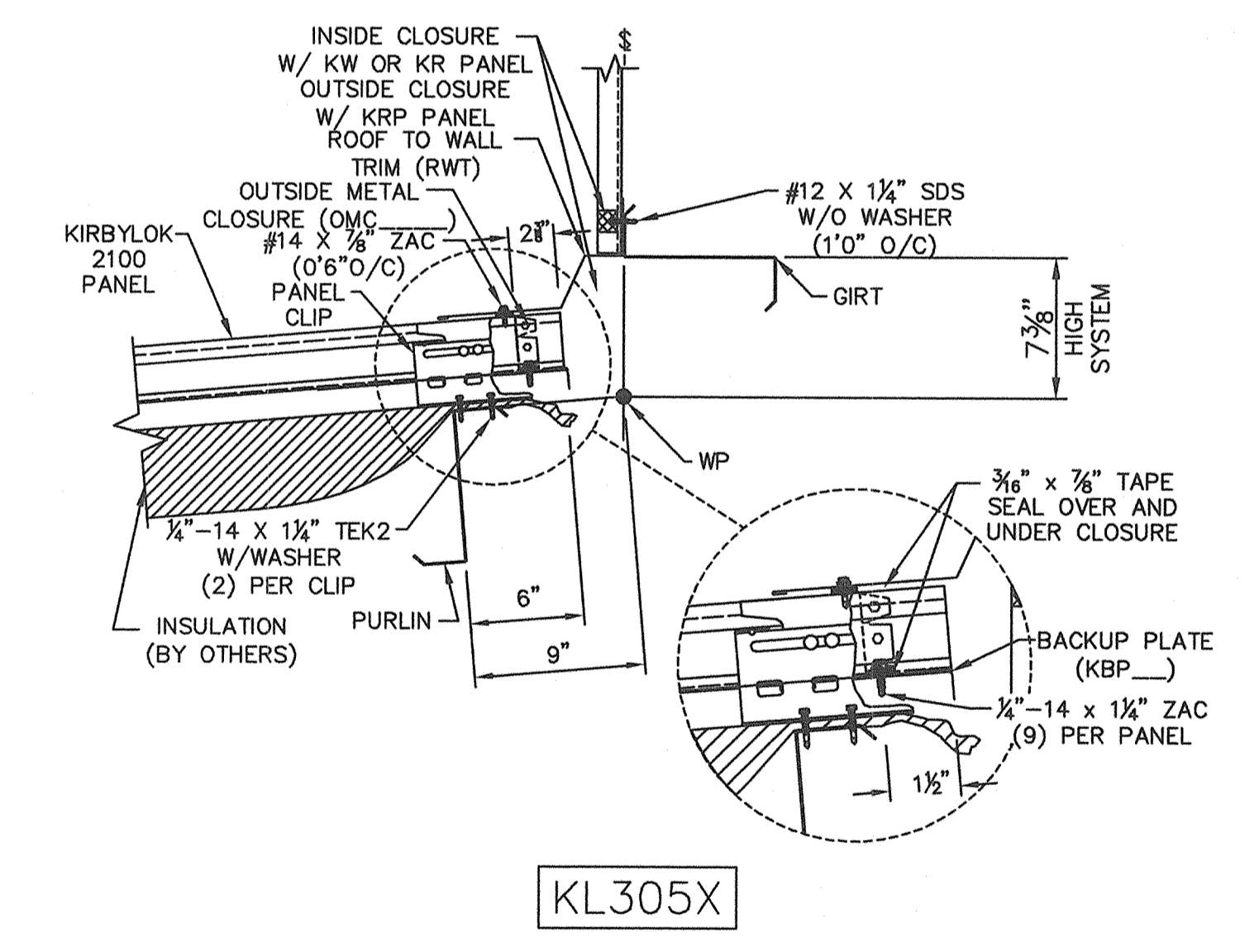
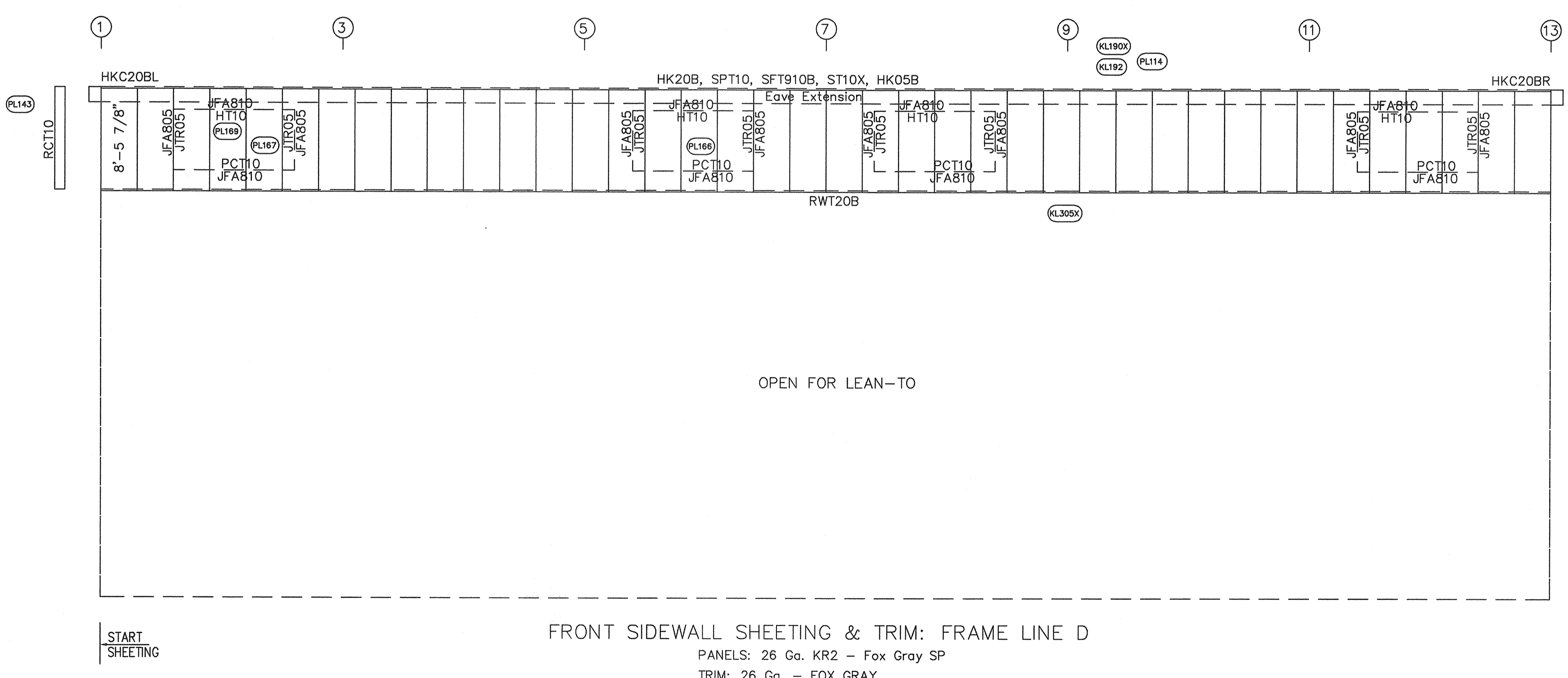
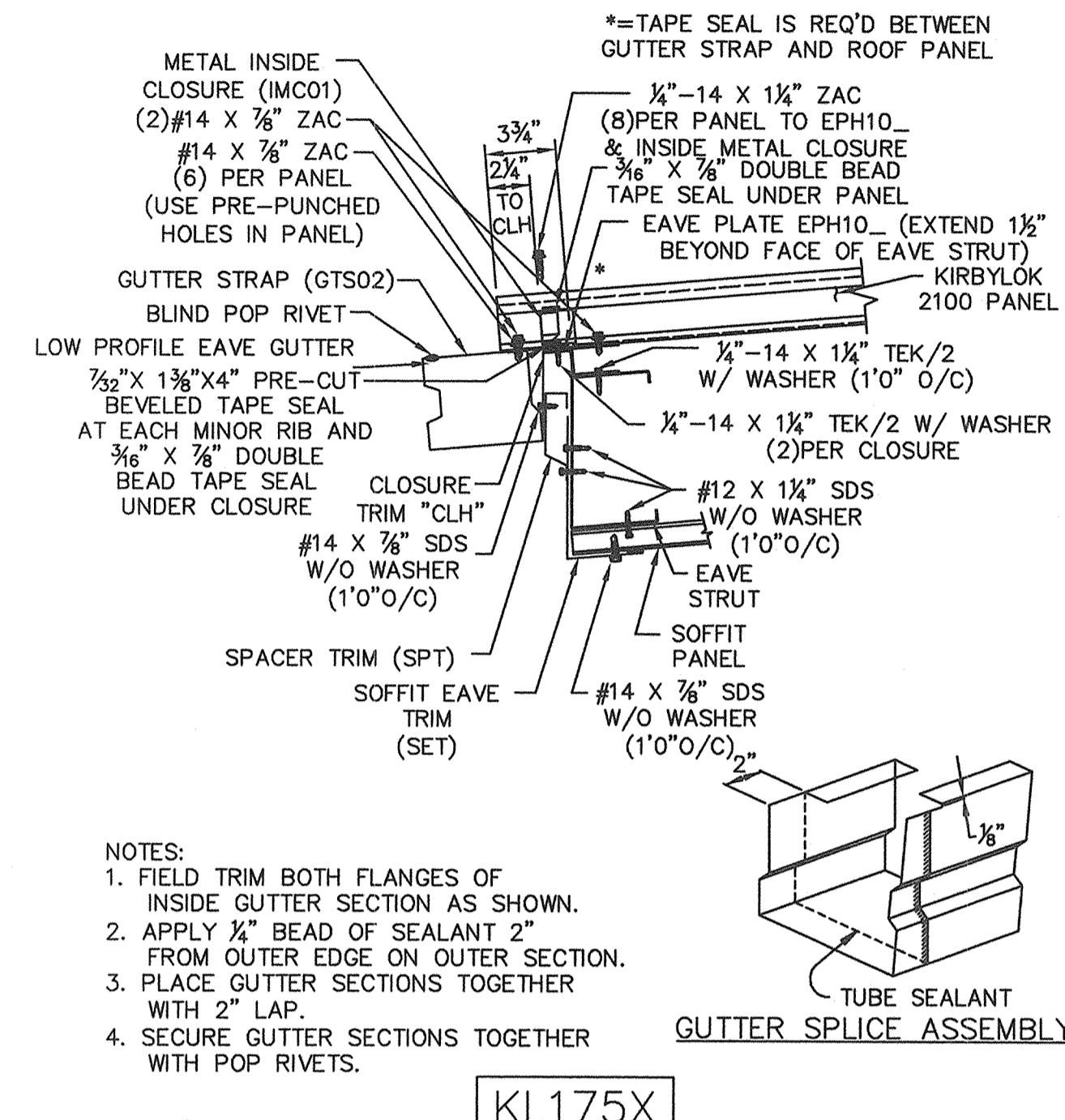
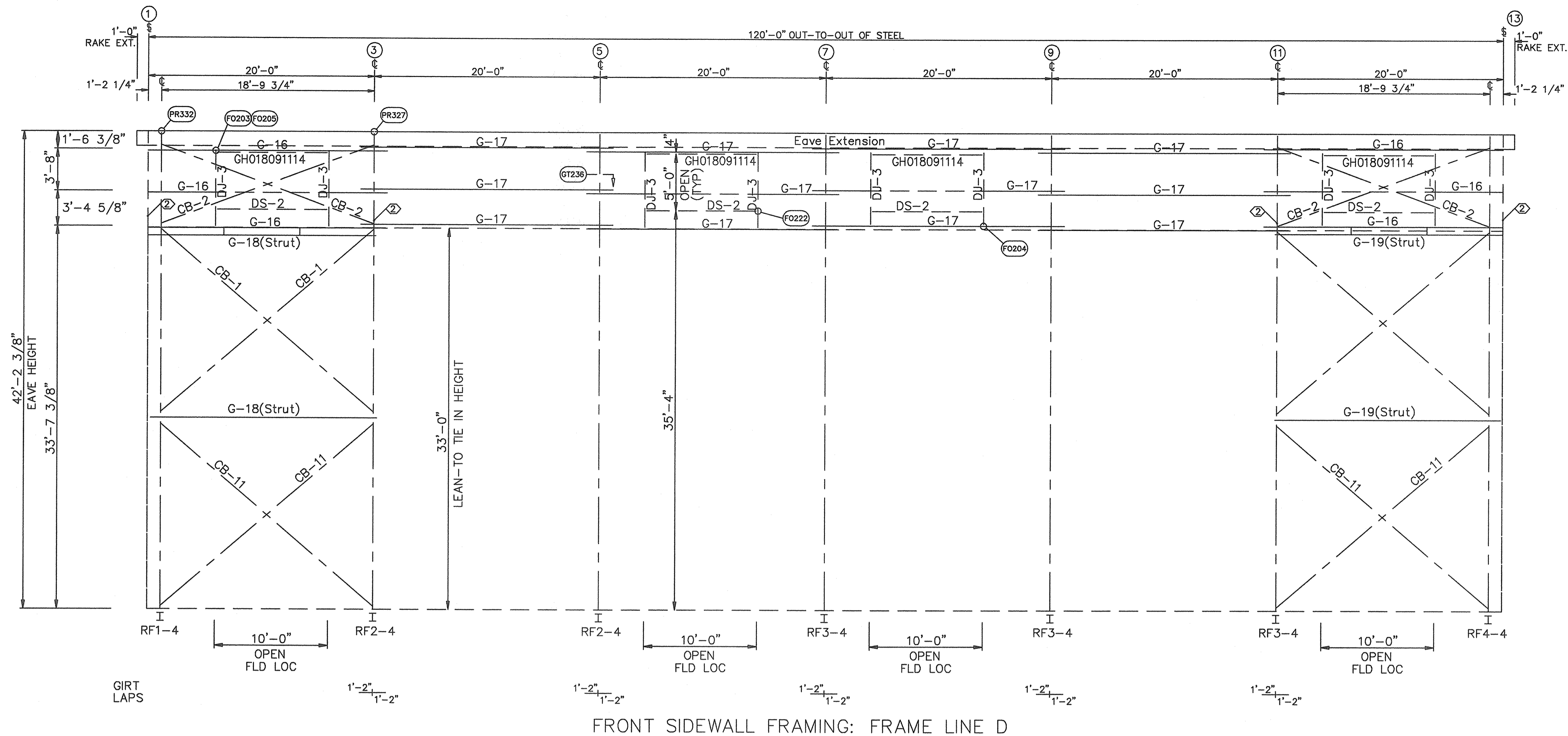

- GENERAL NOTES:
- USE 1/2" x 1 1/4" A325 BOLTS FOR ALL GIRT LAP AND GIRT TO CLIP CONNECTIONS.
 - THE DIAMETER OF THE BRACING IS DENOTED BY THE THIRD AND FOURTH DIGITS OF THE PIECE MARK. (EX. 08 = 1/2" x 10 = 8" dia)
 - ADEQUATE TEMPORARY BRACING MUST BE PROVIDED BY THE ERECTOR DURING THE ERECTION OF THE BUILDING.
 - ALL PRIMARY AND SECONDARY FRAMING, WIND BRACING, ETC. MUST BE INSTALLED, PROPERLY ALIGNED, BOLTED OR WELDED PRIOR TO THE INSTALLATION OF THE PANELS.
 - IT MAY BE NECESSARY DURING ERECTION TO MAKE MINOR ADJUSTMENTS AND ALIGNMENTS TO BOTH PURLINS AND GIRTS PRIOR TO INSTALLING PANELS.

- ERECTOR TO FIELD SLOT FLUSH FRAME GIRTS FOR CABLE BRACING.
- BUILDER TO FIELD CUT OR BACK LAP PANELS AS REQUIRED.
- BEFORE INSTALLATION OF WALL PANELS, IT IS IMPORTANT TO REFERENCE WALL PANEL FASTENER LAYOUT DETAILS (PL153) KIRBYWALL (PL149) KIRBYRIB II) TO INSURE CORRECT USAGE OF FASTENERS.
- USE RVTCP AT 5'0" C/C FOR TEMPORARY INSTALLATION OF CLH TRIM.
- DRAWINGS ARE NOT TO SCALE.
- REF. PL357 FOR CAULKING AT TRIM LAPS
- WARNING: PENCIL LEAD AND MARKER WILL CAUSE GALV. PANELS AND TRIM PIECES TO RUST. DO NOT USE THESE TO MARK ON PARTS.

NOTE: ALL GIRT LAPS NOT INDICATED WILL BE 0'24" DOOR GIRTS. ALL GIRTS ATTACHED AT ONE END TO A DOOR JAMB ARE 16 GAGE UNLESS NOTED OTHERWISE.

DETAIL KEY			
ISSUE	DESCRIPTION	BY	DATE
A	APPROVAL	JLA	12-23-13

MAIN BLDG

CERTIFICATION EXTENDS ONLY FOR THE LOADS SPECIFIED ON KIRBY'S PURCHASE ORDER AS APPLIED TO THE STRUCTURAL COMPONENTS OF THE BUILDING DESIGNED AND SUPPLIED BY KIRBY BUILDING SYSTEMS, IF ERECTED AS INDICATED. NOTE THAT KIRBY'S ENGINEER IS NOT ACTING AS THE ENGINEER OF RECORD FOR THIS CONSTRUCTION PROJECT.

Kirby Building Systems
AN IRVING COMPANY

KIRBY BUILDING SYSTEMS • 124 KIRBY DRIVE • PORTLAND, TN 37148

TITLE: FRONT SIDEWALL	DRN. BY:
BUILDER: FLYNN CONSTRUCTION	DATE:
CUSTOMER: EVOLUTION ROCK	CKD. BY:
LOCATION: PORTLAND, ME	DATE:
ID NUMBER: K13B0648MBR1	MBS
JOB NO: K13B0648A	

FLYNN CONSTRUCTION CORP.
CORPORATE • INDUSTRIAL
145 TOPPLE • BASKIN, N.H. 03060
PHONE: (603) 882-8177 • FAX: (603) 889-0484

STATE OF MAINE
FORREST J. RUSSELL
88%
LICENSED PROFESSIONAL ENGINEER
17/14