

HILARY HARRIS, AIA
LEED AP

PO BOX 22
CONCORD, NH 03302
PH: (603) 499-1239

EMAIL:
hilyharris@gmail.com

EVO ROCK & FITNESS PORTLAND, ME

ISSUE

| DATE | BY | REMARKS |
|---------|-----|-----------------------|
| 07JUL13 | HBH | PLANNING BOARD REVIEW |
| 08APR14 | HBH | FOR CONSTRUCTION |
| | | |
| | | |
| | | |
| | | |
| | | |
| | | |
| | | |

DRAWING TITLE:

1ST FLOOR PLAN

STAMP

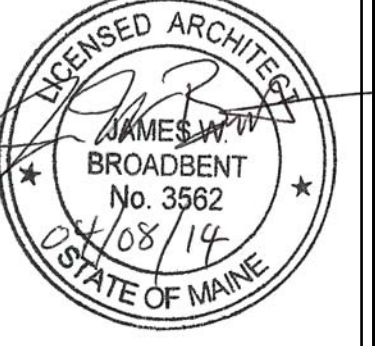

SCALE: 1/8"=1'-0"

DSN TEAM:

SHEET NUMBER:

A-1.1

LIFE SAFETY NOTES:
1. DIAGONAL = 145'-1", THEREFORE 2ND
MEANS OF EGRESS MUST BE 72'-7"
EXIT SEPARATION: 112'

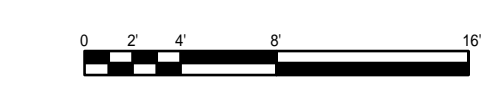
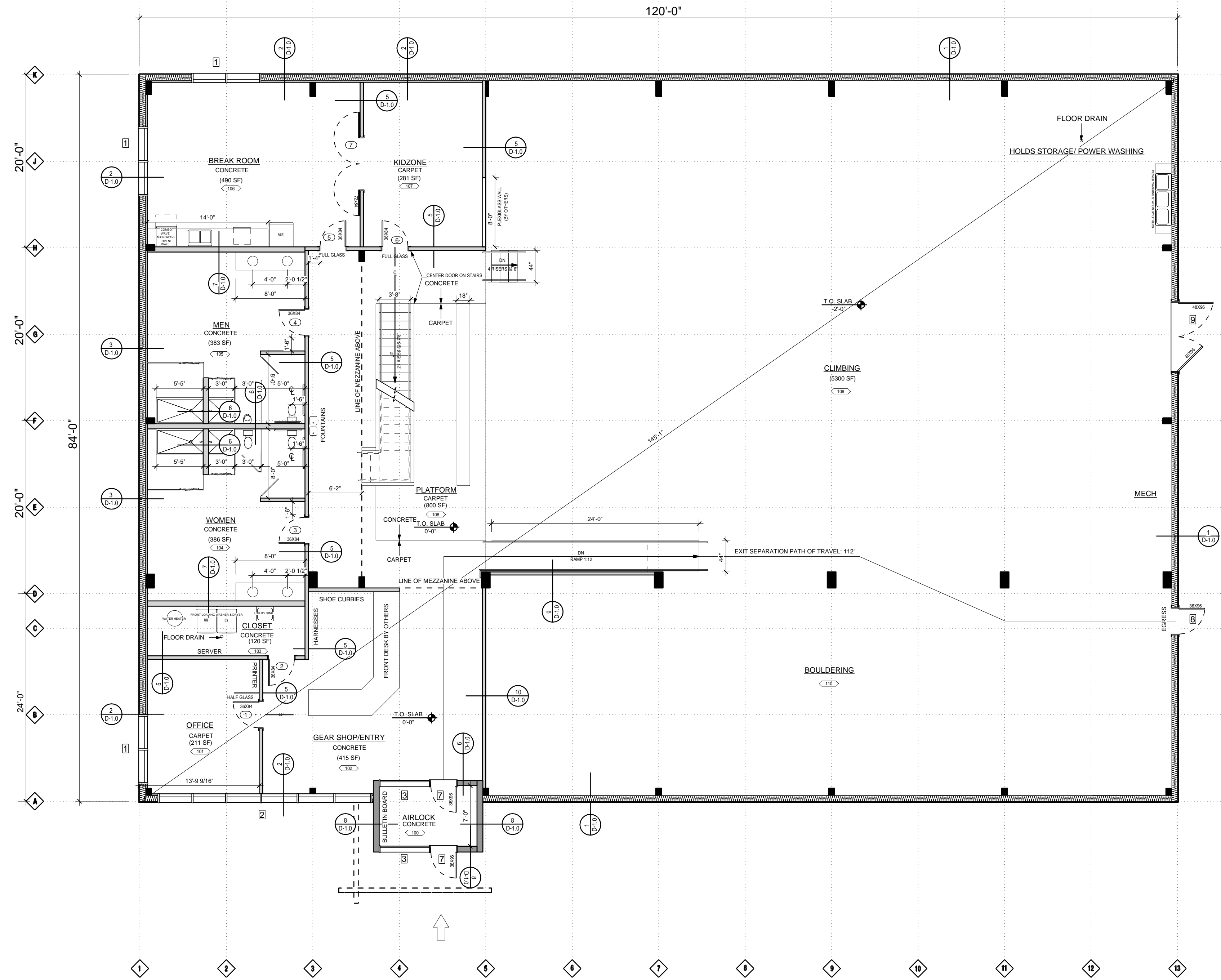

FOR CONSTRUCTION