

- FLOOR PLAN**
- ① ADDITION FLOOR SAME LEVEL AS EXISTING
  - ② INSTALL SMOKE DETECTORS, AS REQ'D.
  - ③ BUILDER TO MOVE EXISTING DRYER VENTS, SILLCOCKS, ETC. ON EXISTING REAR WALL.

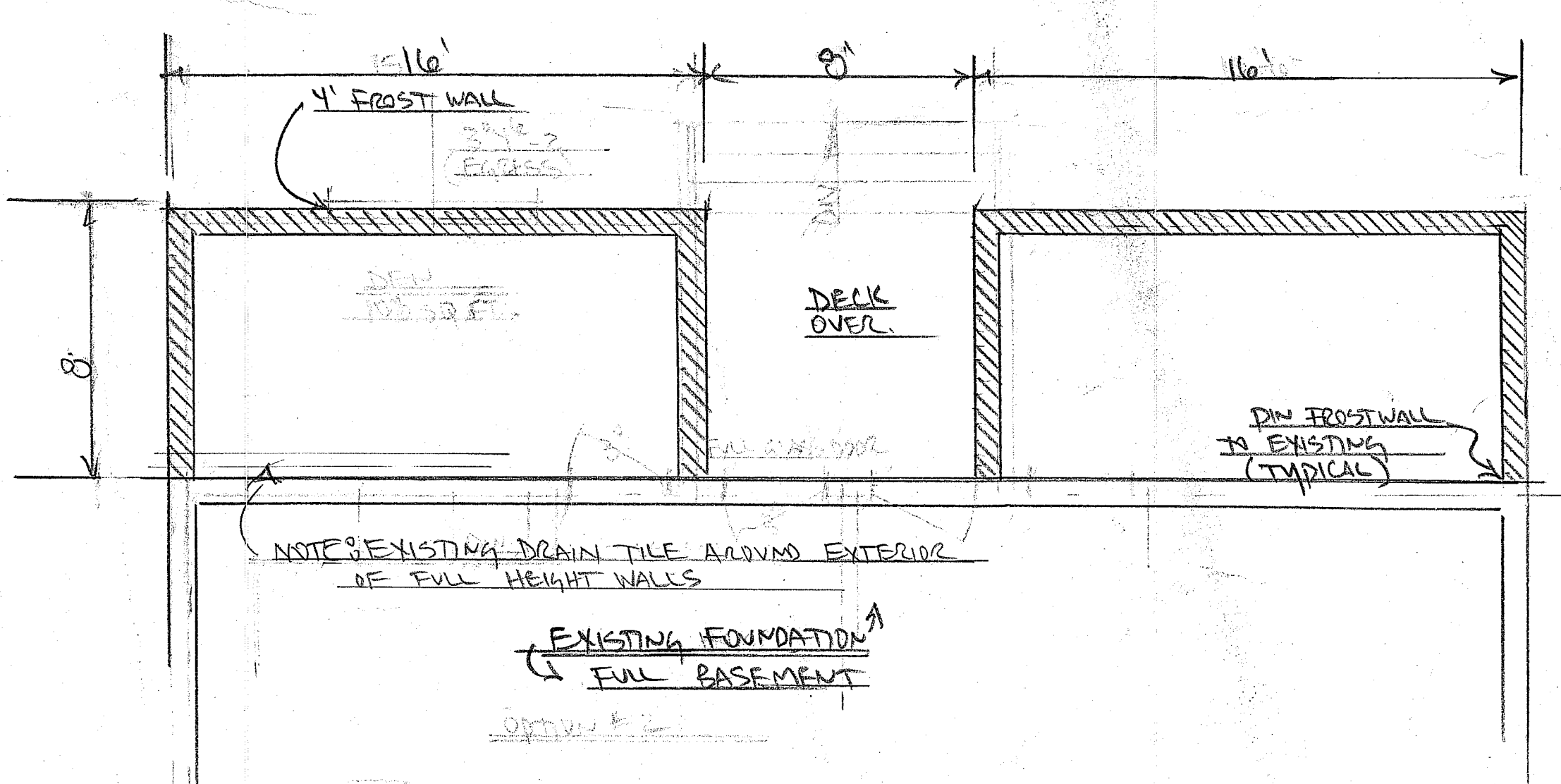

- FOUNDATION PLAN**
- ① NEW WALLS - SHADED.
  - ② 4' FROST WALLS - 8\"/>

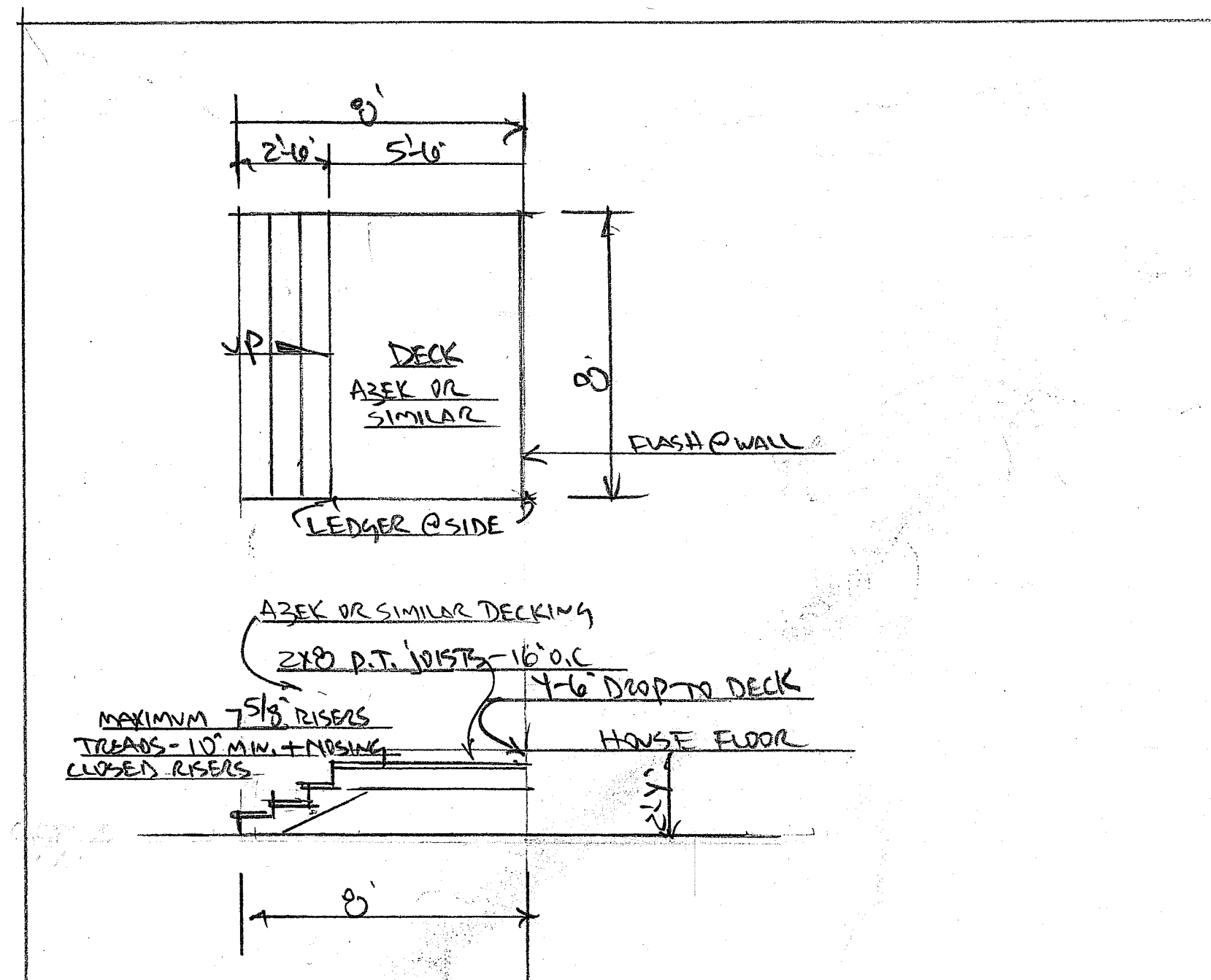

- SIMPLE DECK PLAN**
- ① CONFIRM TOTAL RISE - GRADE TO TOP OF DECK. 4 RISERS SHOWN - POSSIBLY ONLY 3 NEEDED - MAXIMUM RISE = 7 5/8\"/>
  - ② BUILDER MAY RUN P.T. JOISTS EITHER DIRECTION.

PORTLAND PERMIT # 2016-02272  
 REVIEWER - GLEN GILBERT (GGILBERT@PORTLAND.ME.GOV)  
 PLAN FOR ADDITION - 42-11 MAGGIE LANE  
 6/22/16 - SCALE 1/4"=1' - D.B.W. Stanley  
 10/25/16 / 10/29/16  
 DOTEN CONSTRUCTION - 175 S. FOREST RD. FREEPORT  
 865-4412