

# DISPLAY THIS CARD ON PRINCIPAL FRONTAGE OF WORK CITY OF PORTLAND

Please Read Application And Notes, If Any, Attached

BUILDING INSPECTION

## PERMIT

Permit Number: 080626

This is to certify that CUZNER CHARLOTTE C ROBERT W/ITS/Sheds, U.S.

has permission to new 8' x 12' Shed

AT 120 DENNETT ST L 286 H003001

PERMIT ISSUED  
JUN - 4 2008  
CITY OF PORTLAND

provided that the person or persons firm or corporation accepting this permit shall comply with all of the provisions of the Statutes of the State and of the Ordinances of the City of Portland regulating the construction, maintenance and use of buildings and structures, and of the application on file in this department.

Apply to Public Works for street line and grade if nature of work requires such information.

Notification of inspection must be given and when permission procured before this building or part thereof is occupied or closed-in. 4 HOUR NOTICE IS REQUIRED.

A certificate of occupancy must be procured by owner before this building or part thereof is occupied.

### OTHER REQUIRED APPROVALS

Fire Dept. \_\_\_\_\_  
Health Dept. \_\_\_\_\_  
Appeal Board \_\_\_\_\_  
Other \_\_\_\_\_  
Department Name

*6/5/08* *CLM*  
Director - Building & Inspection Services

**PENALTY FOR REMOVING THIS CARD**

**City of Portland, Maine - Building or Use Permit Application**

389 Congress Street, 04101 Tel: (207) 874-8703, Fax: (207) 874-8716

Permit No: 08-0626	Issue Date: 6/5/08	CBL: 286 H003001
-----------------------	-----------------------	---------------------

<b>Location of Construction:</b> 120 DENNETT ST	<b>Owner Name:</b> CUZNER CHARLOTTE C & ROB	<b>Owner Address:</b> 120 DENNETT ST	<b>Phone:</b>
<b>Business Name:</b>	<b>Contractor Name:</b> Sheds, U.S.A.	<b>Contractor Address:</b> P.O.Box 6622 Portsmouth	<b>Phone</b> 6038681300
<b>Lessee/Buyer's Name</b>	<b>Phone:</b>	<b>Permit Type:</b> Sheds	<b>Zone:</b>

<b>Past Use:</b> Single Family Home	<b>Proposed Use:</b> Single Family Home - new 8' x 12' Shed	<b>Permit Fee:</b> \$50.00	<b>Cost of Work:</b> \$2,154.00	<b>CEO District:</b> 3
<b>Proposed Project Description:</b> new 8' x 12' Shed		<b>FIRE DEPT:</b> <input type="checkbox"/> Approved <input type="checkbox"/> Denied	<b>INSPECTION:</b> Use Group: R-3 Type: SB Shed IRC-2003	
		Signature:	Signature: 6/5/08 CLM	
<b>PEDESTRIAN ACTIVITIES DISTRICT (P.A.D.)</b>				
Action: <input type="checkbox"/> Approved <input type="checkbox"/> Approved w/Conditions <input type="checkbox"/> Denied				
Signature: _____ Date: _____				

<b>Permit Taken By:</b> ldobson	<b>Date Applied For:</b> 06/05/2008	<b>Zoning Approval</b>		
------------------------------------	--	------------------------	--	--

<p>1. This permit application does not preclude the Applicant(s) from meeting applicable State and Federal Rules.</p> <p>2. Building permits do not include plumbing, septic or electrical work.</p> <p>3. Building permits are void if work is not started within six (6) months of the date of issuance. False information may invalidate a building permit and stop all work..</p>	<p><b>Special Zone or Reviews</b></p> <p><input type="checkbox"/> Shoreland</p> <p><input type="checkbox"/> Wetland</p> <p><input type="checkbox"/> Flood Zone</p> <p><input type="checkbox"/> Subdivision <i>B.K.</i></p> <p><input type="checkbox"/> Site Plan</p> <p>Maj <input type="checkbox"/> Minor <input type="checkbox"/> MM <input type="checkbox"/></p> <p>Date: 6/5/08</p>	<p><b>Zoning Appeal</b></p> <p><input type="checkbox"/> Variance</p> <p><input type="checkbox"/> Miscellaneous</p> <p><input type="checkbox"/> Conditional Use</p> <p><input type="checkbox"/> Interpretation</p> <p><input type="checkbox"/> Approved</p> <p><input type="checkbox"/> Denied</p> <p>Date: _____</p>	<p><b>Historic Preservation</b></p> <p><input checked="" type="checkbox"/> Not in District or Landmark</p> <p><input type="checkbox"/> Does Not Require Review</p> <p><input type="checkbox"/> Requires Review</p> <p><input type="checkbox"/> Approved</p> <p><input type="checkbox"/> Approved w/Conditions</p> <p><input type="checkbox"/> Denied</p> <p>Date: 6/5/08</p>
---	---	--	--

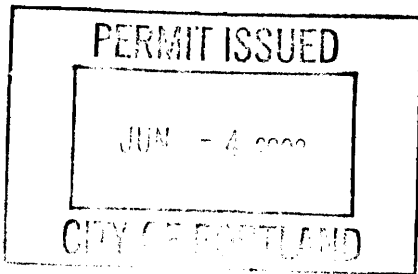

**CERTIFICATION**

I hereby certify that I am the owner of record of the named property, or that the proposed work is authorized by the owner of record and that I have been authorized by the owner to make this application as his authorized agent and I agree to conform to all applicable laws of this jurisdiction. In addition, if a permit for work described in the application is issued, I certify that the code official's authorized representative shall have the authority to enter all areas covered by such permit at any reasonable hour to enforce the provision of the code(s) applicable to such permit.

SIGNATURE OF APPLICANT	ADDRESS	DATE	PHONE
RESPONSIBLE PERSON IN CHARGE OF WORK, TITLE		DATE	PHONE

**BUILDING PERMIT INSPECTION PROCEDURES**

Please call **874-8703** or **874-8693 (ONLY)**

to schedule ~~your inspections as agreed upon~~

**Permits expire in 6 months, if the project is not started or ceases for 6 months.**

The Owner or their designee is required to notify the inspections office for the following inspections and provide adequate notice. Notice must be called in 48-72 hours in advance in order to schedule an inspection:

**By initializing at each inspection time, you are agreeing that you understand the inspection procedure and additional fees from a "Stop Work Order" and "Stop Work Order Release" will be incurred if the procedure is not followed as stated below.**

**A Pre-construction Meeting will take place upon receipt of your building permit.**

  X   **Final inspection required at completion of work.**

Certificate of Occupancy is not required for certain projects. Your inspector can advise you if your project requires a Certificate of Occupancy. All projects DO require a final inspection.

**If any of the inspections do not occur, the project cannot go on to the next phase, REGARDLESS OF THE NOTICE OR CIRCUMSTANCES.**

**CERIFICATE OF OCCUPANICES MUST BE ISSUED AND PAID FOR, BEFORE THE SPACE MAY BE OCCUPIED.**

X Robert W. Cupra  
Signature of Applicant/Designee

6-5-08  
Date

X [Signature]  
Signature of Inspections Official

6-5-08  
Date

**City of Portland, Maine - Building or Use Permit**

389 Congress Street, 04101 Tel: (207) 874-8703, Fax: (207) 874-8716

<b>Permit No:</b> 08-0626	<b>Date Applied For:</b> 06/05/2008	<b>CBL:</b> 286 H003001
------------------------------	--	----------------------------

<b>Location of Construction:</b> 120 DENNETT ST	<b>Owner Name:</b> CUZNER CHARLOTTE C & ROB	<b>Owner Address:</b> 120 DENNETT ST	<b>Phone:</b>
<b>Business Name:</b>	<b>Contractor Name:</b> Sheds, U.S.A.	<b>Contractor Address:</b> P.O.Box 6622 Portsmouth	<b>Phone</b> (603) 868-1300
<b>Lessee/Buyer's Name</b>	<b>Phone:</b>	<b>Permit Type:</b> Sheds	

<b>Proposed Use:</b> Single Family Home - new 8' x 12' Shed	<b>Proposed Project Description:</b> new 8' x 12' Shed
--	---

<b>Dept:</b> Zoning	<b>Status:</b> Approved	<b>Reviewer:</b> Chris Hanson	<b>Approval Date:</b> 06/05/2008
<b>Note:</b>	<b>Ok to Issue:</b> <input checked="" type="checkbox"/>		
<b>Dept:</b> Building	<b>Status:</b> Approved with Conditions	<b>Reviewer:</b> Chris Hanson	<b>Approval Date:</b> 06/05/2008
<b>Note:</b>	<b>Ok to Issue:</b> <input checked="" type="checkbox"/>		
1) This structure is exempt from meeting the City of Portland Building Code based on size.			
2) Application approval based upon information provided by applicant. Any deviation from approved plans requires separate review and approval prior to work.			



# General Building Permit Application

If you or the property owner owes real estate or personal property taxes or user charges on any property within the City, payment arrangements must be made before permits of any kind are accepted.

Location/Address of Construction: <u>120 DENNETT STREET, PORTLAND 04102</u>		
Total Square Footage of Proposed Structure/Area <u>6' x 12' 96 sq ft</u>		Square Footage of Lot <u>9,350 #</u>
Tax Assessor's Chart, Block & Lot Chart# <u>286</u> Block# <u>H</u> Lot# <u>3</u>	Applicant * <b>must be owner, Lessee or Buyer</b> * Name <u>Robert W. Cuzner</u> Address <u>120 DENNETT STREET</u> City, State & Zip <u>Portland, ME 04102</u>	Telephone: <u>207-775-1389</u>
Lessee/DBA (If Applicable)	Owner (if different from Applicant) Name Address City, State & Zip	Cost Of Work: \$ <u>2,154.48</u> C of O Fee: \$ _____ Total Fee: \$ <u>2,154.48</u>
Current legal use (i.e. single family) <u>Single Family</u> <span style="float: right;"><u>50</u></span> If vacant, what was the previous use? _____ Proposed Specific use: _____ Is property part of a subdivision? <u>No</u> If yes, please name _____ Project description: <u>8' x 12' Storage shed manufactured with smart siding. 40" double door, two functional sash windows. Tough Floor II pressure treated floor joists.</u>		
Contractor's name: <u>Sheds USA</u>		
Address: <u>755 Banfield Road</u>		
City, State & Zip <u>Portsmouth, NH 03801</u>		Telephone: <u>(800) 441-8489</u>
Who should we contact when the permit is ready: <u>Robert Cuzner</u>		Telephone: <u>(207) 775-1389</u>
Mailing address: <u>120 DENNETT STREET, PORTLAND ME 04102</u>		

**Please submit all of the information outlined on the applicable Checklist. Failure to do so will result in the automatic denial of your permit.**

In order to be sure the City fully understands the full scope of the project, the Planning and Development Department may request additional information prior to the issuance of a permit. For further information or to download copies of this form and other applications visit the Inspections Division on-line at [www.portlandmaine.gov](http://www.portlandmaine.gov), or stop by the Inspections Division office, room 315 City Hall or call 874-8703.

I hereby certify that I am the Owner of record of the named property, or that the owner of record authorizes the proposed work and that I have been authorized by the owner to make this application as his/her authorized agent. I agree to conform to all applicable laws of this jurisdiction. In addition, if a permit for work described in this application is issued, I certify that the Code Official's authorized representative shall have the authority to enter all areas covered by this permit at any reasonable hour to enforce the provisions of the codes applicable to this permit.

Signature: Robert W. Cuzner Date: June 5, 2008

**This is not a permit; you may not commence ANY work until the permit is issued**

# Smart Siding

8' x 8' HideAway, smart siding, peak roof, black shingles



# Pine

8' x 12' Classic, pine siding, peak roof, white/gray shingles with optional gable vents and ramp



Our pre-primed engineered wood siding is tough on everything except your wallet. If you're looking for attractive durability at a value price we recommend Smart Siding.

- Pre-primed surface offers exceptional paint adhesion
- Smart Siding is K11 Free
- 70% less paint than standard siding
- All backed by **Sheds USA Lifetime Warranty**

Choose Your Shed Model, Size & Wall Height

Model	Shed Model, Size & Wall Height	Price	Price
 THE HIDEAWAY	8' x 8' 1/2'	\$1,799	\$2,199
	8' x 10'	\$2,199	\$2,599
	8' x 12'	\$2,599	\$2,999
	10' x 12'	\$3,199	\$3,599
	12' x 12'	\$3,799	\$4,199
 THE CLASSIC	8' x 8' 1/2'	\$1,999	\$2,399
	8' x 10'	\$2,399	\$2,799
	8' x 12'	\$2,799	\$3,199
	10' x 12'	\$3,399	\$3,799
	12' x 12'	\$3,999	\$4,399
	12' x 14'	\$4,599	\$4,999
	12' x 16'	\$5,199	\$5,599
 THE HORIZON	8' x 12'	\$2,099	\$2,499
	10' x 12'	\$2,499	\$2,899
	10' x 14'	\$2,899	\$3,299
	10' x 16'	\$3,299	\$3,699
	12' x 12'	\$3,699	\$4,099
	12' x 14'	\$4,099	\$4,499
	12' x 16'	\$4,499	\$4,899

For generations builders have been using pine siding. Our pine sided shed will answer all your storage needs and flatter your yard for a lifetime.

- North America's most popular wood siding
- Solid tongue and groove construction
- Paint or stain to match your house
- All backed by **Sheds USA Lifetime Warranty**

Choose Your Shed Model, Size & Wall Height

Model	Shed Model, Size & Wall Height	Price	Price
 THE HIDEAWAY	8' x 8' 1/2'	\$1,799	\$2,199
	8' x 10'	\$2,199	\$2,599
	8' x 12'	\$2,599	\$2,999
	10' x 12'	\$3,199	\$3,599
	12' x 12'	\$3,799	\$4,199
 THE CLASSIC	8' x 8' 1/2'	\$1,999	\$2,399
	8' x 10'	\$2,399	\$2,799
	8' x 12'	\$2,799	\$3,199
	10' x 12'	\$3,399	\$3,799
	10' x 16'	\$3,999	\$4,399
	12' x 12'	\$4,599	\$4,999
	12' x 14'	\$5,199	\$5,599
 THE HORIZON	8' x 12'	\$2,099	\$2,499
	10' x 12'	\$2,499	\$2,899
	10' x 14'	\$2,899	\$3,299
	10' x 16'	\$3,299	\$3,699
	12' x 12'	\$3,699	\$4,099
	12' x 14'	\$4,099	\$4,499
	12' x 16'	\$4,499	\$4,899

# Cedar

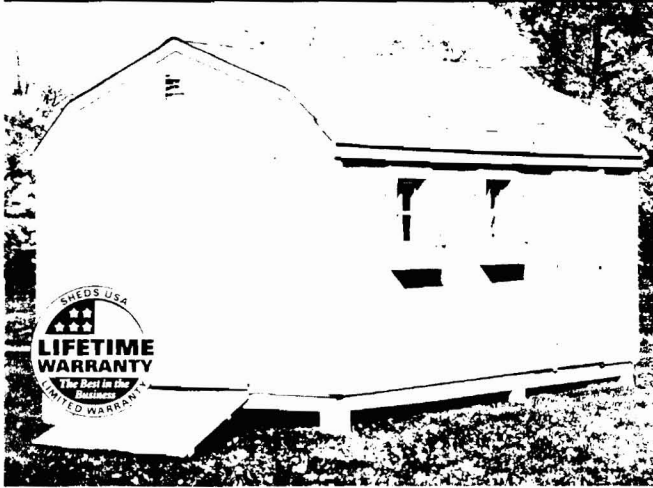

10' x 16' Horizon, cedar siding, gambrel roof, brown shingles with optional gable vents and ramp



When your backyard deserves nothing but the best, we recommend our premium cedar siding.

- Cedar resists decay and insect.
- Cedar shakes and shingles resist warping and buckling.
- Cedar shakes and shingles constructed.
- Cedar shakes and shingles are made in the USA.
- All backed by **Sheds USA Lifetime Warranty**

## Choose Your Shed Model, Size & Wall Height

Model	Size	6' Wall	7' Wall
 HIDEAWAY	8' x 12'	\$2,199	\$2,499
	10' x 12'	\$2,499	\$2,799
	10' x 16'	\$2,799	\$3,099
	12' x 20'	\$3,099	\$3,399
 CLASSIC	8' x 12'	\$2,899	\$3,039
	10' x 12'	\$3,199	\$3,329
	10' x 16'	\$3,499	\$3,729
	12' x 16'	\$3,799	\$4,089
	12' x 20'	\$4,099	\$4,509
	12' x 24'	\$4,399	\$4,829
 HORIZON	8' x 12'	\$2,799	\$3,139
	10' x 12'	\$3,029	\$3,429
	10' x 16'	\$3,419	\$3,929
	12' x 16'	\$3,769	\$4,329
	12' x 20'	\$4,169	\$4,829
	12' x 24'	\$4,569	\$5,329

## Choose Your Features

**Roof Style**

**Shingle Color**

## Choose Your Options

### WALL HEIGHT

### FLOOR UPGRADES

**Tough Floor II** (4" Slope)

- Will not rot, pressure treated floor joist
- Will not warp, center spaced
- Pressure treated plywood at floor

### DOOR UPGRADES

**Exchange Standard 40" Wide Double Door:**

- 64" Wide Double Door \$319
- 66" Wide Double Door \$349
- 60" Wide Double Door, Round Top Double Door \$439
- 66" Wide Double Door, Round Top Double Door \$499

### MORE OPTIONS

- Value Package A:** Work bench, shelf, window box \$119
- Value Package B:** Work bench, anchor kit, ramp \$139
- Window Screen** \$19
- Gable Vents** \$29
- Ramp** \$299
- Shelf** \$39
- Storage Loft** \$49
- Work Bench** \$119
- Anchor Kit** \$19

*Some options require site prep. Additional costs apply. Sheds USA will review your order and contact you with any exceptions to your selected options.*

## Quality Construction

- All 2" x 4" & 2" x 6" construction
- All construction grade material
- 40" double door with keyed lock entry
- Functional sash windows (with FREE window box & shutters)
- 6" & 8" wide = 2" x 4" PT floor joists, 16" on center
- 10" & 12" wide = 2" x 6" PT floor joists, 16" on center
- All backed by **Sheds USA Lifetime Warranty**

 Low monthly payments available with credit approval on The Home Depot Consumer Credit Card. See store for details.

No one puts more into a shed.™



# SPECIAL SERVICES CUSTOMER INVOICE

Store 2401 PORTLAND  
245 RIVERSIDE STREET  
PORTLAND, ME 04103

Phone: (207) 761-0600  
Salesperson: MTG7FT  
Reviewer:

**REPRINT**

<b>SOLD TO</b>	Name	<b>CUZNER ROBERT</b>		Home Phone	<b>(207) 775-1389</b>
	Address	120 DENNETT ST		Work Phone	() -
				Company Name	
	City	PORTLAND		Job Description	SHED
	State	ME	Zip	041021534	County

2008-05-23 13:09

INSTALLATION #1		MERCHANDISE AND SERVICE SUMMARY				We reserve the right to limit the quantities of merchandise sold to customers.	
		REF #101					
<b>BASIC INSTALLATION LABOR:</b>							
SKU	DESCRIPTION	QTY	UM	TAX	PRICE EACH	EXTENSION	
929-938	SHEDS USA SMART SIDING 6' WALL SHED	1.00	EA	Y	\$0.01	\$0.00	
<b>OPTIONAL LABOR SELECTED INCLUDES:</b>							
OPTION	DESCRIPTION	QTY	UM	TAX	PRICE EACH	EXTENSION	
02	6' SMART SIDING CLASSIC/8X12	1.00	EA	Y	\$1,959.00	\$1,959.00	
04	ROOF STYLE CHOICE - REQUIRED - CHOSE 1 (NOTE-6' WIDE SHEDS COME IN PEAK ONLY.)/GAMBREL	1.00	EA	Y	\$0.01	\$0.01	
05	ROOF SHINGLE COLOR CHOICE - REQUIRED - CHOOSE 1/BLACK	1.00	EA	Y	\$0.01	\$0.01	
12	GABLE VENTS (PAIR)/	1.00	EA	Y	\$29.00	\$29.00	
19	DELIVERY - REQUIRED FOR ALL SHEDS/0.25 MILES	1.00	EA	Y	\$0.01	\$0.01	
<b>INSTALLATION SITE NAME:</b> CUZNER, ROBERT						<b>INSTALL LABOR CHARGE:</b> \$1,988.03	
<b>ADDRESS:</b> 120 DENNETT ST						<b>TRIP CHARGE:</b> \$0.00	
<b>CITY:</b> PORTLAND	<b>STATE:</b> ME	<b>ZIP:</b> 041021534					
<b>COUNTY:</b>	<b>SALES TAX RATE:</b> 5.000	<b>TAX:</b> Merchandise - Y	<b>LABOR - Y</b>				
<b>PHONE:</b> (207) 775-1389					<b>INSTALL TOTAL DUE:</b> \$1,988.03		
*** CONTINUED ON NEXT PAGE ***							

Added pressure Treated Floor  
 \$ 156.45 with tax  
 8 147.00



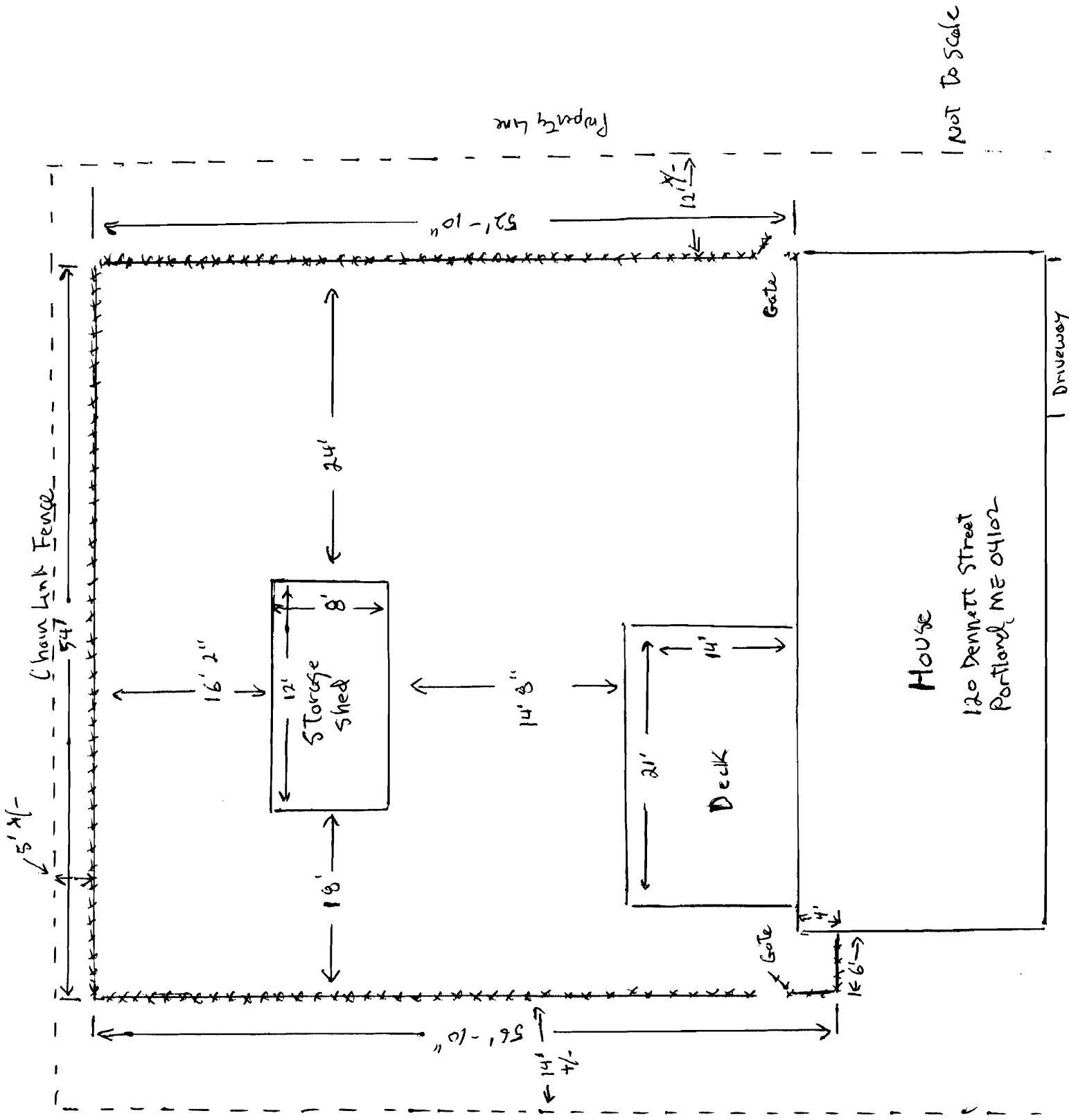

Not To Scale

House  
120 Dennett Street  
Portland, ME 04102