

City of Portland, Maine - Building or Use Permit Application

389 Congress Street, 04101 Tel: (207) 874-8703, Fax: (207) 874-8716

PERMIT ISSUED		Permit No: 02-0333	Issue Date: APR 12 2002	CBL: 286 A024001
----------------------	--	------------------------------	-----------------------------------	----------------------------

Location of Construction: 30 Ludlow Ter	Owner Name: Macquarrie Pamela A	Owner Address: 30 Ludlow Ter	Phone: 772-1927
Business Name:	Contractor Name: Samara, Keith	Contractor Address: Bolton Street Portland	Phone: 2077490737
Lessee/Buyer's Name	Phone:	Permit Type: Amendment to Single Family	Zone:

Past Use: Single Family	Proposed Use: Single Family	Permit Fee:	Cost of Work: \$58.00	CEO District: 3
		FIRE DEPT: <input type="checkbox"/> Approved <input type="checkbox"/> Denied <i>N/A</i>	INSPECTION: Use Group: <i>123</i> Type: <i>SB</i> <i>BOCA 1999</i>	

Proposed Project Description:
Amend Permit #01-1017
Addition of 12' x 16' Sunroom
Changed framing of structure only.

Signature: *[Signature]*

PEDESTRIAN ACTIVITIES DISTRICT (P.A.D.)
Action: Approved Approved w/Conditions Denied
N/A
Signature: *[Signature]* **Date:**

Permit Taken By: gad	Date Applied For: 04/09/2002	Zoning Approval
--------------------------------	--	------------------------

<ol style="list-style-type: none"> This permit application does not preclude the Applicant(s) from meeting applicable State and Federal Rules. Building permits do not include plumbing, septic or electrical work. Building permits are void if work is not started within six (6) months of the date of issuance. False information may invalidate a building permit and stop all work.. 	Special Zone or Reviews <input type="checkbox"/> Shoreland <input type="checkbox"/> Wetland <input type="checkbox"/> Flood Zone <input type="checkbox"/> Subdivision <input type="checkbox"/> Site Plan Maj <input type="checkbox"/> Minor <input type="checkbox"/> MM <input type="checkbox"/> Date: <i>OK</i>	Zoning Appeal <input type="checkbox"/> Variance <input type="checkbox"/> Miscellaneous <input type="checkbox"/> Conditional Use <input type="checkbox"/> Interpretation <input type="checkbox"/> Approved <input type="checkbox"/> Denied Date: <i>N/A</i>	Historic Preservation <input checked="" type="checkbox"/> Not in District or Landmark <input type="checkbox"/> Does Not Require Review <input type="checkbox"/> Requires Review <input type="checkbox"/> Approved <input type="checkbox"/> Approved w/Conditions <input type="checkbox"/> Denied Date:
---	---	--	--

CERTIFICATION

I hereby certify that I am the owner of record of the named property, or that the proposed work is authorized by the owner of record and that I have been authorized by the owner to make this application as his authorized agent and I agree to conform to all applicable laws of this jurisdiction. In addition, if a permit for work described in the application is issued, I certify that the code official's authorized representative shall have the authority to enter all areas covered by such permit at any reasonable hour to enforce the provision of the code(s) applicable to such permit.

SIGNATURE OF APPLICANT _____ ADDRESS _____ DATE _____ PHONE _____

RESPONSIBLE PERSON IN CHARGE OF WORK, TITLE _____ DATE _____ PHONE _____

Form # P 04

DISPLAY THIS CARD ON PRINCIPAL FRONTAGE OF WORK CITY OF PORTLAND

Please Read
Application And
Notes, If Any,
Attached

BUILDING DEPARTMENT PERMIT

Permit Number: 020333

This is to certify that Macquarrie Pamela A/Samantha Keith
has permission to Amend Permit #01-1017
AT 30 Ludlow Ter 286 A024001

provided that the person or persons, firm or corporation accepting this permit shall comply with all the provisions of the Statutes of Maine and of the Ordinances of the City of Portland relating to the construction, maintenance and use of buildings and structures, and of the application of this department.

Apply to Public Works for street line and grade if nature of work requires such information.

Notification of inspection must be given and work on permit must be completed before this building or part thereof is occupied or closed-in. 24 HOUR NOTICE IS REQUIRED.

A certificate of occupancy must be procured by owner before building or part thereof is occupied.

OTHER REQUIRED APPROVALS

Fire Dept. _____
Health Dept. _____
Appeal Board _____
Other _____
Department Name

Director - Building & Inspection Services

PENALTY FOR REMOVING THIS CARD



919 U.S. Route One ■ Yarmouth, ME 04096 ■ tel. 207.846.6670 ■ fax 207.846.6671

Date: April 2, 2002

To: Donald Paradis
30 Ludlow Terrace
Portland, Maine 04103

Re: Engineering/Consulting Services
Project - Sun Room Addition

Our scope of work is to review a portion of the structural framing. This review is limited to the sunroom addition roof beams, the 2x6 tongue and groove roof sheathing, the support beam between the existing house and the new sunroom addition and the support beam's posts that you have designated as requiring input.

We discovered that the 6"x8" roof rafters and 2"x6" roof sheathing conform to the current City of Portland and BOCA 99' codes. We also designed the support beam between the existing house and the new sunroom addition. We recommend that you install a new 3 1/2" x 11 1/4" Parallam beam with a 4"x4" supporting column at each end. We also recommend that you install proper solid blocking beneath new columns, within the floor framing depth, down to the existing foundation.

The structure excluded from this review includes footings, foundation walls, resistance to lateral loads (wind & seismic), and framing connections. We would be pleased to assist you with any additional services.

This will confirm our agreement for Engineering Ventures to provide engineering/consulting services to you. Our standard Terms and Conditions are attached. Our fee will be based on our standard rates.

Please contact me if you have any further questions or comments.

ENGINEERING VENTURES

A handwritten signature in black ink, appearing to read 'Eric Dube', written in a cursive style.

Eric Dube
Project Engineer

ROOF REVISION

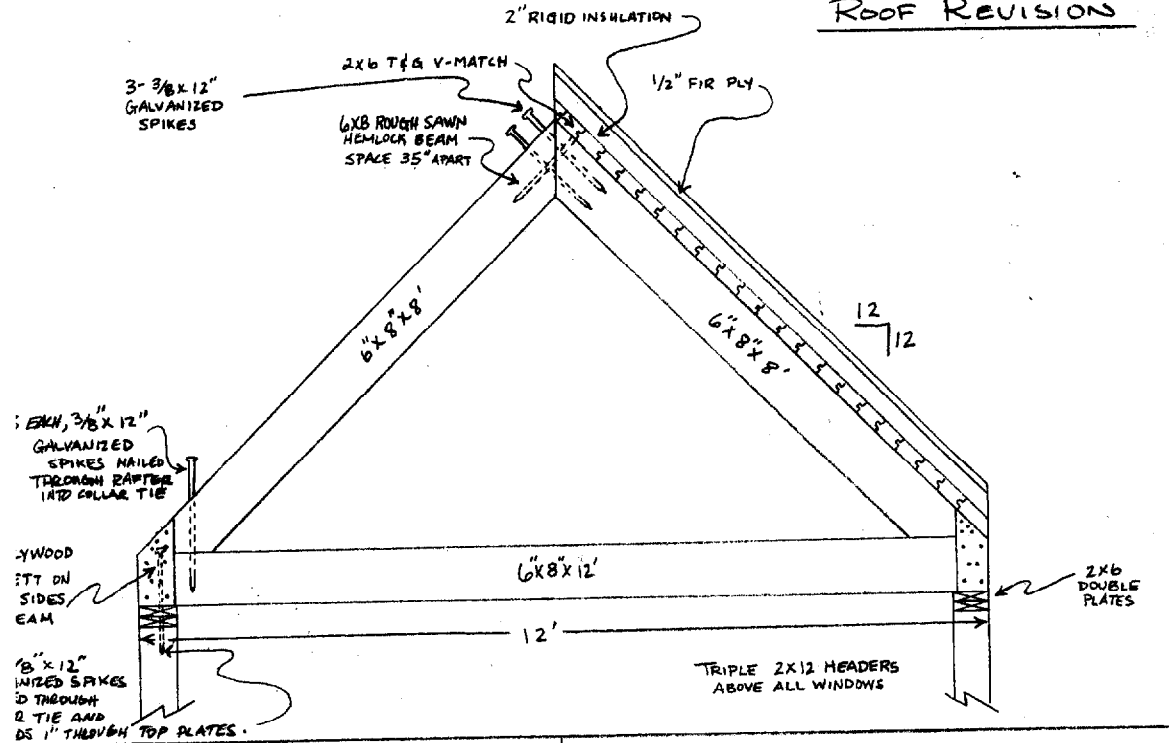

TWO NEW HEADERS

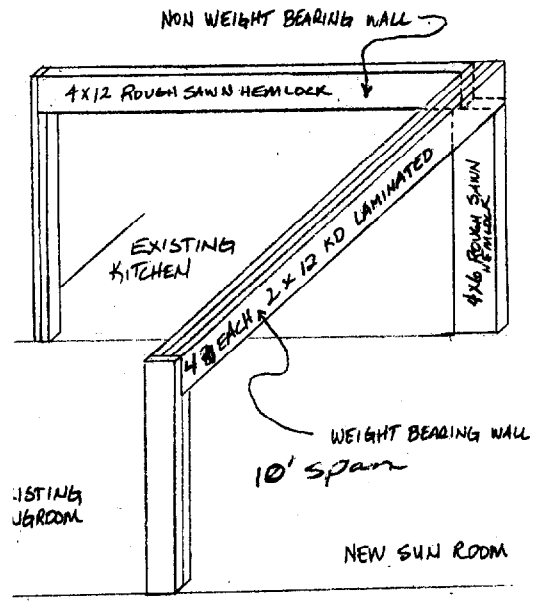

"PARADIS"

30 LUDLOW TERR.

02-0333

All Purpose Building Permit Application

If you or the property owner owes real estate or personal property taxes or user charges on any property within the City, payment arrangements must be made before permits of any kind are accepted.

Location/Address of Construction: 30 Ludlow Terr. Port. Me. 04102		
Total Square Footage of Proposed Structure	Square Footage of Lot	
Tax Assessor's Chart, Block & Lot Chart# 286 Block# A.24 Lot#	Owner: Pamela MacQuarrie	Telephone: 772-1927
Lessee/Buyer's Name (If Applicable)	Applicant name, address & telephone: Pamela MacQuarrie 30 Ludlow Terr. Port. Me. 04102 772-1927	Cost Of Work: \$ 5,000 Fee: \$ 58-
Current use: sunroom SIF 01-10-17		
If the location is currently vacant, what was prior use: _____		
Approximately how long has it been vacant: _____		
Proposed use: 10' x 16' sunroom Project description: amendment to amendment to permit #		
Contractor's name, address & telephone: Keith Samara Bolton St. Port - 749-0737		
Who should we contact when the permit is ready: Don Paradis 831-1910 ^{xx} cell		
Mailing address: TO TAMMY		
We will contact you by phone when the permit is ready. You must come in and pick up the permit and review the requirements before starting any work, with a Plan Reviewer. A stop work order will be issued and a \$100.00 fee if any work starts before the permit is picked up. PHONE:		

IF THE REQUIRED INFORMATION IS NOT INCLUDED IN THE SUBMISSIONS THE PERMIT WILL BE AUTOMATICALLY DENIED AT THE DISCRETION OF THE BUILDING/PLANNING DEPARTMENT, WE MAY REQUIRE ADDITIONAL INFORMATION IN ORDER TO APPROVE THIS PERMIT.

I hereby certify that I am the Owner of record of the named property, or that the owner of record authorizes the proposed work and that I have been authorized by the owner to make this application as his/her authorized agent. I agree to conform to all applicable laws of this jurisdiction. In addition, if a permit for work described in this application is issued, I certify that the Code Official's authorized representative shall have the authority to enter all areas covered by this permit at any reasonable hour to enforce the provisions of the codes applicable to this permit.

Signature of applicant: Donald Paradis	Date: 4-9-02
--	--------------

This is NOT a permit, you may not commence ANY work until the permit is issued. If you are in a Historic District you may be subject to additional permitting and fees with the Planning Department on the 4th floor of City Hall

BUILDING PERMIT INSPECTION PROCEDURES

Please call 874-8703 or 874-8693 to schedule your inspections as agreed upon

Permits expire in 6 months, if the project is not started or ceases for 6 months.

The Owner or their designee is required to notify the inspections office for the following inspections and provide adequate notice. Notice must be called in 48-72 hours in advance in order to schedule an inspection:

By initializing at each inspection time, you are agreeing that you understand the inspection procedure and additional fees from a "Stop Work Order" and "Stop Work Order Release" will be incurred if the procedure is not followed as stated below.

_____ **Pre-construction Meeting:** Must be scheduled with your inspection team upon receipt of this permit. Jay Reynolds, Development Review Coordinator at 874-8632 must also be contacted at this time, before **any** site work begins on any project other than single family additions or alterations.

_____ **Footing/Building Location Inspection:** Prior to pouring concrete

_____ **Re-Bar Schedule Inspection:** Prior to pouring concrete

_____ **Foundation Inspection:** Prior to placing ANY backfill

_____ **Framing/Rough Plumbing/Electrical:** Prior to any insulating or drywalling

X _____ **Final/Certificate of Occupancy:** Prior to any occupancy of the structure or use. NOTE: There is a \$75.00 fee per inspection at this point.

Certificate of Occupancy is not required for certain projects. Your inspector can advise you if your project requires a Certificate of Occupancy. All projects DO require a final inspection

_____ **If any of the inspections do not occur, the project cannot go on to the next phase, REGARDLESS OF THE NOTICE OR CIRCUMSTANCES.**

CERIFICATE OF OCCUPANICES MUST BE ISSUED AND PAID FOR, BEFORE THE SPACE MAY BE OCCUPIED

X *Donald Parks*
Signature of applicant/designee

Date

[Signature]
Signature of inspections Official

Date

CBL: 286 A024 Building Permit #: 02 0333