

NOTE:

DRAWING WAS CREATED USING INFORMATION FOR THE CITY OF PORTLAND WEBSITE AND FROM OWNER SUPPLIED INFORMATION.

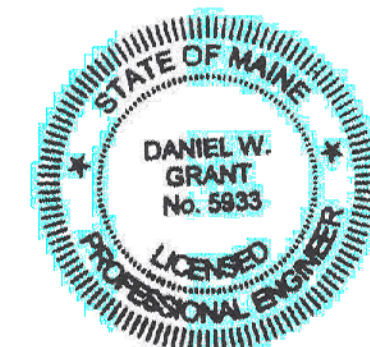
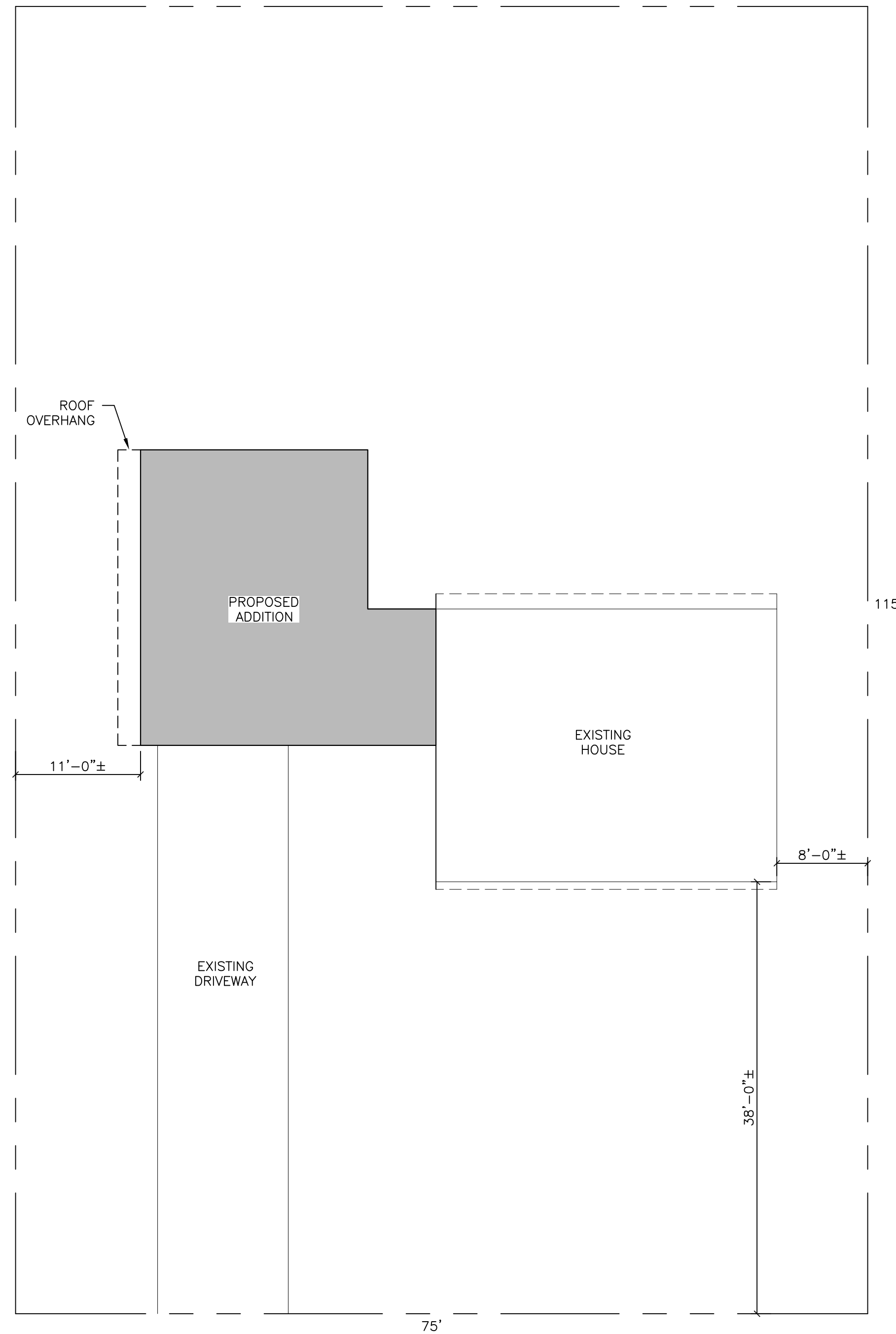

ISSUED FOR CONSTRUCTION
08-07-2015

ALL DRAWINGS, PLANS, SKETCHES ETC. ARE PROVIDED TO OUR CLIENTS BASED UPON INFORMATION PROVIDED BY THE CLIENT AND DRAWN IN ACCORDANCE WITH COMMON BUILDING PRACTICES. NONE OF THE EMPLOYEES OF MORIN DRAFTING ARE REGISTERED ARCHITECTS, STRUCTURAL ENGINEERS OR PROFESSIONAL LAND SURVEYORS. ALL CODES SHALL BE REVIEWED AND APPROVED BY APPROPRIATE REGISTERED PROFESSIONAL, IF NOT, IT SHALL BE THE RESPONSIBILITY OF THE CONTRACTOR OR OWNER. ALL NOTING, SPECIFICATIONS AND DIMENSIONS SHALL BE VERIFIED BY CLIENT AND/OR CONTRACTOR BEFORE WORK BEGINS. ALL OMISSIONS SHALL BE BROUGHT TO THE ATTENTION OF MORIN DRAFTING AFTER REVIEW. IF PLANS ARE NOT VERIFIED BY CLIENT AND/OR CONTRACTOR BEFORE CONSTRUCTION BEGINS, MORIN DRAFTING SHALL BE HELD HARMLESS. IN ALL EVENTS DAMAGES SHALL BE LIMITED TO THE COST OF THE PLANS. MORIN DRAFTING ASSUMES NO LIABILITY FOR CONSTRUCTION DEFECTS, CHANGES AND/OR REVISIONS TO THE PLANS. ALL PLANS ARE THE PROPERTY OF MORIN DRAFTING.

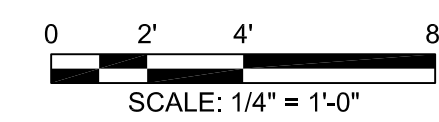

Village Builders 21 New Portland Road, Gorham, Me 207-839-6072	
MORIN DRAFTING GORHAM, ME. 318-1177	
MOREY RESIDENCE 104 DENNETT STREET, PORTLAND, MAINE	
SITE PLAN	
DRAWN: J. MORIN	C1
SCALE:	
DATE: 08-05-2015	
PLAN NO:	