

General							
GN1	1	96 high wall	Siding-4	63	0	ft	
GN2	1		heated floor area	240.00	0.00	sq ft	
GN3	1		heated roof area	253.00	0.00	sq ft	
GN4	1		heated wall area	463.00	0.00	sq ft	
GN5	1		heated door area	40.00	0.00	sq ft	
GN6	2	54 3/8 high wall	Siding-4	24	0	ft	
							Subtotal:
Subfloor							
SF1	1	8'x4'x3/4"	Sheet Plywood	8	0		
SF2	1	2x4"-20'	rim joists - lumber	4	0		
SF3	1	2x4"-12'	rim joists - lumber	4	0		
SF4	1	2x4"-12'	floor joists - lumber	15	0		
SF5	1	4x4"-20'	rim joists - lumber	4	0		
							Subtotal:
Framing							
F1	1	2x4-16ft+	fir plate	203	0	ft	
F2	1	2x4-16ft+	fir stud stock	202	0	ft	
F3	1	2x4"-91 1/2"	fir stud	34	0		
F4	1	2x11-16ft+	header - lumber	13	0	ft	
F5	2	2x4-16ft+	fir stud stock	71	0	ft	
F6	2	2x4-16ft+	fir plate	71	0	ft	
							Subtotal:
Siding							
S1	1	7" wide	Siding Wood White	1124	0	ft	
S2	1		house wrap	509.00	0.00	sq ft	
S3	2	7" wide	Siding Wood White	171	0	ft	
							Subtotal:
Ext Trim							
EX1	1	1x5-72"	door threshold	1	0		
EX2	1	1x4-16ft+	ext. door casing - color white	20	0	ft	
EX3	1	5 in	ext. door jamb - color white	20	0	ft	
EX4	1	1x6 in (2)	corner board - color white	31	0	ft	
							Subtotal:
Roofing							
R1	1	2x8"-16'+	ridge board - lumber	61	0	ft	
R2	1	2x6"-16'+	rafters - lumber	248	0	ft	
R3	1	2x6"-22'	rafters - lumber	2	0		
R4	1		ridge vent	61	0	ft	
R5	1		ridge cap	61	0	ft	
R6	1		Roofing Dimensional Comp.	369.00	0.00	sq ft	
R7	1	4x8' sheets	roof sheathing	12	0		
R8	1	2x6"	gable fascia	36	0	ft	
R9	1	2x6"	eave fascia	41	0	ft	
R10	1		metal drip edge	77	0	ft	
							Subtotal:
Insulation							
IN1	1	12x16x48" batts	floor insulation	45	0		
IN2	1	12x24x48" batts	roof insulation	31	0		
IN3	1	4x16x93" batts	wall insulation	43	0		
							Subtotal:
Flooring							
FL1	1	2 1/4" wide	Flooring Oak-Golden	1169	0	ft	
Wall Brd							
WB1	1	4'x8'x1/2"	Sheet Sheetrock	16	0		
WB2	2	4'x8'x1/2"	Sheet Sheetrock	2	0		
							Subtotal:
Doors							
D1	1		handle: Lever (decorative)	2	0		
D2	1		handle: Exterior Handle (ext.)	2	0		
D3	1		lock: Dead Bolt (interior)	2	0		
D4	1		lock: Dead Bolt (exterior)	2	0		
D5	1		hinge: hidden	6	0		
D6	1	36x80x1 3/4R	ext. 6-Panel - color white	1	0		
D7	1	36x80x1 3/4L	ext. 6-Panel - color white	1	0		
							Subtotal:
Int Trim							
T1	1	1x4-16ft+	interior casing	20	0	ft	
T2	1	1x6-16ft+	base molding	61	0	ft	
							Subtotal:
							Total:

Computer Generated Materials List
From the 3D CAD Model
Verify Before Construction

CDX PLYWOOD SHEAR WALL INSTALLED W/ LONG DIMENSION ACROSS STUDS. STAGGER VERTICAL JOINTS

PANEL SHEATHING USED AS CORNER BRACING W/ LONG DIMENSION PARALLEL TO STUDS

LEAVE 1/4" GAP @ EDGES & 1/8" GAP @ ENDS UNLESS OTHERWISE RECOMMENDED BY MANUFACTURER

SIDING MATERIAL STRUCTURAL PANEL CAN ACT AS SIDING IF OF EXTERIOR GRADE

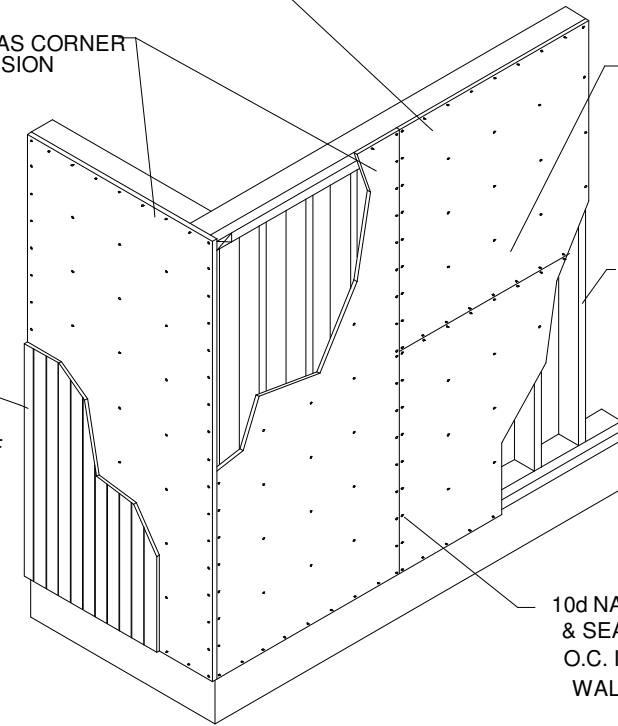

10d NAILS @ 6" O.C. AT EDGES & SEAMS AND 10d NAILS @ 12" O.C. IN FIELD U.N.O. ON SHEAR WALL SCHEDULE

TYPICAL BRACED WALL PANEL (BWP)

NOTE: TYPICAL DETAILS FOR CONSTRUCTION TO MEET BUILDING REQUIREMENTS. BARN TO BE BUILT AS PER LOCAL CODE REQUIREMENTS

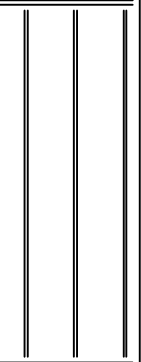
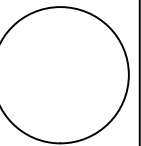

CLIENT _____

DATE _____

DRAWN BY _____

CHECKED BY _____

DATE _____

REVISIONS _____

JOB NO. _____

DETAILS

SHEET NO.

5

OF

6