

This page contains a detailed description of the Parcel ID you selected. Press the **New Search** button at the bottom of the screen to submit a new query.

**Current Owner Information**

**Card Number** 1 of 1  
**Parcel ID** 286 E011001  
**Location** 376 LUDLOW ST  
**Land Use** SINGLE FAMILY

**Owner Address** FIELDS JAMES H & JENNIFER A SHUPE JTS  
 376 LUDLOW ST  
 PORTLAND ME 04102

**Book/Page** 19569/156  
**Legal** 374-380  
 8000 SF

**Current Assessed Valuation For Fiscal Year 2006**

<b>Land</b>	<b>Building</b>	<b>Total</b>
\$49,260	\$124,240	\$173,500

**Estimated Assessed Valuation For Fiscal Year 2007\***

<b>Land</b>	<b>Building</b>	<b>Total</b>
\$64,600	\$165,000	\$229,600

\* Value subject to change based upon review of property **status** as of 4/1/06. The tax rate will be determined by City Council in May 2006.

**Property Information**

<b>Year Built</b>	<b>Style</b>	<b>story Height</b>	<b>Sq. Ft.</b>	<b>Total Acres</b>
1964	Garrison	2	1395	0.184

<b>Bedrooms</b>	<b>Full Baths</b>	<b>Half Baths</b>	<b>Total Rooms</b>	<b>Attic</b>	<b>Basement</b>
3	1	1	6	None	Full

**Outbuildings**

<b>Type</b>	<b>Quantity</b>	<b>Year Built</b>	<b>Size</b>	<b>Grade</b>	<b>condition</b>
GARAGE-WD/CB CANOPY	1 1	1965 1965	22X24 7X24	1	G G

**Sales Information**

<b>Date</b>	<b>Type</b>	<b>Price</b>	<b>Book/Page</b>
06/01/2003	LAND & BLDING	\$232,000	19569-156
08/01/2002	LAND & BLDING	\$198,000	17908-177

**Picture and Sketch**

[Picture](#)      [Sketch](#)      [Tax Map](#)

[Click here](#) to view **Tax** Roll Information.

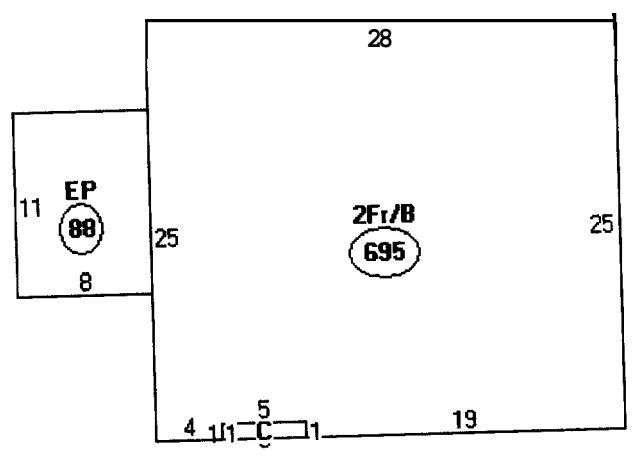

Descriptor/Area

- 1: 2Fr/B  
695 sqft
- 2: EP  
88 sqft
- 3: FDH  
5 sqft

528 garage 22x24  
 168 garage canopy 7x24  
 224 New deck 14x6

695  
 88  
 5  
 528  
 168  
 224

8000<sup>sq ft</sup> x 35%

2800<sup>sq ft</sup>  
 max lot cov.

OK

1708<sup>sq ft</sup>

Client: **Jon & James Fields**  
 376 Ludlow St.  
 Portland, ME  
 # 412-0201

Builder/contractor: **M/S WoodWales / Mark D'Fabio.**  
 101 Albion Rd  
 Windham, ME 04962  
 # 318-2209

**R-3 Zone**  
 8,000 sq ft  
 REAR: 25' req - 33'  
 SIDE: 14' req - 21'  
 38' Show

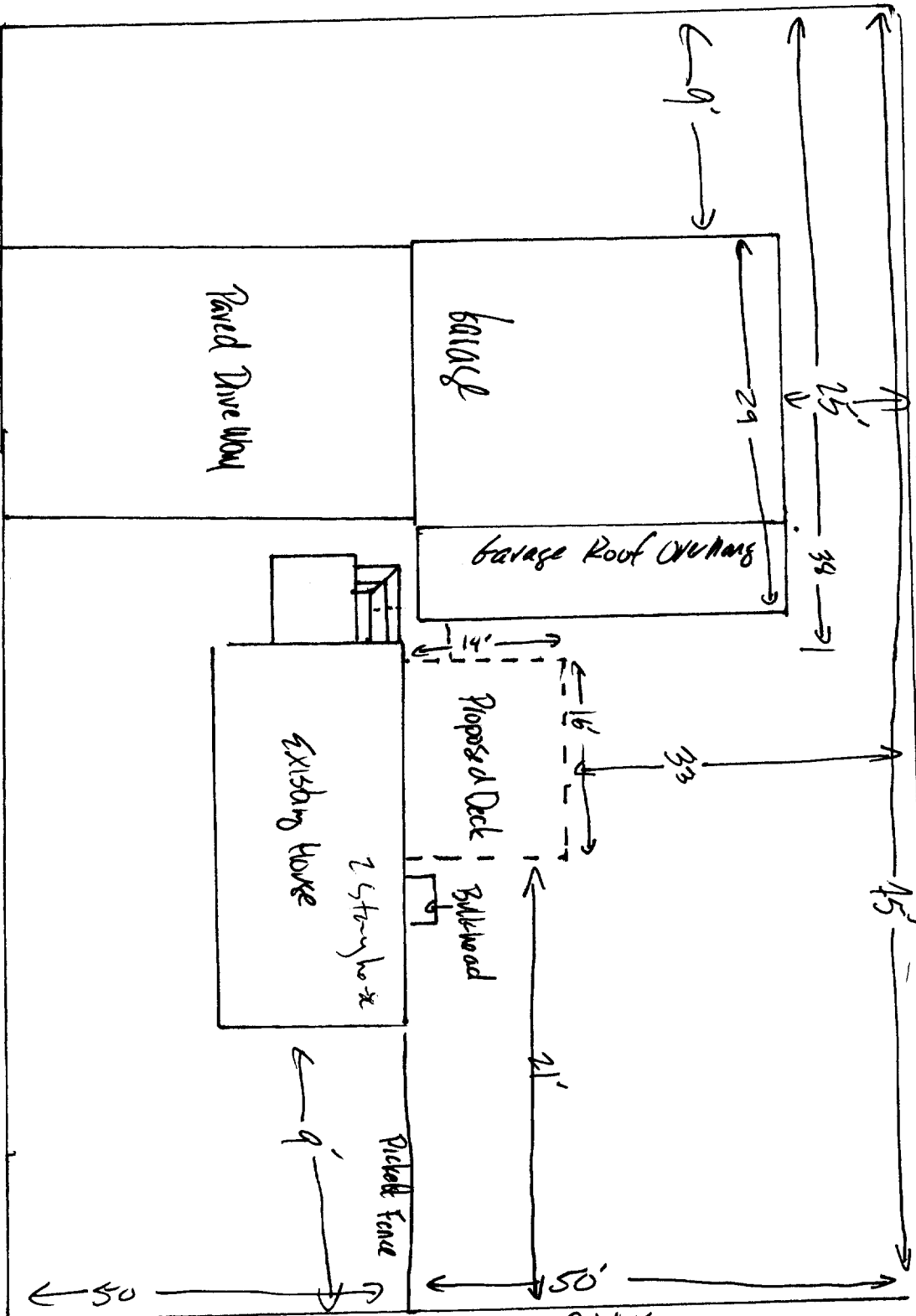

LOT PLAN (Not to Scale)

← Ludlow St. →

# BUILDING A DECK???

## INFORMATION REQUIRED WITH YOUR APPLICATION

The following is a guideline of information required for the review of a deck application. It is intended to help you supply proper and complete application packages. Please label all of the following items on your plans. Thank you!

1. **A complete plot plan showing all structures & proposed structures with distances to all property lines labeled.**
2. **Type of foundation system**
  - a. Diameter of concrete filled tube or pre cast concrete pier size 8"
  - b. depth below grade (minimum 4'-0" below grade) 4 FT
  - c. anchorage of column to footing Lag Bolts
  - d. spacing and location of tubes/piers 5 FT
3. **Framing Members**
  - a. Columns – wood size and location (members supporting framing of floor system) 4x4 post
  - b. Ledger size attached to building 2x10
  - c. Fastener size and spacing attaching ledger LAG BOLTS 24" OC
  - d. Girder Size and spans carrying floor system 2(2x10)
  - e. Joist size, span, and spacing 2x10 16" OC
  - f. Joist hangers or ledger Joist Hangers
4. **Guardrails & Handrail Details**
  - a. Guardrail height
  - b. Baluster spacing
  - c. Handrail height

NA 18" h. off grade
5. **Stair Details**
  - a. Tread depth (measured nosing to nosing)
  - b. Riser height
  - c. Nosing on tread
  - d. Width of stairs

Existing steps

