

**City of Portland, Maine - Building or Use Permit Application**

389 Congress Street, 04101 Tel: (207) 874-8703, Fax: (207) 874-8716

Permit No: 06-1235	Issue Date:	CBL: 285 C017001
-----------------------	-------------	---------------------

Location of Construction: 785 BRIGHTON AVE	Owner Name: GUEVIN EDWARD J & RONALD	Owner Address: 785 BRIGHTON AVE	Phone:
Business Name:	Contractor Name: Home owner	Contractor Address:	Phone:
Lessee/Buyer's Name	Phone:	Permit Type: Alterations - Dwellings	Zone:

Past Use: Single Family	Proposed Use: Single Family 8 x 12 shed	Permit Fee: \$30.00	Cost of Work: \$600.00	CEO District: 3
----------------------------	--	------------------------	---------------------------	--------------------

FIRE DEPT: <input type="checkbox"/> Approved <input type="checkbox"/> Denied	INSPECTION: Use Group: <i>Resource</i> Type: <i>Prot. Zone.</i>
Signature:	Signature:

Proposed Project Description:  
8 x 12 shed

**DENIED**

PED (P.A.D.)

Action:  Approved  Approved w/Conditions  Denied

Signature: \_\_\_\_\_ Date: \_\_\_\_\_

Permit Taken By: dmartin	Date Applied For: 08/23/2006	<b>Zoning Approval</b>
-----------------------------	---------------------------------	------------------------

<p>1. This permit application does not preclude the Applicant(s) from meeting applicable State and Federal Rules.</p> <p>2. Building permits do not include plumbing, septic or electrical work.</p> <p>3. Building permits are void if work is not started within six (6) months of the date of issuance. False information may invalidate a building permit and stop all work..</p>	<p><b>Special Zone or Reviews</b></p> <p><input type="checkbox"/> Shoreland</p> <p><input type="checkbox"/> Wetland</p> <p><input type="checkbox"/> Flood Zone</p> <p><input type="checkbox"/> Subdivision</p> <p><input type="checkbox"/> Site Plan</p> <p>Maj <input type="checkbox"/> Minor <input type="checkbox"/> MM <input type="checkbox"/></p> <p>Date: _____</p>	<p><b>Zoning Appeal</b></p> <p><input type="checkbox"/> Variance</p> <p><input type="checkbox"/> Miscellaneous</p> <p><input type="checkbox"/> Conditional Use</p> <p><input type="checkbox"/> Interpretation</p> <p><input type="checkbox"/> Approved</p> <p><input type="checkbox"/> Denied</p> <p>Date: _____</p>	<p><b>Historic Preservation</b></p> <p><input type="checkbox"/> Not in District or Landmark</p> <p><input type="checkbox"/> Does Not Require Review</p> <p><input type="checkbox"/> Requires Review</p> <p><input type="checkbox"/> Approved</p> <p><input type="checkbox"/> Approved w/Conditions</p> <p><input type="checkbox"/> Denied</p> <p>Date: _____</p>
---	--	--	--

**CERTIFICATION**

I hereby certify that I am the owner of record of the named property, or that the proposed work is authorized by the owner of record and that I have been authorized by the owner to make this application as his authorized agent and I agree to conform to all applicable laws of this jurisdiction. In addition, if a permit for work described in the application is issued, I certify that the code official's authorized representative shall have the authority to enter all areas covered by such permit at any reasonable hour to enforce the provision of the code(s) applicable to such permit.

SIGNATURE OF APPLICANT	ADDRESS	DATE	PHONE
RESPONSIBLE PERSON IN CHARGE OF WORK, TITLE		DATE	PHONE



# General Building Permit Application

If you or the property owner owes real estate or personal property taxes or user charges on any property within the City, payment arrangements must be made before permits of any kind are accepted.

Location/Address of Construction: <u>785 Brighton Ave - Portland - 04102</u>		
Total Square Footage of Proposed Structure <u>N/A</u>		Square Footage of Lot <u>N/A</u>
Tax Assessor's Chart, Block & Lot Chart#      Block#      Lot# <u>285      C      017</u>	Owner: <u>Ryan Le</u>	Telephone: <u>207 615 6645</u>
Lessee/Buyer's Name (If Applicable) <u>Ryan Le</u>	Applicant name, address & telephone: <u>Ryan Le 785 Brighton Ave Portland, ME 04102</u>	Cost Of Work: \$ <u>600.00</u> Fee: \$ _____ C of O Fee: \$ <u>N/A</u>
Current Specific use: <u>Single Family</u> If vacant, what was the previous use? _____ Proposed Specific use: _____		
Project description: <u>8x12 Shed</u>		
Contractor's name, address & telephone: <u>Below</u>		
Who should we contact when the permit is ready: <u>Ryan Le</u> Mailing address: _____ Phone: <u>615 6645</u>		

Please submit all of the information outlined in the Commercial Application Checklist.  
Failure to do so will result in the automatic denial of your permit.

In order to be sure the City fully understands the full scope of the project, the Planning and Development Department may request additional information prior to the issuance of a permit. For further information visit us on-line at [www.portlandmaine.gov](http://www.portlandmaine.gov), stop by the Building Inspections office, room 315 City Hall or call 874-8703.

I hereby certify that I am the Owner of record of the named property, or that the owner of record authorizes the proposed work and that I have been authorized by the owner to make this application as his/her authorized agent. I agree to conform to all applicable laws of this jurisdiction. In addition, if a permit for work described in this application is issued, I certify that the Code Official's authorized representative shall have the authority to enter all areas covered by this permit at any reasonable hour to enforce the provisions of the codes applicable to this permit.

Signature of applicant: Ryan Le Date: 8/18/06

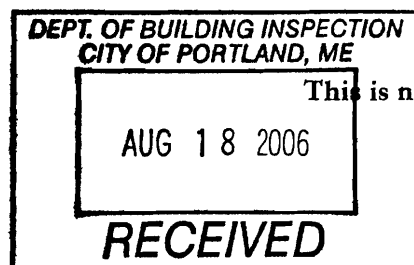

CASH

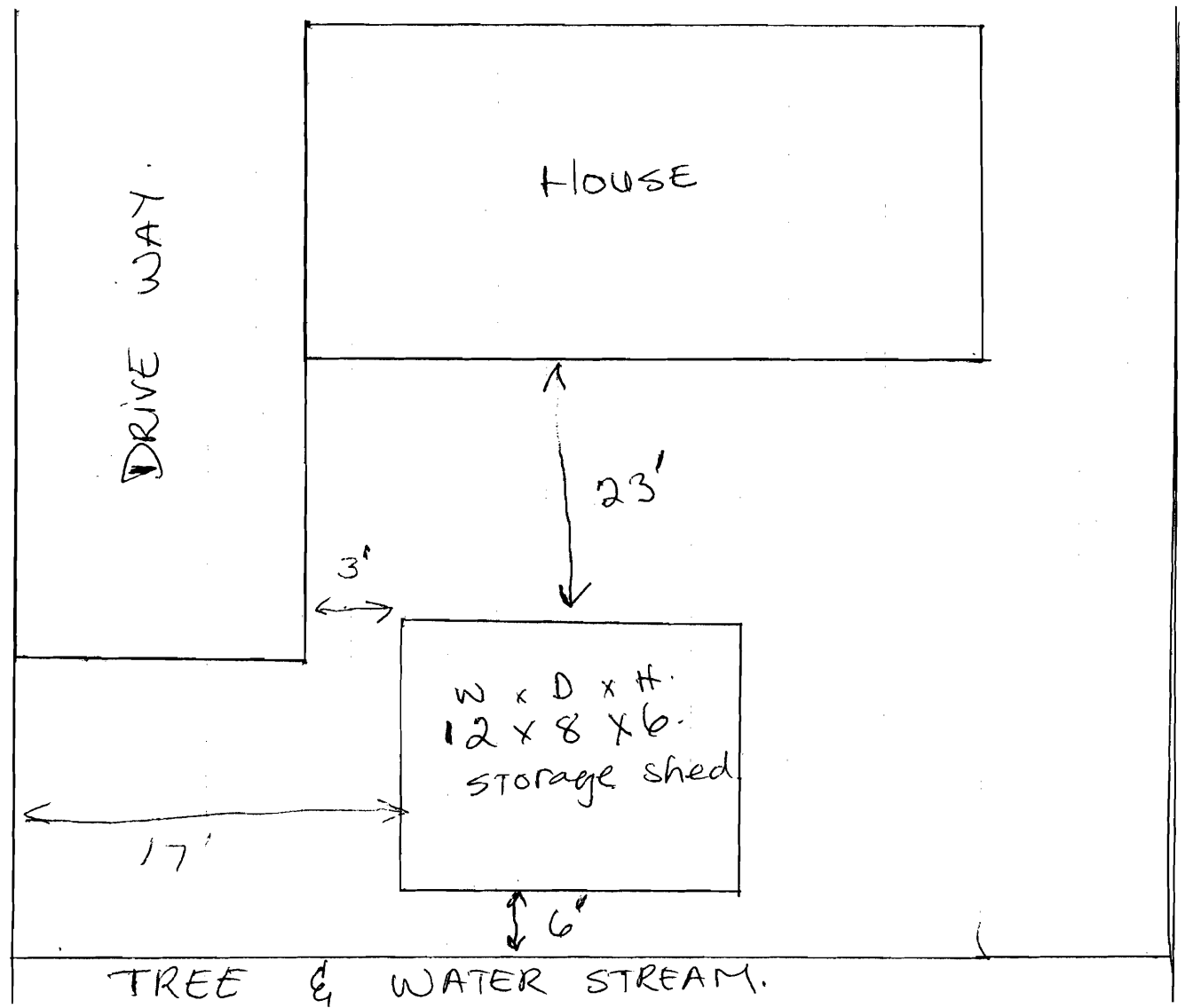

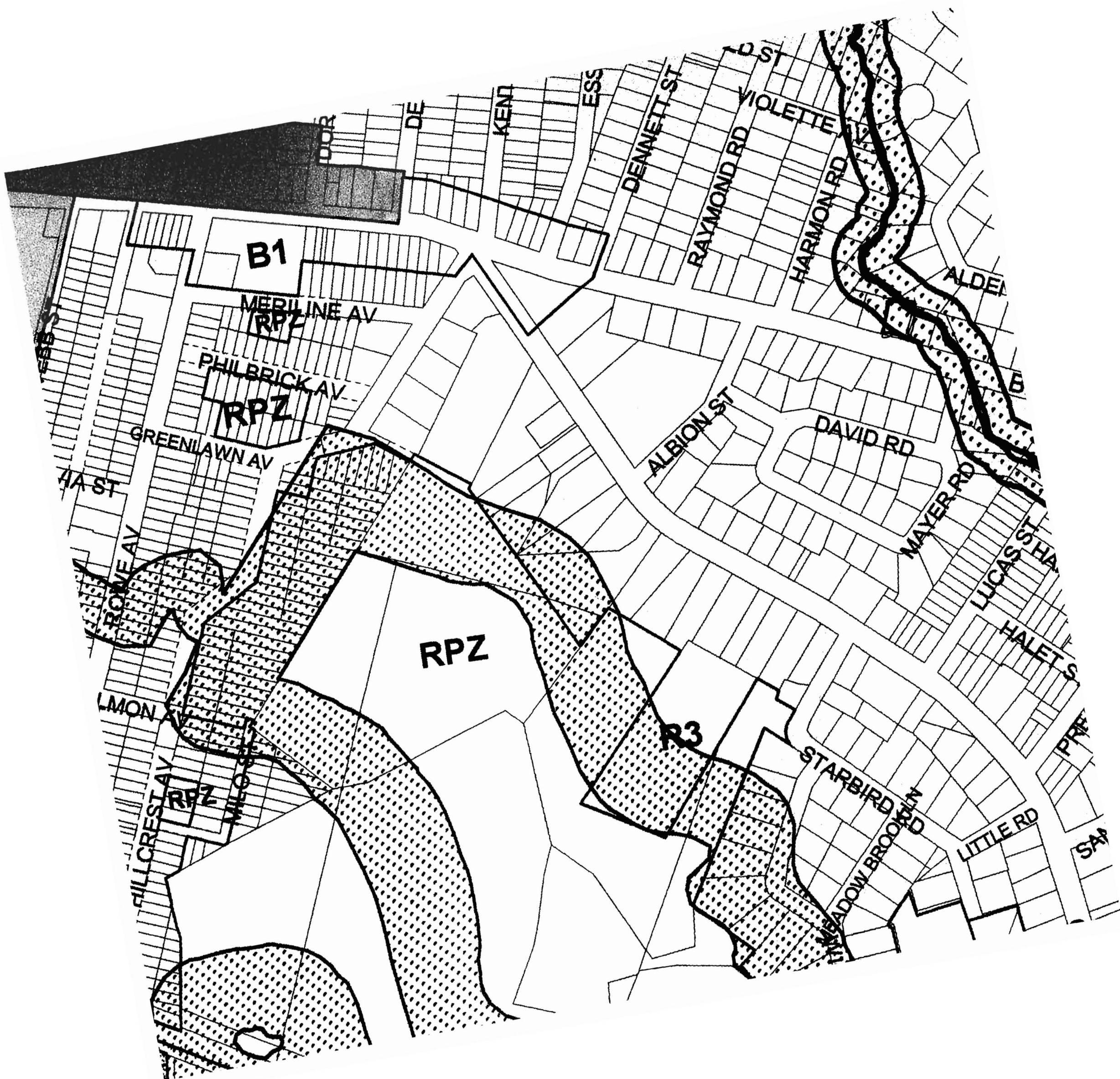

B1

MERILINE AV  
RPZ

PHILBRICK AV  
RPZ

GREENLAWN AV

RPZ

A3

RPZ

STARBIRD RD

MEADOW BROOK RD

LITTLE RD

SAY

DENNETT ST

RAYMOND RD

HARMON RD

ALBION ST

DAVID RD

MAYER RD

LUCAS ST

HALET ST

D ST

VIOLETTE

ALDEN

ST HA

PR

MON

HILL CREST AV

HA ST

ROCKE AV

DOOR

DE

KENT

ESS

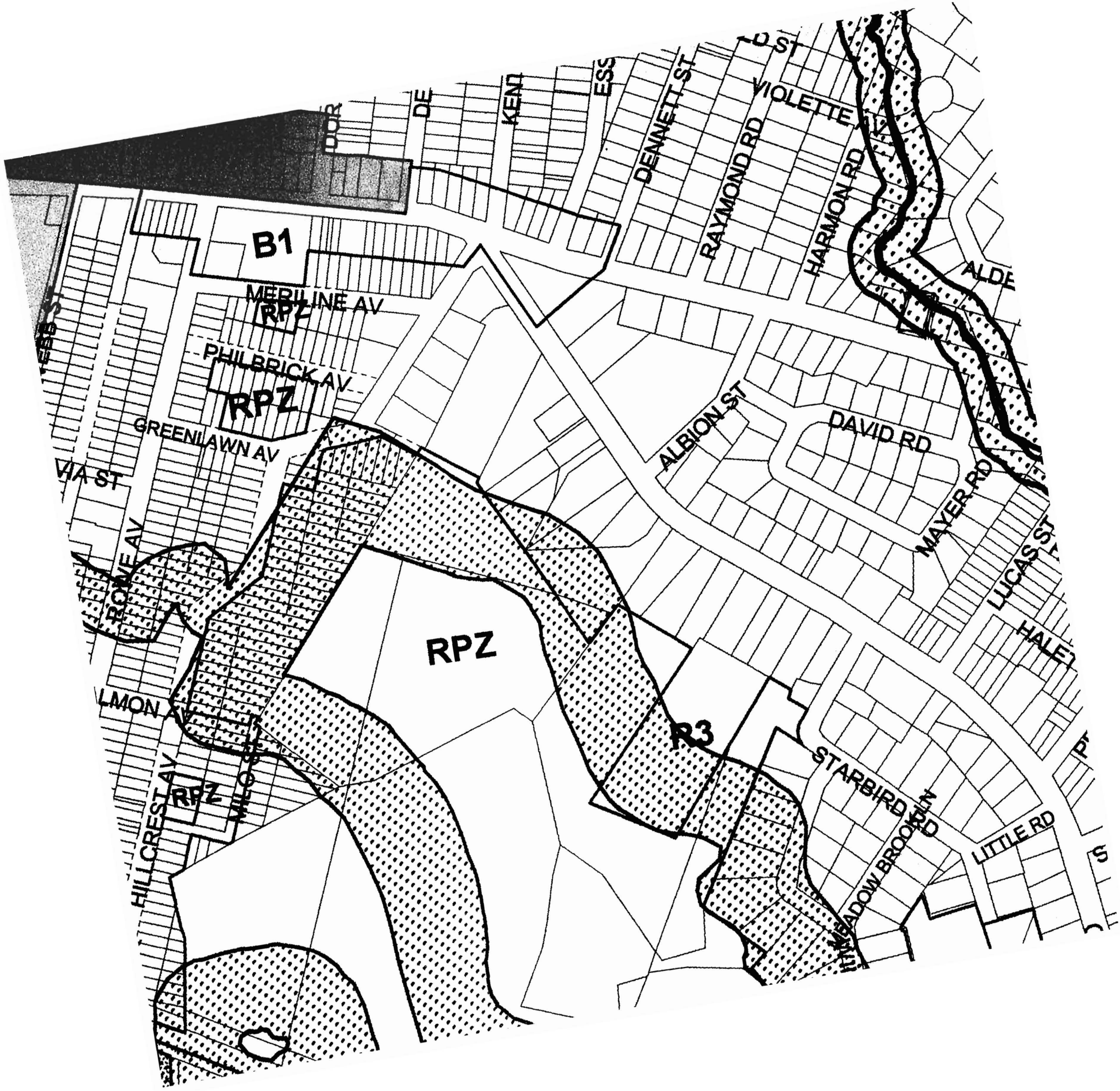

B1

MERILINE AV  
RPZ

PHILBRICK AV  
RPZ

GREENLAWN AV

RPZ

P3

STARBIRD RD

SHADOW BROOK RD

LITTLE RD

DOR  
DE  
KENT  
ESS  
DENNETT ST  
RAYMOND RD  
VIOLETTE  
HARMON RD  
ALDEN  
DAVID RD  
MAYER RD  
LUCAS ST  
HALE  
VIA ST  
ROME AV  
LIMON  
HILL CREST AV  
MILBURN