

DISPLAY THIS CARD ON PRINCIPAL FRONTAGE OF WORK CITY OF PORTLAND

BUILDING DEPARTMENT

PERMIT

Permit Number: 090360

Please Read
Application And
Notes, If Any,
Attached

This is to certify that GREENLAW DAVID & PATRICIA GREENLAW/Atlantic P
has permission to install a above ground pool 15' and 52" high
AT 13 DENNETT ST City of Portland 285 A003001

provided that the person or persons, firm or corporation accepting this permit shall comply with all of the provisions of the Statutes of Maine and of the Ordinances of the City of Portland regulating the construction, maintenance and use of buildings and structures, and of the application on file in this department.

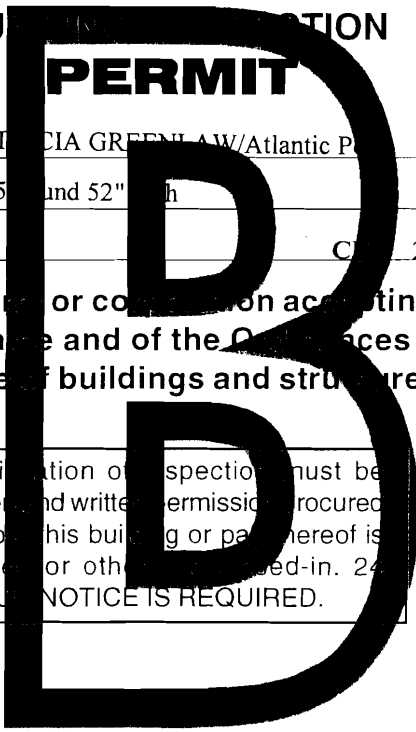

Apply to Public Works for street line and grade if nature of work requires such information.

Notification of inspection must be given and written permission procured before this building or part thereof is lathed or otherwise finished-in. 24 HOUR NOTICE IS REQUIRED.

A certificate of occupancy must be procured by owner before this building or part thereof is occupied.

OTHER REQUIRED APPROVALS

Fire Dept. _____
Health Dept. _____
Appeal Board _____
Other _____
Department Name

Chit 1/12 5/1/09
Director - Building & Inspection Services

PENALTY FOR REMOVING THIS CARD

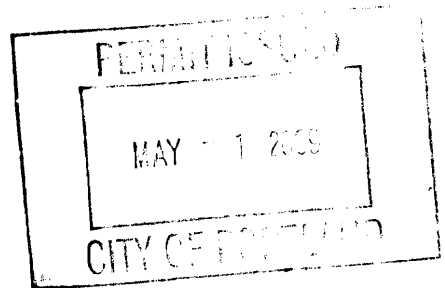

City of Portland, Maine - Building or Use Permit Application

389 Congress Street, 04101 Tel: (207) 874-8703, Fax: (207) 874-8716

Permit No: 09-0360	Issue Date: 5/1/09	CBL: 285 A003001
-----------------------	-----------------------	---------------------

Location of Construction: 13 DENNETT ST	Owner Name: GREENLAW DAVID & PATRICI	Owner Address: 13 DENNETT ST	Phone:
Business Name:	Contractor Name: Atlantic Pool	Contractor Address: 7 Union St. Biddeford	Phone 2072841505
Lessee/Buyer's Name	Phone:	Permit Type: Swimming Pools	Zone: R-3

Past Use: Single Family Home	Proposed Use: Single Family Home - install a above ground pool 15' round 52" high	Permit Fee: \$30.00	Cost of Work: \$600.00	CEO District: 3
Proposed Project Description: install a above ground pool 15' round 52" high		FIRE DEPT: <input type="checkbox"/> Approved <input type="checkbox"/> Denied	INSPECTION: Use Group: R-3 Type: 5B DEC-2003	
		Signature: <i>ch 5/1/09</i>		

PEDESTRIAN ACTIVITIES DISTRICT (P.A.D.)	
Action: <input type="checkbox"/> Approved <input type="checkbox"/> Approved w/Conditions <input type="checkbox"/> Denied	Signature: _____ Date: _____

Permit Taken By: Ldobson	Date Applied For: 04/24/2009	Zoning Approval
-----------------------------	---------------------------------	------------------------

<ol style="list-style-type: none"> This permit application does not preclude the Applicant(s) from meeting applicable State and Federal Rules. Building permits do not include plumbing, septic or electrical work. Building permits are void if work is not started within six (6) months of the date of issuance. False information may invalidate a building permit and stop all work.. 	Special Zone or Reviews <input type="checkbox"/> Shoreland <input type="checkbox"/> Wetland <input type="checkbox"/> Flood Zone <input type="checkbox"/> Subdivision <input type="checkbox"/> Site Plan <i>O.K.</i> Maj <input type="checkbox"/> Minor <input type="checkbox"/> MM <input type="checkbox"/> Date: <i>5/1/09</i>	Zoning Appeal <input type="checkbox"/> Variance <input type="checkbox"/> Miscellaneous <input type="checkbox"/> Conditional Use <input type="checkbox"/> Interpretation <input type="checkbox"/> Approved <input type="checkbox"/> Denied Date: _____	Historic Preservation <input type="checkbox"/> Not in District or Landmark <input checked="" type="checkbox"/> Does Not Require Review <input type="checkbox"/> Requires Review <input type="checkbox"/> Approved <input type="checkbox"/> Approved w/Conditions <input type="checkbox"/> Denied Date: <i>5/1/09 ch</i>
---	---	---	---

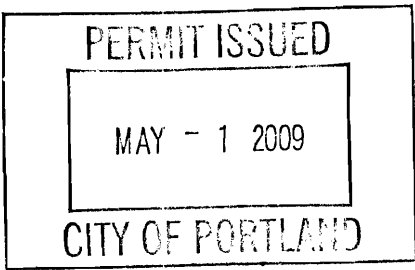

CERTIFICATION

I hereby certify that I am the owner of record of the named property, or that the proposed work is authorized by the owner of record and that I have been authorized by the owner to make this application as his authorized agent and I agree to conform to all applicable laws of this jurisdiction. In addition, if a permit for work described in the application is issued, I certify that the code official's authorized representative shall have the authority to enter all areas covered by such permit at any reasonable hour to enforce the provision of the code(s) applicable to such permit.

SIGNATURE OF APPLICANT	ADDRESS	DATE	PHONE
RESPONSIBLE PERSON IN CHARGE OF WORK, TITLE		DATE	PHONE

City of Portland, Maine - Building or Use Permit Application

389 Congress Street, 04101 Tel: (207) 874-8703, Fax: (207) 874-8716

Permit No: 09-0360	Issue Date: 5/1/09	CBL: 285 A003001
-----------------------	-----------------------	---------------------

Location of Construction: 13 DENNETT ST	Owner Name: GREENLAW DAVID & PATRICI	Owner Address: 13 DENNETT ST	Phone:
Business Name:	Contractor Name: Atlantic Pool	Contractor Address: 7 Union St. Biddeford	Phone 2072841505
Lessee/Buyer's Name	Phone:	Permit Type: Swimming Pools	Zone: R-3

Past Use: Single Family Home	Proposed Use: Single Family Home - install a above ground pool 15' round 52" high	Permit Fee: \$30.00	Cost of Work: \$600.00	CEO District: 3
Proposed Project Description: install a above ground pool 15' round 52" high		FIRE DEPT: <input type="checkbox"/> Approved <input type="checkbox"/> Denied	INSPECTION: Use Group: R-3 Type: 56 IRC-2003	
		Signature: _____		Signature: <i>ch 5/1/09</i>
PEDESTRIAN ACTIVITIES DISTRICT (P.A.D.)				
Action: <input type="checkbox"/> Approved <input type="checkbox"/> Approved w/Conditions <input type="checkbox"/> Denied				
Signature: _____ Date: _____				

Permit Taken By: Ldobson	Date Applied For: 04/24/2009	Zoning Approval
-----------------------------	---------------------------------	------------------------

- This permit application does not preclude the Applicant(s) from meeting applicable State and Federal Rules.
- Building permits do not include plumbing, septic or electrical work.
- Building permits are void if work is not started within six (6) months of the date of issuance. False information may invalidate a building permit and stop all work..

Special Zone or Reviews	Zoning Appeal	Historic Preservation
<input type="checkbox"/> Shoreland	<input type="checkbox"/> Variance	<input type="checkbox"/> Not in District or Landmark
<input type="checkbox"/> Wetland	<input type="checkbox"/> Miscellaneous	<input checked="" type="checkbox"/> Does Not Require Review
<input type="checkbox"/> Flood Zone	<input type="checkbox"/> Conditional Use	<input type="checkbox"/> Requires Review
<input type="checkbox"/> Subdivision	<input type="checkbox"/> Interpretation	<input type="checkbox"/> Approved
<input type="checkbox"/> Site Plan <i>OK</i>	<input type="checkbox"/> Approved	<input type="checkbox"/> Approved w/Conditions
Maj <input type="checkbox"/> Minor <input type="checkbox"/> MM <input type="checkbox"/>	<input type="checkbox"/> Denied	<input type="checkbox"/> Denied
Date: <i>5/1/09</i>	Date: _____	Date: <i>5/1/09 ch</i>

CERTIFICATION

I hereby certify that I am the owner of record of the named property, or that the proposed work is authorized by the owner of record and that I have been authorized by the owner to make this application as his authorized agent and I agree to conform to all applicable laws of this jurisdiction. In addition, if a permit for work described in the application is issued, I certify that the code official's authorized representative shall have the authority to enter all areas covered by such permit at any reasonable hour to enforce the provision of the code(s) applicable to such permit.

SIGNATURE OF APPLICANT	ADDRESS	DATE	PHONE
RESPONSIBLE PERSON IN CHARGE OF WORK, TITLE		DATE	PHONE

BUILDING PERMIT INSPECTION PROCEDURES

Please call 874-8703 or 874-8693 (ONLY)

to schedule your inspections as agreed upon

Permits expire in 6 months, if the project is not started or ceases for 6 months.

The Owner or their designee is required to notify the inspections office for the following inspections and provide adequate notice. Notice must be called in 48-72 hours in advance in order to schedule an inspection:

By initializing at each inspection time, you are agreeing that you understand the inspection procedure and additional fees from a "Stop Work Order" and "Stop Work Order Release" will be incurred if the procedure is not followed as stated below.

A Pre-construction Meeting will take place upon receipt of your building permit.

 X Final inspection required at completion of work.

 X Setback inspection prior to setting up pool walls showing proposed layout.

Certificate of Occupancy is not required for certain projects. Your inspector can advise you if your project requires a Certificate of Occupancy. All projects DO require a final inspection.

If any of the inspections do not occur, the project cannot go on to the next phase, REGARDLESS OF THE NOTICE OR CIRCUMSTANCES.

CERIFICATE OF OCCUPANICES MUST BE ISSUED AND PAID FOR, BEFORE THE SPACE MAY BE OCCUPIED.



Signature of Applicant/Designee

 4/31/09

Date

Signature of Inspections Official

Date



Pool Installation/Construction Permit Application

If you or the property owner owes real estate or personal property taxes or user charges on any property within the City, payment arrangements must be made before permits of any kind are accepted.

Location/Address of Construction: <u>13 Dennett St</u>		
Total Square Footage of Proposed Structure: <u>-</u>	Square Footage of Lot: <u>5000 sq'</u>	
Tax Assessor's Chart, Block & Lot Chart# <u>285</u> Block# <u>A</u> Lot# <u>3</u>	Owner: <u>David-Patricia Greenlaw</u>	Telephone: <u>207-761-2006</u>
Lessee/Buyer's Name (If Applicable): <u>-</u>	Applicant name, address & telephone: <u>David-Patricia Greenlaw</u> <u>13 Dennett St.</u> <u>Portland, Me. 04102</u>	Cost Of Work: \$ <u>600.00</u> Fee: \$ <u>30.00 city fee</u>
Dimensions of pool: <u>15' round 52" high</u> <input checked="" type="radio"/> above <input type="radio"/> or below ground: _____		
Dimensions of decking and/or any platforms, sheds, or other structures: _____		
APR 24 2009		
Contractor's name, address & telephone: <u>Don Ballard of Atlantic Pools 284-1505</u>		
Who should we contact when the permit is ready: <u>Dave Greenlaw</u>		
Mailing address: <u>13 Dennett St.</u> <u>Portland, Me. 04102</u>		
Phone: <u>329-8676 cell</u> <u>TX Cell</u>		

Please submit all of the information outlined in the pool application checklist. Failure to do so could result in the automatic denial of your permit.

In order to be sure the City fully understands the full scope of the project, the Planning and Development Department may request additional information prior to the issuance of a permit. For further information visit us on-line at www.portlandmaine.gov, stop by the Building Inspections office, room 315 City Hall or call 874-8703.

I hereby certify that I am the Owner of record of the named property, or that the owner of record authorizes the proposed work and that I have been authorized by the owner to make this application as his/her authorized agent. I agree to conform to all applicable laws of this jurisdiction. In addition, if a permit for work described in this application is issued, I certify that the Code Official's authorized representative shall have the authority to enter all areas covered by this permit at any reasonable hour to enforce the provisions of the codes applicable to this permit.

Signature of applicant: <u>David L. Greenlaw</u>	Date: <u>4-20-09</u>
--	----------------------

This is not a permit; you may not commence ANY work until the permit is issued.

Applicant: David Brennan

Date: 5/1/09

Address: 13 Dennett St.

C-B-L: 285-A-003

CHECK-LIST AGAINST ZONING ORDINANCE

Date - 5/1/09

Zone Location - R-3

Interior or corner lot -

Proposed Use/Work -

Sevage Disposal -

Lot Street Frontage - 50'

Front Yard - 25' ✓ O.K.

Rear Yard - 25' - 27' shown

Side Yard - 8' - 1 - 1/2

Projections - 14 - 2 17' shown O.K.

Width of Lot - 50' - Min - 65'

Height -

Lot Area -

Lot Coverage/ Impervious Surface -

Area per Family -

Off-street Parking -

Loading Bays -

Site Plan -

Shoreland Zoning/ Stream Protection -

Flood Plains -



Pool Installation/Construction Checklist

All of the following information is required and must be submitted. Checking off each item as you prepare your application package will ensure your package is complete and will help to expedite the permitting process.

- A plot plan showing the shape and dimension of the lot, footprint of the pool and its distance from the actual property lines, and the principal structure. Include any decks or accessory structures
- A complete set of plans that include structural details, size and dimensions and a cross section showing the slope and depth ratios, or for above ground pool, design specifications. Often this information can be obtained from the manufacturer.
- none A complete set of construction details for any accessory structures or decks including: pier or foundation layout, framing, fastenings, guards/handrails, baluster spacing and stair dimensions
- Details of required barrier protection including the design of fencing, gates, latches, ladders, or audible alarms (if applicable). Please show where they will be located and how they are constructed. This information can often be obtained from the manufacturer
- Proof of ownership is required if it is inconsistent with the assessors records

**All pool installations must be conducted in compliance with the
IRC 2003 Building Code Appendix G**

Separate permits are required for HVAC, and electrical installations.

Permit Fee: \$30.00 for the first \$1000.00 construction cost, \$9.00 per additional \$1000.00 cost

This is not a Permit; you may not commence any work until the Permit is issued.

POOL ENTRY SYSTEMS

Pro Series In-Pool Ladder

Reg. \$79.99

17345

Now Only
\$69⁹⁹

Save
\$10



31" Heavy Duty In-Pool Step

Reg. \$269.99 07007

Now Only
\$199⁹⁹

Save
\$70

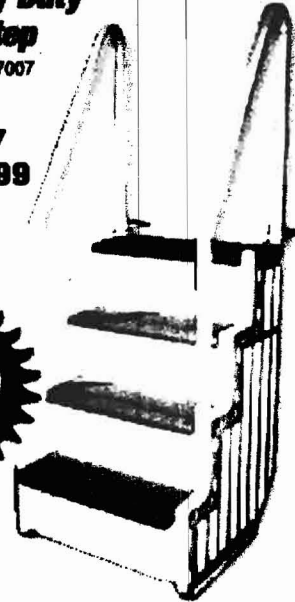

Safe & Secure Step System

Reg. \$579.99 07211

Now Only
\$499⁹⁹

Save
\$80



Combo Step & Gate

Reg. \$349.99 07051

Now Only
\$299⁹⁹

Save
\$50



these lift up & lock & gate covers & locks



5'x5' Resin Deck Platform

Reg. \$1,199.99 3179

Now Only
\$999⁹⁹

Save
\$200

Ladder Mats

9" x 24" Ladder Mat 03379

Now Only **\$7⁹⁹**

30" X 36" Step Mat 03409

Now Only **\$19⁹⁹**

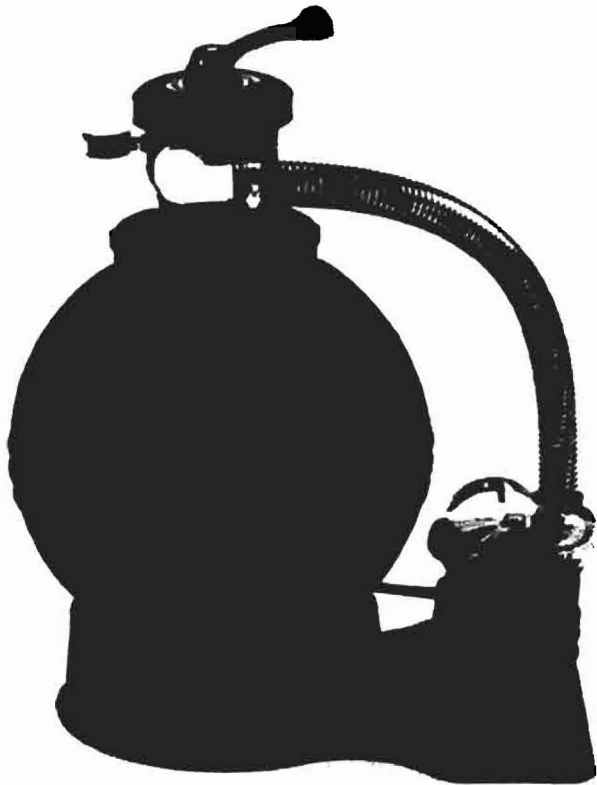

Proline Sand filter &
pump.

Electrician to install

TYPES OF FILTRATION

Water circulation is one of the most important elements to your pool. Adequate movement of the water is one of the best defenses against algae formation and cloudiness. There are basically three different types of filter systems: sand, cartridge and diatomaceous earth (D. E.). Each system is a good choice to filter the pool; however, they differ in operation and type of medium that actually filters the particles (medium refers to the actual sand, cartridge or D.E. that is inside the filter tank).

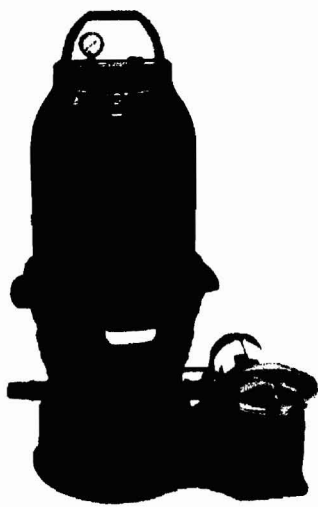

Circulation begins as water flows through the in- wall skimmer and down the first filter hose to the pump. Inside the pump housing, the impeller pushes the water into the filter tank. Inside the tank, dirt and debris are trapped in the filter medium (sand, cartridge or D.E.) The filtered water exits the tank, flows through the second filter hose and re-enters the pool through the pool wall return fitting.

Regardless of the type of filter system you have the length of time that your system should operate, run time, is the same. Single speed pumps should operate a minimum of 8 hours per day. Two-speed pumps are meant to run on continuous low-speed operation, filtering the water 24 hours per day. As dirt and debris accumulate within the medium of the filter tank the pressure gauge on the tank will begin to rise and the return flow of water going into the pool will simultaneously diminish. It is then time to backwash the filter. Refer to the operating instructions for each system type on the pages to follow. Be certain to read and follow all manufacturers' instructions on operation and winterizing prior to start-up.



PROLINE SAND FILTER

Replacement Parts Diagram

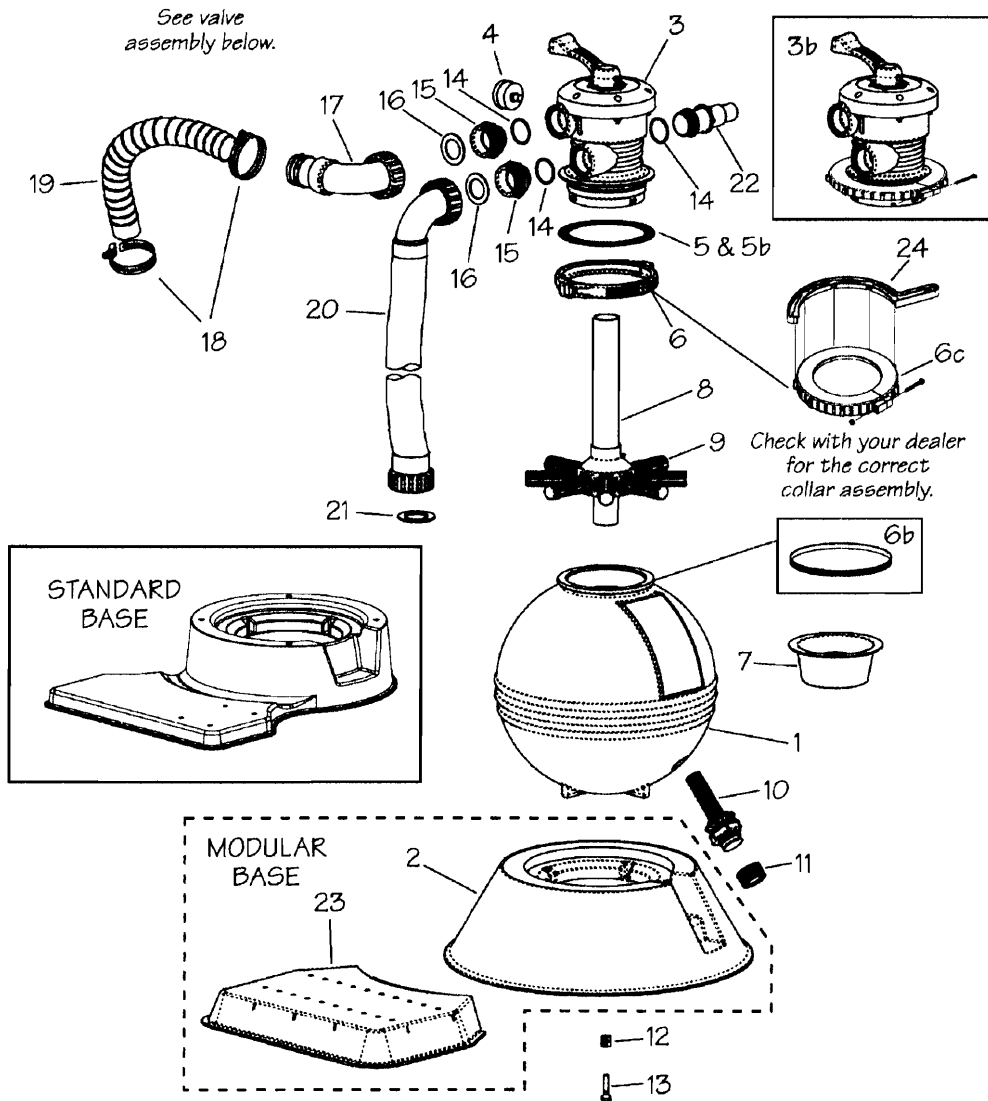

MULTI-PORT VALVE ASSEMBLY

HARD PLUMB OPTIONS

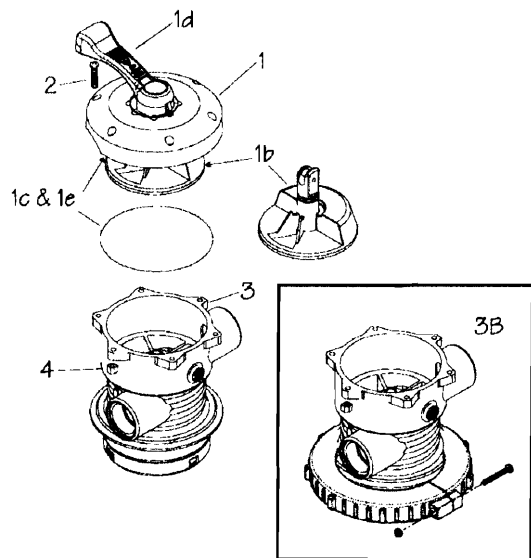
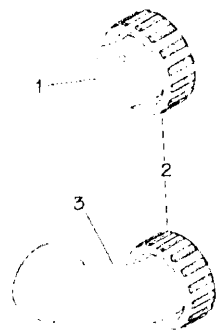

The Willow

WILLOW — Best family value under the sun!

The Willow is the affordable pool that will bring you happy memories for many years to come.

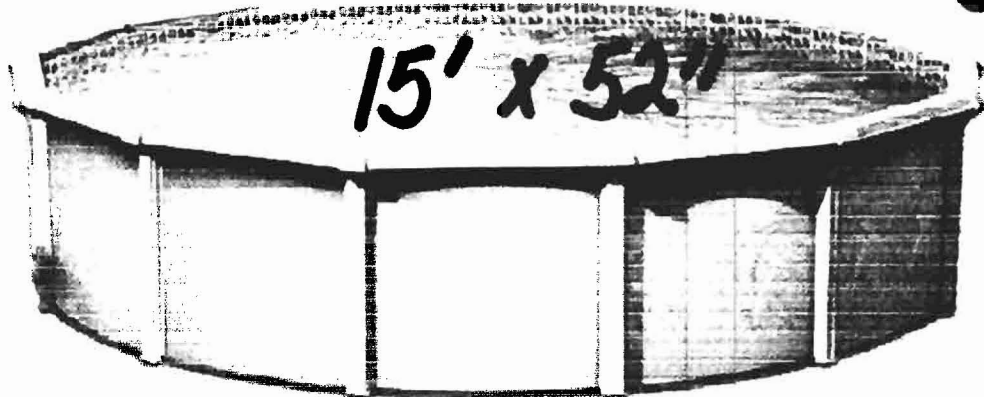

Features

- WALL HEIGHT 52"
- WALLS Willow Designer Steel Wall
- TOP SEATS 8" Deluxe Ribbed Steel
- VERTICALS 8" Deluxe Boxed Steel
- TRACKS 1" Steel Universal Top & Bottom Rails
- LINERS All-Weather Overlap Sand Print Liner
- SEAT COVER 2-Piece Resin Seat Cover
- PLATES Steel Universal Top & Bottom Plates

Available Sizes

- ROUND 15', 18', 21', 24', 27', 30'
- OVAL 12' x 8', 14' x 10', 20' x 15', 25' x 15', 30' x 15', 33' x 18'

Deck Options

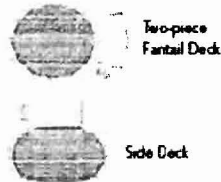

Purchased: 9/27/08 from Namco on 100 Larrabee Rd. Westbrook.

Picked up a few days later. Did not include the pump / filter package for an additional \$800.00. Does not include installation.

Regular price pool only \$1300.00 on sale for \$779.99 end of season sale. Plan to install spring of 2009.

