

74-75 211-11-11



SHANK WALKER

2nd cut # 920R - 4th cut # 9202R - 3rd cut # 9203R - 5th cut # 9205R



FILL IN AND SIGN WITH INK OE 948

APPLICATION FOR PERMIT FOR HEATING, COOKING OR POWER EQUIPMENT

PERMIT ISSUED AUG 13 1949

Portland, Maine, August 10th 1949

CITY OF PORTLAND

To the INSPECTOR OF BUILDINGS, PORTLAND, MAINE

The undersigned hereby applies for a permit to install the following heating, cooking or power equipment in accordance with the Laws of Maine, the Building Code of the City of Portland, and the following specifications:

Location 76 Kent St. Use of Building Dwelling No. Stories 2 Existing " Name and address of owner of appliance Alfred Densmore, 76 Kent St. Installer's name and address Ballard Oil & Equipment, 135 Marginal Way 2-1991

General Description of Work

To install One Fully Automatic Oil Burner in Steam Boiler to replace Timken Burner

IF HEATER, OR POWER BOILER

Location of appliance or source of heat Type of floor beneath appliance If wood, how protected? Kind of fuel Minimum distance to wood or combustible material, from top of appliance or casing top of furnace From top of smoke pipe From front of appliance From sides or back of appliance Size of chimney flue Other connections to same flue If gas fired, how vented? Rated maximum demand per hour

IF OIL BURNER

Name and type of burner Esso ECS1 Labelled by underwriter's laboratories? Yes Will operator be always in attendance? no Does oil supply line feed from top or bottom of tank Bottom Type of floor beneath burner Cement Location of oil storage Basement Number and capacity of tanks Use present one If two 275-gallon tanks, will three-way valve be provided? Will all tanks be more than five feet from any flame? yes How many tanks fire proofed? none Total capacity of any existing storage tanks for furnace burners 1 - 275

IF COOKING APPLIANCE

Location of appliance Kind of fuel Type of floor beneath appliance If wood, how protected? Minimum distance to wood or combustible material from top of appliance From front of appliance From sides and back From top of smokepipe Size of chimney flue Other connections to same flue Is hood to be provided? If so, how vented? If gas fired, how vented? Rated maximum demand per hour

MISCELLANEOUS EQUIPMENT OR SPECIAL INFORMATION

RECEIVED AUG 13 1949 DEPT. OF BLD'G. INSP. CITY OF PORTLAND

Amount of fee enclosed? \$2.00 (\$1.00 for one heater, etc., 50 cents additional for each additional heater, etc., in same building at same time.)

APPROVED: [Signature] 8-11-49

Will there be in charge of the above work a person competent to see that the State and City requirements pertaining thereto are observed? yes

Ballard Oil & Equipment Co.

Signature of Installer [Signature]

INSPECTION COPY

Permit No. 47/1268 ^{Sept. 9}
 Location 76th Kent St.
 Owner Albion Demaree
 Date of permit 8/13/49
 Approved 9/10/49 *[Signature]*
 NOTES

- 1 Fill Pipe
- 2 Vent Pipe
- 3 Kilowatt Heat 51
- 4 Burner Regulation Supply
- 5 Name & Label
- 6 Stack Guard
- 7 High Limit Control
- 8 Thermost Control
- 9 Piping Support & Protection
- 10 Valves in Supply Line
- 11 Capacity of Tanks 127.5
- 12 Tank Location & Support
- 13 Tank Discharge
- 14 Oil Gauge
- 15 Instruction Card
- 16 _____

8/22/49 - Nail cut - home #11
 8/21/49 - Same #11



FILL IN COMPLETELY AND SIGN WITH INK

Permit No. 13314

APPLICATION FOR PERMIT FOR HEATING, COOKING OR POWER EQUIPMENT

Portland, Maine, July 26, 1939

To the INSPECTOR OF BUILDINGS, PORTLAND, ME.

The undersigned hereby, applies for a permit to install the following heating, cooking or power equipment in accordance with the Laws of Maine, the Building Code of the City of Portland, and the following specifications:

Location 76 Kent St Use of Building Residential No. Stories New Building Existing Name and address of owner of appliance Direct Residence 76 Kent St Installer's name and address Randall 750 1/2 Ave - 2nd floor Telephone 32441

General Description of Work

To install

Hot Water in Existing Steam

IF HEATER, POWER BOILER OR COOKING DEVICE

Is appliance or source of heat to be in cellar? Yes If not, which story Kind of Fuel Material of supports of appliance (concrete floor or what kind) Concrete Minimum distance to wood or combustible material, from top of appliance or casing top of furnace, from top of smoke pipe from front of appliance from sides or back of appliance Size of chimney flue Other connections to same flue

IF OIL BURNER

Name and type of burner Trunkman Labeled and approved by Underwriters' Laboratories? Yes Will operator be always in attendance? Type of oil feed (gravity or pressure) Gravity Location oil storage Basement No. and capacity of tanks 1-275 Gallon Will all tanks be more than seven feet from any flame? No How many tanks fireproofed?

Amount of fee enclosed? 1.00 (\$1.00 for one heater, etc., 50 cents additional for each additional heater, etc., in same building at same time.)

Signature of Installer

Handwritten signature

INSPECTION COPY

74-76

Permit No. 39/1108

Location 76 Kent St

Owner Alfred Danmore

Date of Permit 7/26/39.

Post Card sent

Notif. for insp. None

Approval Tax issued 8/18/39. etc.

Oil Burner Check List (date) 7/26/39.

1. Kind of heat Steam

2. Label

3. Anti-siphon

4. Oil storage

5. Tank distance

6. Vent Pipe

7. Fill Pipe

8. Gauge

9. Rigidity

10. Feed safety

11. Pipe sizes and material

12. Control valve

13. Ash pit vent

14. Temp. or pressure safety

15. Instruction card

16. Draft Station corrected

NOTES



FILL IN COMPLETELY AND SIGN WITH INK

Permit No. 2093
PERMIT ISSUED

APPLICATION FOR PERMIT FOR HEATING, COOKING OR POWER EQUIPMENT

Portland, Maine, DEC 6 1938

To the INSPECTOR OF BUILDINGS, PORTLAND, ME.

The undersigned hereby applies for a permit to install the following heating, cooking or power equipment in accordance with the Laws of Maine, the Building Code of the City of Portland, and the following specifications:

Location 76 Kent Street Use of Building dwelling house No. Stories 2

Name and address of owner Fossett & Bertelsen, 26 Kent Street Ward 9

Contractor's name and address Owner Telephone 4-4892

General Description of Work

To install steam heating system

IF HEATER, POWER BOILER OR COOKING DEVICE

Is heater or source of heat to be in cellar? yes If not, which story _____ Kind of Fuel coal

Material of supports of heater or equipment (concrete floor or what kind) concrete

Minimum distance to wood or combustible material, from top of boiler or casing top of furnace, 18"

from top of smoke pipe 2', from front of heater 4' from sides or back of heater 3'

Size of chimney flue 8x12 Other connections to same flue stove

IF OIL BURNER

Name and type of burner _____ Labeled and approved by Underwriters' Laboratories? _____

Will operator be always in attendance? _____ Type of oil feed (gravity or pressure) _____

Location oil storage _____ No. and capacity of tank _____

Will all tanks be more than seven feet from any flame? _____ How many tanks fire-proofed? _____

Amount of fee enclosed? 1.00 (\$1.00 for one heater, etc., 50 cents additional for each additional heater, etc., in same building at same time.)
Fossett & Bertelsen

Signature of contractor Carl G. Burtson

INSPECTION COPY

3871424
Permit No 3872098
Location 76 Kent St.
Owner Fursell & Bertelsen
Date of permit 12/6/38

Post Card sent

Notif. for insp.

Approval Tag issued 5/11/39

Oil Burner Check List (date)

1. Kind of burner
2. Label
3. Anti-siphon
4. Oil storage
5. Tank distance
6. Vent pipe
7. Fill pipe
8. Gauge
9. Rigidity
10. Fuel safety
11. Pipe sizes and material
12. Control valve
13. Ash pit vent
14. Temp. or pressure safety
15. Instruction card
- 16.

NOTES

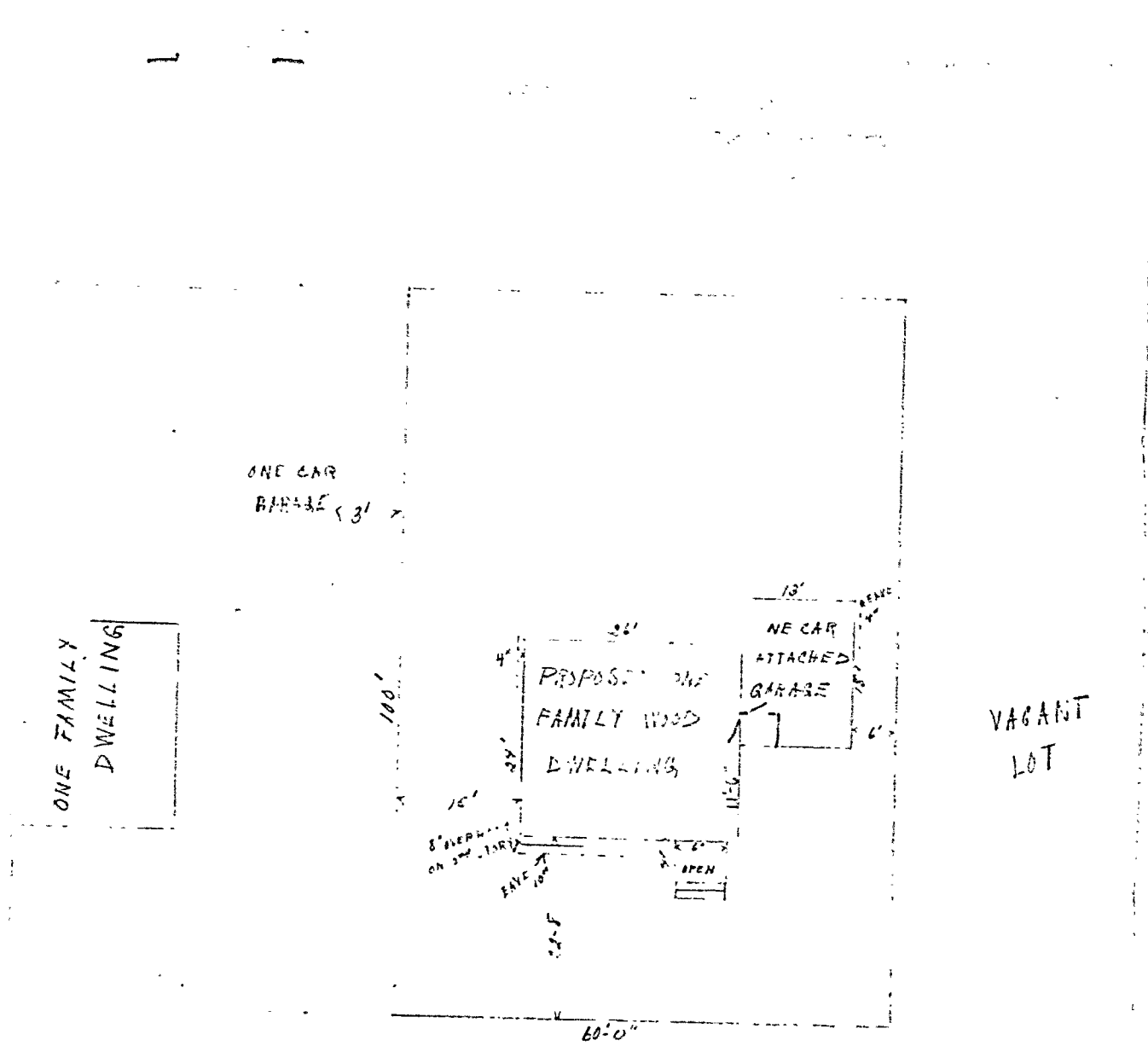

← BRIGHTON AVE.

#74-76 KENT ST.

STATEMENT ACCOMPANYING APPLICATION FOR BUILDING PERMIT

for a family dwelling and 1 car garage attached
at 1234 1st Street

Date 10/2/38

Marked P. Forsyth, Carl E. Berntsen

1. ... whose name is in the title of the property now recorded.
2. Are the boundaries of the property in the vicinity of the proposed work shown clearly on the ground, and how? stake
3. Is the outline of the proposed work now staked out upon the ground? yes If not, will you notify the Inspection Office when the work is staked out and before any of the work is commenced? _____
4. What is to be maximum projection or overhang of eaves or drip? 14"
5. Do you assume full responsibility for the correctness of the location plan or statement of location filed with this application, and does it show the complete outline of the proposed work on the ground, including bay windows, porches, and other projections? yes
6. Do you assume full responsibility for the correctness of all statements in the application concerning the sizes, design and use of the proposed building? yes
7. Do you understand that in case changes are proposed in the location of the work or in any of the details specified in the application that a revised plan and application must be submitted to this office before the changes are made? yes

Marked P. Forsyth
by Carl E. Berntsen



APPLICATION FOR PERMIT Permit No. 1921
 (—ss of Building or Type of Structure Third Class)

Portland, Maine, November 2, 1938

To the INSPECTOR OF BUILDINGS, PORTLAND, ME.

The undersigned hereby applies for a permit to erect ~~and alter~~ the following building ~~in accordance with the Laws of the State of Maine, the Building Code of the City of Portland, plans and specifications, if any, submitted herewith and the following specifications:~~

Location 74-76 Kent Street Ward _____ Within Fire Limits? no Dist. No. _____
 Owner's ~~name~~ name and address Fossett & Fertelsen, 26 Kent Street Telephone 1-1312
 Contractor's name and address Omer Telephone _____
 Architect _____ Plans filed yes No. of sheets 1
 Proposed use of building Dwelling with 1 car garage attached No. families 1
 Other buildings on same lot garage
 Estimated cost \$1000. Fee \$ 1.25
 \$ 0.50 gar. = \$ 1.75

Description of Present Building to be Altered

Material _____ No. stories _____ Heat _____ Style of roof _____ Roofing _____
 Last use _____ No. families _____

General Description of New Work

1 family
 To construct ~~erect~~ frame dwelling 24' x 26' with one car garage attached

The inside of the garage will be covered, where required by law, with perforated gypsum lath covered with one-half inch thickness of gypsum plaster.

It is understood that this permit does not include installation of heating apparatus which is to be taken out separately by and in the name of the heating contractor.

hemlock dressed Details of New Work

Size, front 26' depth 24' No. stories 2 Height average grade to top of plate 18'
 Height average grade to highest point of roof 26'
 To be erected on solid or filled land? solid earth or rock? earth
 Material of foundation concrete Concrete trench wall under garage 8"
 Thickness, top 10" bottom 12"
 Material of underpinning brick Height 17 1/2" Thickness 8"
 Kind of Roof pitch Rise per foot 8" Roof covering asphalt roofing Class C Und. Lab.
 No. of chimneys 1 Material of chimneys brick of lining tile
 Kind of heat stove Type of fuel coal Is gas fitting involved? no
 Corner posts 4x6 Sills 4x6 Girt or ledger board? girt Size 2-2x4
 Material columns under girders iron posts Size 4" Max. on centers 8'
 Studs (outside walls and carrying partitions) 2x4-16" O. C. Girders 6x8 or larger Bridging in every floor and flat roof
 span over 8 feet. Sills and corner posts all one piece in cross section. stairway
 Joists and rafters: 1st floor 2x8, 2nd 2x8, 3rd 2x6, roof 3x6
 On centers: 1st floor 16", 2nd 16", 3rd 24", roof 18" 24"
 Maximum span: 1st floor 13', 2nd 13', 3rd 11', roof _____
 If one story building with masonry walls, thickness of walls? _____ height? _____

If a Garage

No. cars now accommodated on same lot none, to be accommodated 1
 Total number commercial cars to be accommodated none
 Will automobile repairing be done other than minor repairs to cars habitually stored in the proposed building? no

Miscellaneous

Will above work require removal or disturbing of any shade tree on a public street? no
 Will there be in charge of the above work a person competent to see that the State and City requirements pertaining thereto are observed? yes
Fossett & Fertelsen

Signature of owner: Karl S. Fossett

INSPECTION COPY

William D. ...
 CHIEF OF FIRE DEPT.

33130

Ward Permit No. 3811924
 Location 74-76 West Street
 Of Josselt + Bertelsen
 Date of permit 11/3/38
 Notif. closing-in 2/7/39 - 12/7/38
 Int. closing-in 2/8/39 - 3/5/39
 Final Notif. 5/11/39
 Final in. pt. 6/2/39 - O.K.
 Cert. of Occupancy issued 6/3/39

NOTES

11/2/38 - Labingout, O.K.
 11/10/38 - Foundation
 wall toward B.C.
 11/22/38 - Underpinning
 on - A.G.S.
 11/30/38 - No change - A.G.S.
 12/5/38 - Same - A.G.S.
 12/16/38 - Framing built
 along A.G.S.
 12/23/38 - Working on
 chimney - A.G.S.
 1/3/39 - Work well along
 on - A.G.S.
 1/10/39 - Work progressing
 slowly - A.G.S.
 1/17/39 - More work on
 chimney - A.G.S.

1/25/39 - Pouring collar
 floor - A.G.S.
 2/8/39 - Finishing on outside
 walls at first floor level
 Firestop around chimney
 at first floor
 Finishing back of Firestop
 between chimney and
 main partition top of
 2nd floor which is in
 floor joist between stairs
 I study space beside
 chimney and floor -
 Mr. Bertelsen says he
 will take care of these
 matters. Check on fire
 stop in basement on
 level - A.G.S.
 5/11/39 - Firestop around
 soil stack in basement.
 Firestop made above soil
 in basement where floor joist
 has run parallel to it.
 Plastering on wall of
 garage side of Mr. Bertel
 sen says he will
 take care of above
 mention - A.G.S.
 5/24/39 - Garage not yet

11/2/38 - A.G.S.
 11/10/38 - A.G.S.
 11/22/38 - A.G.S.
 11/30/38 - A.G.S.
 12/5/38 - A.G.S.
 12/16/38 - A.G.S.
 12/23/38 - A.G.S.
 1/3/39 - A.G.S.
 1/10/39 - A.G.S.
 1/17/39 - A.G.S.
 1/24/39 - A.G.S.

PERMIT # 001940 CITY OF Portland BUILDING PERMIT APPLICATION MAP # _____ LOT# _____

Please fill out any part which applies to job. Proper plans must accompany form.

Owner: Scott J. Murray
 Address: 76- Kent Street Pld. 772-0796
 LOCATION OF CONSTRUCTION: 76 Kent St
 CONTRACTOR: Kager Hitchens SUBCONTRACTORS: 761-5636
 ADDRESS: _____

Est. Construction Cost: 15,000. Type of Use: single family
 Past Use: _____
 Building Dimensions: L _____ W _____ Sq. Ft. _____ # Stories: _____ Lot Size: _____
 Is Proposed Use: _____ Seasonal _____ Condominium _____ Apartment _____
 Conversion - Explain construction, a new addition as per plans

COMPLETE ONLY IF THE NUMBER OF UNITS WILL CHANGE
 Residential Buildings Only:
 # Of Dwelling Units _____ # Of New Dwelling Units _____

Foundation:
 1. Type of Soil: _____
 2. Set Backs - Front _____ Rear _____ Side(s) _____
 3. Footings Size: _____
 4. Foundation Size: _____
 5. Other: _____

Floor:
 1. Sills Size: _____ Sills must be anchored.
 2. Girder Size: _____
 3. Lally Column Spacing: _____ Size: _____
 4. Joists Size: _____ Spacing 16" O.C.
 5. Bridging Type: _____ Size: _____
 6. Floor Sheathing Type: _____ Size: _____
 7. Other Material: _____

Exterior Walls:
 1. Studding Size _____ Spacing _____
 2. No. windows _____
 3. No. Doors _____
 4. Header Sizes _____ Span(s) _____
 5. Bracing: Yes _____ No _____
 6. Corner Post Size _____
 7. Insulation Type _____ Size _____
 8. Sheathing Type _____ Size _____
 9. Siding Type _____ Weather Exposure _____
 10. Masonry Materials _____
 11. Metal Materials _____

Interior Walls:
 1. Studding Size _____ Spacing _____
 2. Header Sizes _____ Span(s) _____
 3. Wall Covering Type _____
 4. Fire Wall if required _____
 5. Other Materials _____

**PERMIT ISSUED
 WITH LETTER**

PS-11-4 White-Tax Assessor

For Official Use Only

Date: APR 11 1989 Subdivision: Yes No
 Inside Fire Limits: _____ Name: _____
 Bldg Code: _____ Use: _____
 Time Limit: _____ Block: _____
 Estimated Cost: 12,000 Permit Expiration: _____
 Use/Structure: _____ Ownership: _____ Public _____ Private _____
 Fee: 95.00

Ceiling:
 1. Ceiling Joists Size: _____
 2. Ceiling Strapping Size _____ Spacing _____
 3. Type Ceiling: _____ **PERMIT ISSUED**
 4. Insulation Type _____
 5. Ceiling Height: _____

Roof:
 1. Truss or Rafter Size _____
 2. Sheathing Type _____
 3. Roof Covering Type _____
 4. Other: _____

Chimneys:
 Type: _____ Number of Fire Places _____

Heating:
 Type of Heat: _____

Electrical:
 Service Entrance Size: _____ Smoke Detector Required Yes No

Plumbing:
 1. Approval of soil test if required Yes No
 2. No. of Tubs or Showers 00.00
 3. No. of Flushes _____
 4. No. of Lavatories _____
 5. No. of Other Fixtures 00.00

Swimming Pools:
 1. Type: _____
 2. Pool Size: _____ x _____ Square Footage _____
 3. Must conform to National Electrical Code and State Law.

Zoning:
 District: _____ Street Frontage Req: _____ Provided: _____
 Required Setbacks: Front _____ Back _____ Side _____

Review Required:
 Zoning Board Approval: Yes No Date: _____
 Planning Board Approval: Yes No Date: _____
 Conditional Use: _____ Variance _____ Site Plan _____ Subdivision _____
 Shore and Floodplain Mgmt _____ Special Exception _____
 Other (Explain): _____
 Date Approved: _____

Permit Received By: Deborah Goode

Signature of Applicant: Scott J. Murray Date: 4/11/89

Signature of CEO: _____ Date: _____

Section Dates: _____

White Tag: CEO _____ © Copyright GPCOG 1987

PLOT PLAN

4/21 - No work yet
4/28 - Foundation/attachs ok
6/14 - Framing ok
6/24 - ~~Completed~~ ok



FEES (Breakdown From Front)

Base Fee \$ 25.00
Subdivision Fee \$ _____
Site Plan Review Fee \$ _____
Other Fees \$ 70.00
(Explain) _____
Late Fee \$ _____

Inspection Record

Type	Date
_____	____/____/____
_____	____/____/____
_____	____/____/____
_____	____/____/____
_____	____/____/____

COMMENTS

Signature of Applicant Scott J. Murray

Date 4-11-89



CITY OF PORTLAND, MAINE

389 CONGRESS STREET
PORTLAND, MAINE 04101
(207) 874- 8300

DEPARTMENT OF PLANNING & URBAN DEVELOPMENT

P. SAMUEL HOFFSES, CHIEF
INSPECTION SERVICES DIVISION

76 Kent Street

April 12, 1989

Mr. Scott J. Murray
76 Kent Street
Portland, Maine 04102

Dear Mr. Murray:

This is in response to your application for a building permit for an addition and deck for your residence in the R-3 Residence Zone. We have reviewed your plot plan for this proposed project and wish to advise you that the side yard setback for your addition and deck must be a minimum of 14 feet side yard due to the fact that the principal building is two stories in height.

Please therefore amend your plot plan to show the 14 foot side yard for both the proposed addition and the proposed deck.

Sincerely,

William D. Giroux
Zoning Enforcement Officer

cc: P. Samuel Hoffses, Chief, Inspection Services
Kathleen Taylor, Code Enforcement Officer
Warren J. Turner, Administrative Assistant

PERMIT # 001940 CITY OF Portland BUILDING PERMIT APPLICATION MAP # LOT #

Please fill out any part which applies to job. Proper plans must accompany form.

Owner: Scott J. Murray
 Address: 76- Kent Street Pctd. 772-0796
 LOCATION OF CONSTRUCTION 76 Kent St
 CONTRACTOR: Roger Hutchins SUBCONTRACTORS: 761-5636
 ADDRESS: _____

Est. Construction Cost: 15,000. Type of Use: single family
 Past Use: _____
 Building Dimensions L W Sq. Ft. # Stories Lot Size: _____
 Is Proposed Use: _____ Seasonal _____ Condominium _____ Apartment _____
 Conversion - Explain constructing a new addition as per plans

COMPLETE ONLY IF THE NUMBER OF UNITS WILL CHANGE
 Residential Buildings Only:
 # Of Dwelling Units _____ # Of New Dwelling Units _____

Foundation:
 1. Type of Soil: _____
 2. Set Backs - Front _____ Rear _____ Side(s) _____
 3. Footings Size: _____
 4. Foundation Size: _____
 5. Other _____

Floor:
 1. Sills Size: _____ Sills must be anchored.
 2. Girder Size: _____
 3. Lally Column Spacing: _____ Size: _____
 4. Joists Size: _____ Spacing 16" O.C.
 5. Bridging Type: _____ Size: _____
 6. Floor Sheathing Type: _____ Size: _____
 7. Other Material: _____

Exterior Walls:
 1. Studding Size _____ Spacing _____
 2. No. windows _____
 3. No. Doors _____
 4. Header Sizes _____ Span(s) _____
 5. Bracing: Yes _____ No _____
 6. Corner Posts Size _____
 7. Insulation Type _____ Size _____
 8. Sheathing Type _____ Size _____
 9. Siding Type _____ Weather Exposure _____
 10. Masonry Materials _____
 11. Metal Materials _____

Interior Walls:
 1. Studding Size _____ Spacing _____
 2. Header Sizes _____ Span(s) _____
 3. Wall Covering Type _____
 4. Fire Wall if required _____
 5. Other Materials _____

For Official Use Only

Date: <u>April 11, 1989</u>	Subdivision: Yes / No _____
Inside Fire Limits _____	Name _____
Bldg Code: _____	Lot _____
Time Limit: _____	Block _____
Estimated Cost: <u>15,000</u>	Permit Expiration: _____
Value/Structure _____	Ownership: _____ Public _____ Private _____
Fee: <u>95.00</u>	

Ceiling:
 1. Ceiling Joists Size: _____
 2. Ceiling Strapping Size _____ Spacing _____
 3. Type Ceilings: _____
 4. Insulation Type _____ Size _____
 6. Ceiling Height: _____

Roof:
 1. Truss or Rafter Size _____ Span _____
 2. Sheathing Type _____ Size _____
 3. Roof Covering Type _____
 4. Other _____

Chimneys:
 Type: _____ Number of Fire Places _____

Heating:
 Type of Heat: _____

Electrical:
 Service Entrance Size: _____ Smoke Detector Required Yes _____ No _____

Plumbing:
 1. Approval of soil test if required Yes _____ No _____
 2. No. of Tubs or Showers _____
 3. No. of Flushes _____
 4. No. of Lavatories _____
 5. No. of Other Fixtures _____

Swimming Pools:
 1. Type: _____
 2. Pool Size: _____ x _____ Square Footage _____
 3. Must conform to National Electrical Code and State Law.

Zoning:
 District _____ Street Frontage Req. _____ Provided _____
 Required Setbacks: Front _____ Back _____ Side _____ Side _____

Review Required:
 Zoning Board Approval: Yes _____ No _____ Date: _____
 Planning Board Approval: Yes _____ No _____ Date: _____
 Conditional Use: _____ Variance _____ Site Plan _____ Subdivision _____
 Shore and Floodplain Mgmt. _____ Special Exception _____
 Other (Explain) _____
 Date Approved _____

Permit Received By Deborah Goode
 Signature of Applicant Scott J. Murray Date 4/11/89
 Signature of CEO (S)KT Date _____
 Inspection Dates _____

PLUMBING APPLICATION

Department of Human Services
Division of Health Engineering
(207) 289-3826

PROPERTY ADDRESS

Town Or Plantation: Portland, Me
Street: 76 Kent St
Subdivision Lot #

PROPERTY OWNERS NAME

Last: McIntyre First: Scott
Applicant Name: W. J. McIntyre
Mailing Address of Owner/Applicant (if Different): 25600 Ave

PORTLAND PERMIT # 3,505 TOWN COPY

Date Permit Issued: 7.13.89 \$ 1910.00 FEE Double Fee Charged

Local Plumbing Inspector Signature: _____ L.P.I. # 11213

Owner/Applicant Statement

I certify that the information submitted is correct to the best of my knowledge and understand that any falsification is reason for the Local Plumbing Inspector to deny a Permit.

Signature of Owner/Applicant: W. J. McIntyre Date: 7/13/89

Caution: Inspection Required

I have inspected the installation authorized above and found it to be in compliance with the Maine Plumbing Rules.

Local Plumbing Inspector Signature: _____

Date Approved: JUL 13 1989

PERMIT INFORMATION

This Application is for	Type Of Structure To Be Served:	Plumbing To Be Installed By:
1. <input checked="" type="checkbox"/> NEW PLUMBING	1. <input checked="" type="checkbox"/> SINGLE FAMILY DWELLING	1. <input type="checkbox"/> MASTER PLUMBER
2. <input type="checkbox"/> RELOCATED PLUMBING	2. <input type="checkbox"/> MODULAR OR MOBILE HOME	2. <input type="checkbox"/> OIL BURNER/MAN
	3. <input type="checkbox"/> MULTIPLE FAMILY DWELLING	3. <input type="checkbox"/> MFG'D. HOUSING DEALER/MECHANIC
	4. <input type="checkbox"/> OTHER - SPECIFY: _____	4. <input type="checkbox"/> PUBLIC UTILITY EMPLOYEE
		5. <input type="checkbox"/> PROPERTY OWNER
		LICENSE # <u>15986</u>

Hook-Up & Piping Relocation Maximum of 1 Hook-Up	Column 2 Type of Fixture		Column 1 Type of Fixture	
	Number	Type of Fixture	Number	Type of Fixture
HOOK-UP: to public sewer in those cases where the connection is not regulated and inspected by the local Sanitary District. OR HOOK-UP: to an existing subsurface wastewater disposal system.		Hosebibb / Sillcock		Bathtub (and Shower)
		Floor Drain		Shower (Separate)
		Urinal		Sink
		Drinking Fountain		Wash Basin
		Indirect Waste		Water Closet (Toilet)
		Water Treatment Softener, Filter, etc.		Clothes Washer
PIPING RELOCATION: of sanitary lines, drains, and piping without new fixtures.		Grease/Oil Separator		Dish Washer
		Dental Cuspidor		Garbage Disposal
		Bidet		Laundry Tub
Number of Hook-Ups & Relocations		Other: _____		Water Heater
\$ Hook-Up & Relocation Fee		Fixtures (Subtotal) Column 2		Fixtures (Subtotal) Column 1
			3	Fixtures (Subtotal) Column 2
				Total Fixtures
				Permit Fee
				Hook-Up & Relocation Fee
			9	

SEE PERMIT FEE SCHEDULE FOR CALCULATING FEE



APPLICATION FOR PERMIT
DEPARTMENT OF BUILDING INSPECTIONS SERVICES
ELECTRICAL INSTALLATIONS

Date July 26, 1989, 19
 Receipt and Permit number 01538

To the CHIEF ELECTRICAL INSPECTOR, Portland, Maine:

The undersigned hereby applies for a permit to make electrical installations in accordance with the laws of Maine, the Portland Electrical Ordinance, the National Electrical Code and the following specifications:

LOCATION OF WORK: 76 Kent St
 OWNER'S NAME: Scott Murray ADDRESS: 76 Kent St

	FEES
OUTLETS:	
Receptacles <u>14</u> Switches <u>7</u> Plugmold _____ ft. TOTAL <u>21</u>	3.00
FIXTURES: (number of)	
Incandescent <u>8</u> Fluorescent _____ (not strip) TOTAL <u>8</u>	3.00
Strip Fluorescent _____ ft.	
SERVICES:	
Overhead _____ Underground _____ Temporary _____ TOTAL amperes _____	
METERS: (number of)	
MOTORS: (number of)	
Fractional	
1 HP or over	
RESIDENTIAL HEATING:	
Oil or Gas (number of units)	
Electric (number of rooms)	
COMMERCIAL OR INDUSTRIAL HEATING:	
Oil or Gas (by a main boiler)	
Oil or Gas (by separate units)	
Electric Under 20 kws _____ Over 20 kws _____	
APPLIANCES: (number of)	
Ranges _____	Water Heaters _____
Cook Tops _____	Disposals _____
Wall Ovens _____	Dishwashers _____
Dryers _____	Compactors _____
Fans _____	Others (denote) _____
TOTAL <u>2</u>	3.00
MISCELLANEOUS: (number of)	
Branch Panels	
Transformers	
Air Conditioners Central Unit	
Separate Units (windows)	
Signs 20 sq. ft. and under	
Over 20 sq. ft.	
Swimming Pools Above Ground	
In Ground	
Fire/Burglar Alarms Residential	
Commercial	
Heavy Duty Outlets, 220 Volt (such as welders) 30 amps and under	
over 30 amps	
Circus, Fairs, etc.	
Alterations to wires	
Repairs after fire	
Emergency Lights, battery	
Emergency Generators	
FOR ADDITIONAL WORK NOT ON ORIGINAL PERMIT	INSTALLATION FEE DUE:
FOR REMOVAL OF A "STOP ORDER" (304-16.b)	DOUBLE FEE DUE:
	TOTAL AMOUNT DUE: <u>9.00</u>

INSPECTION:
 Will be ready on _____, 19__; or Will Call XX
CONTRACTOR'S NAME: Scott Kent
ADDRESS: 76 Kent Street
TEL.: 772-0796
MASTER LICENSE NO.: _____ **SIGNATURE OF CONTRACTOR:**
LIMITED LICENSE NO.: _____ *Scott Kent*



APPLICATION FOR PERMIT
DEPARTMENT OF BUILDING INSPECTIONS SERVICES
ELECTRICAL INSTALLATIONS

Date July 26, 1989, 19
 Receipt and Permit number 21538

To the CHIEF ELECTRICAL INSPECTOR, Portland, Maine:

The undersigned hereby applies for a permit to make electrical installations in accordance with the laws of Maine, the Portland Electrical Ordinance, the National Electrical Code and the following specifications:

LOCATION OF WORK: 76 Kent St
 OWNER'S NAME: Scott Murray ADDRESS: 76 Kent St

	FEES
OUTLETS:	
Receptacles <u>14</u> Switches <u>7</u> Plugmold _____ ft. TOTAL <u>21</u>	3.00
FIXTURES: (number of)	
Incanidescent <u>8</u> Flourescent _____ (not strip) TOTAL <u>8</u>	3.00
Strip Flourescent _____ ft.	
SERVICES:	
Overhead _____ Underground _____ Temporary _____ TOTAL amperes _____ ..	
METERS: (number of)	
MOTORS: (number of)	
Fractional _____	
1 HP or over _____	
RESIDENTIAL HEATING:	
Oil or Gas (number of units) _____	
Electric (number of rooms) _____	
COMMERCIAL OR INDUSTRIAL HEATING:	
Oil or Gas (by a main boiler) _____	
Oil or Gas (by separate units) _____	
Electric Under 20 kws _____ Over 20 kws _____	
APPLIANCES: (number of)	
Ranges _____ Water Heaters _____	
Cook Tops _____ Disposals _____	
Wall Ovens _____ Dishwashers _____	
Dryers _____ Compactors _____	
Fans _____ 2 _____ Others (denote) _____	
TOTAL, <u>2</u>	3.00
MISCELLANEOUS: (number of)	
Branch Panels _____	
Transformers _____	
Air Conditioners Central Unit _____	
Separate Units (windows) _____	
Signs 20 sq. ft. and under _____	
Over 20 sq. ft. _____	
Swimming Pools Above Ground _____	
In Ground _____	
Fire/Burglar Alarms Residential _____	
Commercial _____	
Heavy Duty Outlets, 220 Volt (such as welders) 30 amps and under _____	
over 30 amps _____	
Circus, Fairs, etc. _____	
Alterations to wires _____	
Repairs after fire _____	
Emergency Lights, battery _____	
Emergency Generators _____	
INSTALLATION FEE DUE: _____	
FOR ADDITIONAL WORK NOT ON ORIGINAL PERMIT DOUBLE FEE DUE: _____	
FOR REMOVAL OF A "STOP ORDER" (304-16.b)	
TOTAL AMOUNT DUE: _____	9.00

INSPECTION:
 Will be ready on _____, 19__; or Will Call X
CONTRACTOR'S NAME: Scott Kent
ADDRESS: 76 Kent Street
TEL: 772-0796
MASTER LICENSE NO.: _____ **SIGNATURE OF CONTRACTOR:**
LIMITED LICENSE NO.: _____ *Scott Kent*

