

DISPLAY THIS CARD ON PRINCIPAL FRONTAGE OF WORK CITY OF PORTLAND

Please Read
Application And
Notes, if Any,
Attached

BU...TION

PERMIT

Permit Number: 101043

PERMIT ISSUED

This is to certify that GIANTRIS ARIANI & MATTHEW S. O'NEILL/ITS/Kei

has permission to Repair existing garage & remove & replace existing

AT 53 ESSEX ST C-284 G026001 AUG 27 2010

provided that the person or persons, firm or corporation accepting this permit shall comply with all of the provisions of the Statutes of Maine and of the Ordinances of the City of Portland regulating the construction, maintenance and use of buildings and structures, and of the application on file in this department.

Apply to Public Works for street line and grade if nature of work requires such information.

Notification of inspection must be given and written permission procured before this building or part thereof is lath or other is used-in. 2 HO... NOTICE IS REQUIRED.

A certificate of occupancy must be procured by owner before this building or part thereof is occupied.

OTHER REQUIRED APPROVALS

Fire Dept. _____

Health Dept. _____

Appeal Board _____

Other _____

Department Name

Director - Building & Inspection Services

PENALTY FOR REMOVING THIS CARD

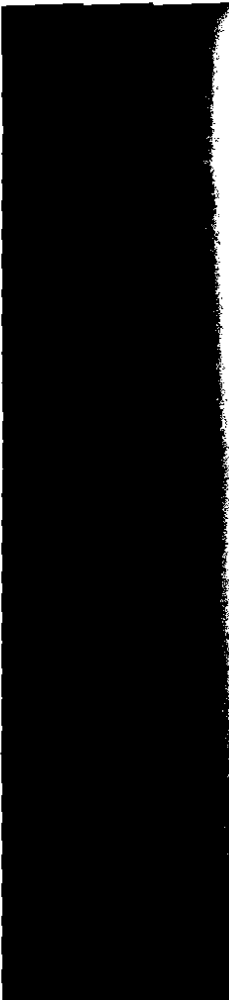

City of Portland, Maine - Building or Use Permit Application

389 Congress Street, 04101 Tel: (207) 874-8703, Fax: (207) 874-8716

| | | |
|-----------------------|-------------|---------------------|
| Permit No: 10-1043 | Issue Date: | CBL: 284 G026001 |
|-----------------------|-------------|---------------------|

| | | | |
|--|--|-------------------------------|--------|
| Location of Construction: 53 ESSEX ST | Owner Name: GIANTRIS ARIAN L & MATTHE | Owner Address: 53 ESSEX ST | Phone: |
|--|--|-------------------------------|--------|

| | | | |
|----------------|--|---|----------------------|
| Business Name: | Contractor Name: Keith Doyon Construction | Contractor Address: 190 Goodwins Mills Road Saco | Phone: 2072721257 |
|----------------|--|---|----------------------|

| | | | |
|---------------------|--------|---|--------------|
| Lessee/Buyer's Name | Phone: | Permit Type: Alterations - Dwellings | Zone: R-3 |
|---------------------|--------|---|--------------|

| | | | | |
|---------------------------------|---|------------------------|-----------------------------|--------------------|
| Past Use: Single Family Home | Proposed Use: Single Family Home - Repair existing garage & remove & replace existing slab | Permit Fee: \$80.00 | Cost of Work: \$6,000.00 | CEO District: 3 |
|---------------------------------|---|------------------------|-----------------------------|--------------------|

| | |
|--|--|
| FIRE DEPT: <input type="checkbox"/> Approved <input type="checkbox"/> Denied | INSPECTION: Use Group: R-3 Type 5TB |
| <i>N/A</i> | <i>IRC 2003</i> |

| | | |
|--|--|-------------------------------|
| Proposed Project Description: Repair existing garage & remove & replace existing slab | Signature: <i>[Signature]</i> | Signature: <i>[Signature]</i> |
| | PEDESTRIAN ACTIVITIES DISTRICT (P.A.D.) | |
| | Action: <input type="checkbox"/> Approved <input type="checkbox"/> Approved w/Conditions <input type="checkbox"/> Denied | |
| | Signature: | Date: |

| | | | |
|-----------------------------|---------------------------------|------------------------|--|
| Permit Taken By: ldobson | Date Applied For: 08/25/2010 | Zoning Approval | |
|-----------------------------|---------------------------------|------------------------|--|

| | | | |
|---|--|---|---|
| <p>1. This permit application does not preclude the Applicant(s) from meeting applicable State and Federal Rules.</p> <p>2. Building permits do not include plumbing, septic or electrical work.</p> <p>3. Building permits are void if work is not started within six (6) months of the date of issuance. False information may invalidate a building permit and stop all work..</p> | <p>Special Zone or Reviews</p> <input type="checkbox"/> Shoreland <input type="checkbox"/> Wetland <input type="checkbox"/> Flood Zone <input type="checkbox"/> Subdivision <input type="checkbox"/> Site Plan <p>Maj <input type="checkbox"/> Minor <input type="checkbox"/> MM <input type="checkbox"/></p> <p><i>OK w/conditions</i> Date: <i>8/26/10</i> <i>APM</i></p> | <p>Zoning Appeal</p> <input type="checkbox"/> Variance <input type="checkbox"/> Miscellaneous <input type="checkbox"/> Conditional Use <input type="checkbox"/> Interpretation <input type="checkbox"/> Approved <input type="checkbox"/> Denied <p>Date:</p> | <p>Historic Preservation</p> <input checked="" type="checkbox"/> Not in District or Landmark <input type="checkbox"/> Does Not Require Review <input type="checkbox"/> Requires Review <input type="checkbox"/> Approved <input type="checkbox"/> Approved w/Conditions <input type="checkbox"/> Denied <p><i>APM</i> Date:</p> |
| | PERMIT ISSUED | | |

AUG 27 2010

City of Portland

CERTIFICATION

I hereby certify that I am the owner of record of the named property, or that the proposed work is authorized by the owner of record and that I have been authorized by the owner to make this application as his authorized agent and I agree to conform to all applicable laws of this jurisdiction. In addition, if a permit for work described in the application is issued, I certify that the code official's authorized representative shall have the authority to enter all areas covered by such permit at any reasonable hour to enforce the provision of the code(s) applicable to such permit.

| | | | |
|---|---------|------|-------|
| SIGNATURE OF APPLICANT | ADDRESS | DATE | PHONE |
| RESPONSIBLE PERSON IN CHARGE OF WORK, TITLE | | DATE | PHONE |

BUILDING PERMIT INSPECTION PROCEDURES

Please call 874-8703 or 874-8693 (ONLY)

or email: buildinginspections@portlandmaine.gov

With the issuance of this permit, the owner, builder or their designee is required to provide adequate notice to the City of Portland Inspection Services for the following inspections. Appointments must be requested 48 to 72 hours in advance of the required inspection. The inspection date will need to be confirmed by this office.

- **Please read the conditions of approval that is attached to this permit!! Contact this office if you have any questions.**
- **Permits expire in 6 months, if the project is not started or ceases for 6 months.**
- **If the inspection requirements are not followed as stated below additional fees may be incurred due to the issuance of a "Stop Work Order" and subsequent release to continue with construction.**

 X **Footing/Building Location Inspection: Prior to pouring concrete or setting precast piers**

 X **Framing/Rough Plumbing/Electrical: Prior to Any Insulating or drywalling**

 X **Final inspection required at completion of work.**

The project cannot move to the next phase prior to the required inspection and approval to continue, REGARDLESS OF THE NOTICE OR CIRCUMSTANCES.

IF THE PERMIT REQUIRES A CERTIFICATE OF OCCUPANCY, IT MUST BE PAID FOR AND ISSUED TO THE OWNER OR DESIGNEE BEFORE THE SPACE MAY BE OCCUPIED.

PERMIT ISSUED

AUG 27 2010

City of Portland

FLOOR PLAN

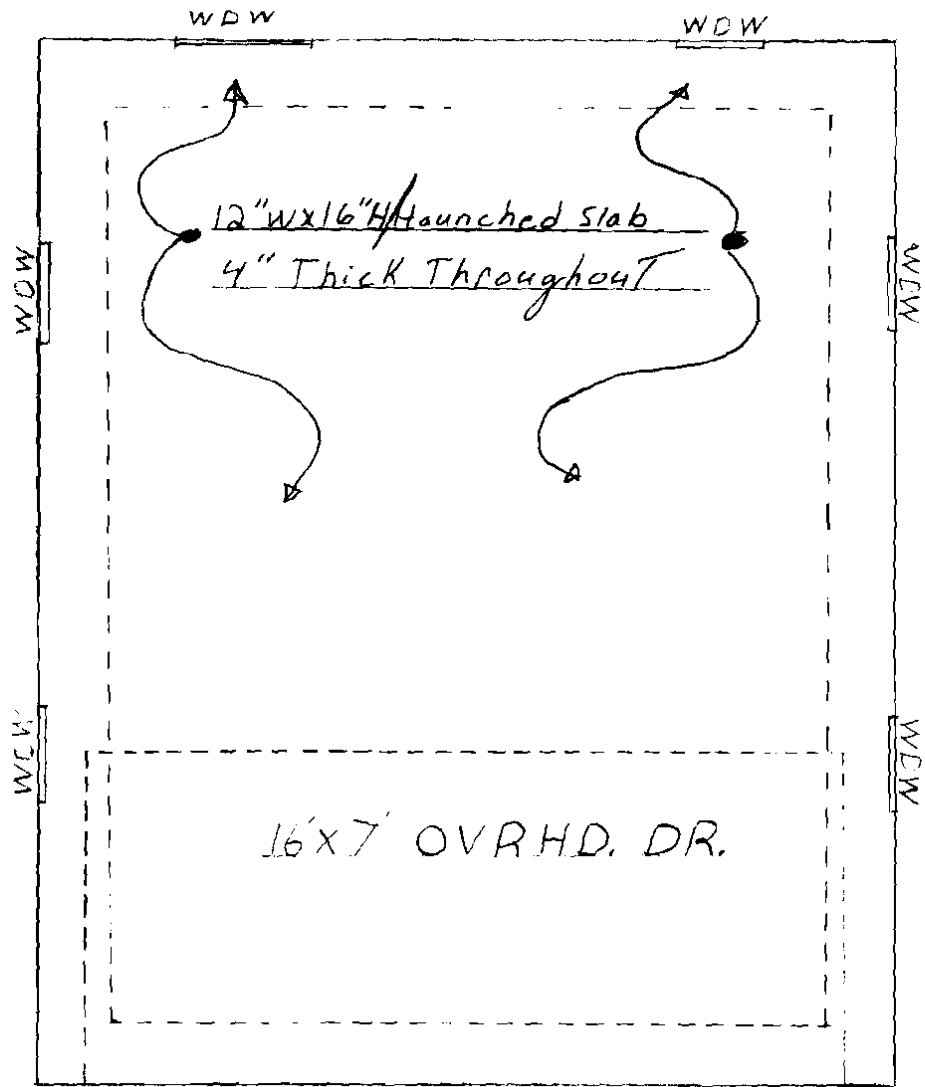

TYP. SECTION

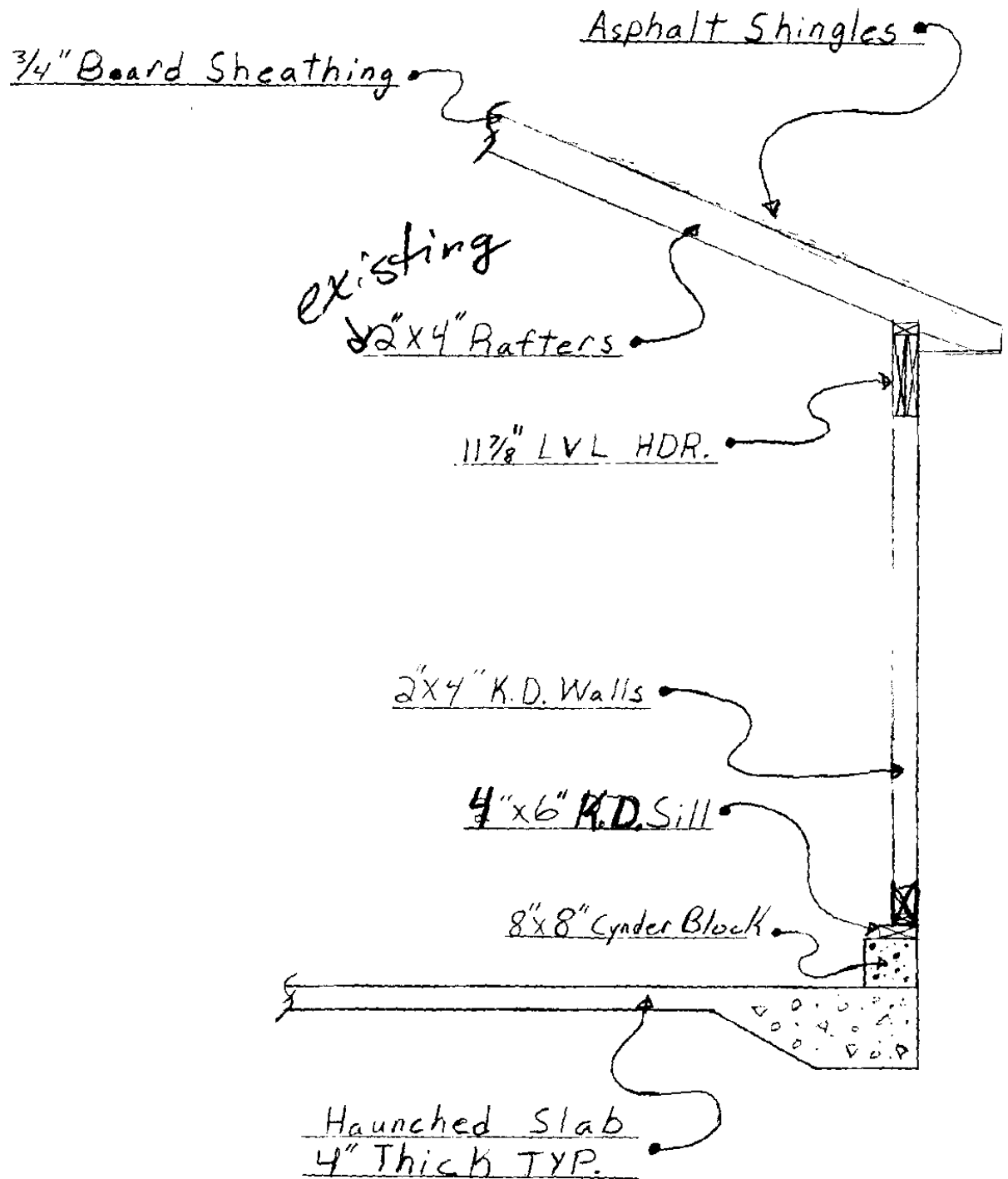

City of Portland, Maine - Building or Use Permit

389 Congress Street, 04101 Tel: (207) 874-8703, Fax: (207) 874-8716

| | | |
|-----------------------|---------------------------------|---------------------|
| Permit No: 10-1043 | Date Applied For: 08/25/2010 | CBL: 284 G026001 |
|-----------------------|---------------------------------|---------------------|

| | | | |
|--|--|---|--------------------------|
| Location of Construction: 53 ESSEX ST | Owner Name: GIANTRIS ARIAN L & MATTHE | Owner Address: 53 ESSEX ST | Phone: |
| Business Name: | Contractor Name: Keith Doyon Construction | Contractor Address: 190 Goodwins Mills Road Saco | Phone: (207) 272-1257 |
| Lessee/Buyer's Name | Phone: | Permit Type: Alterations - Dwellings | |

| | |
|---|--|
| Proposed Use: Single Family Home - Repair existing garage & remove & replace existing slab | Proposed Project Description: Repair existing garage & remove & replace existing slab |
|---|--|

| | | | |
|---|---|-------------------------------|----------------------------------|
| Dept: Zoning | Status: Approved with Conditions | Reviewer: Ann Machado | Approval Date: 08/26/2010 |
| Note: Original garage permitted in 1926 (20' x 20') | | | Ok to Issue: ✓ |
| <ol style="list-style-type: none"> 1) This permit is being issued with the condition that the existing footprint and shell of the garage wil remian the same. 2) This property shall remain a single family dwelling. Any change of use shall require a separate permit application for review and approval. 3) This permit is being approved on the basis of plans submitted. Any deviations shall require a separate approval before starting that work. | | | |
| Dept: Building | Status: Approved with Conditions | Reviewer: Tammy Munson | Approval Date: 08/27/2010 |
| Note: | | | Ok to Issue: ✓ |
| <ol style="list-style-type: none"> 1) 1/2" diameter by 6" anchor bolts must be used 6'-0" o.c. To secure the sill to the foundation. 2) Application approval based upon information provided by applicant. Any deviation from approved plans requires separate review and approval prior to work. 3) Separate permits are required for any electrical, plumbing, sprinkler, fire alarm HVAC systems, heating appliances, including pellet/wood stoves, commercial hood exhaust systems and fuel tanks. Separate plans may need to be submitted for approval as a part of this process. | | | |

PERMIT ISSUED

AUG 27 2010

City of Portland



4366

284 G027

104.01

6'-6" 6'-6"

46'

4A

14

50

284 G026

11'-1" 5'-6" 5'-8"

4913

10' 20'

6'-6"

18'

284 G038

PAVED DRIVEWAY

Garage

284 G014

51.44

1 inch = 9 feet
0 5 10
Feet

92.21

284 G025

Map Produced by the City of
Portland's ArcGIS Server
Web Application.