

TOP OF DECK

NOT TO SCALE

7 1/2" ↑

Double 2x10 PT

Grade

6x8 concrete block set on grade

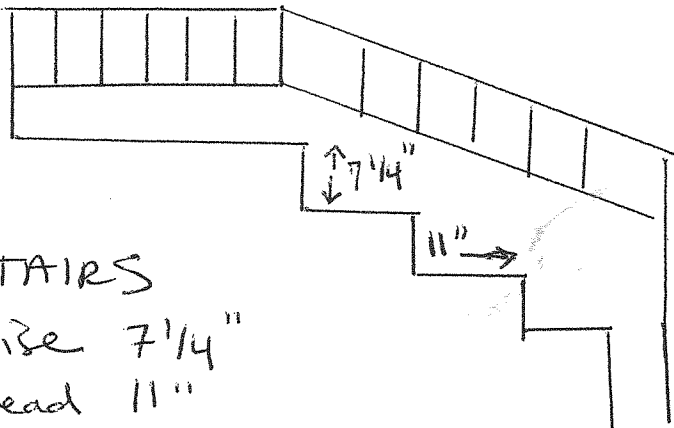

STAIRS

Rise 7 1/4"

Tread 11"

Rail Height 36"

Grab Rail 34"

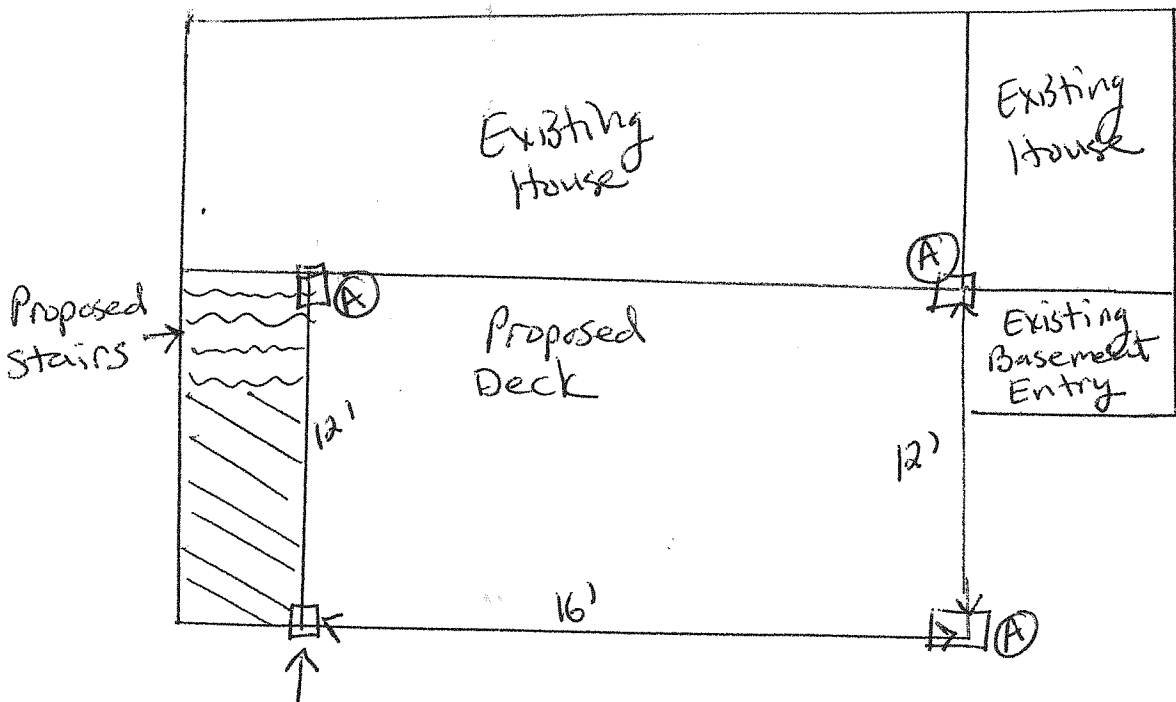

Ⓐ 8" x 8" x 16"  
Solid Concrete Block Set to Grade