

**City of Portland, Maine - Building or Use Permit Application**  
 389 Congress Street, 04101 Tel: (207) 874-8703, Fax: (207) 874-8716

<b>Permit No:</b> 02-0397	<b>Issue Date:</b> AUG 14 2002	<b>CBL:</b> 284 C001001
------------------------------	-----------------------------------	----------------------------

<b>Location of Construction:</b> 899 Brighton Ave	<b>Owner Name:</b> Samba Llc	<b>Owner Address:</b> 110 Colonial Rd CITY OF PORTLAND	<b>Phone:</b> 773-0017
<b>Business Name:</b>	<b>Contractor Name:</b> Applicant	<b>Contractor Address:</b> Portland	<b>Phone:</b>
<b>Lessee/Buyer's Name</b>	<b>Phone:</b>	<b>Permit Type:</b> Signs - Permanent	<b>Zone:</b> B-1

<b>Past Use:</b> Fish Market	<b>Proposed Use:</b> Fish Market	<b>Permit Fee:</b> \$42.00	<b>Cost of Work:</b> \$42.00	<b>CEO District:</b> 3
		<b>FIRE DEPT:</b> <input checked="" type="checkbox"/> Approved <input type="checkbox"/> Denied	<b>INSPECTION:</b> Use Group: U Type: Sign BOA 99	

**Proposed Project Description:**  
Erect an A-Frame 36" x 48" Sidewalk Sign

**Signature:** \_\_\_\_\_ **Signature:** *gm*

**PEDESTRIAN ACTIVITIES DISTRICT (P.A.D.)**

Action:  Approved  Approved w/Conditions  Denied

**Signature:** \_\_\_\_\_ **Date:** \_\_\_\_\_

<b>Permit Taken By:</b> gad	<b>Date Applied For:</b> 08/08/2002	<b>Zoning Approval</b>	
--------------------------------	--	------------------------	--

<ol style="list-style-type: none"> <li>This permit application does not preclude the Applicant(s) from meeting applicable State and Federal Rules.</li> <li>Building permits do not include plumbing, septic or electrical work.</li> <li>Building permits are void if work is not started within six (6) months of the date of issuance. False information may invalidate a building permit and stop all work..</li> </ol>	<b>Special Zone or Reviews</b> <input type="checkbox"/> Shoreland <input type="checkbox"/> Wetland <input type="checkbox"/> Flood Zone <input type="checkbox"/> Subdivision <input type="checkbox"/> Site Plan Maj <input type="checkbox"/> Minor <input type="checkbox"/> MM <input type="checkbox"/> Date: <i>8/13/02</i>	<b>Zoning Appeal</b> <input type="checkbox"/> Variance <input type="checkbox"/> Miscellaneous <input type="checkbox"/> Conditional Use <input type="checkbox"/> Interpretation <input type="checkbox"/> Approved <input type="checkbox"/> Denied Date: _____	<b>Historic Preservation</b> <input checked="" type="checkbox"/> Not in District or Landmark <input type="checkbox"/> Does Not Require Review <input type="checkbox"/> Requires Review <input type="checkbox"/> Approved <input type="checkbox"/> Approved w/Conditions <input type="checkbox"/> Denied Date: _____
	<i>not a zoning issue</i>		

**CERTIFICATION**

I hereby certify that I am the owner of record of the named property, or that the proposed work is authorized by the owner of record and that I have been authorized by the owner to make this application as his authorized agent and I agree to conform to all applicable laws of this jurisdiction. In addition, if a permit for work described in the application is issued, I certify that the code official's authorized representative shall have the authority to enter all areas covered by such permit at any reasonable hour to enforce the provision of the code(s) applicable to such permit.

\_\_\_\_\_  
 SIGNATURE OF APPLICANT ADDRESS DATE PHONE

\_\_\_\_\_  
 RESPONSIBLE PERSON IN CHARGE OF WORK, TITLE DATE PHONE

Form # P 04

# DISPLAY THIS CARD ON PRINCIPAL FRONTAGE OF WORK CITY OF PORTLAND

Please Read  
Application And  
Notes, If Any,  
Attached

ENGINEERING DIVISION

Permit Number: 020897

## PERMIT

This is to certify that Samba Llc /Applicant  
has permission to Erect an A-Frame 36" x 48" sidewalk S  
AT 899 Brighton Ave 284 C001001

provided that the person or persons, firm or corporation accepting this permit shall comply with all of the provisions of the Statutes of Maine and of the ordinances of the City of Portland regulating the construction, maintenance and use of buildings and structures, and of the application on file in this department.

Apply to Public Works for street line and grade if nature of work requires such information.

Notification of inspection must be given and written permission procured before this building or part thereof is laid or closed-in. **HEAVY NOTICE IS REQUIRED.**

A certificate of occupancy must be procured by owner before this building or part thereof is occupied.

### OTHER REQUIRED APPROVALS

Fire Dept. \_\_\_\_\_  
Health Dept. \_\_\_\_\_  
Appeal Board \_\_\_\_\_  
Other \_\_\_\_\_  
Department Name \_\_\_\_\_

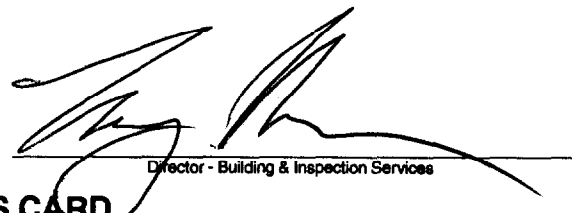
  
Director - Building & Inspection Services

**PENALTY FOR REMOVING THIS CARD**

02-0897

**THIS IS NOT A PERMIT/CONSTRUCTION MAY NOT COMMENCE UNTIL THE PERMIT IS ISSUED**

# Signage Application

If you or the property owner owes real estate or personal property taxes or user charges on any property within the City, payment arrangements must be made before permits of any kind are accepted.

Location/Address of Construction: <u>889 Brighton Ave. Portland, Maine</u>		
Total Square Footage of Proposed Structure	Square Footage of Lot	
Tax Assessor's Chart, Block & Lot Chart# <u>284</u> Block# <u>C</u> Lot# <u>1-5</u>	Owner: <u>SAMBA, LLC</u>	Telephone: <u>773-0017</u>
Lessee/Buyer's Name (If Applicable)	Applicant name, address & telephone:	Total s.f. of signage <u>12</u> x 1.00 per s.f. \$ <u>12.00</u> , plus \$30.00 base fee Fee: \$ <u>12</u> -
Current use: <u>Fish Company</u> <u>SMARTHS</u>		
If the location is currently vacant, what was prior use: <u>Fish market</u>		
Approximately how long has it been vacant: _____		
Proposed use: <u>A FRAME SIGN FOR SPECIALS OUTSIDE STORE</u> Project description: <u>36x48 A FRAME SIGN</u>		
Contractor's name, address & telephone: <u>Ø</u>		
Who should we contact when the permit is ready: <u>Susan Clough</u>		
Mailing address: <u>Pieble Fish</u> <u>889 Brighton Ave. Portland, Me. 04102</u>		
We will contact you by phone when the permit is ready. You must come in and pick up the permit and review the requirements before starting any work, with a Plan Reviewer. A stop work order will be issued and a \$50.00 fee if any work starts before the permit is picked up. Phone: <u>772-4024</u>		

**IF THE REQUIRED INFORMATION IS NOT INCLUDED IN THE SUBMISSIONS THE PERMIT WILL BE AUTOMATICALLY DENIED AT THE DISCRETION OF THE BUILDING/PLANNING DEPARTMENT, WE MAY REQUIRE ADDITIONAL INFORMATION IN ORDER TO APPROVE THIS PERMIT.**

I hereby certify that I am the Owner of record of the named property, or that the owner of record authorizes the proposed work and that I have been authorized by the owner to make this application as his/her authorized agent. I agree to conform to all applicable laws of this jurisdiction. In addition, if a permit for work described in this application is issued, I certify that the Code Official's authorized representative shall have the authority to enter all areas covered by this permit at any reasonable hour to enforce the provisions of the codes applicable to this permit.

Signature of applicant: [Signature]

Date:

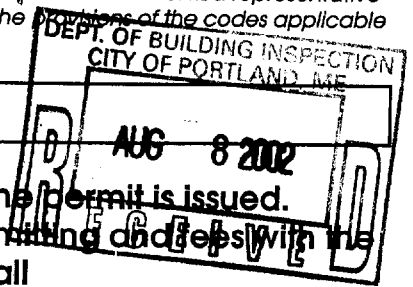

**This is NOT a permit, you may not commence ANY work until the permit is issued. If you are in a Historic District you may be subject to additional permitting and fees with the Planning Department on the 4th floor of City Hall**

**SIGNAGE PRE-APPLICATION**

PLEASE ANSWER ALL QUESTIONS

ADDRESS: 883-899 Brighton Ave ZONE: B1

OWNER: SAMBA, LLC

APPLICANT: \_\_\_\_\_

ASSESSOR NO. \_\_\_\_\_

PLEASE CIRCLE APPROPRIATE ANSWER

SINGLE TENANT LOT? YES   NO MULTI-TENANT LOT?  YES  NO  
FREESTANDING SIGN? (ex. Pole Sign) YES  NO  --- DIMENSIONS 36<sup>(72)</sup> HEIGHT 48  
MORE THAN ONE SIGN? YES  NO  DIMENSIONS \_\_\_\_\_ HEIGHT \_\_\_\_\_  
SIGN ATTACHED TO BLDG.? YES   NO DIMENSIONS \_\_\_\_\_  
MORE THAN ONE SIGN? YES  NO  DIMENSIONS \_\_\_\_\_  
AWNING: YES  NO  IS AWNING BACKLIT? YES  NO  HEIGHT OFF SIDEWALK \_\_\_\_\_  
IS THERE ANY MESSAGE, TRADEMARK OR SYMBOL ON IT?

LIST ALL EXISTING SIGNAGE AND THEIR DIMENSIONS:

\*\*\* TENANT BLDG. FRONTAGE (IN FEET): 163'  
\*\*\* REQUIRED INFORMATION

AREA FOR COMPUTATION

**YOU SHALL PROVIDE:**  
**A SITE SKETCH AND BUILDING SKETCH SHOWING EXACTLY WHERE EXISTING AND NEW SIGNAGE IS LOCATED MUST BE PROVIDED. SKETCHES AND/OR PICTURES OF PROPOSED ARE ALSO REQUIRED.**

SIGNATURE OF APPLICANT: \_\_\_\_\_ DATE: \_\_\_\_\_

SAMBA, LLC

August 7, 2002

Preble Seafood  
Sidewalk Sign Application  
883-889 Brighton Ave  
Portland, Me 04102

To Whom it may concern:

This letter gives permission to Preble Seafood to have a sidewalk sign at the above location.

S. Philip DiBiase

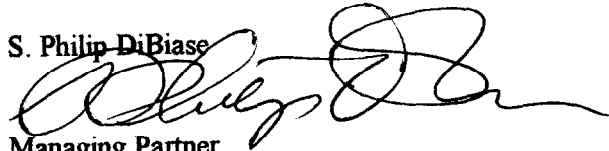
A handwritten signature in black ink, appearing to read 'S. Philip DiBiase', written over a horizontal line.

Managing Partner  
SAMBA, LLC (Property owner)

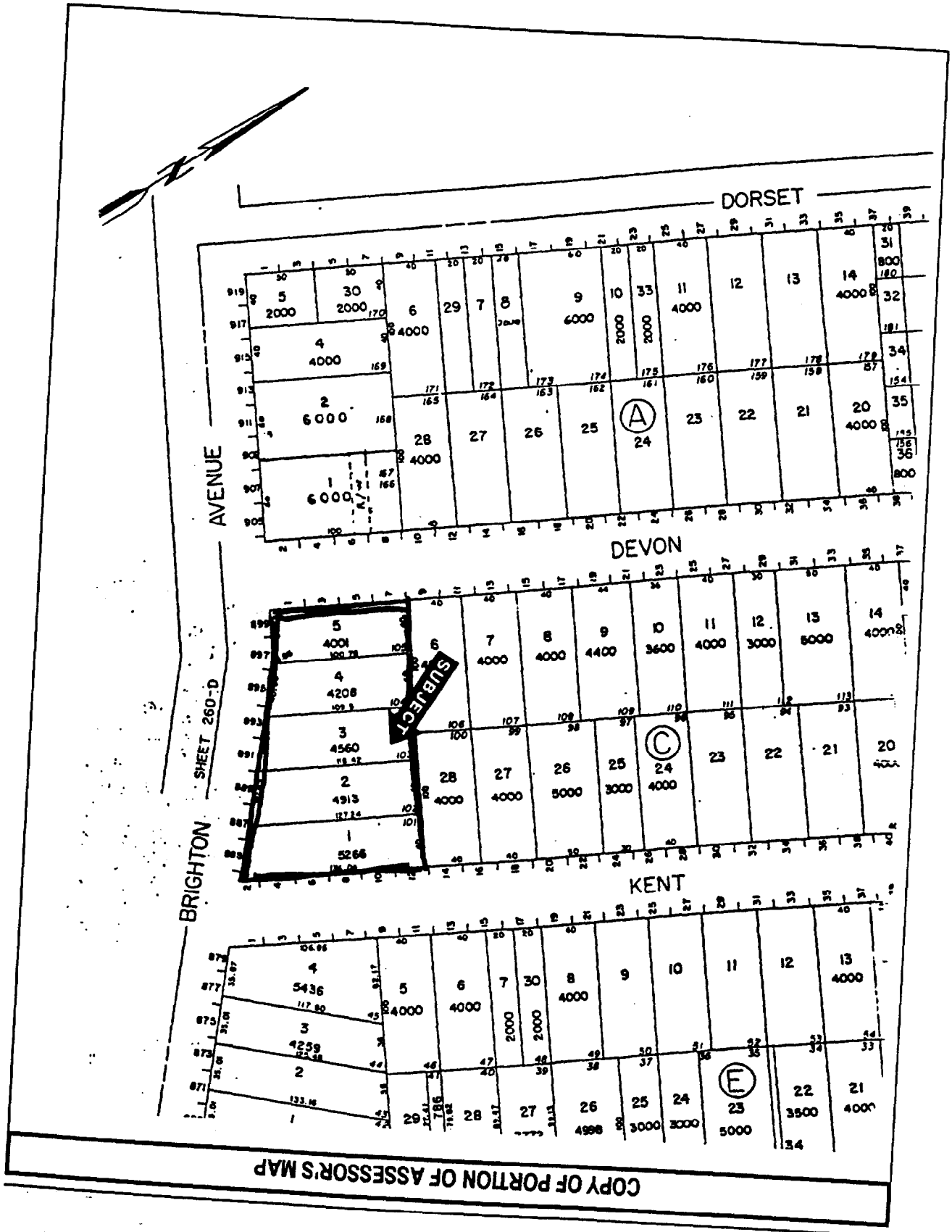

COPY OF PORTION OF ASSESSOR'S MAP

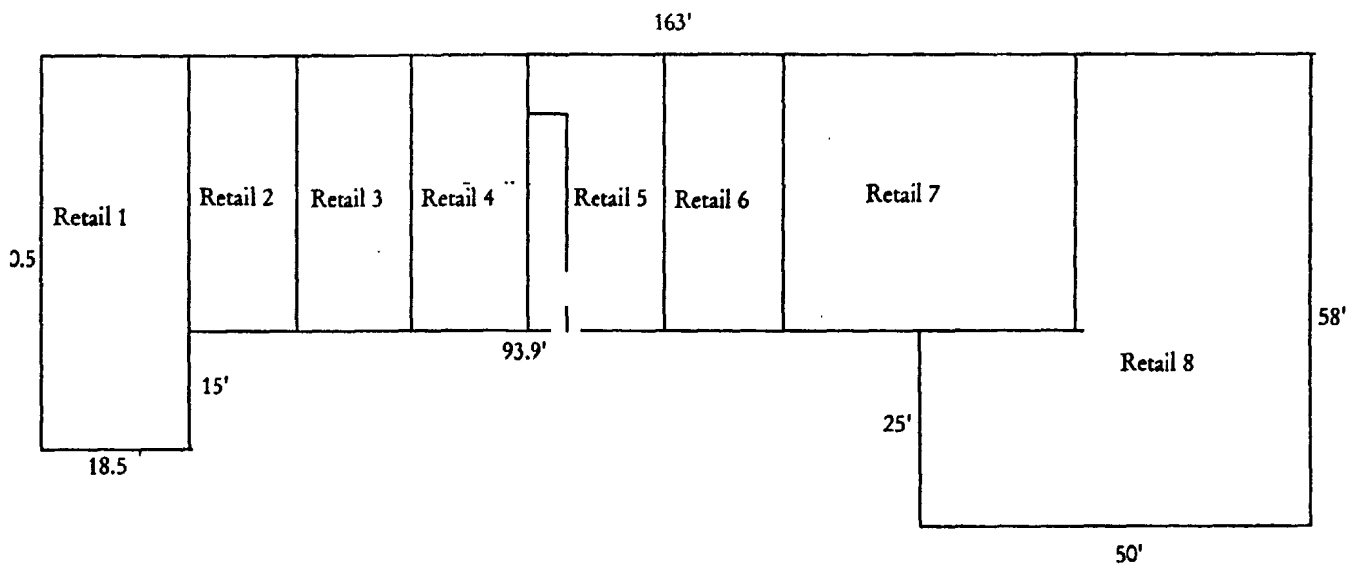

FIRST FLOOR RETAIL

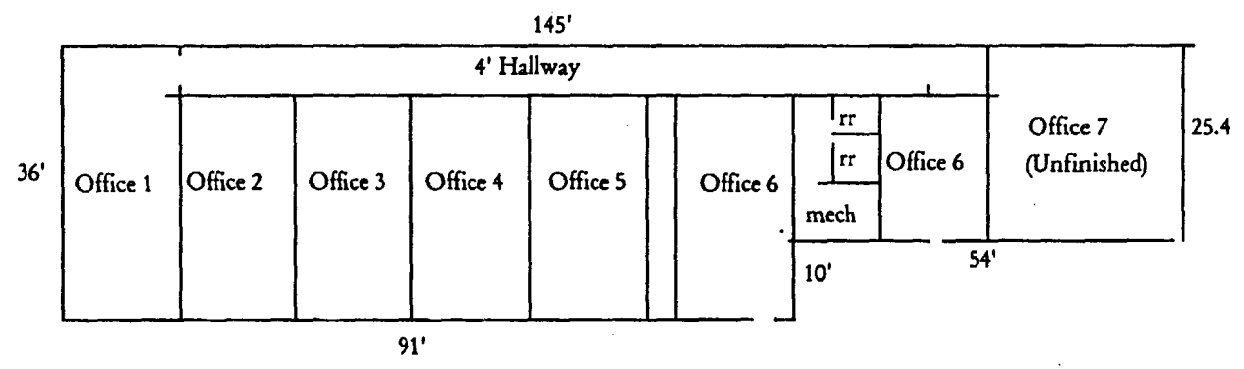

SECOND FLOOR OFFICES

BUILDING SKETCH

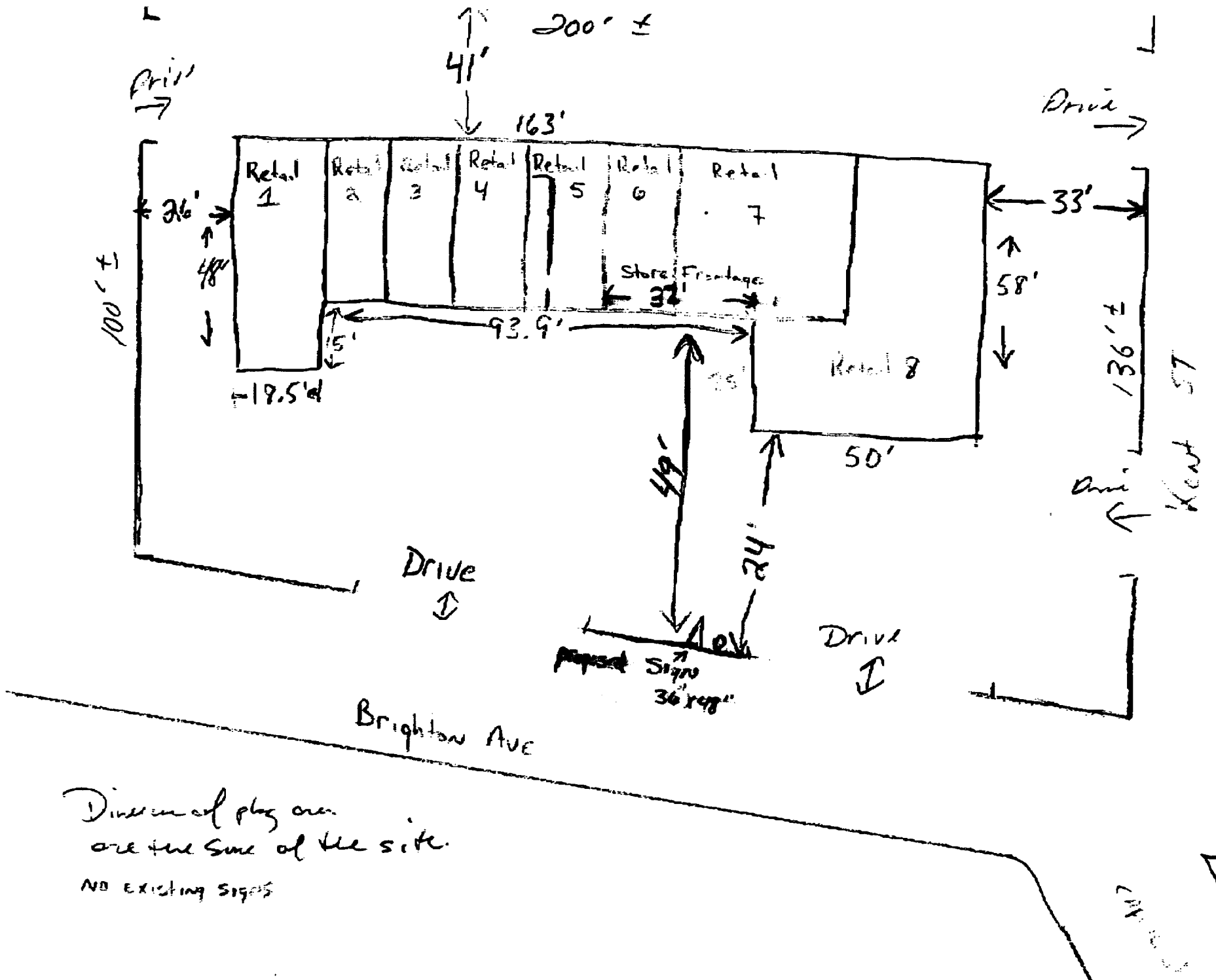

Dimensions of plot area  
are the same of the site.  
NO EXISTING SIGNS



# ACORD CERTIFICATE OF LIABILITY INSURANCE

08/02/2002

PRODUCER (207)985-3361 FAX (207)985-7977  
 Cole-Harrison Agency  
 83 Main Street  
 P.O. Box 358  
 Kennebunk, ME 04043

THIS CERTIFICATE IS ISSUED AS A MATTER OF INFORMATION ONLY AND CONFERS NO RIGHTS UPON THE CERTIFICATE HOLDER. THIS CERTIFICATE DOES NOT AMEND, EXTEND OR ALTER THE COVERAGE AFFORDED BY THE POLICIES BELOW.

### INSURERS AFFORDING COVERAGE

INSURED R. J. Preble And Sons Inc  
 43 Old Alewife Road  
 Kennebunk, ME 04043

INSURER A: The Netherlands Insurance Co  
 INSURER B:  
 INSURER C:  
 INSURER D:  
 INSURER E:

### COVERAGES

THE POLICIES OF INSURANCE LISTED BELOW HAVE BEEN ISSUED TO THE INSURED NAMED ABOVE FOR THE POLICY PERIOD INDICATED. NOTWITHSTANDING ANY REQUIREMENT, TERM OR CONDITION OF ANY CONTRACT OR OTHER DOCUMENT WITH RESPECT TO WHICH THIS CERTIFICATE MAY BE ISSUED OR MAY PERTAIN, THE INSURANCE AFFORDED BY THE POLICIES DESCRIBED HEREIN IS SUBJECT TO ALL THE TERMS, EXCLUSIONS AND CONDITIONS OF SUCH POLICIES. AGGREGATE LIMITS SHOWN MAY HAVE BEEN REDUCED BY PAID CLAIMS.

TYPE OF INSURANCE	POLICY NUMBER	POLICY EFFECTIVE DATE (MM/DD/YYYY)	POLICY EXPIRATION DATE (MM/DD/YYYY)	LIMITS
<b>GENERAL LIABILITY</b> <input checked="" type="checkbox"/> COMMERCIAL GENERAL LIABILITY <input type="checkbox"/> CLAIMS MADE <input checked="" type="checkbox"/> OCCUR GEN'L AGGREGATE LIMIT APPLIES PER: <input type="checkbox"/> POLICY <input type="checkbox"/> PRO-JECT <input type="checkbox"/> LOC	BOP9007478	05/12/2002	05/12/2003	EACH OCCURRENCE \$ 1,000,000 FIRE DAMAGE (Any one fire) \$ 50,000 MED EXP (Any one person) \$ 5,000 PERSONAL & ADV INJURY \$ 1,000,000 GENERAL AGGREGATE \$ 2,000,000 PRODUCTS - COMP/OP AGG \$ 2,000,000
<b>AUTOMOBILE LIABILITY</b> <input type="checkbox"/> ANY AUTO <input type="checkbox"/> ALL OWNED AUTOS <input type="checkbox"/> SCHEDULED AUTOS <input type="checkbox"/> HIRED AUTOS <input type="checkbox"/> NON-OWNED AUTOS				COMBINED SINGLE LIMIT (Ea accident) \$ BODILY INJURY (Per person) \$ BODILY INJURY (Per accident) \$ PROPERTY DAMAGE (Per accident) \$
<b>GARAGE LIABILITY</b> <input type="checkbox"/> ANY AUTO				AUTO ONLY - EA ACCIDENT \$ OTHER THAN AUTO ONLY: EA ACC \$ AGG \$
<b>EXCESS LIABILITY</b> <input type="checkbox"/> OCCUR <input type="checkbox"/> CLAIMS MADE DEDUCTIBLE \$ RETENTION \$				EACH OCCURRENCE \$ AGGREGATE \$ \$ \$
<b>WORKERS COMPENSATION AND EMPLOYERS' LIABILITY</b>				WC STATU-TORY LIMITS OTH-ER E.L. EACH ACCIDENT \$ E.L. DISEASE - EA EMPLOYEE \$ E.L. DISEASE - POLICY LIMIT \$
OTHER				

DESCRIPTION OF OPERATIONS/LOCATIONS/VEHICLES/EXCLUSIONS ADDED BY ENDORSEMENT/SPECIAL PROVISIONS

LOCATION: 889 BRIGHTON AVENUE, PORTLAND, ME 04102

### CERTIFICATE HOLDER

ADDITIONAL INSURED; INSURER LETTER:

### CANCELLATION

CITY OF PORTLAND, MAINE  
 CITY HALL  
 389 CONGRESS STREET  
 PORTLAND, ME 04101

SHOULD ANY OF THE ABOVE DESCRIBED POLICIES BE CANCELLED BEFORE THE EXPIRATION DATE THEREOF, THE ISSUING COMPANY WILL ENDEAVOR TO MAIL 10 DAYS WRITTEN NOTICE TO THE CERTIFICATE HOLDER NAMED TO THE LEFT, BUT FAILURE TO MAIL SUCH NOTICE SHALL IMPOSE NO OBLIGATION OR LIABILITY OF ANY KIND UPON THE COMPANY, ITS AGENTS OR REPRESENTATIVES.

AUTHORIZED REPRESENTATIVE

Jeffrey Cole BY

ACORD CORPORATION 1988

## IMPORTANT

If the certificate holder is an **ADDITIONAL INSURED**, the policy(ies) must be endorsed. A statement on this certificate does not confer rights to the certificate holder in lieu of such endorsement(s).

If **SUBROGATION IS WAIVED**, subject to the terms and conditions of the policy, certain policies may require an endorsement. A statement on this certificate does not confer rights to the certificate holder in lieu of such endorsement(s).

## DISCLAIMER

The Certificate of Insurance on the reverse side of this form does not constitute a contract between the issuing insurer(s), authorized representative or producer, and the certificate holder, nor does it affirmatively or negatively amend, extend or alter the coverage afforded by the policies listed thereon.