

**City of Portland, Maine - Building or Use Permit Application**

389 Congress Street, 04101 Tel: (207) 874-8703, Fax: (207) 874-8716

Permit No: 06-0918	Issue Date: <b>PERMIT ISSUED</b>	CBL: 283 D022001
-----------------------	-------------------------------------	---------------------

Location of Construction: 26 CANDLEWYCK TER	Owner Name: LI YONG T & LI YU HUANG JTS	Owner Address: 26 CANDLEWYCK TER	Phone: 
Business Name: 	Contractor Name: Down East Energy	Contractor Address: 172 Main Street South Portland	Phone: 2077995585
Lessee/Buyer's Name: 	Phone: 	Permit Type: Tanks - Dwellings	Zone: R3

Past Use: Single Family	Proposed Use: Single Family install a 120 gal tank	Permit Fee: \$30.00	Cost of Work: \$30.00	CEO District: 3
		FIRE DEPT: <input type="checkbox"/> Approved <input type="checkbox"/> Denied <i>N/A</i>	INSPECTION: Use Group: <i>U</i> Type: <i>Tank</i> <i>Rankes</i>	

Proposed Project Description: install a 120 gal tank	Signature: <i>[Signature]</i>	Signature: <i>[Signature]</i>
PEDESTRIAN ACTIVITIES DISTRICT (P.A.D.)		
Action <input type="checkbox"/> Approved <input type="checkbox"/> Approved w/Conditions <input type="checkbox"/> Denied		
Signature		Date

Permit Taken By: dmartin	Date Applied For: 06/3/2006	<b>Zoning Approval</b>
-----------------------------	--------------------------------	------------------------

<ol style="list-style-type: none"> <li>This permit application does not preclude the Applicant(s) from meeting applicable State and Federal Rules.</li> <li>Building permits do not include plumbing, septic or electrical work.</li> <li>Building permits are void if work is not started within six (6) months of the date of issuance. False information may invalidate a building permit and stop all work..</li> </ol>	<b>Special Zone or Reviews</b> <input type="checkbox"/> Shoreland <input type="checkbox"/> Wetland <input type="checkbox"/> Flood Zone <input type="checkbox"/> Subdivision <i>N/A</i> <input type="checkbox"/> Site Plan Maj <input type="checkbox"/> Minor <input type="checkbox"/> MM <input type="checkbox"/> Date: <i>6/24/06</i> <i>APM</i>	<b>Zoning Appeal</b> <input type="checkbox"/> Variance <input type="checkbox"/> Miscellaneous <input type="checkbox"/> Conditional Use <input type="checkbox"/> Interpretation <input type="checkbox"/> Approved <input type="checkbox"/> Denied Date:	<b>Historic Preservation</b> <input checked="" type="checkbox"/> Not in District or Landmar <input type="checkbox"/> Does Not Require Review <input type="checkbox"/> Requires Review <input type="checkbox"/> Approved <input type="checkbox"/> Approved w/Conditions <input type="checkbox"/> Denied <i>ABM</i> Date:
---	--	---	--

**CERTIFICATION**

I hereby certify that I am the owner of record of the named property, or that the proposed work is authorized by the owner of record and that I have been authorized by the owner to make this application as his authorized agent and I agree to conform to all applicable laws of this jurisdiction. In addition, if a permit for work described in the application is issued, I certify that the code official's authorized representative shall have the authority to enter all areas covered by such permit at any reasonable hour to enforce the provision of the code(s) applicable to such permit.

\_\_\_\_\_  
SIGNATURE OF APPLICANT ADDRESS DATE PHONE

\_\_\_\_\_  
RESPONSIBLE PERSON IN CHARGE OF WORK. TITLE DATE PHONE



FILL IN AND SIGN WITH INK

# APPLICATION FOR PERMIT HEATING OR POWER EQUIPMENT

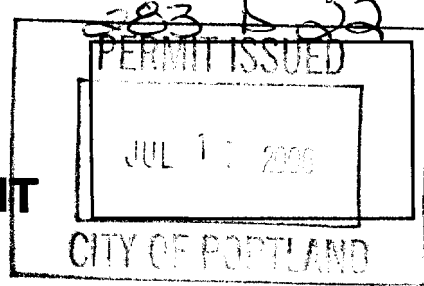

To the INSPECTOR OF BUILDINGS, PORTLAND, ME .

The undersigned hereby applies for a permit to install the following heating, cooking or power equipment in accordance with the Laws of Maine, the Building Code of the City of Portland, and the following specifications:

Location / CBL \_\_\_\_\_ Use of Building Private Date \_\_\_\_\_  
 Name and address of owner of appliance Donald Smith 26 Candlewick Dr Portland  
 Installer's name and address Dawn East Energy 172 Main St South Portland Telephone 799-5585

**Location of appliance:**

- Basement  Floor
- Attic  Roof

**Type of Fuel:**

- Gas  Oil  Solid

**Appliance Name:** \_\_\_\_\_

U.L. Approved  Yes  No

Will appliance be installed in accordance with the manufacture's installation instructions?  Yes  No

IF **NO** Explain: \_\_\_\_\_

**The Type of License of Installer:**

- Master Plumber # \_\_\_\_\_
- Solid Fuel # \_\_\_\_\_
- Oil # \_\_\_\_\_
- Gas# PNT 1445
- Other \_\_\_\_\_

**Type of Chimney:**

- Masonry Lined  
Factory built \_\_\_\_\_
- Metal  
Factory Built U.L. Listing # \_\_\_\_\_
- Direct Vent  
Type \_\_\_\_\_ uL# \_\_\_\_\_

**Type of Fuel Tank**

- Oil
- Gas

Size of Tank 120

Number of Tanks 1

Distance from Tank to Center of Flame \_\_\_\_\_ feet.

Cost of Work: \$ \_\_\_\_\_

Permit Fee: \$ 30

**Approved**

**Approved with Conditions**

Fire: \_\_\_\_\_  
 Ele.: \_\_\_\_\_  
 Bldg.: \_\_\_\_\_

See attached letter or requirement

Inspector's Signature \_\_\_\_\_

Date Approved \_\_\_\_\_

Signature of Installer Steve Ludell

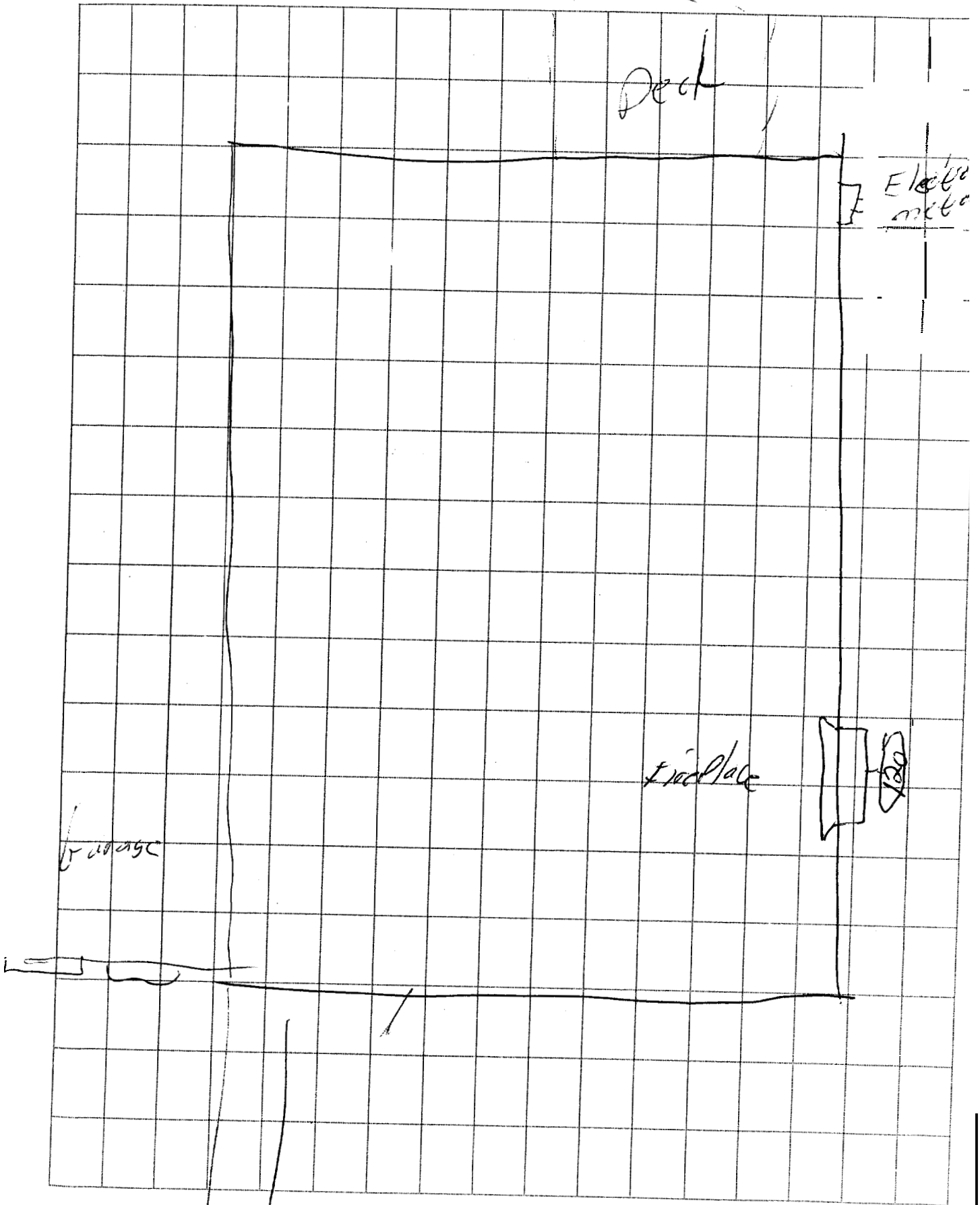

LIVING ROOM

can do with Terrace