

1" = 2'

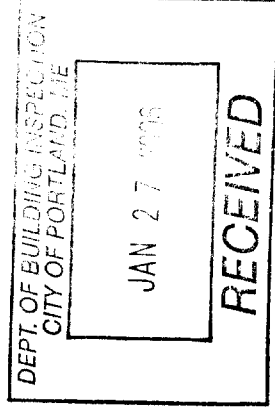

GARAGE ROOF LINE

SIDE VIEW

STREET SIDE

FRONT

BACK

1'

1'

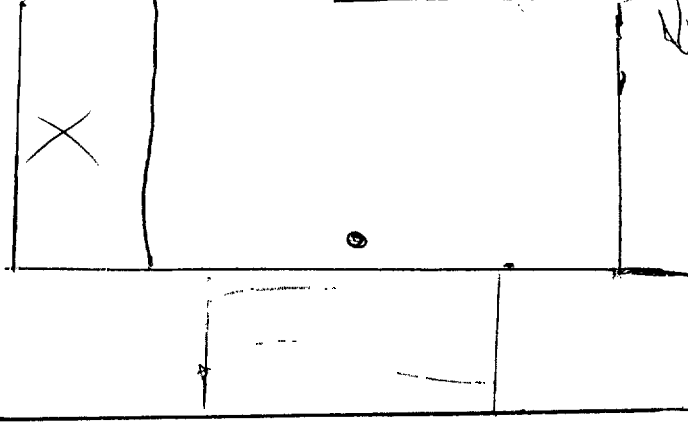

EXISTING RAILING

DECK

FRONT GARAGE WALL

12'

FRONT VIEW FRAMING

1/2" = 1'

1" SPACER

1 RPT FRAMING
6" OVERHANG

1/2" CDX ROOF SHEATHING

2x6 RAFTERS 16" O/C

DBL 2x4 TOP PLATE

2x4 STUD

2x4 JACK STUD

2x4 STUD

2x4 JACK STUD

2x4 PLATE

EXISTING DECK

EXISTING WOOD STEPS TO BE REPLACED WITH BRICK

4x4 PT PLATE

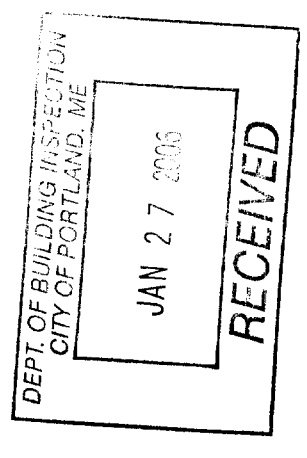

HOUSE

GARAGE

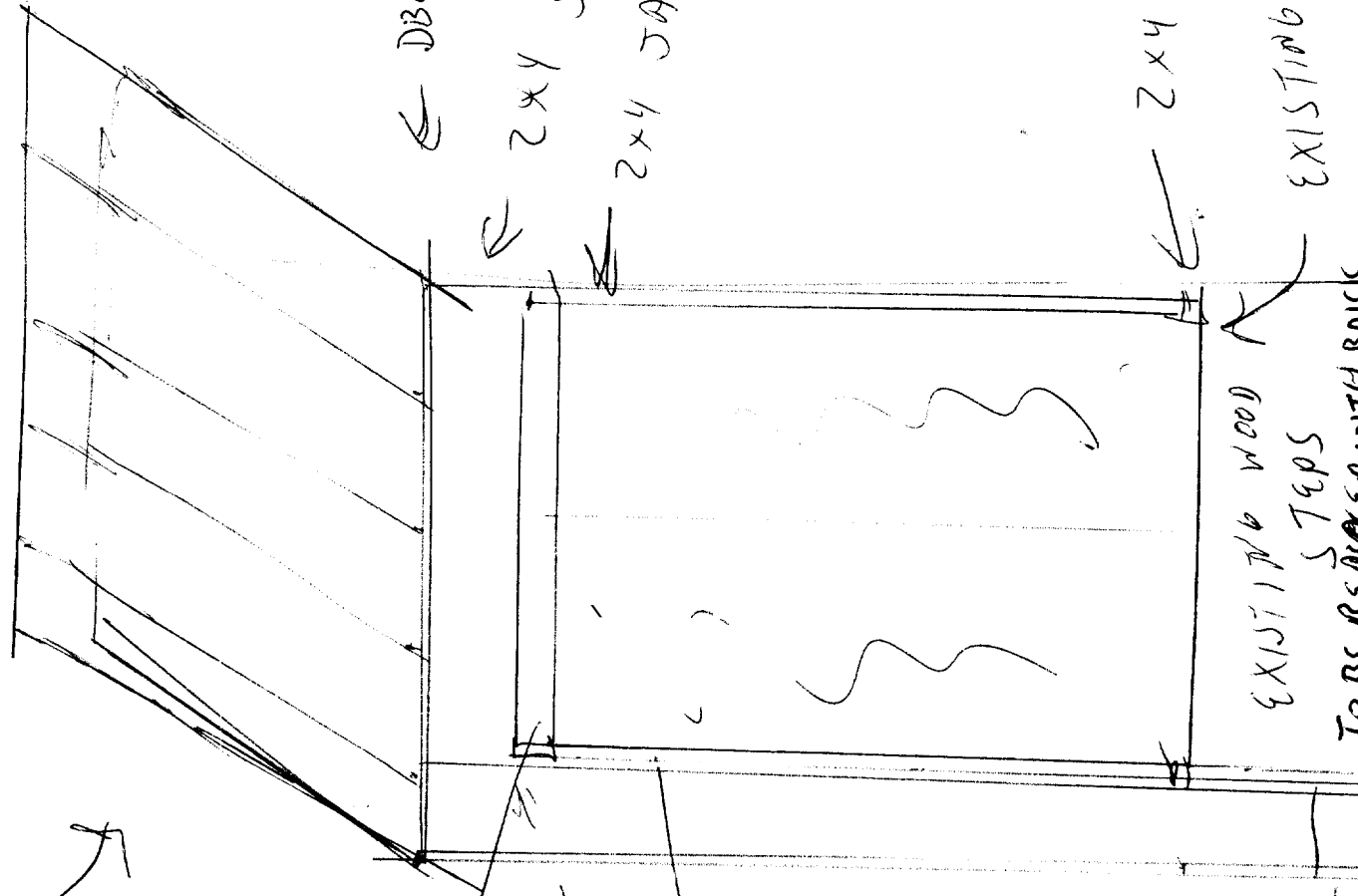

1/4" = 1'

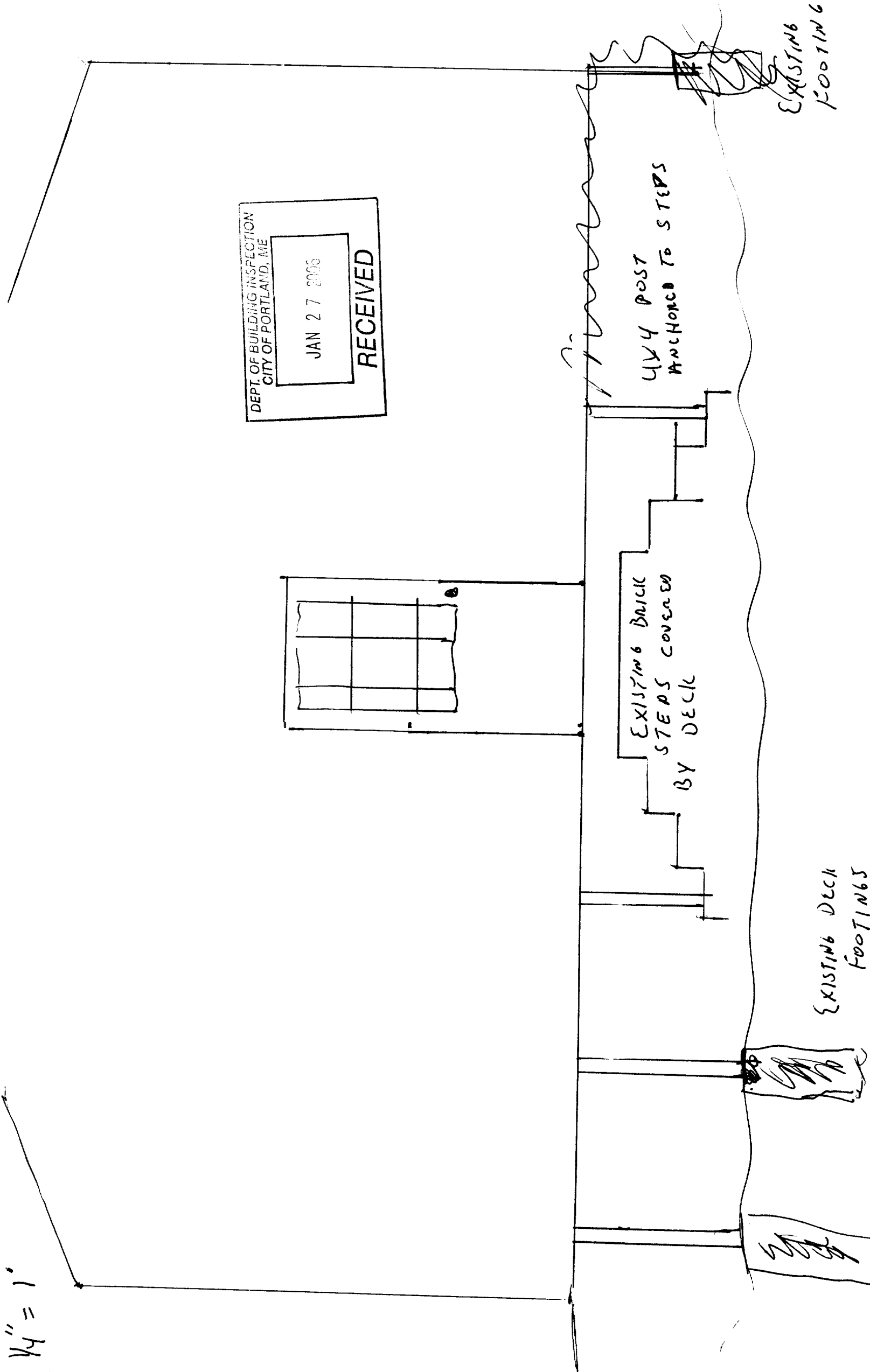

DEPT. OF BUILDING INSPECTION
CITY OF PORTLAND, ME
JAN 27 2006
RECEIVED

EXISTING
FOOTING

EXISTING DECK
FOOTINGS