

DISPLAY THIS CARD ON PRINCIPAL FRONTAGE OF WORK



CITY OF PORTLAND BUILDING PERMIT

This is to certify that PIKE INDUSTRIES INC

Located At BISHOP ST

Job ID: 2012-03-3551-DEMO

CBL: 281-A-003-001

has permission to Demolish of Hot mix asphalt Plant, tanks, equipment
provided that the person or persons, firm or corporation accepting this permit shall comply with all of the provisions of the Statues of Maine and of the Ordinances of the City of Portland regulating the construction, maintenance and use of the buildings and structures, and of the application on file in the department.

Notification of inspection and written permission procured before this building or part thereof is lathed or otherwise closed-in. 48 HOUR NOTICE IS REQUIRED.

A final inspection must be completed by owner before this building or part thereof is occupied. If a certificate of occupancy is required, it must be

Fire Prevention Officer

[Signature] 4/3/12

Code Enforcement Officer / Plan Reviewer

**THIS CARD MUST BE POSTED ON THE STREET SIDE OF THE PROPERTY
PENALTY FOR REMOVING THIS CARD**

City of Portland, Maine - Building or Use Permit Application

389 Congress Street, 04101 Tel: (207) 874-8703, FAX: (207) 8716

Job No: 2012-03-3551-DEMO	Date Applied: 3/21/2012	CBL: 281- A-003-001	
Location of Construction: BISHOP ST (#172 - at the end)	Owner Name: PIKE INDUSTRIES INC.	Owner Address: 145 RIVER RD LEWISTON, ME 04240	Phone: 207-854-2561
Business Name:	Contractor Name: Pike & CIA Salvage	Contractor Address: 366 Sokokis Trail, Limerick, ME	Phone:
Lessee/Buyer's Name:	Phone:	Permit Type: DEMO - Demolition Permit	Zone: I-H, I-M & R-3
Past Use: Hot Mix Asphalt Plant	Proposed Use: Vacant - demolish hot mix asphalt plant & all associated equipment - DEMO ONLY	Cost of Work: 15000.00	CEO District:
		Fire Dept: <input type="checkbox"/> Approved <input type="checkbox"/> Denied <input checked="" type="checkbox"/> N/A	Inspection: Use Group: N/A Type: Demolition Signature: JMB 4/3/12
Proposed Project Description: Demolition of hot mix asphalt plant, tanks, equip.		Pedestrian Activities District (P.A.D.)	
Permit Taken By:	Zoning Approval		

1. This permit application does not preclude the Applicant(s) from meeting applicable State and Federal Rules. 2. Building Permits do not include plumbing, septic or electrical work. 3. Building permits are void if work is not started within six (6) months of the date of issuance. False information may invalidate a building permit and stop all work.	Special Zone or Reviews <input type="checkbox"/> Shoreland <input type="checkbox"/> Wetlands <input type="checkbox"/> Flood Zone <input type="checkbox"/> Subdivision <input type="checkbox"/> Site Plan <input type="checkbox"/> Maj <input type="checkbox"/> Min <input type="checkbox"/> MM Date: OK w/ conditions 3/22/12 ABM	Zoning Appeal <input type="checkbox"/> Variance <input type="checkbox"/> Miscellaneous <input type="checkbox"/> Conditional Use <input type="checkbox"/> Interpretation <input type="checkbox"/> Approved <input type="checkbox"/> Denied Date:	Historic Preservation <input type="checkbox"/> Not in Dist or Landmark <input checked="" type="checkbox"/> Does not Require Review <input type="checkbox"/> Requires Review <input type="checkbox"/> Approved <input type="checkbox"/> Approved w/Conditions <input type="checkbox"/> Denied Date:
	CERTIFICATION		

I hereby certify that I am the owner of record of the named property, or that the proposed work is authorized by the owner of record and that I have been authorized by the owner to make this application as his authorized agent and I agree to conform to all applicable laws of this jurisdiction. In addition, if a permit for work described in the application is issued, I certify that the code official's authorized representative shall have the authority to enter all areas covered by such permit at any reasonable hour to enforce the provision of the code(s) applicable to such permit.

SIGNATURE OF APPLICANT	ADDRESS	DATE	PHONE
RESPONSIBLE PERSON IN CHARGE OF WORK, TITLE		DATE	PHONE

3/23/12 OK to proceed w/ demo of
processing plants - see checklist

G

BUILDING PERMIT INSPECTION PROCEDURES

Please call 874-8703 or 874-8693 (ONLY)

or email: buildinginspections@portlandmaine.gov

With the issuance of this permit, the owner, builder or their designee is required to provide adequate notice to the city of Portland Inspections Services for the following inspections. Appointments must be requested 48 to 72 hours in advance of the required inspection. The inspection date will need to be confirmed by this office.

- **Please read the conditions of approval that is attached to this permit!! Contact this office if you have any questions.**
- **Permits expire in 6 months. If the project is not started or ceases for 6 months.**
- **If the inspection requirements are not followed as stated below additional fees may be incurred due to the issuance of a "Stop Work Order" and subsequent release to continue.**

Final Inspection when demolition is completed

The project cannot move to the next phase prior to the required inspection and approval to continue, REGARDLESS OF THE NOTICE OF CIRCUMSTANCES.

IF THE PERMIT REQUIRES A CERTIFICATE OF OCCUPANCY, IT MUST BE PAID FOR AND ISSUED TO THE OWNER OR DESIGNEE BEFORE THE SPACE MAY BE OCCUPIED.



PORTLAND MAINE

Strengthening a Remarkable City, Building a Community for Life • www.portlandmaine.gov

Acting Director of Planning and Urban Development
Gregory Mitchell

Job ID: 2012-03-3551-DEMO

Located At: BISHOP ST

CBL: 281- A-003-001

Conditions of Approval:

Zoning

1. This permit is for demolition only. Separate permits shall be required for any future structures that are built, and the new use will have to be established at that time.

Building

1. Application approval based upon information provided by applicant. Any deviation from approved plans requires separate review and approval prior to work.
2. Demolition permits are valid for a period of 30 days from the date of issuance. A written request must be submitted and granted for an extension to this time period. Dust prevention shall be controlled per Chapter 6 of the Municipal Ordinance and demolition per Section 3303 of the IBC 2003.

Demo Inspection:

Address/Permit#: 172 Bishop St 2012-03-3551

Inspector visits site prior to issuance to inspect for hazards. Verify with owner that they are aware that permit expires in 30 days

Record size and location, if applicable (Length, width, and height)

Call or e-mail utilities & verify removal of utilities and any hazardous conditions:

Utility Approvals	Number	Contact Name/Date
<input checked="" type="checkbox"/> Central Maine Power	800-750-4000-2-0	3/23 Gary yes ATO
<input type="checkbox"/> Unutil 866-933-3821-0 Rick Bellemare Mob 252-2488 Office 541-2504 <u>Bellemare@Unitel.com</u>	541-2533	3/23 Rick <u>yes.</u>
<input checked="" type="checkbox"/> Portland Water District	761-8310	3/23 Heather <u>yes.</u>
<input checked="" type="checkbox"/> Dig Safe	888-344-7233	3/23 Dianne <u>yes</u>
<input type="checkbox"/> DPW/ Traffic(L. Cote)	874-8891	3/23 Mailbox full <u>Ø</u>
<input checked="" type="checkbox"/> DPW/ Sealed Drain (C. Merritt)	874-8822 Greg Vining 8838 or John Emerson 8468 Mob 318-0239	3/23 Carol <u>yes</u>
<input type="checkbox"/> Historic Preservation	874-8726	<u>Ø</u>
<input checked="" type="checkbox"/> DEP Environ Sandy Moody 287-2651 sandy.j.moody@maine.gov		3/23 Sandy <u>yes</u>
<input type="checkbox"/> Cable services		<u>Ø</u>
<input type="checkbox"/> Fuel tanks	<u>→ Clean Harbors</u>	
<input type="checkbox"/> Lead/Asbestos Environmental Issues		<u>Ø</u>
<input type="checkbox"/> Clutter/Pests (don't want rodents going in neighbors yards)		<u>Ø</u>



Demolition Call List & Requirements

Site Address: ZERO BISHOP ST.

Owner: PIKE INDUSTRIES, INC.

Structure Type: HOT MIX ASPHALT PLANT
172 BISHOP, PAST ADDRESS

Contractor: CIA SALVAGE - LIMERICK, ME

Utility Approvals	Number	Contact Name/Date
Central Maine Power	1-800-750-4000	<u>IARA 3-15-2012</u>
Unitil	1-207-541-2533	<u>BARBARA 3-15-2012</u>
Portland Water District	761-8310	<u>HEATHER 3-15-2012</u>
Dig Safe <u>3-15-2012</u> <u>9:31:25 A.M.</u>	1-888-344-7233	<u>TICKET # 20121104182</u> <u>E-MAIL I.D.# 10738382</u>

After calling Dig Safe, you must wait 72 business hours before digging can begin.

DPW/ Traffic Division (L. Cote)	874-8891	<u>KEVIN THOMAS 3-15-2012</u>
DPW/ Sealed Drain Permit (C. Merritt)	874-8822	<u>CAROL MERRITT 3-15-2012</u>
Historic Preservation	874-8726	<u>DEBBIE ANDREWS 3-15-2012</u>
DEP - Environmental (Augusta)	287-2651	<u>SANDY MOODY 3-15-2012</u>

Additional Requirements

- 1) Written notice to adjoining owners ATTACHED
- 2) A photo of the structure(s) to be demolished ATTACHED
- 3) A plot plan or site plan of the property ATTACHED
- 4) Certification from an asbestos abatement company ATTACHED
- 5) Electronic files in pdf format are also required in addition to hard copy ✓

Permit Fee: \$30.00 for the first \$1000.00 construction cost, \$10.00 per additional \$1000.00 cost

All construction and demolition debris generated in Portland must be delivered to Riverside Recycling Facility at 910 Riverside Street. Source separated salvage materials placed in specifically designated containers are exempt from this provision. For more information contact Troy Moon @ 874-8467.

U.S. EPA Region 1 - No Phone call required. Just mail copy of State notification to:

- ✓ Demo / Reno Clerk
- US EPA Region I (SEA)
- JFK Federal Building
- Boston, MA 02203

I have contacted all of the necessary companies/departments as indicated above and attached all required documentation.

Signed: John Koris

Date: MARCH 16, 2012

or more information or to download this form and other permit applications visit the Inspections Division on our website at www.portlandmaine.gov

Jeanie Bourke - Bishop Street demo signoff

From: "Monti, Barbara" <monti@unitil.com>
To: Donald McPherson <dmcpherson@portlandmaine.gov>, Jeanie Bourke <jmb@port...
Date: 3/20/2012 7:54 AM
Subject: Bishop Street demo signoff
CC: "jkoris@pikeindustries.com" <jkoris@pikeindustries.com>

Pike Industries is ok with us to demo the asphalt plant on Bishop Street.

Any questions please let me know.

barb

Barbara Monti
Unitil Service Corp
1075 Forest Avenue
PO Box 3586
Portland ME 04104-3586
Phone: 207-541-2533
Email: monti@unitil.com

Koris, John (Pike)

Subject: FW: On Target Locating Services - TICKET#: 20121104182; EMAIL ID#: 10738382

From: Sloan Mike (Pike)

Sent: Friday, March 16, 2012 7:59 AM

To: Koris, John (Pike)

Subject: FW: On Target Locating Services - TICKET#: 20121104182; EMAIL ID#: 10738382

Thanks,
Mike

From: No- Reply [mailto:NoReply@ontargetservices.com]

Sent: Thursday, March 15, 2012 9:31 AM

To: Sloan Mike (Pike)

Subject: On Target Locating Services - TICKET#: 20121104182; EMAIL ID#: 10738382

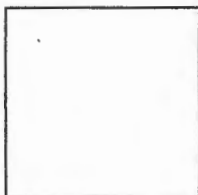

Locating Services
617 Water Street
Gardiner, Maine 04345
tel 800-598-0628 fax 207-588-3302

www.ontargetservices.com

Date/Time: 3/15/2012 9:31:25 AM

MICHAEL SLOAN, PIKE INDUSTRIES
58 MAIN ST
WESTBROOK, ME 04092

This message is being sent in response to your request for underground cable location. The following represents a list of responses for the indicated member. These responses only pertain to the specific member.

Ticket Number: 20121104182

Address: 172 BISHOP ST
PORTLAND, MAINE

Markout Completed on: 3/15/2012 8:51:42 AM Company: CENTRAL MAINE POWER

If you received this notification by email please do not respond by email, please call 1-800-598-0628 with any questions.

3/16/2012



PIKE INDUSTRIES, INC.
58 MAIN STREET
WESTBROOK, ME 04092

PHONE: (207) 854-2561

FAX: (207) 854-2539

FACSIMILE TRANSMITTAL SHEET

TO: DEMO / RENO CLERK

FROM: JOHN KORIS

COMPANY: PIKE INDUSTRIES, INC.

DATE: 3-16-2012

FAX NUMBER: 207-854-2530

TOTAL NO. OF PAGES INCLUDING COVER:

Two

PHONE NUMBER: 207-854-2561

SENDER'S REFERENCE NUMBER:

RE: DEMO PERMIT FOR ASPHALT PLANT

YOUR REFERENCE NUMBER:

URGENT FOR REVIEW PLEASE COMMENT PLEASE REPLY PLEASE RECYCLE

NOTES/COMMENTS:



PIKE INDUSTRIES, INC.

58 MAIN STREET • WESTBROOK, MAINE 04092 • (207) 854-2561 • FAX (207) 854-2539
AN EQUAL OPPORTUNITY EMPLOYER

March 15, 2012

WJG LLC
3 Congressional Drive
Falmouth, Maine 04105

RE: City of Portland Tax Map 281 Lot 3

To Whom It May Concern:

Please be advised that Pike Industries, Inc. has sold its' property at 172 Bishop Street and is applying to the City of Portland for a demolition permit to remove the asphalt plant from this location.

If you should have any questions please do not hesitate to contact me at (207) 854-2561.

Sincerely,
Pike Industries, Inc.

John Koris, P.E.
Environmental Manager



An Oldcastle Company



ESTABLISHED 1872

PIKE INDUSTRIES, INC.

58 MAIN STREET • WESTBROOK, MAINE 04092 • (207) 854-2561 • FAX (207) 854-2539
AN EQUAL OPPORTUNITY EMPLOYER

March 15, 2012

Portland Terminal Co.
Iron Horse Park
North Billerica, MA 01862

RE: City of Portland Tax Map 281 Lot 3

To Whom It May Concern:

Please be advised that Pike Industries, Inc. has sold its' property at 172 Bishop Street and is applying to the City of Portland for a demolition permit to remove the asphalt plant from this location.

If you should have any questions please do not hesitate to contact me at (207) 854-2561.

Sincerely,
Pike Industries, Inc.

John Koris, P.E.
Environmental Manager



An Oldcastle Company



PIKE INDUSTRIES, INC.

58 MAIN STREET • WESTBROOK, MAINE 04092 • (207) 854-2561 • FAX (207) 854-2539
AN EQUAL OPPORTUNITY EMPLOYER

March 15, 2012

Bishop Street LLC & Northern Sky Development
29 Lunt Road
Freeport, ME 04032

RE: City of Portland Tax Map 281 Lot 3

To Whom It May Concern:

Please be advised that Pike Industries, Inc. has sold its' property at 172 Bishop Street and is applying to the City of Portland for a demolition permit to remove the asphalt plant from this location.

If you should have any questions please do not hesitate to contact me at (207) 854-2561.

Sincerely,
Pike Industries, Inc.

John Koris, P.E.
Environmental Manager



An Oldcastle Company



ESTABLISHED 1872

PIKE INDUSTRIES, INC.

58 MAIN STREET • WESTBROOK, MAINE 04092 • (207) 854-2561 • FAX (207) 854-2539
AN EQUAL OPPORTUNITY EMPLOYER

March 15, 2012

William F. Dixon & J. Wesley Wright Jr.
25 Sand Point Lane
Cumberland Foreside, ME 04110

RE: City of Portland Tax Map 281 Lot 3

To Whom It May Concern:

Please be advised that Pike Industries, Inc. has sold its' property at 172 Bishop Street and is applying to the City of Portland for a demolition permit to remove the asphalt plant from this location.

If you should have any questions please do not hesitate to contact me at (207) 854-2561.

Sincerely,
Pike Industries, Inc.

John Koris, P.E.
Environmental Manager



An Oldcastle Company



PIKE INDUSTRIES, INC.

58 MAIN STREET • WESTBROOK, MAINE 04092 • (207) 854-2561 • FAX (207) 854-2539
AN EQUAL OPPORTUNITY EMPLOYER

March 15, 2012

Deering Lodge Building Corp.
651 Forest Avenue
Portland, ME 04101

RE: City of Portland Tax Map 281 Lot 3

To Whom It May Concern:

Please be advised that Pike Industries, Inc. has sold its' property at 172 Bishop Street and is applying to the City of Portland for a demolition permit to remove the asphalt plant from this location.

If you should have any questions please do not hesitate to contact me at (207) 854-2561.

Sincerely,
Pike Industries, Inc.

John Koris, P.E.
Environmental Manager



An Oldcastle Company



PIKE INDUSTRIES, INC.

58 MAIN STREET • WESTBROOK, MAINE 04092 • (207) 854-2561 • FAX (207) 854-2539
AN EQUAL OPPORTUNITY EMPLOYER

March 15, 2012

Central Maine Power Co.
Local Tax
70 Farm View Drive
New Gloucester, ME 04260

RE: City of Portland Tax Map 281 Lot 3

To Whom It May Concern:

Please be advised that Pike Industries, Inc. has sold its' property at 172 Bishop Street and is applying to the City of Portland for a demolition permit to remove the asphalt plant from this location.

If you should have any questions please do not hesitate to contact me at (207) 854-2561.

Sincerely,
Pike Industries, Inc.

John Koris, P.E.
Environmental Manager



An Oldcastle Company



PIKE INDUSTRIES, INC.

58 MAIN STREET • WESTBROOK, MAINE 04092 • (207) 854-2561 • FAX (207) 854-2539
AN EQUAL OPPORTUNITY EMPLOYER

March 15, 2012

Portland Water District
P.O. Box 3553
225 Douglass Street
Portland, ME 04104-3553

RE: City of Portland Tax Map 281 Lot 3

To Whom It May Concern:

Please be advised that Pike Industries, Inc. has sold its' property at 172 Bishop Street and is applying to the City of Portland for a demolition permit to remove the asphalt plant from this location.

If you should have any questions please do not hesitate to contact me at (207) 854-2561.

Sincerely,
Pike Industries, Inc.

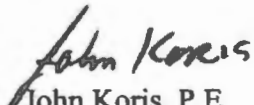
John Koris, P.E.
Environmental Manager



An Oldcastle Company



2017



01/01/2006

2012



2102

2012

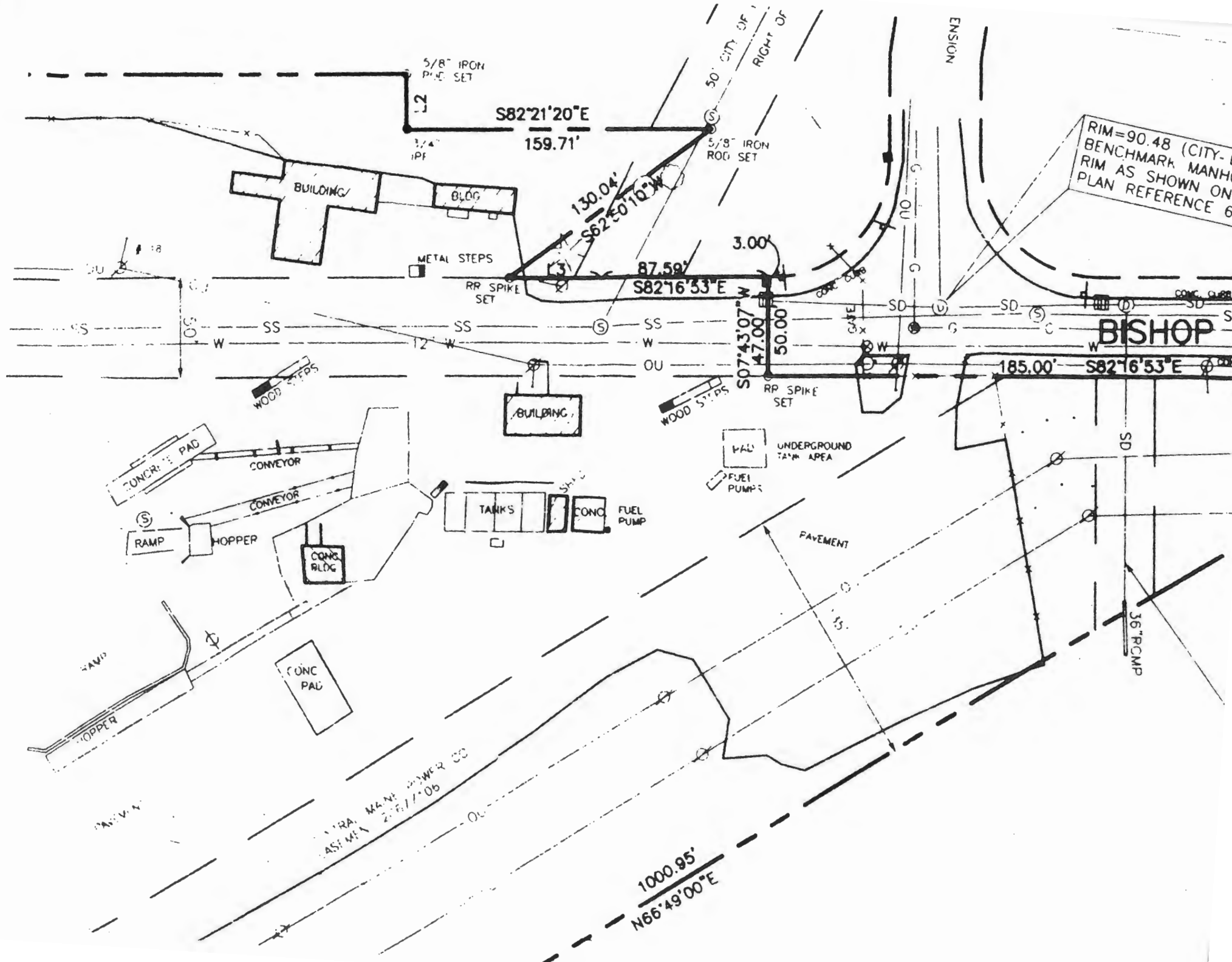

5/8" IRON PIPE SET

S82°21'20"E
159.71'

1/4" IPF

5/8" IRON ROD SET

130.04'
S62°50'10"W

87.59'
S82°16'53"E

3.00'

S0743°07'W
47.00'

RIM=90.48 (CITY-D)
BENCHMARK MANHO
RIM AS SHOWN ON
PLAN REFERENCE 6

BISHOP

185.00' S82°16'53"E

BUILDING

PAU UNDERGROUND TANK AREA

FUEL PUMPS

TANKS CONC FUEL PUMP

PAVEMENT

CONCR. PAD

CONVEYOR

CONVEYOR

RAMP

HOPPER

CONC. BLDG

HAMP

CONC PAD

HOPPER

UTRA MANE POWER CO
LAST MA 2/6/77 '06

1000.95'
N66°49'00"E

36" PCMP



ASBESTOS BUILDING DEMOLITION NOTIFICATION

MAINE DEPARTMENT OF ENVIRONMENTAL PROTECTION

Lead & Asbestos Hazard Prevention Program
17 State House Station, Augusta, Maine 04333



Maine law requires the filing of this form with the Maine DEP prior to the demolition of any building except a single-family home. In addition, State and Federal laws require that buildings be inspected for asbestos materials before beginning any renovation activities.

Building owners are required to provide this notification of the demolition of a building to the DEP at least 5 working days prior to the demolition. This notification is **not** required before the demolition of a single-family residence or related structure (e.g., garage, shed, barn). It is also **not** required if previous notification of the demolition has been provided to the DEP as part of an asbestos abatement project notification. **Demolition** means the tearing down or intentional burning of a building or part of a building.

Prior to demolition or beginning renovation activities, building owners must determine if there is any asbestos-containing material(s) (ACM) in the building. An "asbestos inspection" by a DEP-licensed Asbestos Consultant is required for all buildings except single-family homes and residential buildings with 2-4 units built after 1980. In lieu of an asbestos inspection, pre-1981 residential buildings with 2-4 units can be surveyed to identify possible ACM by someone knowledgeable about ACM, such as a code enforcement officer or building inspector. If materials that may contain asbestos are found, then you can either assume they are ACM or hire a DEP-licensed Asbestos Consultant to test the materials. Use the Department's "Asbestos Inspection Form" (available online at www.maine.gov/dep/rwm/asbestos/index.htm) to determine who may perform the inspection.

Whenever more than 3 square feet or 3 linear feet of ACM is identified, the ACM must be removed in accordance with the *Maine Asbestos Management Regulations* by a DEP-licensed Asbestos Abatement Contractor. This includes materials presumed to be ACM. Check www.maine.gov/dep/rwm/asbestos/index.htm for a listing of asbestos contractors.

Prior to issuing a local demolition permit, the DEP requests that **municipalities** have applicants for municipal demolition permits complete this form and fax it to the DEP at 207-287-6220. **Municipalities should not issue local demolition permits if the required asbestos inspection or survey has not been performed and all identified ACM removed by a licensed asbestos abatement contractor.**

Were asbestos-containing building materials identified by the asbestos inspection or survey and were the asbestos-containing materials removed by a licensed asbestos abatement contractor?

yes no

property address: Zero (formally 172) Bishop Street Portland, Maine 04103	building description: <input type="checkbox"/> pre-1981 residential with 2-4 units <input type="checkbox"/> post-1980 residential with 2-4 units <input checked="" type="checkbox"/> other: Other, Hot Mix Asphalt plant
asbestos survey/inspection performed by: (name & address) CIA Salvage P.O. Box 360, 366 Sokokis Trail North Limerick, Maine 04048 telephone: 207-793-8193	asbestos abatement contractor: N/A
property owner: (name & address) Pike Industries, Inc. 58 Main Street Westbrook, ME 04092 telephone: 207-854-2561	demolition contractor: (name & address) CIA Salvage, Inc. & Pike Industries Inc., 58 Main St. Westbrook P.O. Box 360, 366 Sokokis Trail North <u>207-854-2561</u> Limerick, Maine 04048 telephone: 207-793-8193
demolition start date: ASAP, 3-20-2012	demolition end date: April 20, 2012

This demolition notification does not take the place of the Asbestos Project Notification if applicable

I CERTIFY THAT THE ABOVE INFORMATION IS CORRECT		
Environmental Manager-Maine		
John Koris, P.E.,		
Print Name: Owner/Agent 207-212-8558	Title 207-854-2539	Signature 3-16-2012
Telephone #	FAX #	Date

BUILDING SURVEY FOR ASBESTOS MATERIALS
Bishop St Asphalt Plant #910

PREPARED FOR:

PIKE INDUSTRIES
58 MAIN STREET
WESTBROOK, ME 04092

PREPARED BY:

BATES ENVIRONMENTAL HEALTH & SAFETY
INDUSTRIAL HYGIENE CONSULTING
211 SOPER ROAD
ORLAND, MAINE 04472

MARCH 10, 2012

1.0 SYNOPSIS

This report describes an asbestos survey recently performed at an asphalt plant located on Bishop Street in Portland, Maine. The plant is scheduled for demolition. This survey will provide the following information: (1) An inventory of both asbestos and non-asbestos materials identified during the survey; (2) A basis for project planners to schedule abatement prior to demolition, if asbestos materials are identified; and (3) Assistance with Owner compliance of current state and federal asbestos regulations, including the 'asbestos survey' requirements for demolition permits.

Significant findings and recommendations of this survey include the following:

- No asbestos materials were identified;
- Eleven (11) samples of suspect asbestos containing materials were collected;
- Most pipe insulation consisted of non-asbestos calcium silicate and fibrous glass; and
- A copy of this report should be included in the demolition permits applications and site demolition bid documentation.

2.0 INTRODUCTION

Bates Environmental Health & Safety (BEH&S) was retained by Pike Industries (Owner) to perform a survey for Asbestos Materials. Asphalt Plant #910 located on Bishop Street in Portland, Maine is scheduled for demolition.

The primary purpose of this survey was to provide the following: (1) An inventory of both asbestos and non-asbestos materials identified during the survey; (2) A basis for project planners to schedule abatement prior to demolition, if asbestos materials are identified; and (3) Assistance with Owner compliance of current state and federal asbestos regulations, including the 'asbestos survey' requirements for demolition permits.

Access to the building and site was granted by Mike Sloan. In general, suspect asbestos building materials were inspected, inventoried, and their condition assessed to the extent to which they were accessible. The inspection was limited to the asphalt plant and its equipment. Other buildings on the property or any sub-surface materials and/or components are outside the survey scope.

The following assessment methods were utilized for this survey:

Asbestos Sampling	EPA and MEDEP AHERA Protocol	40 CFR 763
Asbestos Analysis	Bulk Polarized Light Microscopy	EPA 600/M-4-82-020

3.0 FINDINGS & RECOMMENDATIONS

An asbestos-containing material (ACM) is defined as any material containing asbestos in a concentration greater than or equal to 1% as determined by visual evaluation, weight or point count analysis. Suspect building materials were either determined an asbestos-containing material by polarized light microscopy (PLM) or assumed an ACM in accordance with the Maine Department of Environmental Protection and US Environmental Protection Agency Rules and Regulations.

Eleven (11) samples were collected and analyzed for asbestos fibers.

Asbestos-containing materials listed in Table 1 have been identified in the demolition area. The building samples determined by analysis as either not being an asbestos containing material or not considered a suspect asbestos material are listed in Table 2.

TABLE 1: ASBESTOS CONTAINING MATERIALS (ACMs)

ACMs	DESCRIPTION
None	

TABLE 2: BUILDING MATERIALS NOT CONSIDERED ASBESTOS MATERIALS (NON-ACM)

BUILDING MATERIAL	DESCRIPTION
Pipe Insulation	Calcium Silicate Insulation in rewettable cloth wrap
Pipe Insulation	Calcium Silicate Insulation in aluminum protective cover (smooth)
Blown-in Insulation	Calcium Silicate Insulation in aluminum protective cover (corrugated)
Pipe Insulation	Fiberglas® insulation
Tank insulation	Fiberglas® insulation
Pipe Insulation	Expanded Glass

Recommendations include the following:

- R-1 Include a copy of this report with demolition permits and site demolition documentation.

4.0 CLOSURE

This report was prepared by Bates Environmental Health & Safety (BEHS) solely for the Owner. This survey, findings and report represent BEHS professional judgments based on generally accepted methodologies and assessments. Findings were based on visual inspections of suspect building materials in areas usually associated with adverse condition or those materials and on any architectural drawings of the facility supplied by the Owner or his representative. This survey does not include materials that are deemed inaccessible by generally-accepted sampling methodologies or due to unsafe conditions due to fire damage.

The scope of this survey is limited to the building materials and/or contaminants listed in Section 2. There cannot be a guarantee that all targeted materials or contaminants have been located or identified. Some of the reasons for this are the following: (1) sampling was performed on a random basis and the material was assumed to be homogeneous, (2) multiple samples were collected to minimize error; per EPA and other guidelines, there is a chance human error will create inconsistencies; and (3) in most cases, only exposed materials have been sampled. Note: Materials that are concealed, difficult to reach, or where the sampling would alter the integrity of a system (eg. roof), sampling may have to occur in coordination with controlled demolition. In any event, if conditions differ from those described in this report at some later date, we request the opportunity to review such differences to amend this report if needed.

This PDF report has been distributed via electronic mail to the following recipients:

Owner Contact: Mike Sloan, Pike Industries msloan@pikeindustries.com

No reproduction of this report is allowed, unless in full, without the written authorization from the Owner or BEHS. Alteration of this document is not allowed. Use by others is considered at their own risk. Authenticity confirmation can be viewed in the properties section of this software application.

Gary M. Bates, President

Asbestos DEP Consultant License No. SF-058
Inspector DEP Certificate No. AI-0039
Management Planner DEP Certificate No. MP-0031
Design Consultant DEP Certificate No. DC-0112

ATTACHMENT A
ASBESTOS LAB REPORTS

CERTIFICATE OF ANALYSIS

Client:	Bates Environ'tal Health&Safety	Report Date:	3/9/2012
	211 Soper Road	Report No.:	266549
	Orland ME 04472	Project:	Pike Industries-Plant 910
		Project No.:	

BULK SAMPLE ANALYSIS SUMMARY

Lab No.:	4584792	Description / Location:	White Pipe Insulation	
Client No.:	1A		E.Side	
<u>% Asbestos</u>	<u>Type</u>	<u>% Non-Asbestos Fibrous Material</u>	<u>Type</u>	<u>% Non-Fibrous Material</u>
None Detected	None Detected	15	Cellulose	85

Lab No.:	4584793	Description / Location:	White Pipe Insulation	
Client No.:	1B		E.Side	
<u>% Asbestos</u>	<u>Type</u>	<u>% Non-Asbestos Fibrous Material</u>	<u>Type</u>	<u>% Non-Fibrous Material</u>
None Detected	None Detected	15	Cellulose	85

Lab No.:	4584794	Description / Location:	White Pipe Insulation	
Client No.:	1C		E.Side	
<u>% Asbestos</u>	<u>Type</u>	<u>% Non-Asbestos Fibrous Material</u>	<u>Type</u>	<u>% Non-Fibrous Material</u>
None Detected	None Detected	15	Cellulose	85

Lab No.:	4584795	Description / Location:	White Pipe Insulation	
Client No.:	1D		E.Side	
<u>% Asbestos</u>	<u>Type</u>	<u>% Non-Asbestos Fibrous Material</u>	<u>Type</u>	<u>% Non-Fibrous Material</u>
None Detected	None Detected	15	Cellulose	85

Accreditation **NIST-NVLAP No. 101165-0** **NY-DOH No. 11021** **AIHA-LAP, LLC No. 100188**

*This confidential report relates only to those item(s) tested and does not represent an endorsement by NIST-NVLAP, AIHA or any agency of the U.S. government
This report shall not be reproduced except in full, without written approval of the laboratory.*

Analytical Method: EPA 600/R-93/116, by Polarized Light Microscopy

Comments: Quantification at <0.25% by volume is possible with this method. (PC) Indicates Stratified Point Count Method performed. (PC-Trace) means that asbestos was detected but is not quantifiable under the Point Counting regimen. Analysis includes all distinct separable layers in accordance with EPA 600 Method. If not reported or otherwise noted, layer is either not present or the client has specifically requested that it not be analyzed (ex. analyze until positive instructions). Small asbestos fibers may be missed by PLM due to resolution limitations of the optical microscope. Therefore, PLM is not consistently reliable in detecting asbestos in non-friable organically bound (NOB) materials. Quantitative transmission electron microscopy (TEM) is currently the only method that can pronounce materials as non-asbestos containing.

Analysis Performed By: R. Caran

Approved By: 

Date: 3/9/2012

Frank E. Ehrenfeld, III
Laboratory Director



9000 Commerce Parkway, Ste B
 Mount Laurel, NJ 08054
 Toll Free 877-428-4285
 Local: 856-231-9449
 Fax: 856-231-9818

CERTIFICATE OF ANALYSIS

Client:	Bates Environ'tal Health&Safety	Report Date:	3/9/2012
	211 Soper Road	Report No.:	266549
	Orland ME 04472	Project:	Pike Industries-Plant 910
		Project No.:	

BULK SAMPLE ANALYSIS SUMMARY

Lab No.:	4584796	Description / Location:	Tan Pipe Insulation	
Client No.:	2A		W. Side I	
<u>% Asbestos</u>	<u>Type</u>	<u>% Non-Asbestos Fibrous Material</u>	<u>Type</u>	<u>% Non-Fibrous Material</u>
None Detected	None Detected	10	Synthetic	90

Lab No.:	4584797	Description / Location:	Tan Pipe Insulation	
Client No.:	2B		W. Side I	
<u>% Asbestos</u>	<u>Type</u>	<u>% Non-Asbestos Fibrous Material</u>	<u>Type</u>	<u>% Non-Fibrous Material</u>
None Detected	None Detected	10	Synthetic	90

Lab No.:	4584798	Description / Location:	Tan Pipe Insulation	
Client No.:	2C		W. Side I	
<u>% Asbestos</u>	<u>Type</u>	<u>% Non-Asbestos Fibrous Material</u>	<u>Type</u>	<u>% Non-Fibrous Material</u>
None Detected	None Detected	10	Synthetic	90

Lab No.:	4584799	Description / Location:	White Pipe Insulation	
Client No.:	3A		W. Side II	
<u>% Asbestos</u>	<u>Type</u>	<u>% Non-Asbestos Fibrous Material</u>	<u>Type</u>	<u>% Non-Fibrous Material</u>
None Detected	None Detected	10	Cellulose	90

Accreditation **NIST-NVLAP No. 101165-0** **NY-DOH No. 11021** **AIHA-LAP, LLC No. 100188**

*This confidential report relates only to those item(s) tested and does not represent an endorsement by NIST-NVLAP, AIHA or any agency of the U.S. government
 This report shall not be reproduced except in full, without written approval of the laboratory.*

Analytical Method: EPA 600/R-93/116, by Polarized Light Microscopy

Comments: Quantification at <0.25% by volume is possible with this method. (PC) Indicates Stratified Point Count Method performed. (PC-Trace) means that asbestos was detected but is not quantifiable under the Point Counting regimen. Analysis includes all distinct separable layers in accordance with EPA 600 Method. If not reported or otherwise noted, layer is either not present or the client has specifically requested that it not be analyzed (ex. analyze until positive instructions). Small asbestos fibers may be missed by PLM due to resolution limitations of the optical microscope. Therefore, PLM is not consistently reliable in detecting asbestos in non-friable organically bound (NOB) materials. Quantitative transmission electron microscopy (TEM) is currently the only method that can pronounce materials as non-asbestos containing.

Analysis Performed By: R. Caran

Date: 3/9/2012



9000 Commerce Parkway, Ste B
 Mount Laurel, NJ 08054
 Toll Free 877-428-4285
 Local: 856-231-9449
 Fax: 856-231-9818

CERTIFICATE OF ANALYSIS

Client:	Bates Environ'tal Health&Safety 211 Soper Road Orland ME 04472	Report Date:	3/9/2012
		Report No:	266549
		Project:	Pike Industries-Plant 910
		Project No.:	

BULK SAMPLE ANALYSIS SUMMARY

Lab No.:	4584800	Description / Location:	White Pipe Insulation W. Side II	
Client No.:	3B			
<u>% Asbestos</u>	<u>Type</u>	<u>% Non-Asbestos Fibrous Material</u>	<u>Type</u>	<u>% Non-Fibrous Material</u>
None Detected	None Detected	10	Cellulose	90

Lab No.:	4584801A	Description / Location:	White Pipe Insulation W. Side II	
Client No.:	3C			
<u>% Asbestos</u>	<u>Type</u>	<u>% Non-Asbestos Fibrous Material</u>	<u>Type</u>	<u>% Non-Fibrous Material</u>
None Detected	None Detected	10	Cellulose	90

Lab No.:	4584801B	Description / Location:	White Pipe Insulation Platform	
Client No.:	4A			
<u>% Asbestos</u>	<u>Type</u>	<u>% Non-Asbestos Fibrous Material</u>	<u>Type</u>	<u>% Non-Fibrous Material</u>
None Detected	None Detected	5	Cellulose	95

Accreditation	NIST-NVLAP No. 101165-0	NY-DOH No. 11021	AIHA-LAP, LLC No. 100188
----------------------	-------------------------	------------------	--------------------------

*This confidential report relates only to those item(s) tested and does not represent an endorsement by NIST-NVLAP, AIHA or any agency of the U.S. government
 This report shall not be reproduced except in full, without written approval of the laboratory.*

Analytical Method: EPA 600/R-93/116, by Polarized Light Microscopy

Comments: Quantification at <0.25% by volume is possible with this method. (PC) Indicates Stratified Point Count Method performed. (PC-Trace) means that asbestos was detected but is not quantifiable under the Point Counting regimen. Analysis includes all distinct separable layers in accordance with EPA 600 Method. If not reported or otherwise noted, layer is either not present or the client has specifically requested that it not be analyzed (ex. analyze until positive instructions). Small asbestos fibers may be missed by PLM due to resolution limitations of the optical microscope. Therefore, PLM is not consistently reliable in detecting asbestos in non-friable organically bound (NOB) materials. Quantitative transmission electron microscopy (TEM) is currently the only method that can pronounce materials as non-asbestos containing.

Analysis Performed By: R. Caran

Date: 3/9/2012

ATTACHMENT B

PHOTOS



PHOTO 1 Bishop Street Asphalt Plant #910



PHOTO 2 Out buildings not included in survey



PHOTO 3 Non-ACM pipe insulation in smooth & corrugated aluminum covers



PHOTO 4 Non-ACM pipe & tank insulation