

DISPLAY THIS CARD ON PRINCIPAL FRONTAGE OF WORK



CITY OF PORTLAND BUILDING PERMIT

This is to certify that JOHN E LIBBY

Located At 11 GLEN HAVEN EAST

Job ID: 2012-08-4650-DRG

CBL: 277-G-039-001

has permission to allow (already constructed) 8' x 12' detached shed
provided that the person or persons, firm or corporation accepting this permit shall comply with all of the provisions of the Statues of Maine and of the Ordinances of the City of Portland regulating the construction, maintenance and use of the buildings and structures, and of the application on file in the department.

Notification of inspection and written permission procured before this building or part thereof is lathed or otherwise closed-in. 48 HOUR NOTICE IS REQUIRED.

A final inspection must be completed by owner before this building or part thereof is occupied. If a certificate of occupancy is required, it must be

N/A

Mary Schmitt 8/14/12

Fire Prevention Officer

Code Enforcement Officer / Plan Reviewer

THIS CARD MUST BE POSTED ON THE STREET SIDE OF THE PROPERTY
PENALTY FOR REMOVING THIS CARD

BUILDING PERMIT INSPECTION PROCEDURES

Please call 874-8703 or 874-8693 (ONLY)

or email: buildinginspections@portlandmaine.gov

With the issuance of this permit, the owner, builder or their designee is required to provide adequate notice to the city of Portland Inspections Services for the following inspections. Appointments must be requested 48 to 72 hours in advance of the required inspection. The inspection date will need to be confirmed by this office.

- **Please read the conditions of approval that is attached to this permit!! Contact this office if you have any questions.**
- **Permits expire in 6 months. If the project is not started or ceases for 6 months.**
- **If the inspection requirements are not followed as stated below additional fees may be incurred due to the issuance of a "Stop Work Order" and subsequent release to continue.**

***** Please call for a setback inspection *****

The project cannot move to the next phase prior to the required inspection and approval to continue, REGARDLESS OF THE NOTICE OF CIRCUMSTANCES.

IF THE PERMIT REQUIRES A CERTIFICATE OF OCCUPANCY, IT MUST BE PAID FOR AND ISSUED TO THE OWNER OR DESIGNEE BEFORE THE SPACE MAY BE OCCUPIED.



PORTLAND MAINE

Strengthening a Remarkable City, Building a Community for Life • www.portlandmaine.gov

Director of Planning and Urban Development
Jeff Levine

Job ID: 2012-08-4650-DRG

Located At: 11 GLEN HAVEN E

CBL: 277- G-039-001

Conditions of Approval:



Zoning

1. This permit is being approved on the basis of plans submitted. Any deviations shall require a separate approval before starting that work.
2. This property shall remain a single family dwelling. Any change of use shall require a separate permit application for review and approval.
3. As discussed during the review process, the property must be clearly identified prior to pouring concrete and compliance with the required setbacks must be established. Due to the proximity of the setbacks of the proposed addition, it may be required to be located by a surveyor.
4. Section R105.2 of the International Residential Code states that structures 200 square foot or under is exempt from building code review. This structure has not been reviewed for codes or safety under the building codes. The owner takes full responsibility for structural integrity.

City of Portland, Maine - Building or Use Permit Application

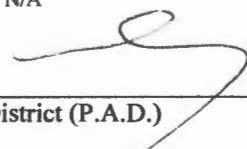
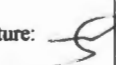
389 Congress Street, 04101 Tel: (207) 874-8703, FAX: (207) 8716

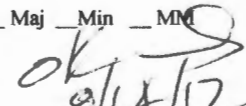
Job No: 2012-08-4650-DRG	Date Applied: 8/8/2012	CBL: 277- G-039-001	
Location of Construction: 11 GLEN HAVEN E	Owner Name: JOHN E LIBBY	Owner Address: 11 GLEN HAVEN ROAD EAST PORTLAND, ME 04102	Phone: 272-0487
Business Name:	Contractor Name: SELF	Contractor Address:	Phone:
Lessee/Buyer's Name:	Phone:	Permit Type: SHED	Zone: R-3
Past Use: Single family dwelling	Proposed Use: Same: Single Family dwelling - to erect a 8' x 12' detached shed	Cost of Work: \$1,000.00	CEO District:
		Fire Dept: <input type="checkbox"/> Approved <input type="checkbox"/> Denied <input checked="" type="checkbox"/> N/A	Inspection: Use Group: Type: NA
		Signature: 	Signature: 
Proposed Project Description: Construct shed (already constructed)		Pedestrian Activities District (P.A.D.)	
Permit Taken By: Brad		Zoning Approval	

<p>1. This permit application does not preclude the Applicant(s) from meeting applicable State and Federal Rules.</p> <p>2. Building Permits do not include plumbing, septic or electrical work.</p> <p>3. Building permits are void if work is not started within six (6) months of the date of issuance. False informatin may invalidate a building permit and stop all work.</p>	<p>Special Zone or Reviews</p> <p><input type="checkbox"/> Shoreland</p> <p><input type="checkbox"/> Wetlands</p> <p><input type="checkbox"/> Flood Zone</p> <p><input type="checkbox"/> Subdivision</p> <p><input type="checkbox"/> Site Plan</p> <p>___ Maj ___ Min ___ MM</p> <p>Date:  8/14/12</p>	<p>Zoning Appeal</p> <p><input type="checkbox"/> Variance</p> <p><input type="checkbox"/> Miscellaneous</p> <p><input type="checkbox"/> Conditional Use</p> <p><input type="checkbox"/> Interpretation</p> <p><input type="checkbox"/> Approved</p> <p><input type="checkbox"/> Denied</p> <p>Date:</p>	<p>Historic Preservation</p> <p><input checked="" type="checkbox"/> Not in Dist or Landmark</p> <p><input type="checkbox"/> Does not Require Review</p> <p><input type="checkbox"/> Requires Review</p> <p><input type="checkbox"/> Approved</p> <p><input type="checkbox"/> Approved w/Conditions</p> <p><input type="checkbox"/> Denied</p> <p>Date: </p>
	CERTIFICATION		

I hereby certify that I am the owner of record of the named property, or that the proposed work is authorized by the owner of record and that I have been authorized by the owner to make this application as his authorized agent and I agree to conform to all applicable laws of this jurisdiction. In addition, if a permit for work described in the appication is issued, I certify that the code official's authorized representative shall have the authority to enter all areas covered by such permit at any reasonable hour to enforce the provision of the code(s) applicable to such permit.

SIGNATURE OF APPLICANT	ADDRESS	DATE	PHONE
RESPONSIBLE PERSON IN CHARGE OF WORK, TITLE		DATE	PHONE

Entered 8/8/12

PR R-3



General Building Permit Application

If you or the property owner owes real estate or personal property taxes or user charges on any property within the City, payment arrangements must be made before permits of any kind are accepted.

2012-08-4650 - DR6

Location/Address of Construction: <u>11 Glen Haven rd E, Portland, ME 04102</u>		
Total Square Footage of Proposed Structure/Area <u>96</u>	Square Footage of Lot	Number of Stories <u>2</u>
Tax Assessor's Chart, Block & Lot Chart# Block# Lot# <u>277 G039</u>	Applicant: (must be owner, lessee or buyer) Name <u>John & Lindsay Libby</u> Address <u>11 Glen haven rd E</u> City, State & Zip <u>Portland ME 04102</u>	Telephone: <u>207-272-0487</u>
Lessee/DBA RECEIVED AUG 08 2012 Dept. of Building Inspections City of Portland Maine	Owner: (if different from applicant) Name Address City, State & Zip	Cost of Work: \$ <u>998</u> C of O Fee: \$ _____ Historic Review: \$ _____ Planning Amin.: \$ _____ Total Fee: \$ <u>30</u>
Current legal use (i.e. single family) <u>Shed</u> Number of Residential Units <u>0</u> If vacant, what was the previous use? _____ Proposed Specific use: <u>Store yard items, tools, lawn mower, snow blower etc.</u> Is property part of a subdivision? <u>NO</u> If yes, please name _____ Project description: <u>After the fact application; Assemble prefab shed obtained from lowes for \$998. Shed is 8' X 12'.</u>		
Contractor's name: _____ Email: _____ Address: _____ City, State & Zip _____ Telephone: _____ Who should we contact when the permit is ready: _____ Telephone: _____ Mailing address: _____		

Please submit all of the information outlined on the applicable checklist. Failure to do so will result in the automatic denial of your permit.

In order to be sure the City fully understands the full scope of the project, the Planning and Development Department may request additional information prior to the issuance of a permit. For further information or to download copies of this form and other applications visit the Inspections Division on-line at www.portlandmaine.gov, or stop by the Inspections Division office, room 315 City Hall or call 874-8703.

and I hereby certify that I am the Owner of record of the named property, or that the owner of record authorizes the proposed work and that I have been authorized by the owner to make this application as his/her authorized agent. I agree to conform to all applicable laws of this jurisdiction. In addition, if a permit for work described in this application is issued, I certify that the Code Official's authorized representative shall have the authority to enter all areas covered by this permit at any reasonable hour to enforce the provisions of the codes applicable to this permit.

Signature: John Libby Date: _____

This is not a permit; you may not commence ANY work until the permit is issued



PORTLAND MAINE

Strengthening a Remarkable City, Building a Community for Life • www.portlandmaine.gov

Receipts Details:

Tender Information: Check , Check Number: 476710

Tender Amount: 30.00

Receipt Header:

Cashier Id: bsaucier

Receipt Date: 8/8/2012

Receipt Number: 46842

Receipt Details:

Reference ID:	7550	Fee Type:	BP-Constr
Receipt Number:	0	Payment Date:	
Transaction Amount:	30.00	Charge Amount:	30.00
Job ID: Job ID: 2012-08-4650-DRG - Construct shed (already constructed)			
Additional Comments: 11 Glen Haven Rd E			

Thank You for your Payment!

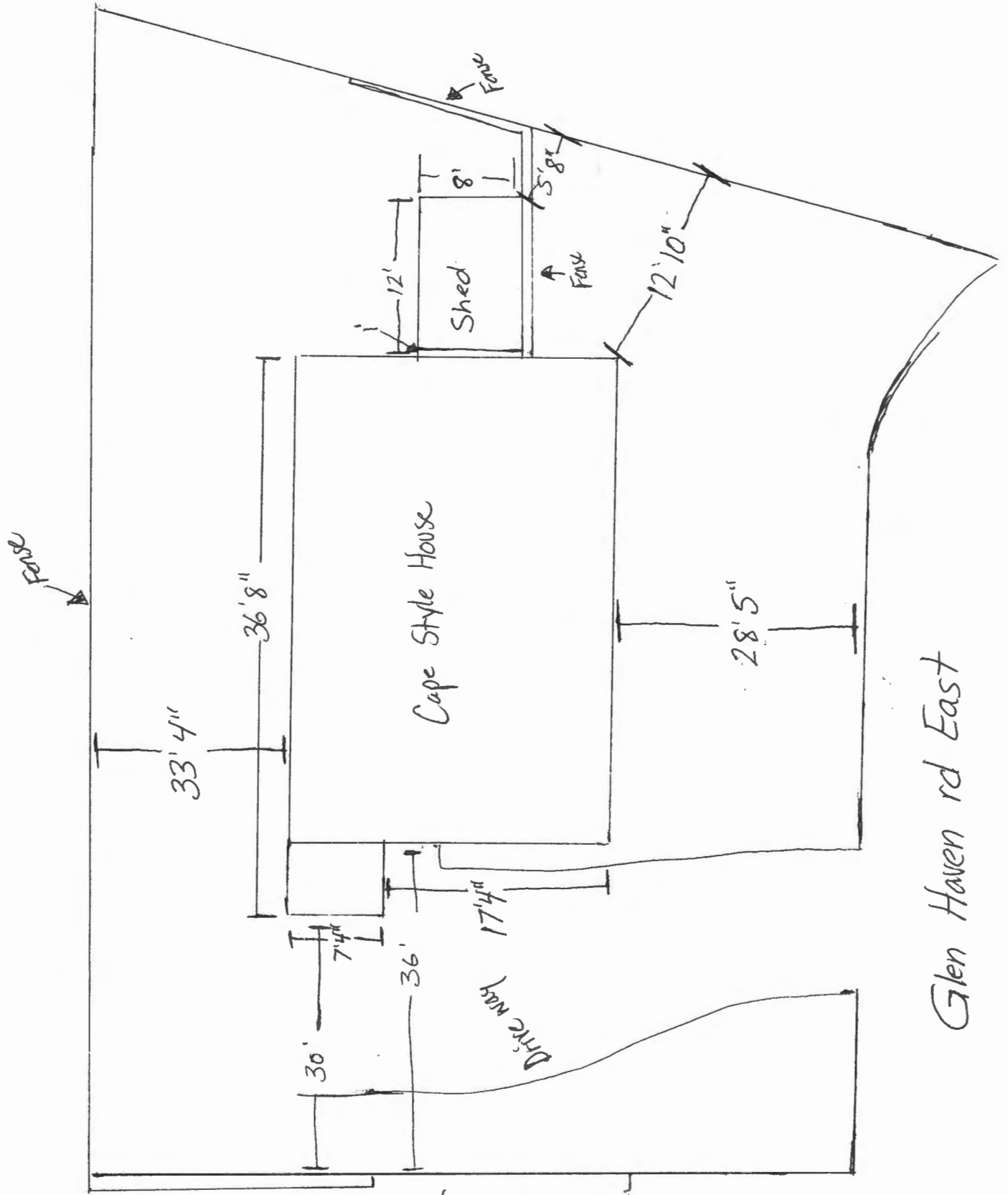

Glen Haven rd East

Fence

R-3 Zone
 14' x 4'

Rear: 5' min -
 33' + shown

Side: 5' min -
 5' 8" shown

Front: 25' min
 28' + shown

N