

City of Portland, Maine - Building or Use Permit

389 Congress Street, 04101 Tel: (207) 874-8703, Fax: (207) 874-8716

Permit No: 03-1158	Date Applied For: 09/23/2003	CBL: 277 I011001
-----------------------	---------------------------------	---------------------

Location of Construction: 45 Glen Haven West Rd	Owner Name: Petersen John W & Carlene F	Owner Address: 45 Glen Haven West	Phone:
Business Name:	Contractor Name: self	Contractor Address: Portland	Phone
Lessee/Buyer's Name	Phone:	Permit Type: Sheds	

Proposed Use: Single Family w/shed & deck	Proposed Project Description: Build 8x8 wood frame shed & 8x17x4 deck
--	--

Dept: Zoning	Status: Approved	Reviewer: Jeanine Bourke	Approval Date: 09/23/2003
Note:			Ok to Issue: <input checked="" type="checkbox"/>
Dept: Building	Status: Approved	Reviewer: Jeanine Bourke	Approval Date: 09/23/2003
Note:			Ok to Issue: <input checked="" type="checkbox"/>
1) Per John P. The deck was built w/o a permit, in error. He understands that upon inspection one of the sono tubes must be exposed for depth and the framing must be available to inspect.			

All Purpose Building Permit Application

If you or the property owner owes real estate or personal property taxes or user charges on any property within the City, payment arrangements must be made before permits of any kind are accepted.

Location/Address of Construction: <u>45 GLEN HAVEN Rd. - WEST PORTLAND</u>		
Total Square Footage of Proposed Structure <u>64'</u>	Square Footage of Lot <u>7000'</u>	
Tax Assessor's Chart, Block & Lot Chart# <u>MAP 277</u> Block# Lot# <u>I-11</u>	Owner: <u>JOHN PETERSEN</u>	Telephone: <u>874-0288 - H</u> <u>854-1731 - W</u>
Lessee/Buyer's Name (if Applicable)	Applicant name, address & telephone:	Cost Of Work: \$ <u>15.50</u> Fee: \$ <u>39.00</u>
Current use: <u>SF Home</u>		
If the location is currently vacant, what was prior use: _____		
Approximately how long has it been vacant: _____		
Proposed use: <u>STORAGE SHED FOR LAWN MOWER, SNOWBLOWER, etc.</u>		
Project description: <u>8 X 8 WOODEN STORAGE SHED 8 X 17 L shaped deck</u>		
Contractor's name, address & telephone:		
Who should we contact when the permit is ready: _____		
Mailing address:		
We will contact you by phone when the permit is ready. You must come in and pick up the permit and review the requirements before starting any work, with a Plan Reviewer. A stop work order will be issued and a \$100.00 fee if any work starts before the permit is picked up. PHONE:		

IF THE REQUIRED INFORMATION IS NOT INCLUDED IN THE SUBMISSIONS THE PERMIT WILL BE AUTOMATICALLY DENIED AT THE DISCRETION OF THE BUILDING/PLANNING DEPARTMENT, WE MAY REQUIRE ADDITIONAL INFORMATION IN ORDER TO APPROVE THIS PERMIT.

I hereby certify that I am the Owner of record of the named property, or that the owner of record authorizes the proposed work and that I have been authorized by the owner to make this application as his/her authorized agent. I agree to conform to all applicable laws of this jurisdiction. In addition, if a permit for work described in this application is issued, I certify that the Code Official's authorized representative shall have the authority to enter all areas covered by this permit at any reasonable hour to enforce the provisions of the codes applicable to this permit.

Signature of applicant:	Date:
-------------------------	-------

**This is NOT a permit, you may not commence ANY work until the permit is issued.
If you are in a Historic District you may be subject to additional permitting and fees with the
Planning Department on the 4th floor of City Hall**

This page contains a detailed description of the Parcel ID you selected. Press the **New Search** button at the bottom of the screen to submit a new query.

Current Owner Information

Card Number 1 of 1
 Parcel ID 277 I011001
 Location 45 GLEN HAVEN WEST RD
 Land Use SINGLE FAMILY

Owner Address PETERSEN JOHN W & CARLENE F
 45 GLEN HAVEN WEST
 PORTLAND ME 04102

Book/Page 10801/229
 Legal 277-I-11
 GLEN HAVEN WEST 43-47
 7000 SF

1 PM
John.
8x8 Shed
#1158

Valuation Information

Land	Building	Total
\$33,080	\$52,180	\$85,260

7000
x 25%
1,750 \$

Property Information

Year Built	Style	Story Height	Sq. Ft.	Total Acres
1960	Cape	1	829	0.161
Bedrooms	Full Baths	Half Baths	Total Rooms	Attic
3	1		6	None
				Basement
				Full

Outbuildings

Type	Quantity	Year Built	Size	Grade	Condition
SHED-FRAME	1	1975	8x12	D	A

Removed

Sales Information

Date	Type	Price	Book/Page
06/30/1993	LAND + BLDING	\$103,900	10801-229

OK

Picture and Sketch

Picture Sketch

816
64-shed
64-deck
36-deck
980

[Click here to view Tax Roll Information.](#)

Any information concerning tax payments should be directed to the Treasury office at 874-8490 or e-mailed.



SHED MATERIALS

- 8x8 PRE CUT STORAGE SHED
- T1-11 SIDING
- WAFER BOARD ROOF w/ ASPHALT SHINGLE
- ROOF
2x4 Rafters
- 2x4 STUDING ON INSIDE
- 1/2" CDX Plywood FOR FLOOR
- SITTING ON 4x4 OAK FLOOR JOIST

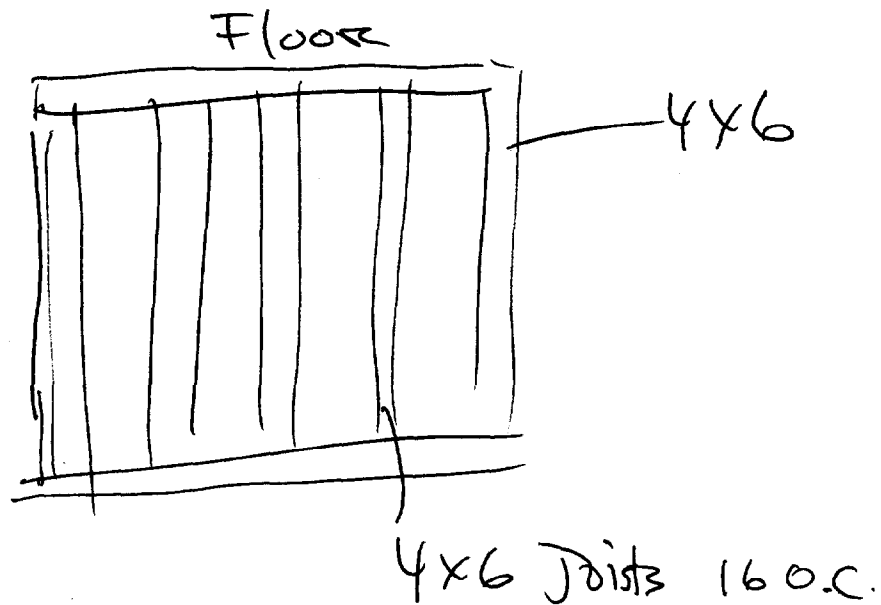

R3 Zone

Front 25' Req 38' shown
Rear 25' Req 38' shown
Side 8' Req 26' shown
50'

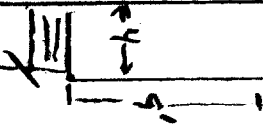
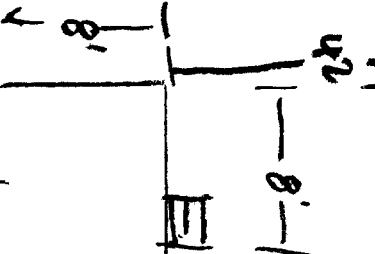
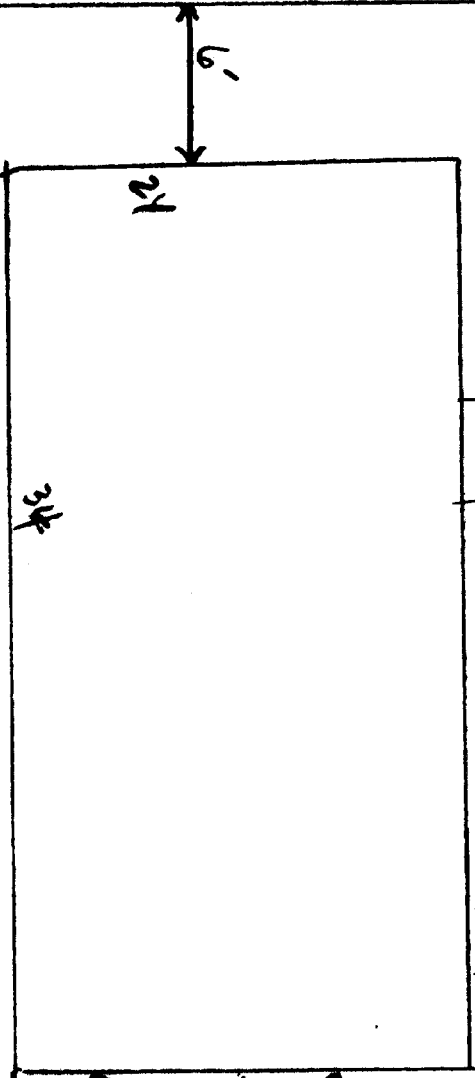
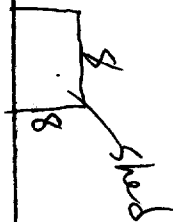

189.

DRIVEWAY

30

101

Glen Haven

100 ↗

← 70 →

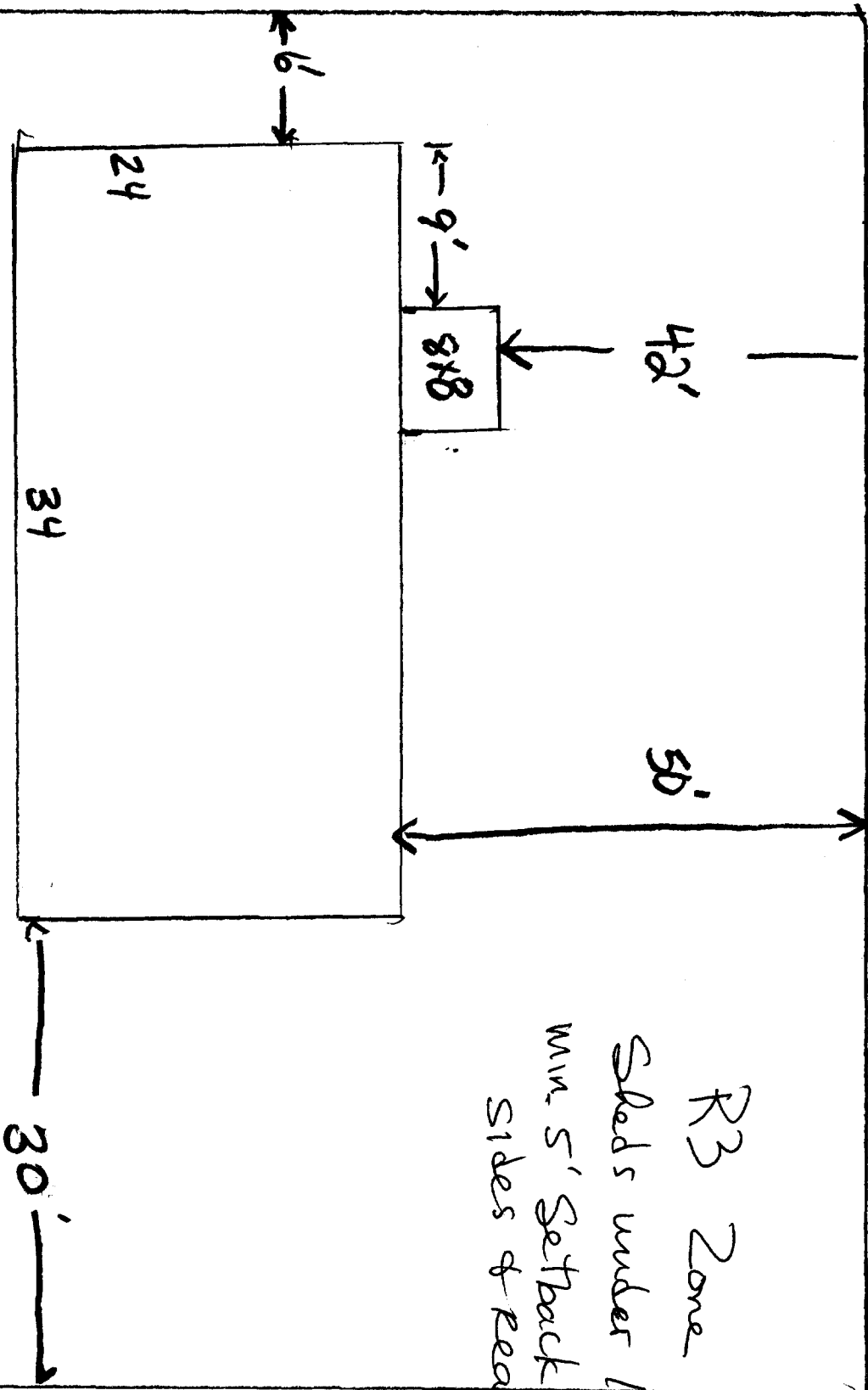

R3 Zone
Sheds under 100 sq ft
min. 5' Setback
sides & rear



It's Easy...It's Handy

Ready-To-Assemble Wooden Storage Building Kits
Do-It-Yourself and SAVE!

REGENT II

SKU# 103-123 or 143-512**

- 6'h sidewall; 8'h peak
- 4'w x 6'h pre-assembled, pre-hung double doors
- FREE treated wood floor frame ready for your plywood or OSB decking*. Just add:
- (2) 48" x 92-1/2" Panels

Specifications

Nominal Size	Cu. Ft.	Storage	Weight	Actual Floor Size	Door Size	Exterior Paint or Stain	Trim	Siding	Edge	Drip	Roof	Floor	Decking
8'w x 8'd x 8'h	436		642 lbs.	8'w x 7' 8-1/2"d	4'w x 6'h	1 qt.	1-1/2 gal.	40'	4 bundles	See Above			

ITEMS FURNISHED BY HOMEOWNER

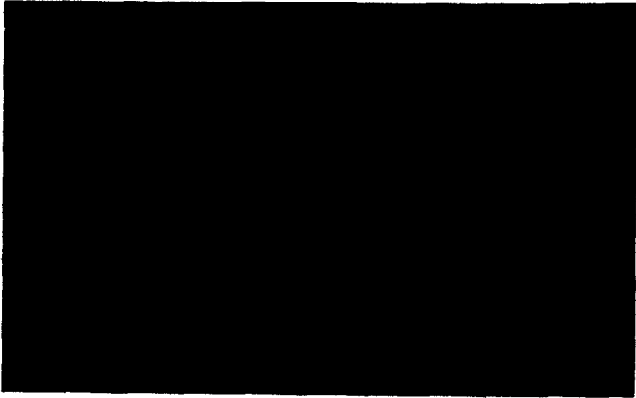

PRINCETON

10'x10' SKU# 660-356 or 143-512**
 10'x14' SKU# 143-512** or 660-356 + 491-073

- 6'h sidewall; 8'h peak
- 5.4'w x 6'h pre-assembled, pre-hung double doors
- FREE treated wood floor frame ready for your plywood or OSB decking*. Just add:
- (2) 48" x 92-1/2" Panels
- (1) 23-7/8" x 96" Panel
- (2) 48" x 72" Panel
- (1) 23-7/8" x 92-1/2" Panel
- (1) 23-7/8" x 92-1/2" Panel
- (1) 23-7/8" x 72" Panel

10' X 10' Princeton

10' X 14' Princeton**

Specifications

Nominal Size	Cu. Ft.	Storage	Weight	Actual Floor Size	Door Size	Exterior Paint or Stain	Trim	Siding	Edge	Drip	Roof	Floor	Decking
10'w x 10'd x 8'h	705		850 lbs.	10'w x 9' 8-1/2"d	5.4'w x 6'h	1 qt.	2 gal.	50'	5 bundles	See Above			
10'w x 14'd x 8'h	987		1091 lbs.	10'w x 13' 8-1/2"d	5.4'w x 6'h	1 qt.	2-1/2 gal.	60'	7 bundles	See Above			

ITEMS FURNISHED BY HOMEOWNER

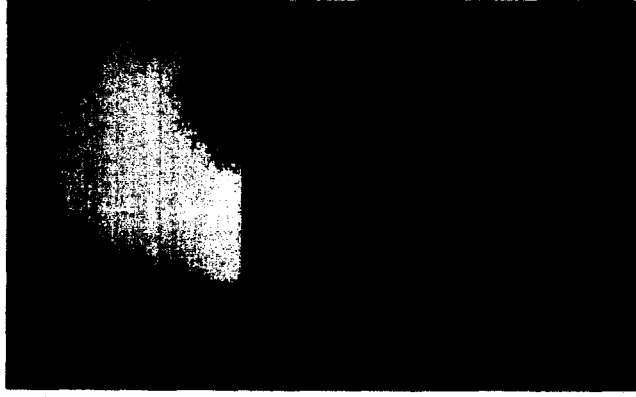



Ready-To-Assemble Wooden Storage Building Kits Do-It-Yourself and SAVE!

**Special
Value!**
Includes FREE
Treated Wood Floor Frame
*Ready for your wood floor panels**
**See reverse side
for details**

Why WOOD?



Less than 4" space

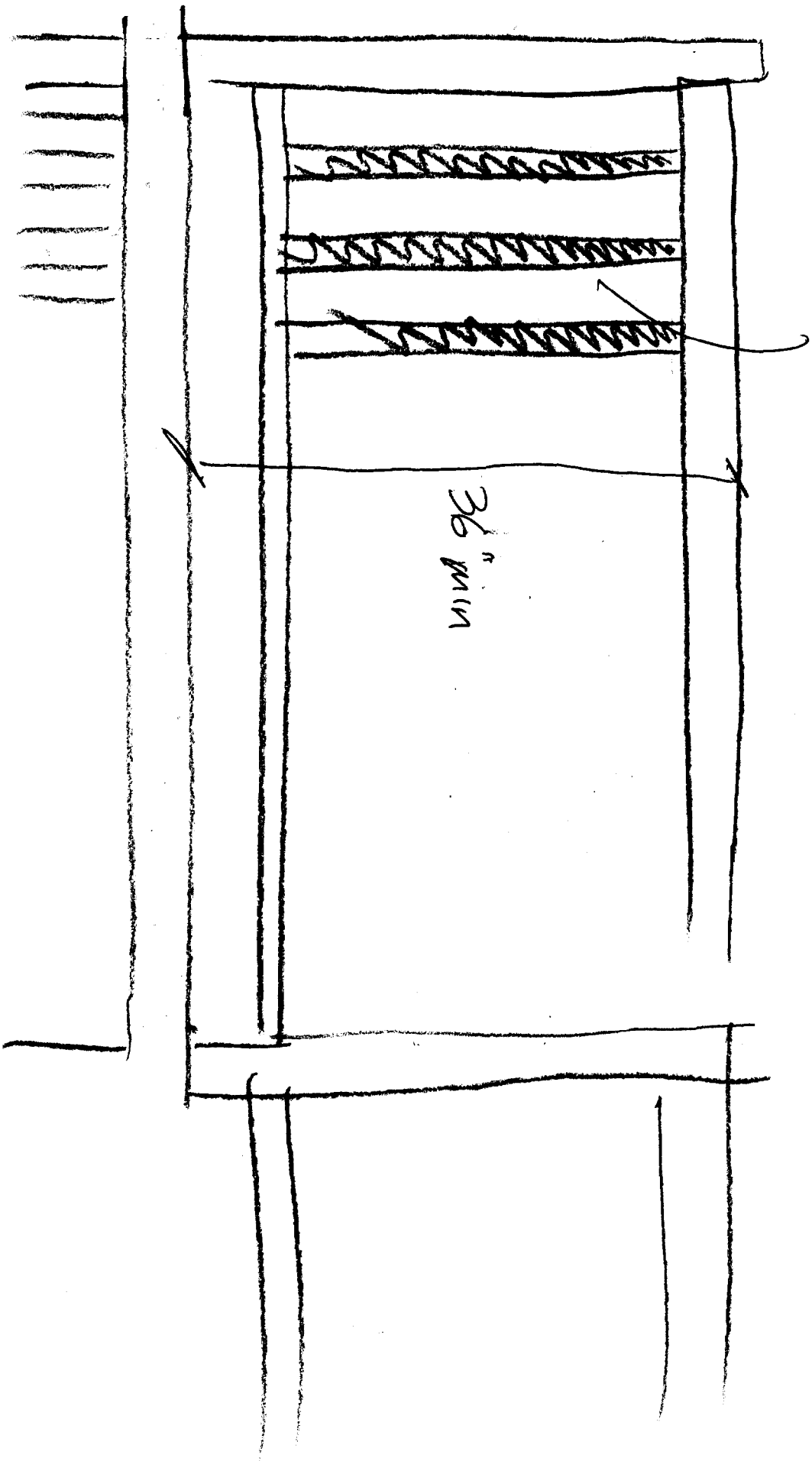

CROSS SECTION OF RAILING & POSTS

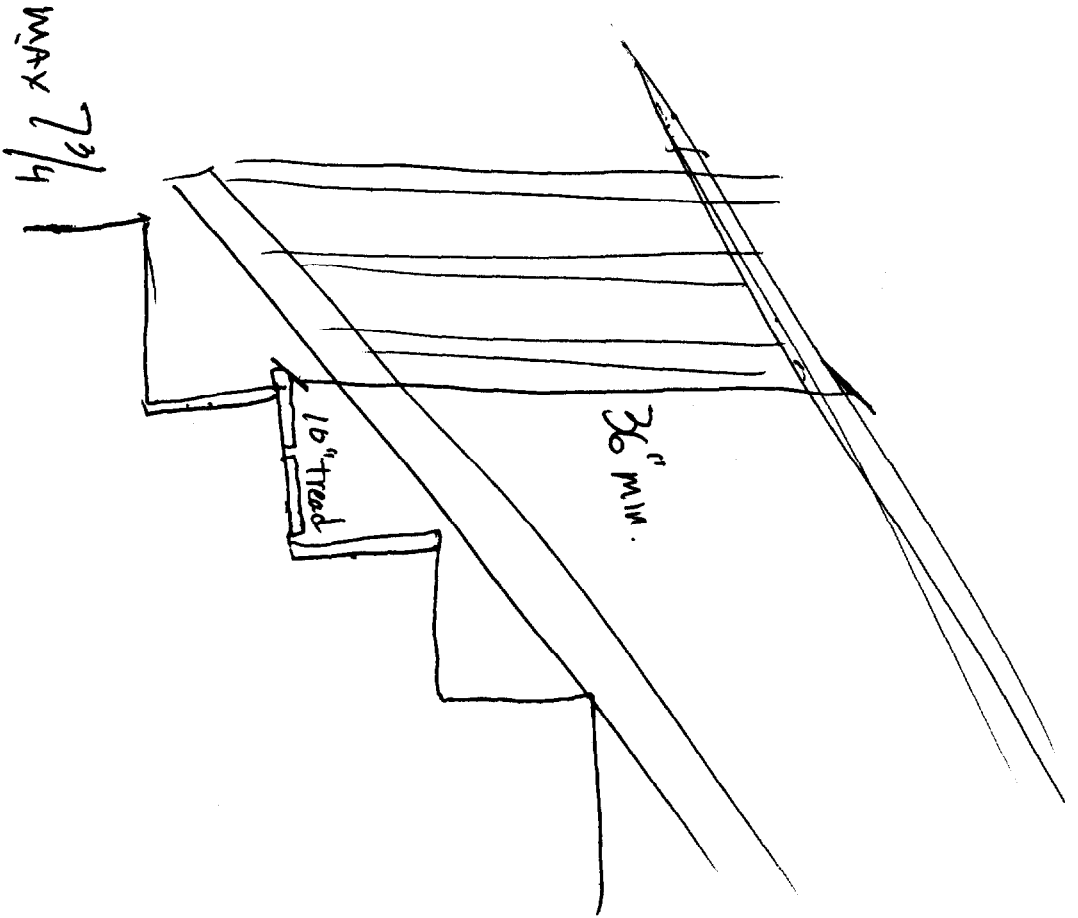

Combination Guard/Handrail 36"
 or
 attached graspable trail
 @ 34-38
 w/ends returned

DECK MATERIAL

- 4x4x8'10" P.T. SUNK ^{4'} $2\frac{1}{2}'$ INTO GROUND IN CONCRETE
- 2x4 PT FOR TOP & BOTTOM OF RAILING
- P.T. DECORATIVE POSTS FOR EDGING
- Floor joist to be 2x12 P.T. RUNNING 16" ON CENTER
- Floors to be 5/4x6 PT DECKING

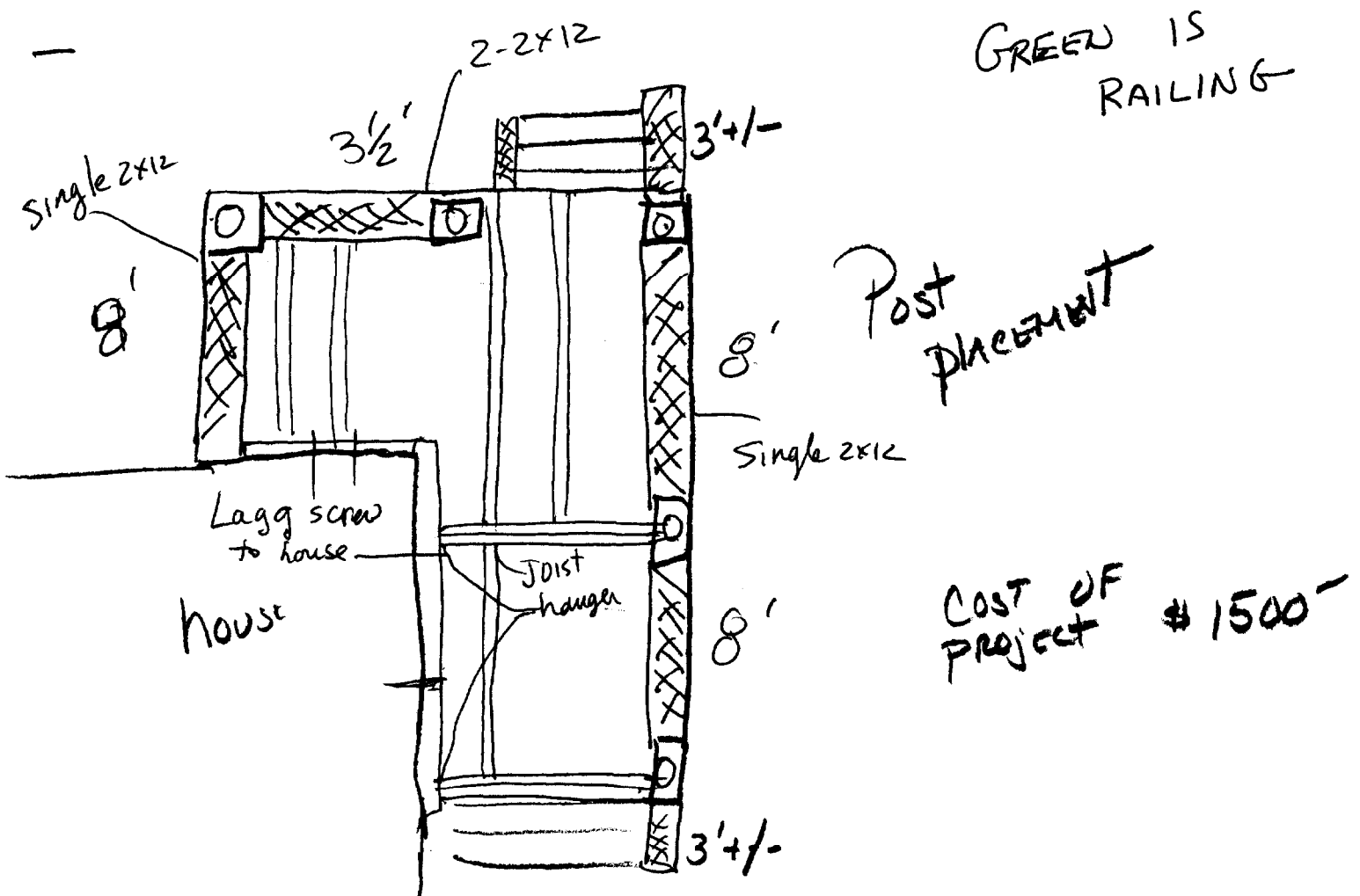

BUILDING PERMIT INSPECTION PROCEDURES

Please call 874-8703 or ~~874-8693~~ to schedule your inspections as agreed upon

Permits expire in 6 months, if the project is not started or ceases for 6 months.

The Owner or their designee is required to notify the inspections office for the following inspections and provide adequate notice. Notice must be called in 48-72 hours in advance in order to schedule an inspection:

By initializing at each inspection time, you are agreeing that you understand the inspection procedure and additional fees from a "Stop Work Order" and "Stop Work Order Release" will be incurred if the procedure is not followed as stated below.

JB Pre-construction Meeting: Must be scheduled with your inspection team upon receipt of this permit. Jay Reynolds, Development Review Coordinator at 874-8693 must also be contacted at this time, before any site work begins on any project other than single family additions or alterations.

Footing/Building Location Inspection: Prior to pouring concrete

NA Re-Bar Schedule Inspection: Prior to pouring concrete

NA Foundation Inspection: Prior to placing ANY backfill

NA Framing/Rough Plumbing/Electrical: Prior to any insulating or drywalling

Final/Certificate of Occupancy: Prior to any occupancy of the structure or use. NOTE: ~~There is a \$75.00 fee per inspection at this point.~~

Certificate of Occupancy is not required for certain projects. Your inspector can advise you if your project requires a Certificate of Occupancy. All projects DO require a final inspection

If any of the inspections do not occur, the project cannot go on to the next phase, REGARDLESS OF THE NOTICE OR CIRCUMSTANCES.

NA **CERTIFICATE OF OCCUPANCIES MUST BE ISSUED AND PAID FOR, BEFORE THE SPACE MAY BE OCCUPIED**

[Signature]
Signature of applicant/designee

9/23/03
Date

[Signature]
Signature of Inspections Official

9/23/03
Date

CBL 277-F-11 Building Permit #: 03-1158

*note:
after the fact
permit
on deck
Homeowner not
aware permit
was required*

DISPLAY THIS CARD ON PRINCIPAL FRONTAGE OF WORK

CITY OF PORTLAND

BUILDING INSPECTION

Please Read Application And Notes, if Any, Attached

CITY OF PORTLAND

Permit Number: 031158

SEP 23 2003

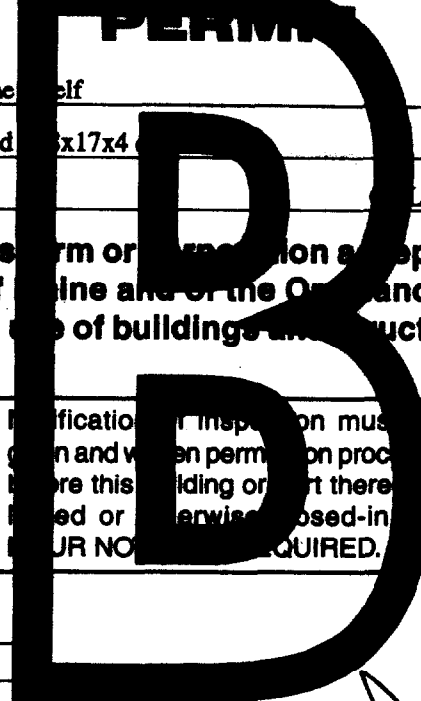

This is to certify that Petersen John W & Carlene self

has permission to Build 8x8 wood frame shed 8x17x4

PERMIT ISSUED

AT 45 Glen Haven West Rd

PL 277 I011001

provided that the person or persons firm or corporation accepting this permit shall comply with all of the provisions of the Statutes of the State and of the Ordinances of the City of Portland regulating the construction, maintenance and use of buildings and structures, and of the application on file in this department.

Apply to Public Works for street line and grade if nature of work requires such information.

Notification of inspection must be given and when permission proceeds before this building or part thereof is erected or otherwise closed-in. NO OTHER NOTICES REQUIRED.

A certificate of occupancy must be procured by owner before this building or part thereof is occupied.

OTHER REQUIRED APPROVALS
PERMIT ISSUED

Fire Dept. _____

Health Dept. _____

Appeal Board SEP 23 2003

Other _____

Department Name
CITY OF PORTLAND

Janice Bonke 9/23/03
Director - Building & Inspection Services

PENALTY FOR REMOVING THIS CARD