

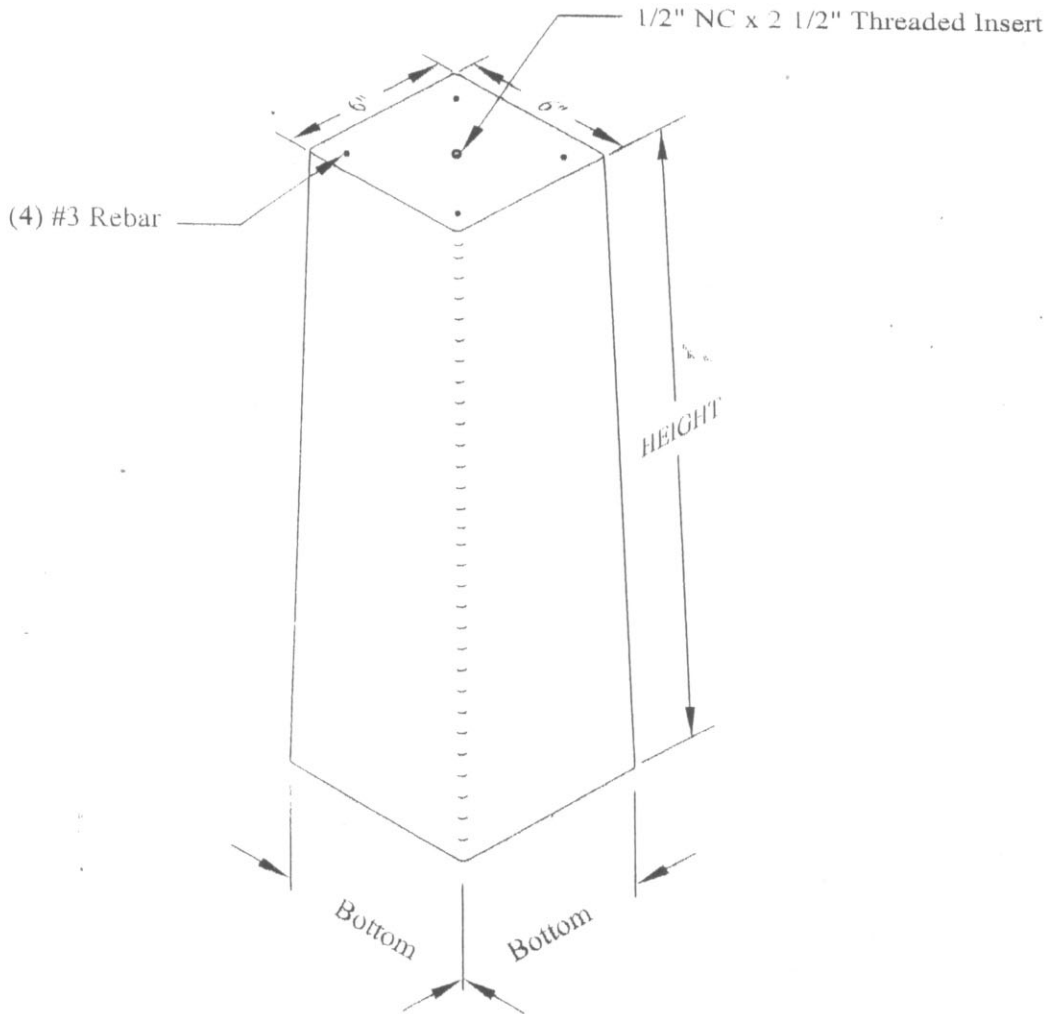

PRECAST CONCRETE PIERS



ELEVATION

Height (Feet)	Bottom (Inches)	Item #	Weight
4'-0"	9"	21740	230 lbs.
5'-0"	10"	21750	340 lbs.
6'-0"	11"	21760	450 lbs.

DESIGN NOTES:

- 1) Concrete Mix Design is 4,000 PSI standard at 28 days, Type 3 Cement.
- 2) Reinforcing Steel ASTM A 615, Grade 60
- 2) Smooth Finish on all exposed surfaces.