

PERMIT ISSUED

City of Portland, Maine - Building or Use Permit Application
 389 Congress Street, 04101 Tel: (207) 874-8703, Fax: (207) 874-8716

Permit No: 03-1186	Issue Date: SEP 29 2003	CBL: 277 F010001
-----------------------	-----------------------------------	---------------------

Location of Construction: 32 Glen Haven West Rd	Owner Name: Provencher Jason M &	Owner Address: 32 Glen Haven Rd CITY OF PORTLAND	Phone: 773-5315
Business Name:	Contractor Name: Right Angle Remodeling	Contractor Address: 53 Central Street Westbrook	Phone: 2078566368
Lessee/Buyer's Name:	Phone:	Permit Type: Alterations - Dwellings	Zone: R3

Past Use: Single Family	Proposed Use: Single Family w/dormer	Permit Fee: \$228.00	Cost of Work: \$23,000.00	CEO District: 3
----------------------------	---	-------------------------	------------------------------	--------------------

Proposed Project Description: Build 32' shed dormer in rear	FIRE DEPT: <input type="checkbox"/> Approved <input type="checkbox"/> Denied INSPECTION: Use Group: R3 Type: Append 5B BOCA 1999 Signature: JMB 9/29/03
--	--

Signature:	Signature: JMB 9/29/03
PEDESTRIAN ACTIVITIES DISTRICT (P.A.D.)	
Action: <input type="checkbox"/> Approved <input type="checkbox"/> Approved w/Conditions <input type="checkbox"/> Denied	
Signature:	Date:

Permit Taken By: jmb	Date Applied For: 09/29/2003	Zoning Approval
-------------------------	---------------------------------	------------------------

1. This permit application does not preclude the Applicant(s) from meeting applicable State and Federal Rules. 2. Building permits do not include plumbing, septic or electrical work. 3. Building permits are void if work is not started within six (6) months of the date of issuance. False information may invalidate a building permit and stop all work..	Special Zone or Reviews <input type="checkbox"/> Shoreland <input type="checkbox"/> Wetland Approved <input type="checkbox"/> Flood Zone <input type="checkbox"/> Subdivision <input type="checkbox"/> Site Plan Maj <input type="checkbox"/> Minor <input type="checkbox"/> MM <input type="checkbox"/> Date: 9/29/03 JMB	Zoning Appeal <input type="checkbox"/> Variance <input type="checkbox"/> Miscellaneous <input type="checkbox"/> Conditional Use <input type="checkbox"/> Interpretation <input type="checkbox"/> Approved <input type="checkbox"/> Denied Date:	Historic Preservation <input checked="" type="checkbox"/> Not in District or Landmark <input type="checkbox"/> Does Not Require Review <input type="checkbox"/> Requires Review <input type="checkbox"/> Approved <input type="checkbox"/> Approved w/Conditions <input type="checkbox"/> Denied Date: JMB
--	--	--	--

CERTIFICATION

I hereby certify that I am the owner of record of the named property, or that the proposed work is authorized by the owner of record and that I have been authorized by the owner to make this application as his authorized agent and I agree to conform to all applicable laws of this jurisdiction. In addition, if a permit for work described in the application is issued, I certify that the code official's authorized representative shall have the authority to enter all areas covered by such permit at any reasonable hour to enforce the provision of the code(s) applicable to such permit.

SIGNATURE OF APPLICANT	ADDRESS	DATE	PHONE
RESPONSIBLE PERSON IN CHARGE OF WORK, TITLE		DATE	PHONE

City of Portland, Maine - Building or Use Permit

389 Congress Street, 04101 Tel: (207) 874-8703, Fax: (207) 874-8716

Permit No: 03-1186	Date Applied For: 09/29/2003	CBL: 277 F010001
------------------------------	--	----------------------------

Location of Construction: 32 Glen Haven West Rd	Owner Name: Provencher Jason M &	Owner Address: 32 Glen Haven Rd W	Phone: () 773-5315
Business Name:	Contractor Name: Right Angle Remodeling	Contractor Address: 53 Central Street Westbrook	Phone: (207) 856-6368
Lessee/Buyer's Name	Phone:	Permit Type: Alterations - Dwellings	

Proposed Use: Single Family w/dormer	Proposed Project Description: Build 32' shed dormer in rear
--	---

Dept: Zoning **Status:** Approved **Reviewer:** Jeanine Bourke **Approval Date:** 09/29/2003

Note: **Ok to Issue:**

- 1) This property shall remain a single family dwelling. Any change of use shall require a separate permit application for review and approval.

Dept: Building **Status:** Approved **Reviewer:** Jeanine Bourke **Approval Date:** 09/29/2003

Note: **Ok to Issue:**

- 1) Separate permits are required for any electrical or plumbing work.
- 2) Application approval based upon information provided by applicant. Any deviation from approved plans requires separate review and approval prior to work.

All Purpose Building Permit Application

If you or the property owner owes real estate or personal property taxes or user charges on any property within the City, payment arrangements must be made before permits of any kind are accepted.

Location/Address of Construction: <u>32 Glen Haven Road WEST PORTLAND</u>		
Total Square Footage of Proposed Structure <u>384</u>	Square Footage of Lot <u>10,484</u>	
Tax Assessor's Chart, Block & Lot Chart# <u>277</u> Block# <u>F</u> Lot# <u>10</u>	Owner: <u>JASON + TINA PROVENCHER</u>	Telephone: <u>773.5315</u>
Lessee/Buyer's Name (if Applicable)	Applicant name, address & telephone: <u>Mark & Fournie 53 Central Street Westbrook M.E. 04092</u>	Cost Of Work: \$ <u>2360.00</u> Fee: \$ <u>228.00</u>
Current use: <u>Single Family Home</u>		
If the location is currently vacant, what was prior use: _____		
Approximately how long has it been vacant: _____		
Proposed use: _____		
Project description: <u>Full 32' Shed Dormer</u>		
Contractor's name, address & telephone: <u>Right Angle Remodeling Inc. 53 Central Street Westbrook M.E.</u>		
Who should we contact when the permit is ready: <u>Mark & Fournie</u>		
Mailing address: <u>53 Central Street Westbrook M.E. 04092</u>		
We will contact you by phone when the permit is ready. You must come in and pick up the permit and review the requirements before starting any work, with a Plan Reviewer. A stop work order will be issued and a \$100.00 fee if any work starts before the permit is picked up. PHONE: <u>856-6368</u>		

IF THE REQUIRED INFORMATION IS NOT INCLUDED IN THE SUBMISSIONS THE PERMIT WILL BE AUTOMATICALLY DENIED AT THE DISCRETION OF THE BUILDING/PLANNING DEPARTMENT, WE MAY REQUIRE ADDITIONAL INFORMATION IN ORDER TO APPROVE THIS PERMIT.

I hereby certify that I am the Owner of record of the named property, or that the owner of record authorizes the proposed work and that I have been authorized by the owner to make this application as his/her authorized agent. I agree to conform to all applicable laws of this jurisdiction. In addition, if a permit for work described in this application is issued, I certify that the Code Official's authorized representative shall have the authority to enter all areas covered by this permit at any reasonable hour to enforce the provisions of the codes applicable to this permit.

Signature of applicant: <u>Mark Fournie</u>	Date: <u>8/22/03</u>
---	----------------------

**This is NOT a permit, you may not commence ANY work until the permit is issued.
If you are in a Historic District you may be subject to additional permitting and fees with the
Planning Department on the 4th floor of City Hall**

This page contains a detailed description of the Parcel ID you selected. Press the **New Search** button at the bottom of the screen to submit a new query.

Current Owner Information

Card Number 1 of 1
 Parcel ID 277 F010001
 Location 32 GLEN HAVEN WEST RD
 Land Use SINGLE FAMILY

Owner Address
 PROVENCHER JASON M & TINA L JTS
 32 GLEN HAVEN RD W
 PORTLAND ME 04102

Book/Page 14892/91
 Legal 277-F-10
 GLEN HAVEN WEST 32-34
 10484 SF

*Mark
 2 PM
 R3 Zone*

Valuation Information

Land	Building	Total
\$32,550	\$61,220	\$93,770

Property Information

Year Built 1959	Style Cape	Story Height 1	Sq. Ft. 1093	Total Acres 0.241
Bedrooms 3	Full Baths 1	Half Baths	Total Rooms 6	Attic Full Finsh
				Basement Full

Outbuildings

Type SHED-FRAME	Quantity 1	Year Built 1980	Size 10X12	Grade C	Condition A
--------------------	---------------	--------------------	---------------	------------	----------------

Sales Information

Date	Type	Price	Book/Page
07/09/1999	LAND + BLDING	\$101,000	14892-091
06/04/1998	LAND + BLDING	\$78,550	13873-151
04/06/1998	LAND + BLDING		13720-039
06/18/1997	LAND + BLDING		13143-337
07/20/1992	LAND + BLDING		10197-099

Picture and Sketch

Picture Sketch

[Click here](#) to view Tax Roll Information.

Any information concerning tax payments should be directed to the Treasury office at 874-8490 or e-mailed.





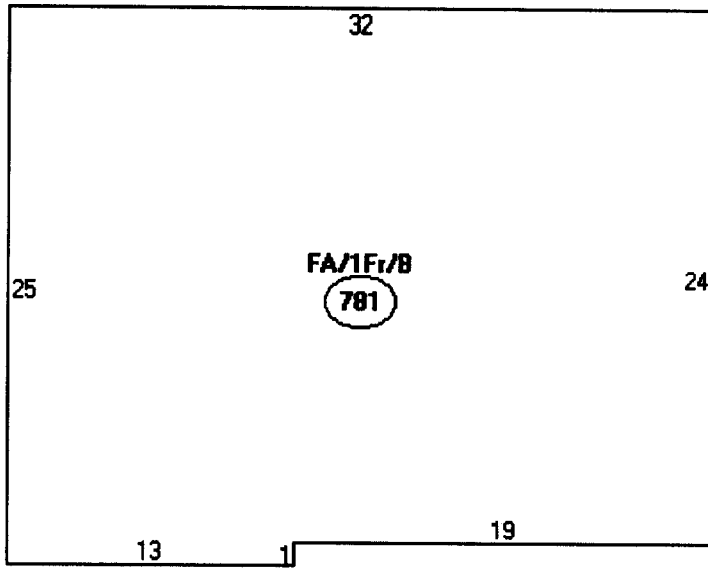

Descriptor/Area
A: FA/1Fr/B
781 sqft

BUILDING PERMIT INSPECTION PROCEDURES

Please call 874-8703 or ~~874-8693~~ to schedule your inspections as agreed upon

Permits expire in 6 months, if the project is not started or ceases for 6 months.

The Owner or their designee is required to notify the inspections office for the following inspections and provide adequate notice. Notice must be called in 48-72 hours in advance in order to schedule an inspection:

By initialzing at each inspection time, you are agreeing that you understand the inspection procedure and additional fees from a "Stop Work Order" and "Stop Work Order Release" will be incurred if the procedure is not followed as stated below.

JB **Pre-construction Meeting:** Must be scheduled with your inspection team upon receipt of this permit. Jay Reynolds, Development Review Coordinator at 874-8632 must also be contacted at this time, before any site work begins on any project other than single family additions or alterations.

NA **Footing/Building Location Inspection:** Prior to pouring concrete

NA **Re-Bar Schedule Inspection:** Prior to pouring concrete

NA **Foundation Inspection:** Prior to placing ANY backfill

✓ **Framing/Rough Plumbing/Electrical:** Prior to any insulating or drywalling

✓ **Final/Certificate of Occupancy:** Prior to any occupancy of the structure or use. ~~NOTE: There is a \$75.00 fee per inspection at this point.~~

Certificate of Occupancy is not required for certain projects. Your inspector can advise you if your project requires a Certificate of Occupancy. All projects DO require a final inspection

✓ If any of the inspections do not occur, the project cannot go on to the next phase, REGARDLESS OF THE NOTICE OR CIRCUMSTANCES.

NA **CERIFICATE OF OCCUPANICES MUST BE ISSUED AND PAID FOR, BEFORE THE SPACE MAY BE OCCUPIED**

James Bonita
Signature of applicant/designee

Date

James Bonita
Signature of Inspections Official

Date

CBL: 277-F-10 Building Permit #: 03-1186

DISPLAY THIS CARD ON PRINCIPAL FRONTAGE OF WORK CITY OF PORTLAND

Please Read Application And Notes, If Any, Attached

BUILDING INSPECTION

PERMIT ISSUED

Permit Number: 031186

SEP 29 2003

This is to certify that Provencher Jason M &/Right Angle Remodeling

has permission to Build 32' shed dormer in rear

CITY OF PORTLAND

AT 32 Glen Haven West Rd

277 F010001

provided that the person or persons who accept this permit shall comply with all of the provisions of the Statutes of the State and of the Ordinances of the City of Portland regulating the construction, maintenance and use of buildings and structures, and of the application on file in this department.

Apply to Public Works for street line and grade if nature of work requires such information.

Notification of inspection must be given and when permission proceeds before this building or part thereof is occupied or otherwise closed-in. 24 HOUR NOTICE REQUIRED.

A certificate of occupancy must be procured by owner before this building or part thereof is occupied.

OTHER REQUIRED APPROVALS

Fire Dept. _____

Health Dept. _____

Appeal Board _____

Other _____
Department Name

Joanie Bourke 9/29/03
Director - Building & Inspection Services

PENALTY FOR REMOVING THIS CARD