

DISPLAY THIS CARD ON PRINCIPAL FRONTAGE OF WORK CITY OF PORTLAND

BUILDING INSPECTION

PERMIT



Please Read Application And Notes, If Any, Attached

PERMIT ISSUED

Permit Number: 080678

JUN 13 2008

CITY OF PORTLAND

This is to certify that VOSMUS REBECCA L
has permission to add a 14' x 16' deck to rear of home
AT 49 PINECREST RD L 277 B011001

provided that the person or persons who perform or supervise the work accepting this permit shall comply with all of the provisions of the Statutes of the State and of the Ordinances of the City of Portland regulating the construction, maintenance and use of buildings and structures, and of the application on file in this department.

Apply to Public Works for street line and grade if nature of work requires such information.

Notification of inspection must be given and when permission is procured before this building or part thereof is occupied or closed-in. 24 HOUR NOTICE IS REQUIRED.

A certificate of occupancy must be procured by owner before this building or part thereof is occupied.

OTHER REQUIRED APPROVALS

Fire Dept. _____
Health Dept. _____
Appeal Board _____
Other _____
Department Name _____

6/16/08 *Clayton M.*
Director - Building & Inspection Services

PENALTY FOR REMOVING THIS CARD

City of Portland, Maine - Building or Use Permit Application

389 Congress Street, 04101 Tel: (207) 874-8703, Fax: (207) 874-8716

Permit No: 08-0678	Issue Date: 6/16/08	CBL: 277 B011001
-----------------------	------------------------	---------------------

Location of Construction: 49 PINECREST RD	Owner Name: VOSMUS REBECCA L	Owner Address: 49 PINECREST RD	Phone:
Business Name:	Contractor Name:	Contractor Address:	Phone:
Lessee/Buyer's Name	Phone:	Permit Type: Additions - Dwellings	Zone: R-3

Past Use: Single Family Home	Proposed Use: Single Family Home - add a 14' x 16' deck to rear of home	Permit Fee:	Cost of Work: \$1,500.00	CEO District: 3
Proposed Project Description: add a 14' x 16' deck to rear of home		FIRE DEPT: <input type="checkbox"/> Approved <input type="checkbox"/> Denied	INSPECTION: Use Group: R-3 Type: SB IRC-2003	
		Signature: 6/16/08 [Signature]		
PEDESTRIAN ACTIVITIES DISTRICT (P.A.D.)				
Action: <input type="checkbox"/> Approved <input type="checkbox"/> Approved w/Conditions <input type="checkbox"/> Denied				
Signature: _____ Date: _____				

Permit Taken By: Idobson	Date Applied For: 06/13/2008	Zoning Approval		
-----------------------------	---------------------------------	------------------------	--	--

- This permit application does not preclude the Applicant(s) from meeting applicable State and Federal Rules.
- Building permits do not include plumbing, septic or electrical work.
- Building permits are void if work is not started within six (6) months of the date of issuance. False information may invalidate a building permit and stop all work..

Special Zone or Reviews	Zoning Appeal	Historic Preservation
<input type="checkbox"/> Shoreland	<input type="checkbox"/> Variance	<input checked="" type="checkbox"/> Not in District or Landmark
<input type="checkbox"/> Wetland	<input type="checkbox"/> Miscellaneous	<input type="checkbox"/> Does Not Require Review
<input type="checkbox"/> Flood Zone <i>O.K.</i>	<input type="checkbox"/> Conditional Use	<input type="checkbox"/> Requires Review
<input type="checkbox"/> Subdivision	<input type="checkbox"/> Interpretation	<input type="checkbox"/> Approved
<input type="checkbox"/> Site Plan	<input type="checkbox"/> Approved	<input type="checkbox"/> Approved w/Conditions
Maj <input type="checkbox"/> Minor <input type="checkbox"/> MM <input type="checkbox"/>	<input type="checkbox"/> Denied	<input type="checkbox"/> Denied
Date: 6/16/08 [Signature]	Date: _____	Date: 6/16/08 [Signature]

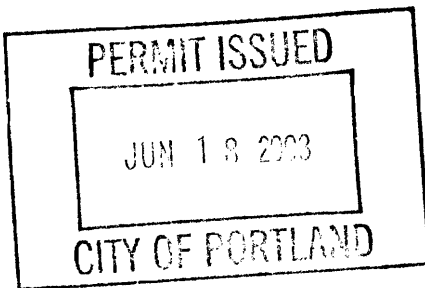

CERTIFICATION

I hereby certify that I am the owner of record of the named property, or that the proposed work is authorized by the owner of record and that I have been authorized by the owner to make this application as his authorized agent and I agree to conform to all applicable laws of this jurisdiction. In addition, if a permit for work described in the application is issued, I certify that the code official's authorized representative shall have the authority to enter all areas covered by such permit at any reasonable hour to enforce the provision of the code(s) applicable to such permit.

SIGNATURE OF APPLICANT	ADDRESS	DATE	PHONE
RESPONSIBLE PERSON IN CHARGE OF WORK, TITLE		DATE	PHONE

6/27/08 - checked post hole depth & setholes - all
OK to pour cement & start building.

Jim



General Building Permit Application

If you or the property owner owes real estate or personal property taxes or user charges on any property within the City, payment arrangements must be made before permits of any kind are accepted.

Location/Address of Construction: <u>49 Pinecrest Rd Portland 04102</u>		
Total Square Footage of Proposed Structure/Area <u>224 ft² Deck</u>		Square Footage of Lot <u>Approx: 7600 sq ft</u>
Tax Assessor's Chart, Block & Lot Chart# <u>977</u> Block# <u>B</u> Lot# <u>11</u>	Applicant * <u>must be owner, Lessee or Buyer</u> * Name <u>Ryan Sullivan</u> Address <u>49 Pinecrest Rd</u> City, State & Zip <u>Portland ME 04102</u>	Telephone: <u>671-6227</u>
Lessee/DBA (If Applicable)	Owner (if different from Applicant) Name Address City, State & Zip	Cost Of Work: \$ <u>1500.00</u> C of O Fee: \$ _____ Total Fee: \$ _____
Current legal use (i.e. single family) <u>Single family</u> If vacant, what was the previous use? _____ Proposed Specific use: <u>Deck</u> Is property part of a subdivision? _____ If yes, please name _____ Project description: <u>14' x 16' Deck Attached To house 2' Above finished grade</u>		
Contractor's name: _____ Address: _____ City, State & Zip _____ Telephone: _____ Who should we contact when the permit is ready: _____ Telephone: _____ Mailing address: _____		

Please submit all of the information outlined on the applicable Checklist. Failure to do so will result in the automatic denial of your permit.

In order to be sure the City fully understands the full scope of the project, the Planning and Development Department may request additional information prior to the issuance of a permit. For further information or to download copies of this form and other applications visit the Inspections Division on-line at www.portlandmaine.gov, or stop by the Inspections Division office, room 315 City Hall or call 874-8703.

I hereby certify that I am the Owner of record of the named property, or that the owner of record authorizes the proposed work and that I have been authorized by the owner to make this application as his/her authorized agent. I agree to conform to all applicable laws of this jurisdiction. In addition, if a permit for work described in this application is issued, I certify that the Code Official's authorized representative shall have the authority to enter all areas covered by this permit at any reasonable hour to enforce the provisions of the codes applicable to this permit.

Signature: Ryan Sullivan Date: 6/13/08

This is not a permit; you may not commence ANY work until the permit is issue

BUILDING PERMIT INSPECTION PROCEDURES

Please call 874-8703 or 874-8693 (ONLY)

to schedule your inspections as agreed upon

Permits expire in 6 months, if the project is not started or ceases for 6 months.

The Owner or their designee is required to notify the inspections office for the following inspections and provide adequate notice. Notice must be called in 48-72 hours in advance in order to schedule an inspection:

By initializing at each inspection time, you are agreeing that you understand the inspection procedure and additional fees from a "Stop Work Order" and "Stop Work Order Release" will be incurred if the procedure is not followed as stated below.

A Pre-construction Meeting will take place upon receipt of your building permit.

Footing/Building Location Inspection: Prior to pouring concrete or setting precast piers

~~Framing/Rough Plumbing/Electrical: Prior to Any Insulating or drywalling~~

Final inspection required at completion of work.

Certificate of Occupancy is not required for certain projects. Your inspector can advise you if your project requires a Certificate of Occupancy. All projects DO require a final inspection.

If any of the inspections do not occur, the project cannot go on to the next phase, REGARDLESS OF THE NOTICE OR CIRCUMSTANCES.

CERIFICATE OF OCCUPANICES MUST BE ISSUED AND PAID FOR, BEFORE THE SPACE MAY BE OCCUPIED.

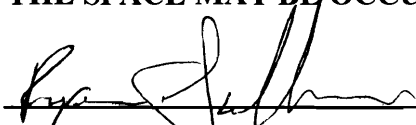

Signature of Applicant/Designee



Date



Signature of Inspections Official

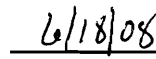

Date

City of Portland, Maine - Building or Use Permit

389 Congress Street, 04101 Tel: (207) 874-8703, Fax: (207) 874-8716

Permit No: 08-0678	Date Applied For: 06/13/2008	CBL: 277 B011001
------------------------------	--	----------------------------

Location of Construction: 49 PINECREST RD	Owner Name: VOSMUS REBECCA L	Owner Address: 49 PINECREST RD	Phone:
Business Name:	Contractor Name:	Contractor Address:	Phone:
Lessee/Buyer's Name	Phone:	Permit Type: Additions - Dwellings	

Proposed Use: Single Family Home - add a 14' x 16' deck to rear of home	Proposed Project Description: add a 14' x 16' deck to rear of home
---	--

Dept: Zoning **Status:** Approved with Conditions **Reviewer:** Chris Hanson **Approval Date:** 06/16/2008

Note: **Ok to Issue:**

- 1) This permit is being approved on the basis of plans submitted. Any deviations shall require a separate approval before starting that work.

Dept: Building **Status:** Approved with Conditions **Reviewer:** Chris Hanson **Approval Date:** 06/16/2008

Note: **Ok to Issue:**

- 1) Open risers are permitted, provided that the opening between treads does not permit the passage of a 4" diameter sphere.
- 2) Fastener schedule per the IRC 2003
- 3) As discussed during the review process, ballusters must be spaced with less than a 4" opening between each.
- 4) Frost protection must be installed per the enclosed detail as discussed w/owner/contractor.
- 5) Separate permits are required for any electrical, plumbing, or HVAC systems. Separate plans may need to be submitted for approval as a part of this process.
- 6) Application approval based upon information provided by applicant. Any deviation from approved plans requires separate review and approval prior to work.

This page contains a detailed description of the Parcel ID you selected. Press the **New Search** button at the bottom of the screen to submit a new query.

Current Owner Information

Card Number 1 of 1
 Parcel ID 277 B011001
 Location 49 PINECREST RD
 Land Use SINGLE FAMILY
 Owner Address VOSMUS REBECCA L
 49 PINECREST RD
 PORTLAND ME 04102

cl 6/16

R-3 ZONE.

Book/Page 24694/292
 Legal 277-B-11
 PINECREST RD 49

7000 SF

*6,500 min. O.K.
 35% cov. Allowed
 2,450 Allowed*

Current Assessed Valuation

Land	Building	Total
\$62,800	\$91,700	\$154,500

*1025
 224

 1249 OK*

Property Information

Year Built 1964	Style Ranch	Story Height 1	Sq. Ft. 1025	Total Acres 0.161
Bedrooms 3	Full Baths 1	Half Baths	Total Rooms 6	Attic None
				Basement Full

Outbuildings

Type SHED-METAL	Quantity 1	Year Built 1975	Size 6X6	Grade D	Condition F
---------------------------	----------------------	---------------------------	--------------------	-------------------	-----------------------

*setbacks - 25 ft ✓
 25 ft ✓
 side - 1 1/2 ft ✓
 2 ft ✓
 OK.*

Sales Information

Date	Type	Price	Book/Page
12/26/2006	LAND + BLDING	\$209,000	24694-292
12/26/2006	LAND + BLDING		24694-290
10/04/2006	LAND + BLDING	\$169,900	24435-200

Picture and Sketch

Picture Sketch Tax Map

cl

[Click here to view Tax Roll Information.](#)

Any information concerning tax payments should be directed to the Treasury office at 874-8490 or e-mailed.

New Search!



Descriptor/Area

A: 1Fr/B
1025 sqft

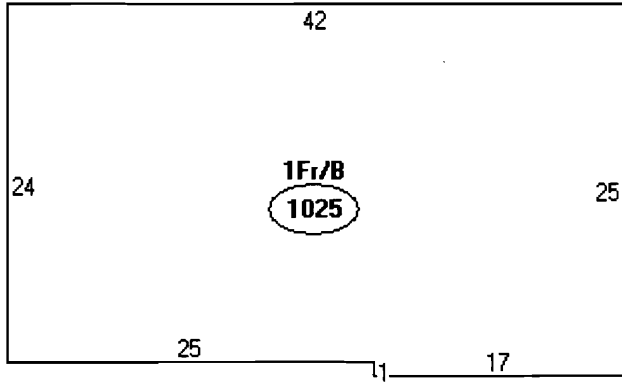



Same-Day Permitting

As part of Portland's city-wide effort to improve customer service and help streamline doing business within the City, the Inspections Division has developed a new permitting system for qualified properties and for specific construction projects.

This permitting program applies only to existing single family homes not located within a historic district or shoreland zone.

Eligible Projects

Please submit a complete application with the required plans

- Interior non structural projects (i.e. Adding closets, bathrooms, changing floor plans, kitchen remodels)
- Repairs to existing decks, porches and stairs that meet current zoning setbacks
- Adding or replacing windows and doors (not to include bay windows)
- Sheds less than 100 sq. ft.
- One story open entry/porch, 50 sq. ft. or less with maximum 6 ft. projection from the principal structure
- Chimney installation (NFPA 211 disclosure statement required)
- Propane tanks
- Heating Appliances (i.e. HVAC systems, gas inserts/monitors, wood/pellet stoves)
- Bulkheads 50 sq. ft. or less with maximum of 2 ft. in height (low profile)

Inspections are still required per City Code of Ordinance.

In order to be sure the City fully understands the full scope of the project, the Planning and Development Department may request additional information prior to the issuance of a permit. For further information visit us on-line at www.portlandmaine.gov, stop by the Building Inspections office, room 315 City Hall or call 874-8703.

I hereby certify that this project meets the above criteria and that the work performed will not go beyond these parameters.

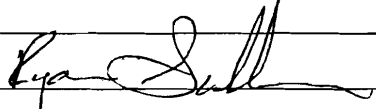
Signature of applicant: 	Date: <u>6/13/08</u>
---	----------------------

This is not a permit; you may not commence ANY work until the permit is issued.

HOUSE

Joist: 2x8x16
w/Joist Hangers Door
@ 16" oc.

2 @ 16" oc
1

Ledger: 2x8x14 PT

3/8" Lag Galv.

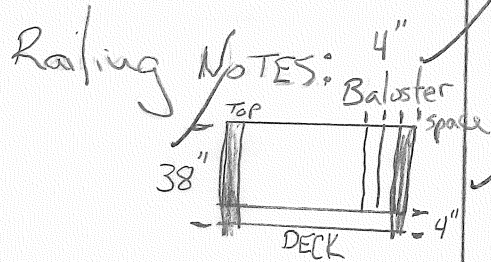

5/4 x 6 x 16 PT Decking

Deck Height Above
Finished Grade = 2 ft
= (24")

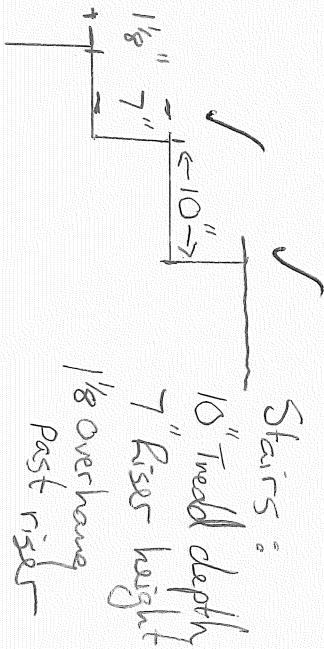

Stairs:

8 in x 4" Tubes

Girder: 2x8x14 PT
Doubled up
Attached to Tubes w/ Brackets

← 2.5 ft →

← 7 ft →

4' Below
Grade

4 ft

14

9'

R. Sullivan 6/23/08

NOTE: Drawing NOT TO SCALE

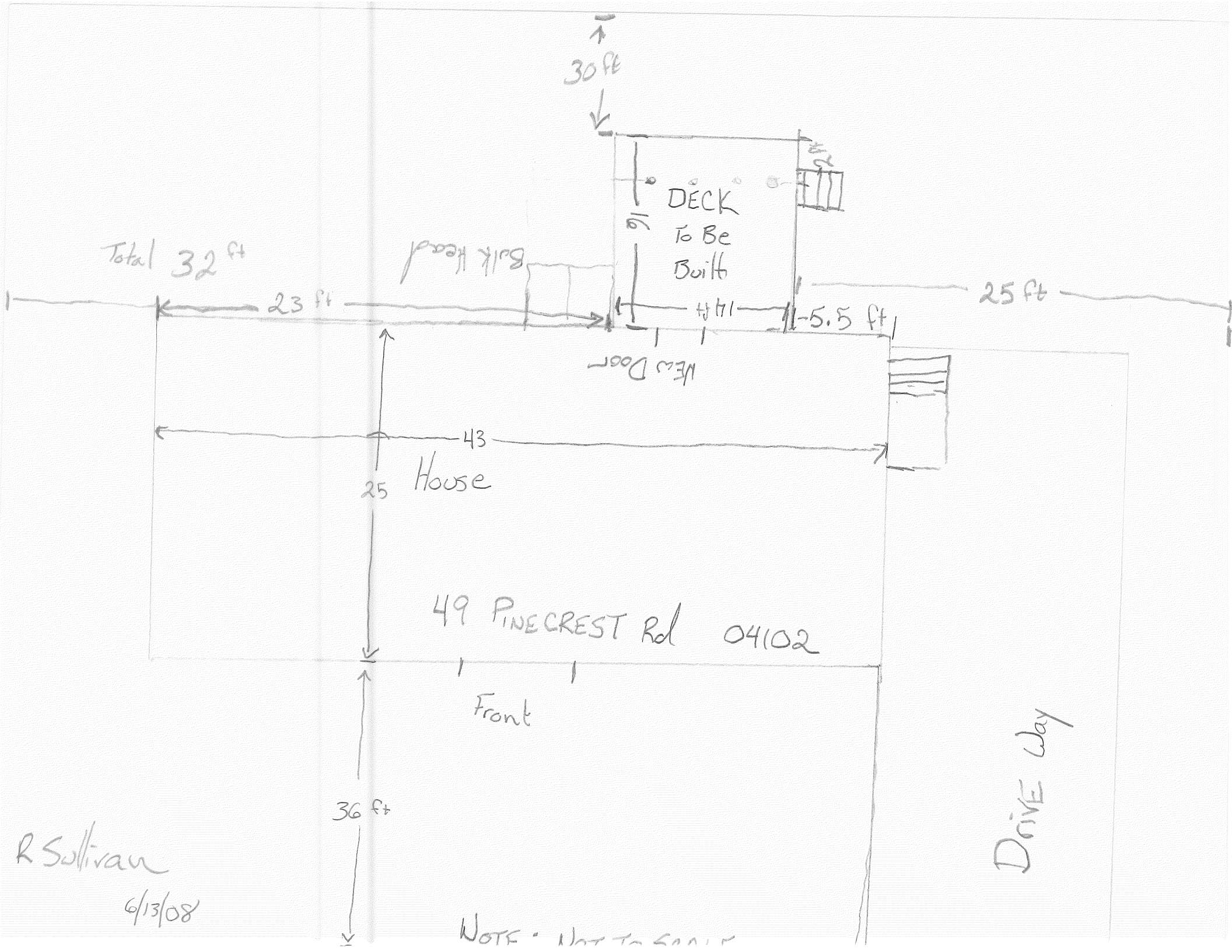

R Sullivan
6/13/08

NOTE - Not To Scale

New location
on Drawing
All other measurements
the same
Ryan Sullivan
671 6227

JUL - 8 2008

New Stair
Location
7/8/08

26 #

277-B-011

Old Location Permit #
080678

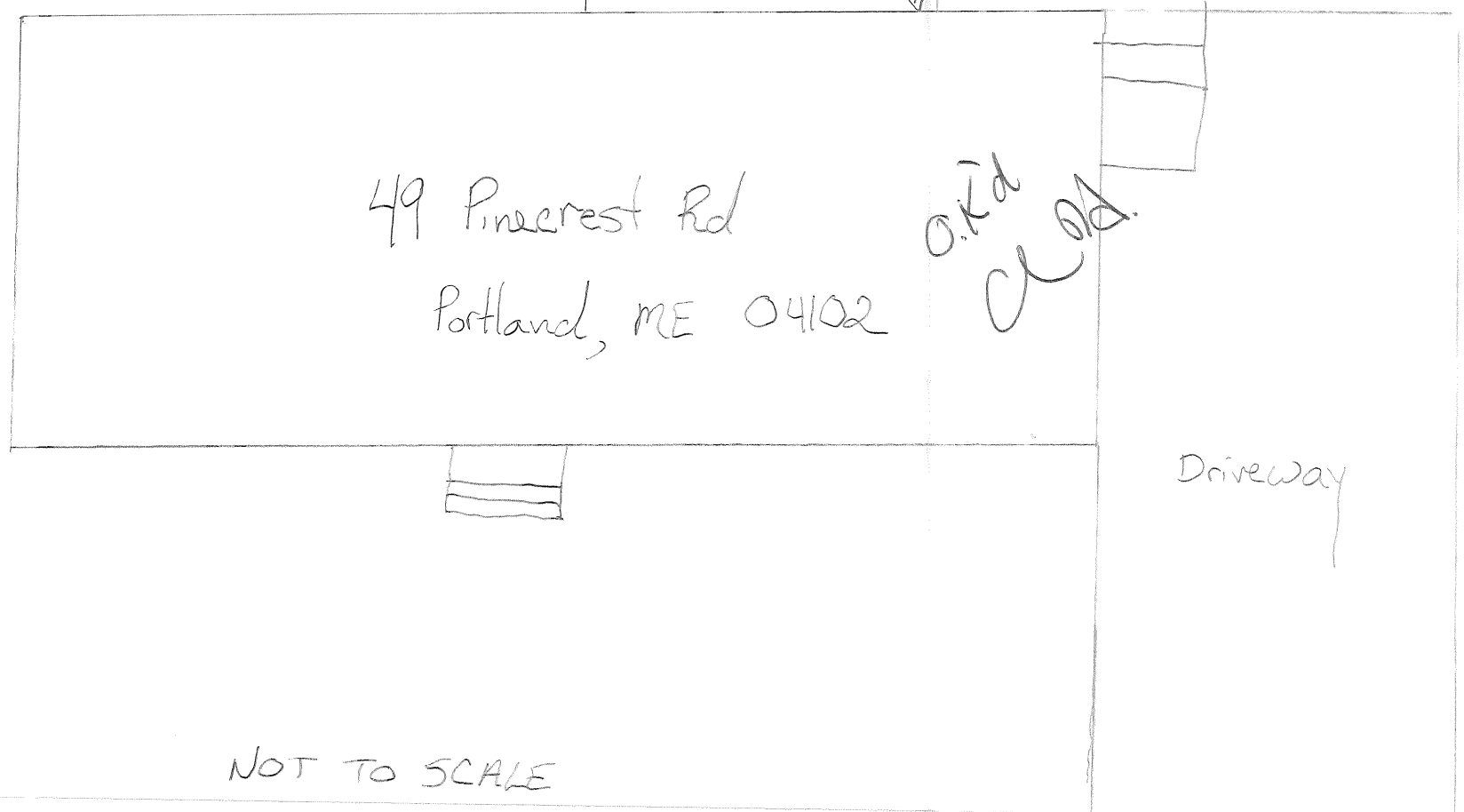
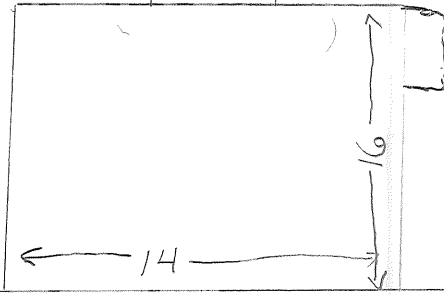

R Sullivan
7/8/08

NOT TO SCALE