

DRAWING KEYNOTES

- 1 MOUNT 96" AFF.
- 2 MOUNT 48" AFF.
- 3 ACTUATION OF FIRE ALARM SYSTEM SHALL ACTIVATE (CLOSE) SLIDING DOOR.
- 4 PROVIDE TAMPER ALARM FOR KNOX BOX.
- 5 PROVIDE ADDRESSABLE INTERFACE MODULE (AIM) FOR EACH TAMPER AND FLOW SWITCH.
- 6 RADIO TRANSMITTER.

DRAWING NOTE

- 1. REFER TO DRAWING E-001 FOR SYMBOLS LIST.

1 FIRST FLOOR FIRE ALARM PART PLAN A
FA101 SCALE: 1/8" = 1'-0"

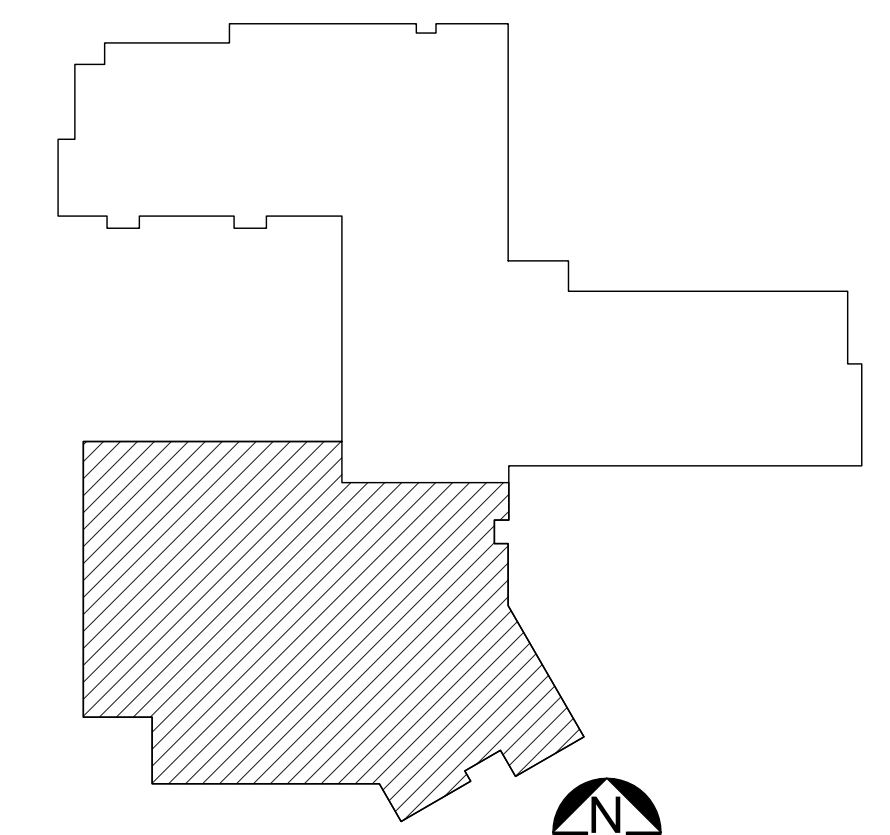

KEYPLAN
NOT TO SCALE

PLAN
NORTH

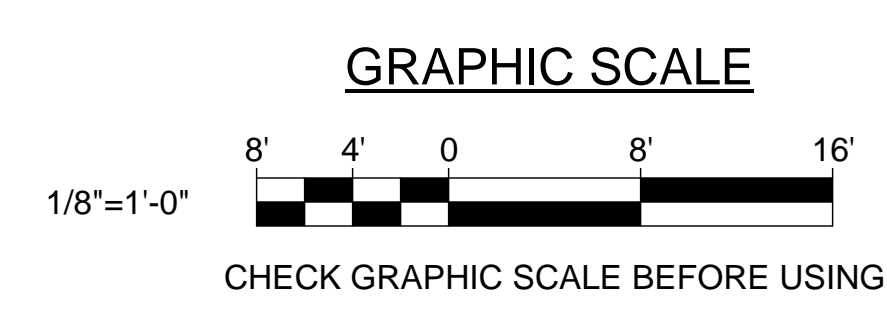

		<p>STATE OF MAINE PUBLIC SCHOOL PROJECT</p> <p>TITLE: PORTLAND PUBLIC SCHOOLS NEW FRED P. HALL ELEMENTARY SCHOOL LOCATION: 23 ORONO ROAD, PORTLAND, ME</p> <p>TITLE THIS DWG: FIRST FLOOR FIRE ALARM PART PLAN A</p>
<p>DRAWN BY: BPD CHECK BY: DCL</p>	<p>DATE: 03/17/17</p>	<p>OAK POINT ASSOCIATES</p> <p>ARCHITECTURE • ENGINEERING • PLANNING</p> <p>231 Main Street, Biddeford, Maine 04005 207.283.9192</p>
<p>NO. DATE DESCRIPTION</p>	<p>BY NO.</p>	<p>DRAWING NO. FA101 SHEET NO. 308 OF 312</p>