

DRAWING NOTES:

1. END REACTIONS (Ru) ARE FACTORED.
2. W8x10'S HAVE A FACTORED END REACTION OF 10 KIPS UNLESS NOTED OTHERWISE.
3. REFER TO SHEET SF605 FOR SHEAR PLATE CONNECTION SCHEDULE AND SHEET SF607 FOR SEISMIC COLLECTOR CONNECTION SCHEDULE.
4. REFER TO SHEET SF606 FOR MOMENT CONNECTION SCHEDULE.
5. REFER TO SHEET SF605 FOR BEAM BEARING PLATE SCHEDULE.

KEYNOTES: (THIS SHEET ONLY)

- 1 2' x 18 GAGE COMPOSITE STEEL DECK WITH 4-3/4" LIGHTWEIGHT CONCRETE SLAB AND 6x6, W2.9xW2.9 WELDED WIRE FABRIC.
- 2 #4'S, 4'-0" LONG, AT 12" ON-CENTER. SEE DETAIL 1/SF501.
- 3 SEISMIC LOAD RESISTING COLLECTOR ELEMENT.
- 4 OPERABLE PARTITION SUPPORT BEAM. PROVIDE DRILLED HOLES IN BOTTOM FLANGE FOR ATTACHMENT OF PARTITION SUPPORT HANGERS. COORDINATE WITH PARTITION MANUFACTURER.
- 5 HSS 3x3x1/4 SWING SUPPORT. SEE DETAIL 5/SF502.
- 6 DECK SUPPORT ANGLE. SEE DETAIL 9/SF501 (SIMILAR).
- 7 CONTINUOUS 2x6x4x3/8 (LLV). SEE DETAIL 7/SF203.
- 8 W8x10 HEADER AT FLOOR OPENING. COORDINATE EXACT LOCATION WITH MECHANICAL AND/OR ARCHITECTURAL PLANS.

1 PARTIAL SECOND FLOOR FRAMING PLAN
SF101 SCALE: 1/8" = 1'-0"
PLAN NORTH

NOTE:
TOP OF STEEL ELEVATION = 81.60',
UNLESS NOTED OTHERWISE.

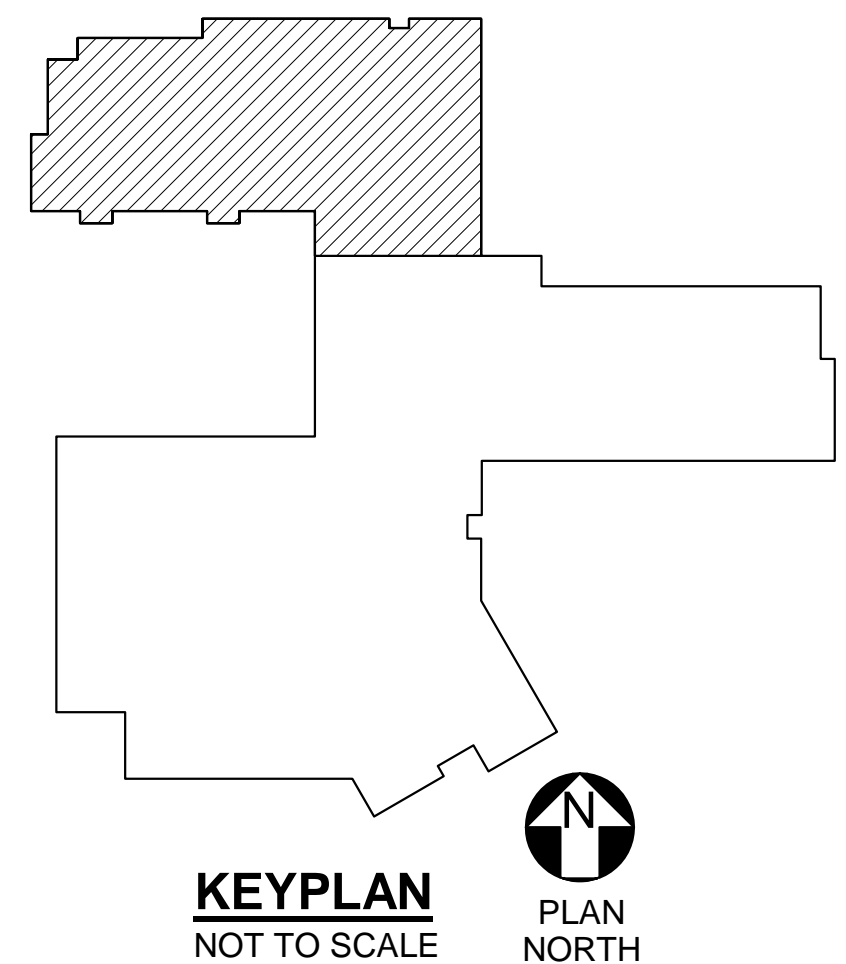

KEYPLAN
NOT TO SCALE
PLAN NORTH

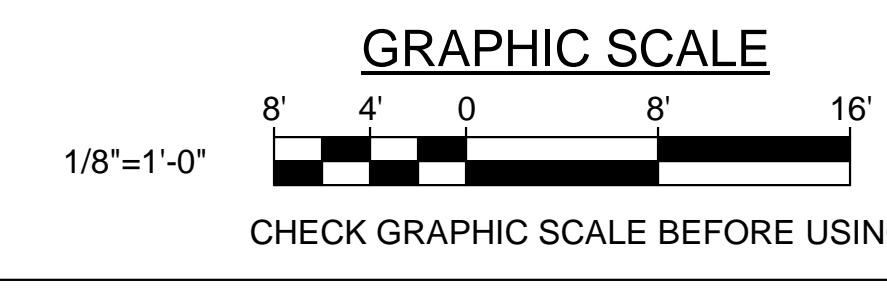

STATE OF MAINE PUBLIC SCHOOL PROJECT	
TITLE PORTLAND PUBLIC SCHOOLS NEW FRED P. HALL ELEMENTARY SCHOOL	
LOCATION 23 ORONO ROAD, PORTLAND, ME	
TITLE THIS DWG. PARTIAL SECOND FLOOR FRAMING PLAN	
DRAWN BY: JEG	CHECKED BY: DNM
NO. DATE	DESCRIPTION
BY NO.	REVISIONS
DATE 03/17/17	