

- DRAWING NOTES:**
- REFER TO SHEET SB104 FOR SLAB CONTROL JOINTS AND EXPANSION JOINT LAYOUTS.
 - REFER TO SHEET SB001 FOR FOOTING SCHEDULES.
 - REFER TO SHEET SF604 FOR COLUMN BASE PLATE SCHEDULE.
 - REFER TO PLUMBING DRAWINGS FOR FLOOR DRAIN LOCATIONS IN SLABS. PITCH SLAB-ON-GRADE TO FLOOR DRAINS AS REQUIRED.
 - BOTTOM OF THE EXTERIOR AND INTERIOR CONTINUOUS FOUNDATION WALL FOOTINGS, EXTERIOR SPREAD FOOTINGS AND EXTERIOR COMBINED FOOTINGS SHALL BE 62.75', UNLESS NOTED OTHERWISE.
 - BOTTOM OF THE ISOLATED INTERIOR COLUMN FOOTINGS SHALL BE 62.75', UNLESS NOTED OTHERWISE. REFER TO TYPICAL PIER DETAIL 7/SB501.
 - TOP OF THE EXTERIOR FOUNDATION WALL SHALL BE 68.00' WITH AN INTEGRAL BRICK SHELVE ELEVATION OF 67.56', UNLESS NOTED OTHERWISE. REFER TO TYPICAL FOUNDATION WALL DETAIL 1/SB501.
 - REFER TO SHEETS SB404 AND SB405 FOR ENLARGED PIER PLAN DETAILS.
 - PROVIDE FOUNDATION WALL AND SLAB-ON-GRADE CONSTRUCTION JOINTS AT EACH EDGE OF CONCRETE PLACEMENT IN ACCORDANCE WITH DETAILS 3/SB104 AND 5/SB502.
 - REFER TO SHEET S-006 FOR COLUMN GRID SPACING.
 - REFER TO SHEETS SB401 AND SB402 FOR ENLARGED MAT PLANS.
 - PROVIDE CONTROL JOINTS IN FOUNDATION WALLS LOCATED BELOW BRICK VENEER CONTROL JOINTS AND AT A MAXIMUM SPACING OF 20'-0". COORDINATE WITH ARCHITECTURAL WALL ELEVATIONS FOR LOCATION OF CONTROL JOINTS. CONTROL JOINTS SHALL BE MADE BY 3/4" x 3/4" INSERTS ATTACHED TO FOUNDATION WALL FORMWORK.

- KEYNOTES: (THIS SHEET ONLY)**
- 6" FIBER REINFORCED CONCRETE SLAB-ON-GRADE WITH 6x6, W2.9xW2.9 WELDED WIRE FABRIC. TOP OF SLAB ELEVATION = 68.00'.
 - 4" FIBER REINFORCED CONCRETE SLAB-ON-GRADE WITH 6x6, W2.9xW2.9 WELDED WIRE FABRIC. TOP OF SLAB ELEVATION = 68.00'.
 - 4" FIBER REINFORCED CONCRETE SLAB-ON-GRADE WITH 6x6, W2.9xW2.9 WELDED WIRE FABRIC. TOP OF SLAB ELEVATION = 67.82'.
 - 4" FIBER REINFORCED CONCRETE SLAB-ON-GRADE WITH 6x6, W2.9xW2.9 WELDED WIRE FABRIC. TOP OF SLAB ELEVATION = 68.99'.
 - SLOPED 4" FIBER REINFORCED CONCRETE SLAB-ON-GRADE WITH 6x6, W2.9xW2.9 WELDED WIRE FABRIC. TOP OF SLAB ELEVATION = VARIES.
 - 1'-1" REINFORCED CONCRETE FOUNDATION WALL. SEE DETAIL 1/SB501.
 - REINFORCED CONCRETE STOOP. SEE DETAIL 5/SB501.
 - STEP FOOTING. SEE DETAIL 4/SB502.
 - 1'-3" REINFORCED CONCRETE FOUNDATION WALL. SEE DETAIL 9/SB501.
 - 1'-3" REINFORCED CONCRETE FOUNDATION WALL. SEE DETAIL 8/SB501.
 - 1'-3" REINFORCED CONCRETE FOUNDATION WALL AT DOOR. SEE DETAIL 5/SB501 (SIMILAR).
 - RADON PIT. SEE DETAIL 3/SB502.
 - 1'-1" REINFORCED CONCRETE FOUNDATION WALL AT DOOR. SEE DETAIL 5/SB501.
 - 1'-1" REINFORCED CONCRETE FOUNDATION WALL. SEE DETAIL 8/SB501 (SIMILAR).
 - 1'-1" REINFORCED CONCRETE FOUNDATION WALL AT CURTAIN WALL. SEE DETAIL 6/SB501.
 - RECESSED CONCRETE SLAB-ON-GRADE FOR WALK-IN FREEZER AND WALK-IN COOLER. COORDINATE RECESS DEPTH AND SIZE WITH FREEZER/COOLER MANUFACTURER.
 - 8" REINFORCED CONCRETE FOUNDATION WALL AT CURTAIN WALL. SEE DETAIL 4/SB501.
 - CONCRETE VOLLEYBALL POST SUPPORT. SEE DETAIL 6/AE401.
 - UTILITY SLEEVE(S). COORDINATE EXACT QUANTITY, SIZE, LOCATION AND ELEVATION WITH CIVIL, PLUMBING AND ELECTRICAL PLANS.
 - 1'-6"x1'-6"x8" DEEP THICKENED SLAB-ON-GRADE.
 - (3) #4 DOWELS, 3'-0" LONG AT 4" ON-CENTER. LOCATE IN MIDDLE OF SLAB.

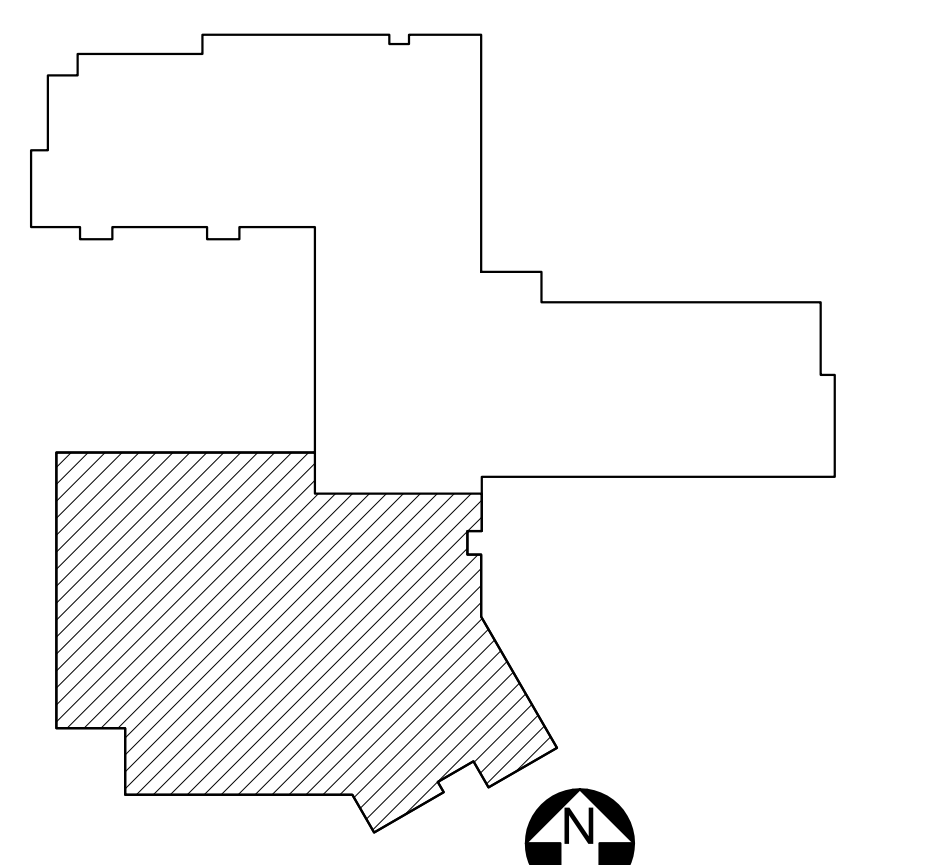

1 FOUNDATION PART PLAN - WING A
SB101 SCALE: 1/8" = 1'-0"

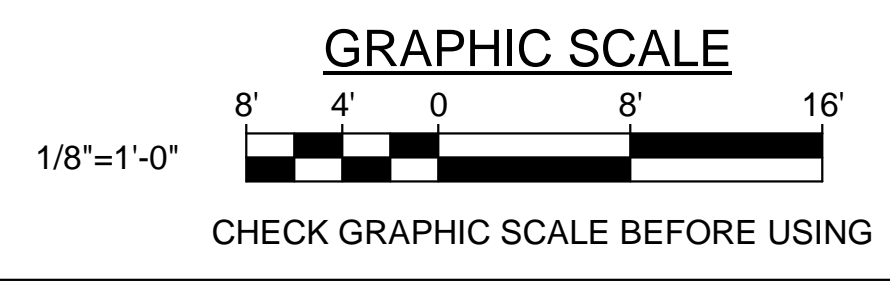

		<p>STATE OF MAINE PUBLIC SCHOOL PROJECT</p> <p>TITLE PORTLAND PUBLIC SCHOOLS NEW FRED P. HALL ELEMENTARY SCHOOL LOCATION 23 ORONO ROAD, PORTLAND, ME</p> <p>TITLE THIS DWG. FOUNDATION PART PLAN - WING A</p>	
<p>DRAWN BY: JEG CHECK BY: DNM</p>	<p>DATE: 03/17/17</p>	<p>OAK POINT ASSOCIATES</p> <p>SB101</p>	<p>DRAWING NO. SB101 SHEET NO. 84 OF 312</p>
<p>NO. DATE DESCRIPTION BY</p>	<p>REVISIONS</p>	<p>DATE 03/17/17</p>	<p>231 Main Street, Biddeford, Maine 04005 207.283.9192</p>