

DRAWING NOTES

1. REFER TO FIRE SUPPRESSION GENERAL NOTES ON FX001 FOR SYSTEM REQUIREMENTS.
2. PROVIDE LIGHT HAZARD SPRINKLER COVERAGE THROUGHOUT UNLESS OTHERWISE NOTED.
3. PROVIDE QUICK RESPONSE HEADS WHERE PERMITTED BY NFPA.
4. REFER TO ARCHITECTURAL REFLECTED CEILING PLANS ON SHEETS AE701 TO AE704 FOR CEILING MATERIALS AND SOFFIT LOCATIONS FOR COORDINATION WITH SPRINKLER TYPES AND POSSIBLE CEILING OBSTRUCTIONS. TEACHING SPACES TYPICALLY HAVE SLOPED CEILINGS WITH HIGH POINT LOCATED AT THE EXTERIOR WALL(S). SEE SHEETS AE220 TO AE222 FOR BUILDING SECTIONS.
5. SLOPED CEILINGS WITH SIDEWALL SPRINKLERS SHALL HAVE A SLOPE NOT EXCEEDING 2 IN 12.

DRAWING KEYNOTES

1. PROVIDE ORDINARY HAZARD, GROUP 1 SPRINKLER COVERAGE IN ROOM INDICATED.
2. PROVIDE SPRINKLER(S) WITH WIRE GUARD(S) IN ROOMS INDICATED.
3. PROVIDE QUICK RESPONSE SPRINKLER HEAD(S) IN THIS SPACE.
4. SECOND FLOOR SPRINKLER ZONE ASSEMBLY. CONNECT ZONE TEST DRAIN PIPING TO MAIN DRAIN PIPING. REFER TO DETAIL 3/FX001.
5. RUN PIPING BETWEEN FLUTES OF METAL DECKING. PROVIDE UNISTRUT SUPPORT BRACING FOR SPRINKLER PIPING. COORDINATE COLOR OF SPRINKLERS AND SPRINKLER PIPING WITH STRUCTURE. PAINT PIPING TO MATCH.
6. CORRIDOR D11 SHALL BE IN SECOND FLOOR ZONE.
7. SPRINKLERS IN LOBBY A02 & VESTIBULE A01 SHALL BE IN SECOND FLOOR SPRINKLER ZONE.
8. EXPOSED STRUCTURE.
9. PROVIDE SPRINKLER HEADS BELOW DUCTWORK IN COMPLIANCE WITH NFPA 13. MAINTAIN MINIMUM HEADROOM OF 7'-0" CLEAR AFF BELOW PIPING AND HEADS.

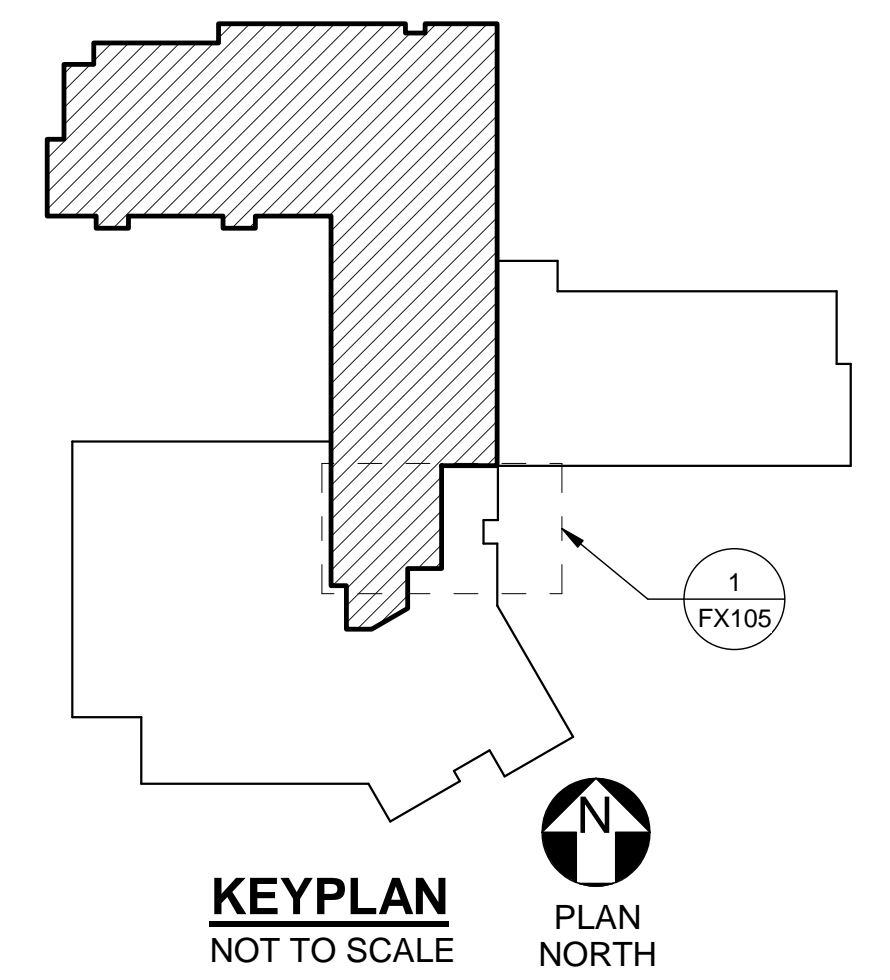
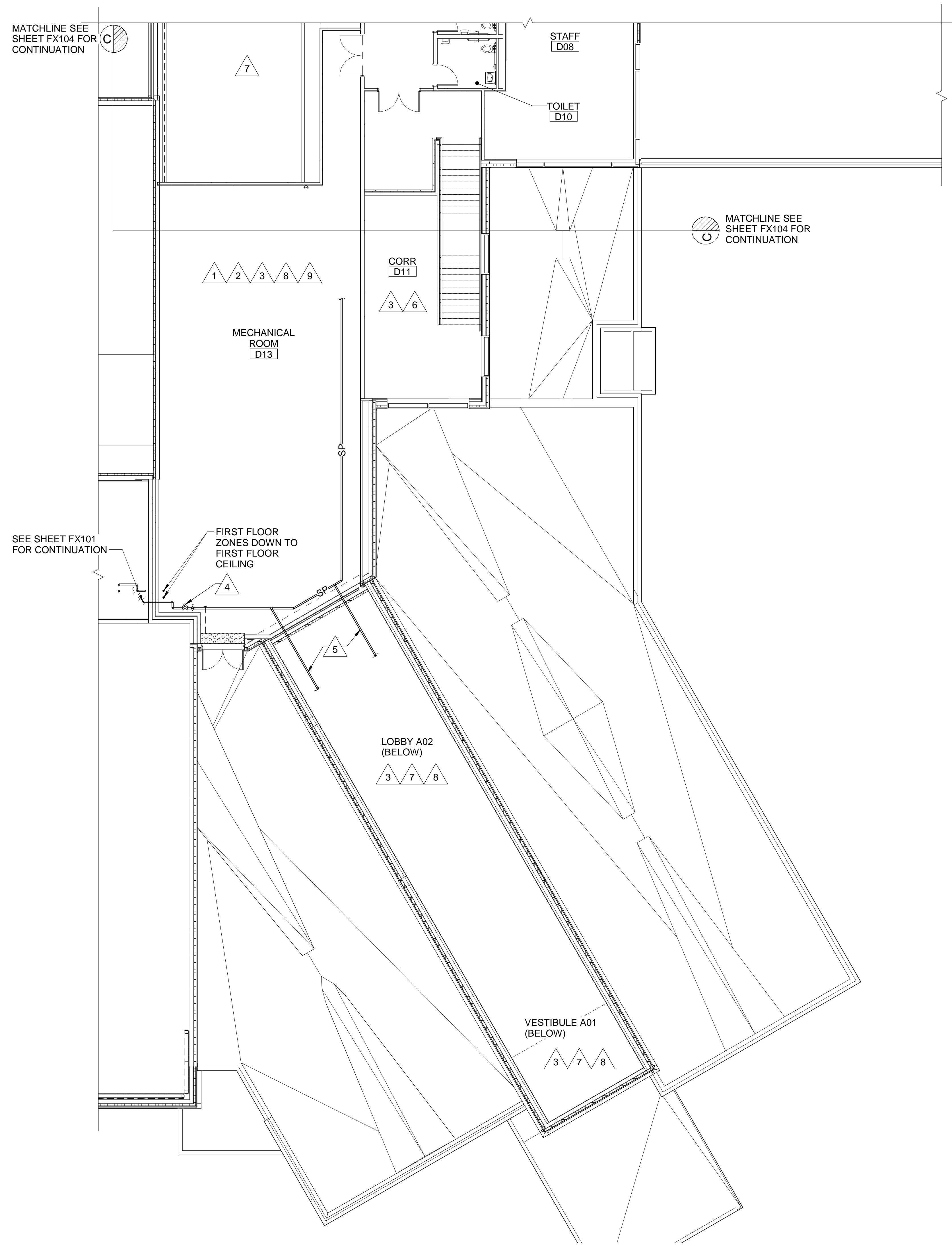

1 SECOND FLOOR FIRE SUPPRESSION PART PLAN D SOUTH END
FX101 FX105 SCALE: 1/8" = 1'-0"

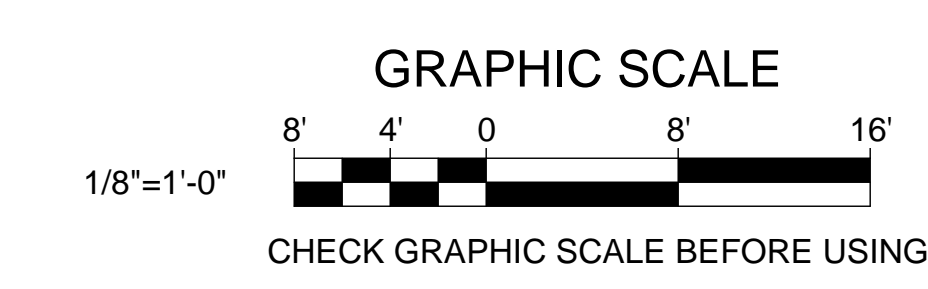

		STATE OF MAINE PUBLIC SCHOOL PROJECT TITLE: PORTLAND PUBLIC SCHOOLS NEW FRED P. HALL ELEMENTARY SCHOOL LOCATION: 23 ORONO ROAD, PORTLAND, ME TITLE THIS DWG: SECOND FLOOR FIRE SUPPRESSION PART PLAN D SOUTHEND	
DRAWN BY: RDA	CHECK BY: DMA		DRAWING NO: FX105 SHEET NO:
NO. DATE	DESCRIPTION	BY NO.	231 Main Street, Biddeford, Maine 04005 207.283.9192
	REVISIONS	DATE	03/17/17