

**DRAWING NOTES**

1. REFER TO FIRE SUPPRESSION GENERAL NOTES ON FX001 FOR SYSTEM REQUIREMENTS.
2. PROVIDE LIGHT HAZARD SPRINKLER COVERAGE THROUGHOUT UNLESS OTHERWISE NOTED.
3. PROVIDE QUICK RESPONSE HEADS WHERE PERMITTED BY NFPA.
4. REFER TO ARCHITECTURAL REFLECTED CEILING PLANS ON SHEETS AE701 TO AE 704 FOR CEILING MATERIALS AND SOFFIT LOCATIONS FOR COORDINATION WITH SPRINKLER TYPES AND POSSIBLE CEILING OBSTRUCTIONS. TEACHING SPACES TYPICALLY HAVE SLOPED CEILINGS WITH HIGH POINT LOCATED AT THE EXTERIOR WALL(S). SEE SHEETS AE220 TO AE222 FOR BUILDING SECTIONS.
5. SLOPED CEILINGS WITH SIDEWALL SPRINKLERS SHALL HAVE A SLOPE NOT EXCEEDING 2 IN 12.

**DRAWING KEYNOTES**

- 1 PROVIDE ORDINARY HAZARD, GROUP 1 SPRINKLER COVERAGE IN ROOM INDICATED.
- 2 PROVIDE SPRINKLER(S) WITH WIRE GUARD(S) IN ROOMS INDICATED.
- 3 PROVIDE DRY TYPE PENDENT SPRINKLER(S) IN ROOMS INDICATED.
- 4 PROVIDE QUICK RESPONSE SPRINKLER HEAD(S) IN THIS SPACE.
- 5 EXPOSED STRUCTURE.
- 6 GYPSUM BOARD CEILING.
- 7 PROVIDE FLEXIBLE EXPANSION LOOP OR OTHER SEISMIC SEPARATION ASSEMBLY PER NFPA 13, CHAPTER 9, WHERE PIPING CROSSES BUILDING FIRE WALL. REFER TO SHEET AE547 FOR FIRE WALL PLANS.
- 8 NFPA 96 COMMERCIAL KITCHEN HOOD WITH INTEGRAL WET CHEMICAL FIRE SUPPRESSION SYSTEM. SEE SHEET AE469 TO AE 472.
- 9 SPRINKLER PIPING AND HEADS SHALL BE INSTALLED INSIDE STRUCTURAL STEEL JOISTS.
- 10 COORDINATE COLOR OF SPRINKLER PIPING WITH STRUCTURE. PAINT TO MATCH.
- 11 PROVIDE SPRINKLER WITH BLACK FINISH. PAINT PIPING TO MATCH.
- 12 FIRST FLOOR A WING SPRINKLER ZONE ASSEMBLY. CONNECT ZONE TEST DRAIN PIPING TO MAIN DRAIN PIPING. REFER TO DETAIL 3/FX001.
- 13 PROVIDE 18"x18"x1-1/2" PRECAST REINFORCED CONCRETE SPLASH BLOCK SET FLUSH WITH EXISTING GRADE (CONCRETE SHALL BE F<sub>c</sub>=4000 PSI).
- 14 PROVIDE SIGN ABOVE FIRE DEPARTMENT CONNECTION USING 1" LETTERING. SIGN SHALL READ "AUTOSPKR."
- 15 ZONE VALVE TEST ASSEMBLY DRAIN. CONNECT ZONE TEST DRAIN PIPING TO MAIN DRAIN PIPING. REFER TO DETAIL 3/FX001.
- 16 PROVIDE ORDINARY HAZARD, GROUP 2 SPRINKLER COVERAGE IN ROOM INDICATED.
- 17 FIRST FLOOR B&C WING SPRINKLER ZONE ASSEMBLY. CONNECT ZONE TEST DRAIN PIPING TO MAIN DRAIN PIPING. REFER TO DETAIL 3/FX001.
- 18 LOBBY SHALL BE IN SECOND FLOOR ZONE. SEE SHEET FX105.
- 19 TWO STORY CORRIDOR SHALL BE IN SECOND FLOOR ZONE. SEE SHEET FX105.
- 20 VESTIBULE SHALL BE IN SECOND FLOOR ZONE. SEE SHEET FX105.
- 21 PROVIDE CORROSION RESISTANT SPRINKLER HEAD.
- 22 PROVIDE DRY TYPE SIDEWALL SPRINKLER HEAD TO COVER CANOPY AREA. SPRINKLER HEAD AND ESCUTCHEON SHALL BE CHROME FINISH.
- 23 STORAGE ROOM.

**1 FIRST FLOOR FIRE PROTECTION PART PLAN A**  
 FX101 SCALE: 1/8" = 1'-0"

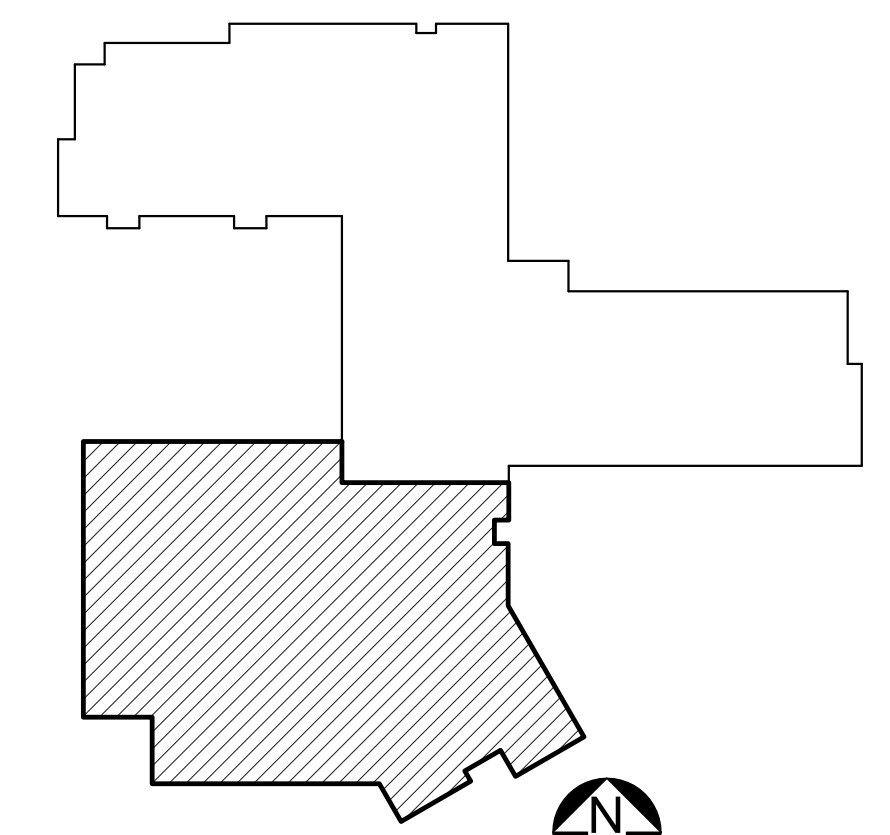

**KEYPLAN**  
 NOT TO SCALE  
 PLAN NORTH

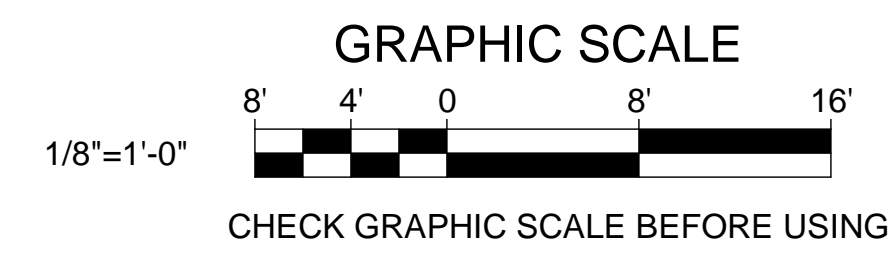

		<b>STATE OF MAINE</b> <b>PUBLIC SCHOOL PROJECT</b> TITLE: PORTLAND PUBLIC SCHOOLS NEW FRED P. HALL ELEMENTARY SCHOOL LOCATION: 23 ORONO ROAD, PORTLAND, ME TITLE THIS DWG: <b>FIRST FLOOR FIRE SUPPRESSION PART PLAN A</b>	
DRAWN BY: RDA CHECK BY: MSA	BY: NO. DATE: 03/17/17		<b>OAK POINT ASSOCIATES</b> <b>FX101</b> SHEET NO. 277 OF 312