



DRAWING KEYNOTES

- 1 MOUNT 96" AFF.
- 2 MOUNT 48" AFF.
- 3 ACTUATION OF FIRE ALARM SYSTEM SHALL ACTIVATE (CLOSE) SLIDING DOOR.
- 4 PROVIDE TAMPER ALARM FOR KNOX BOX.
- 5 PROVIDE ADDRESSABLE INTERFACE MODULE (AIM) FOR EACH TAMPER AND FLOW SWITCH.
- 6 RADIO TRANSMITTER.

DRAWING NOTE

- 1. REFER TO DRAWING E-001 FOR SYMBOLS LIST.

1 FIRST FLOOR FIRE ALARM PART PLAN A
FA101 SCALE: 1/8" = 1'-0"

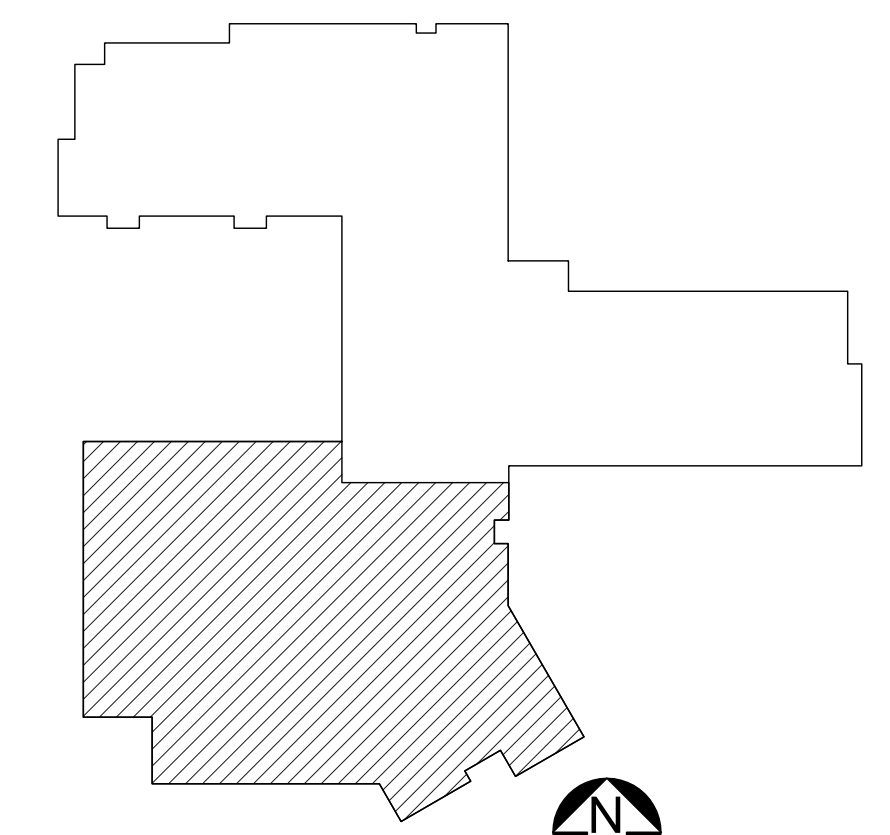

KEYPLAN
NOT TO SCALE
PLAN
NORTH

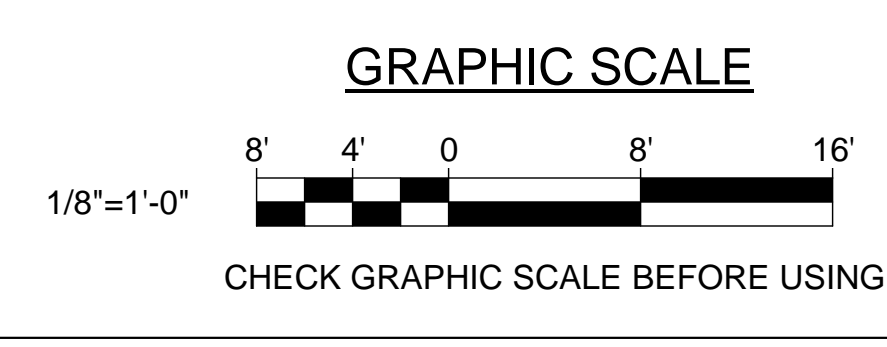

		STATE OF MAINE PUBLIC SCHOOL PROJECT TITLE: PORTLAND PUBLIC SCHOOLS NEW FRED P. HALL ELEMENTARY SCHOOL LOCATION: 23 ORONO ROAD, PORTLAND, ME TITLE THIS DWG: FIRST FLOOR FIRE ALARM PART PLAN A	
DRAWN BY: BPD CHECK BY: DCL	BY: NO. DATE: 03/17/17	OAK POINT ASSOCIATES ARCHITECTURE • ENGINEERING • PLANNING 231 Main Street, Biddeford, Maine 04005 207.283.9192	DRAWING NO: FA101 SHEET NO: 308 OF 312
NO. DATE DESCRIPTION REVISIONS		REVISIONS	