



DRAWING NOTE

1. PROVIDE AND SIZE COMMUNICATIONS PATHWAYS FOR QUANTITY OF CABLES. COORDINATE WITH ARCHITECTURAL, STRUCTURAL, AND MECHANICAL TRADES.

DRAWING KEYNOTES

- 1 LOCATE CENTERED ABOVE SMARTBOARD.
- 2 FOR PRINTER.

1 SECOND FLOOR TECHNOLOGY PART PLAN D
 ET104 SCALE: 1/8" = 1'-0"

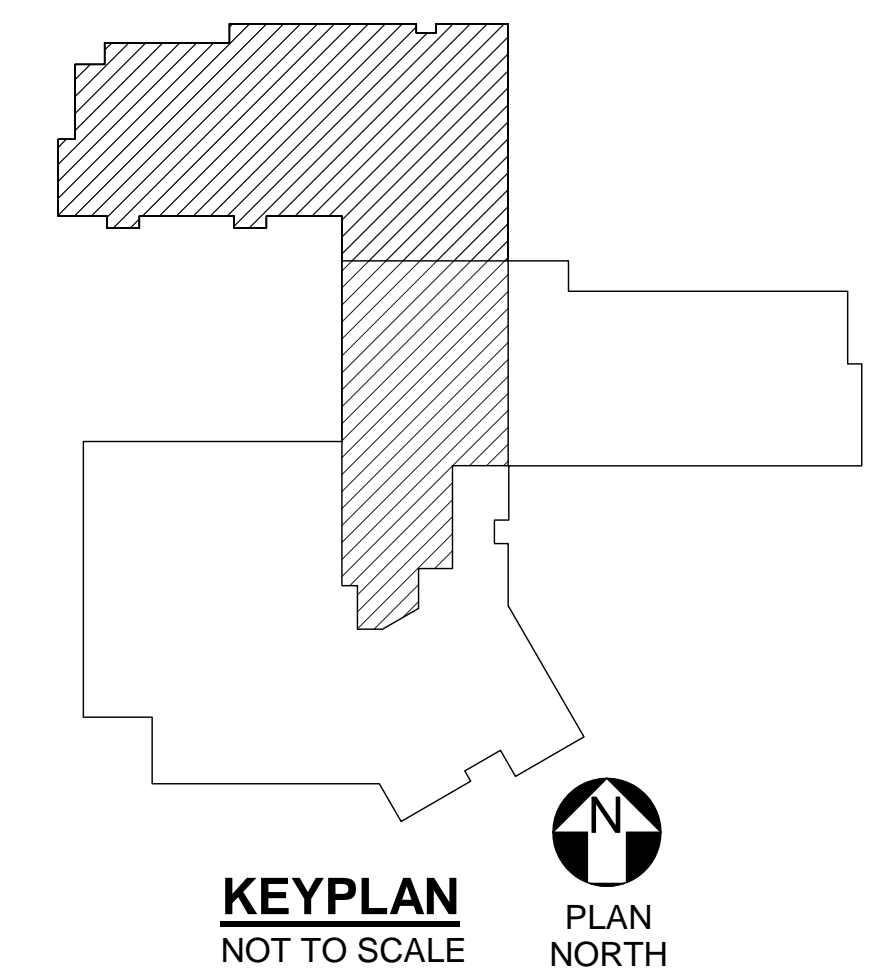
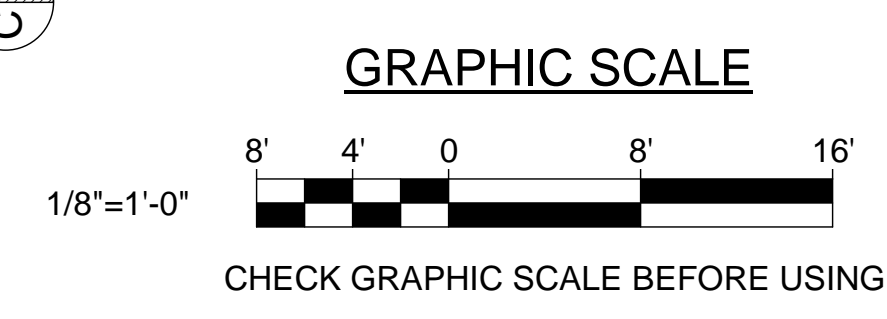

		STATE OF MAINE PUBLIC SCHOOL PROJECT TITLE: PORTLAND PUBLIC SCHOOLS NEW FRED P. HALL ELEMENTARY SCHOOL LOCATION: 23 ORONO ROAD, PORTLAND, ME TITLE THIS DWG: SECOND FLOOR TECHNOLOGY PART PLAN D 2-17-17	
DRAWN BY: BPD CHECK BY: DCL	BY: NO. DATE: 03/17/17	OAK POINT ASSOCIATES ARCHITECTURE • ENGINEERING • PLANNING 231 Main Street, Biddeford, Maine 04005 207.283.9192	DRAWING NO: ET104 SHEET NO: 305 OF 312
NO. DATE REVISIONS	DESCRIPTION	REVISIONS	DATE: 03/17/17