

DRAWING NOTE

1. PROVIDE AND SIZE COMMUNICATIONS PATHWAYS FOR QUANTITY OF CABLES. COORDINATE PATHWAY ROUTES WITH ARCHITECTURAL, STRUCTURAL AND MECHANICAL TRADES.

DRAWING KEYNOTES

- 1 MOUNTED UNDER CANOPY
- 2 FOR FIRE ALARM CONTROL PANEL.
- 3 FOR LIGHTING CONTROL PANEL.
- 4 FOR HVAC CONTROLLER. COORDINATE LOCATION WITH MECHANICAL TRADE.
- 5 CONNECT TO PA SYSTEM PANEL ON STAGE. REFER TO 5/ET502.
- 6 PUSH-BUTTON FOR FRONT DOOR RELEASE.
- 7 PUSH BUTTON FOR LOCKDOWN. INTERFACE WITH FIRE ALARM SYSTEM TO RELEASE MAGNETIC DOOR HOLDERS. FIELD VERIFY LOCATION WITH OWNER AND ARCHITECT PRIOR TO ROUGH-IN.
- 8 FOR LCD SCREEN. MOUNT 60" AFF.
- 9 REFER TO 4/ET502 FOR INTERCOM SYSTEM ONE-LINE DIAGRAM.
- 10 FOR PROJECTORS. COORDINATE LOCATIONS IN THE FIELD.
- 11 PROVIDE TWO (2) 4" UNDERSLAB CONDUITS FOR HORIZONTAL CABLING. CONDUIT SHALL ORIGINATE IN ROOM A24, RUN UNDERSLAB, RISE UP IN A 6" WALL CAVITY AND END ABOVE CEILING. PROVIDE CONDUIT(S) FOR QUANTITY OF HORIZONTAL CABLES IN ADMIN/NURSES AREA.

1 FIRST FLOOR TECHNOLOGY PART PLAN A
ET101 SCALE: 1/8" = 1'-0"

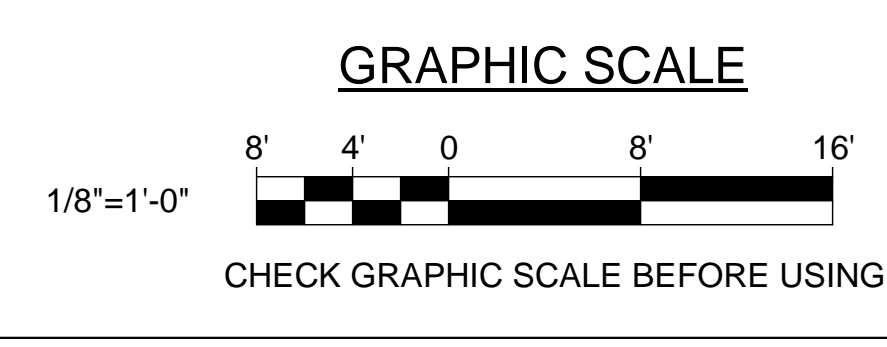
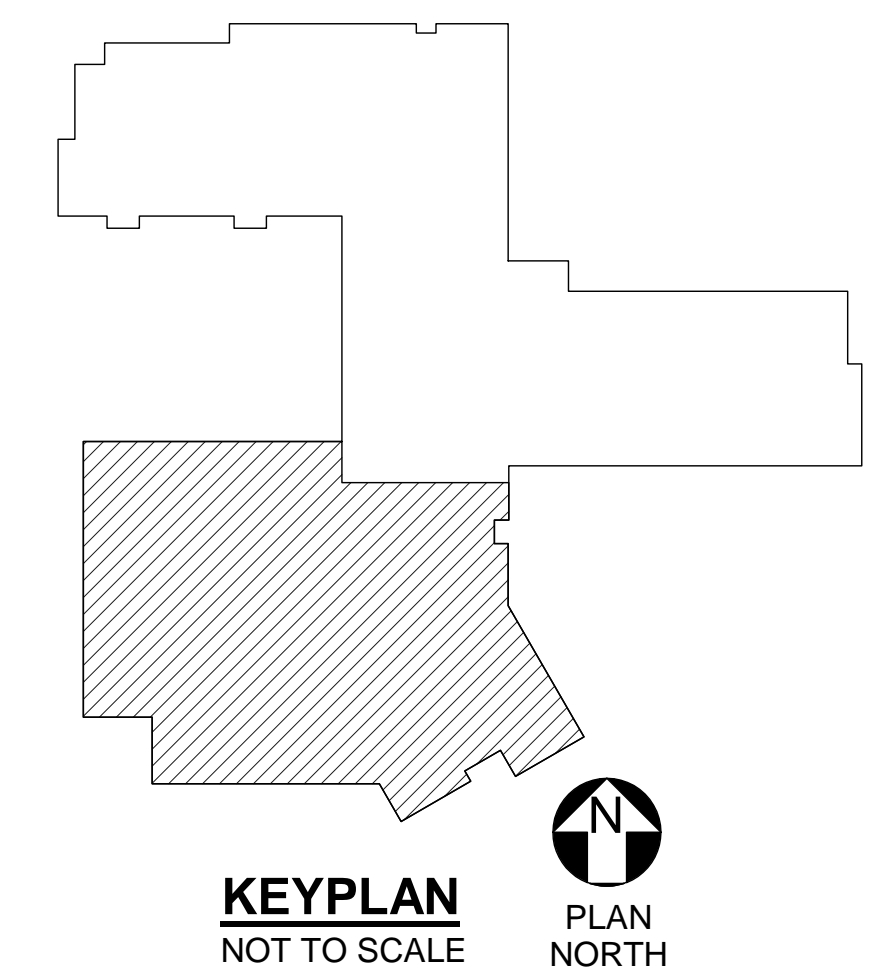

		<p>STATE OF MAINE PUBLIC SCHOOL PROJECT</p> <p>TITLE: PORTLAND PUBLIC SCHOOLS NEW FRED P. HALL ELEMENTARY SCHOOL LOCATION: 23 ORONO ROAD, PORTLAND, ME</p> <p>TITLE THIS DWG: FIRST FLOOR TECHNOLOGY PART PLAN A</p>	
<p>DRAWN BY: BPD CHECK BY: DCL</p>	<p>DATE: 03/17/17</p>	<p>NO. DATE DESCRIPTION REVISIONS</p>	<p>ARCHITECTURE • ENGINEERING • PLANNING 231 Main Street, Biddeford, Maine 04005 207.283.9192</p>