

KEYNOTES: (THIS SHEET ONLY.)

ELECTRIC/COMMUNICATIONS

- 1 - 7 NOT USED THIS SHEET.
- 8 UNDERGROUND LIGHTING LINE IN CONDUIT TRENCH. SEE DETAIL 2/C-508.
- 9 NOT USED THIS SHEET.
- 10 LIGHT POLE ON PRECAST CONCRETE BASE (TYPE AS INDICATED). SEE DETAIL 6/C-505.
- 11 NOT USED THIS SHEET.
- 12 LIGHTED FLAGPOLE AND HANDHOLE. SIZE HANDHOLE IN ACCORDANCE WITH FLAGPOLE LIGHTING MANUFACTURER'S WRITTEN REQUIREMENTS TO ACCOMMODATE LIGHTING TRANSFORMERS (±2'x2'-6"). SEE DETAILS 1/C-505 AND 4/C-508.
- 13 CONNECT TO EXISTING LIGHTING CONDUIT IN EXISTING LIGHTING HANDHOLE (INSTALLED IN PHASE 1).
- 14 - 19 NOT USED THIS SHEET.

WATER

- 20 WATER LINE IN PIPE TRENCH. SEE DETAIL 1/C-507.
- 21 GROUND HYDRANT. SEE DETAIL 6/C-507.
- 22 CONNECT WATER PIPING BETWEEN BUILDING AND WATER LINE AT FORMER TEMPORARY WATER LINE LOCATION WITH RESTRAINED MECHANICAL JOINT COUPLING IN ACCORDANCE WITH PORTLAND WATER DISTRICT'S WRITTEN REQUIREMENTS. SEE DETAIL 1/C-507
- 23 CONNECT WATER LINE TO STUB INSTALLED IN PHASE 1.
- 24 IRRIGATION BOX CONTAINING BATTERY OPERATED DC SOLENOID VALVE, VACUUM BREAKER AND CONTROLLER FOR FUTURE WATER FEATURE. ASSEMBLY SHALL BE FURNISHED BY OWNER AND INSTALLED BY CONTRACTOR. INSTALL IN ACCORDANCE WITH MANUFACTURER'S WRITTEN INSTRUCTIONS. SEE DETAIL 4/C-508 SIM.
- 25 2" WATER VALVE. SEE DETAIL 2/C-506.
- 26 - 49 NOT USED THIS SHEET.

SANITARY SEWER/ STORM DRAINAGE (SEE ALSO CG101)

- 50 - 57 NOT USED THIS SHEET.
- 58 FILL TEMPORARY SANITARY SEWER/STORM DRAIN LINE WITH PUMPED GROUT (FLOWABLE FILL). CAP/PLUG ENDS OF LINE TO REMAIN AND ABANDON IN PLACE IN ACCORDANCE WITH CITY OF PORTLAND'S WRITTEN REQUIREMENTS. SEE NOTIFICATION NOTES, SHEET C-001.
- 59 - 64 NOT USED THIS SHEET.
- 65 STORMWATER TREATMENT AREA (GRASSED UNDERDRAINED SOIL FILTER). SEE DETAIL 1/C-510.
- 66 STORMWATER TREATMENT AREA (SUBSURFACE SAND FILTER) SEE DETAIL 2/C-510.
- 67 - 72 NOT USED THIS SHEET.

NOTES:

1. SEE SHEETS CD101 AND CD102 FOR EXISTING SEWER AND DRAINAGE STRUCTURE INFORMATION.
2. SEE SHEET CG101 FOR STORM DRAINAGE INFORMATION.

GRAPHIC SCALE

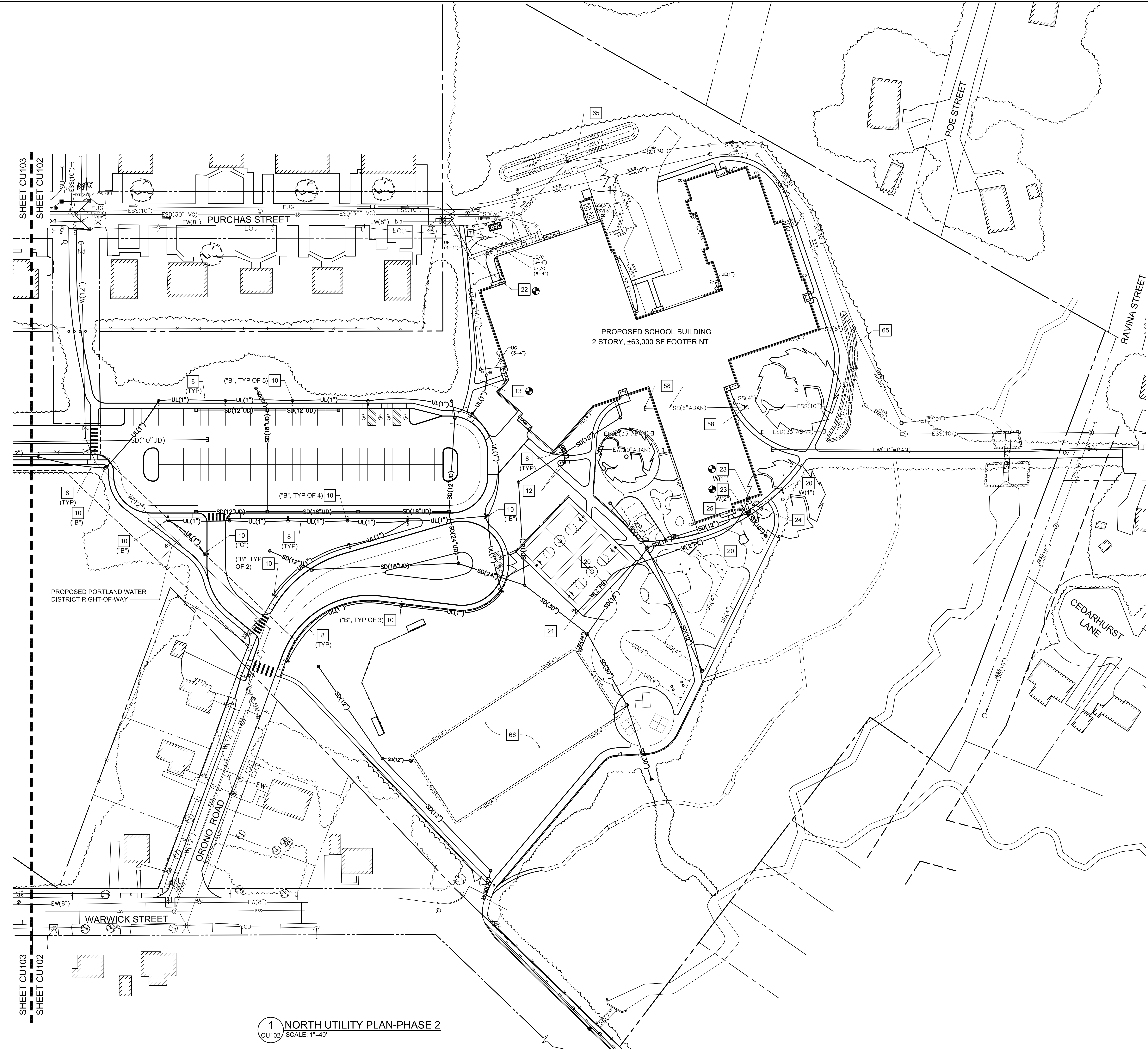
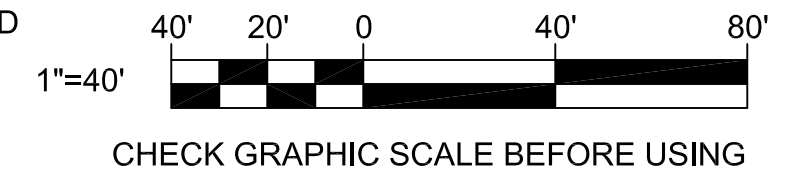

1 NORTH UTILITY PLAN-PHASE 2
CU102 SCALE: 1"=40'

		STATE OF MAINE PUBLIC SCHOOL PROJECT TITLE: PORTLAND PUBLIC SCHOOLS NEW FRED P. HALL ELEMENTARY SCHOOL LOCATION: 23 ORONO ROAD, PORTLAND, ME TITLE THIS SHEET: NORTH UTILITY PLAN-PHASE 2	
DRAWN BY: JSD CHECKED BY: JLG			
NO.	DATE	DESCRIPTION	BY
REVISIONS DATE: 03/17/17			
DRAWING NO.		SHEET NO.	
CU102		39 OF 312	