

KEYNOTES: (THIS SHEET ONLY.)

- 1 CONSTRUCTION FENCE; PROVIDE 6' TALL CHAIN LINK FENCING WITH DRIVEN POSTS IN LIEU OF MOVABLE FENCE PANELS WHERE INDICATED WITH "CLF". SEE DETAIL 4/C-505 (SIM)
- 2 PROTECT EXISTING TREE TO REMAIN. SEE SHEET CD104.
- 3 - 10 NOT USED THIS SHEET.
- 11 ASPHALT CONCRETE PAVEMENT. SEE DETAIL 1/C-503.
- 12 PARTIAL-DEPTH ASPHALT CONCRETE: 6" THICK AGGREGATE BASE COURSE, 2-1/2" ASPHALT CONCRETE BINDER COURSE AND 1-1/2" ASPHALT CONCRETE WEARING COURSE. SEE DETAIL 1/C-503 (SIM).
- 13 TIPDOWN CONCRETE CURB. SEE DETAIL 10/C-503.
- 14 VERTICAL CONCRETE CURB. SEE DETAIL 10/C-503.
- 15 VERTICAL GRANITE CURB. SEE DETAIL 12/C-503.
- 16 TIPDOWN GRANITE CURB. SEE DETAIL 12/C-503.
- 17 ASPHALT CONCRETE SIDEWALK. SEE DETAIL 5/C-503.
- 18 CONCRETE SIDEWALK. SEE DETAIL 6/C-503.
- 19 STONEDUST SURFACE. SEE DETAIL 4/C-503.
- 20 NOT USED THIS SHEET.
- 21 STORM WATER TREATMENT AREA: GRASSED UNDERDRAINED SOIL FILTER (INSTALLED IN PHASE 1). SEE SHEET CG101 AND DETAIL 1/C-510.
- 22 STORMWATER TREATMENT AREA: SUBSURFACE SAND FILTER. SEE SHEET CG101 AND DETAIL 2/C-510.
- 23 TURFGRASS-6" PLANTING SOIL AND SOD. SEE SHEET LS101 FOR EXTENT OF SEEDING/SODDING.
- 24 TURFGRASS-6" PLANTING SOIL, SEED (GENERAL LAWN SEED MIX), FERTILIZER AND MULCH ALL DISTURBED AREAS UNLESS INDICATED OTHERWISE. SEE SHEET LS101 FOR EXTENT OF SEEDING/SODDING.
- 25 MEADOW-6" PLANTING SOIL, SEED (RESTORATION AREA SEED MIX), FERTILIZER AND MULCH. SEE SHEET LS101 FOR EXTENT OF SEEDING/SODDING.
- 26 ACCESSIBLE CURB CUT (TYPE AS INDICATED). SEE DETAIL 1/C-504.
- 27 6" THICK MULCH (UNDER CANOPY OF TREES TO REMAIN).
- 28 - 30 NOT USED THIS SHEET.
- 31 DUMPSTER PAD AND ENCLOSURE. SEE DETAIL 2/C-505.
- 32 REINFORCED CONCRETE PAD AND 15' BENCH (NOT IN CONTRACT).
- 33 TRANSFORMER PAD. SEE DETAIL 7/C-508.
- 34 CHAIN LINK FENCE BACKSTOP. SEE DETAIL 5/C-508.
- 35 35' FLAGPOLE ON CONCRETE BASE. SEE DETAIL 1/C-505.
- 36 BOLLARD. SEE DETAIL 13/C-503.
- 37 CHAIN LINK FENCE GATE (CLEAR OPENING AS INDICATED). SEE DETAIL 6/C-504.
- 38 RIPRAP SWALE. SEE SHEET CG101, SEE DETAIL 9/C-502 (SIM).
- 39 CHAIN LINK FENCE (HEIGHT AS INDICATED). SEE DETAIL 6/C-504.
- 40 LEAF GATE (CLEAR OPENING AS INDICATED). SEE DETAIL 5/C-504.
- 41 TREE/SHRUB PLANTING. SEE LS101.
- 42 REFILL DEPRESSION FROM FORMER STORM DRAIN OUTLET WITH GRANULAR BORROW AND PROVIDE 6" TOPSOIL, SEED (RESTORATION AREA SEED MIX), FERTILIZER AND MULCH.
- 43 SAND PLAY SURFACE.
- 44 SKINNED INFIELD AND PITCHERS MOUND. SEE DETAILS 7/C-504 AND 8-C-504.
- 45 WALKING TRAIL. SEE DETAIL 3/C-503.
- 46 MOW STRIP. SEE DETAIL 11/C-503.
- 47 POSSIBLE SNOW STORAGE AREA.
- 48 - 54 NOT USED THIS SHEET.
- 55 DETECTABLE WARNING PANEL. SEE DETAIL 9/C-503.

NOTES:

- 1. SEE SHEET CL101 FOR LAYOUT INFORMATION.
- 2. SEE CM101 FOR PAVEMENT MARKING AND SIGNAGE INFORMATION.
- 3. SEE SHEET LS101 FOR PLANTING AND SEEDING/SODDING INFORMATION.

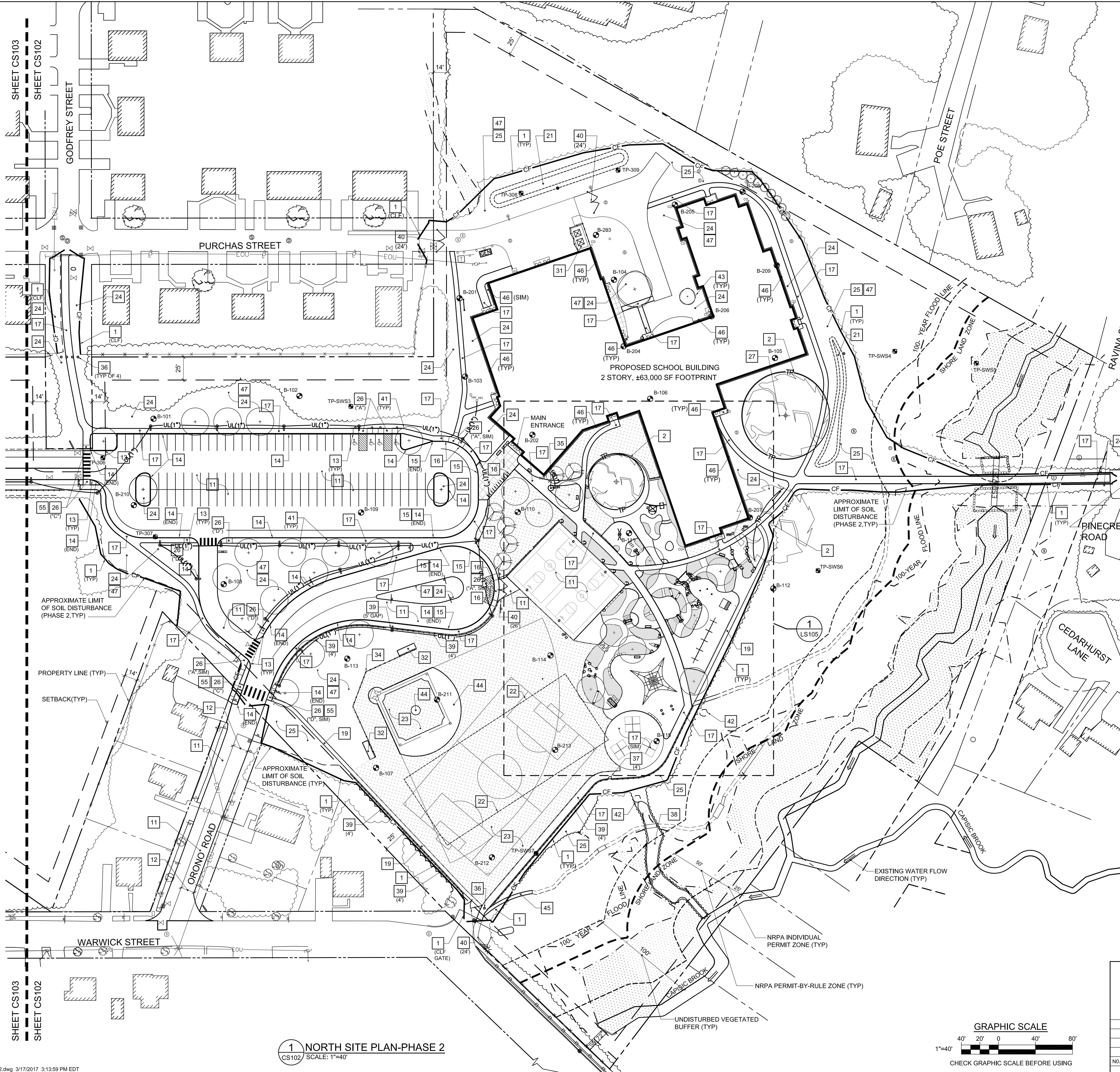

1 NORTH SITE PLAN-PHASE 2
SCALE: 1"=40'

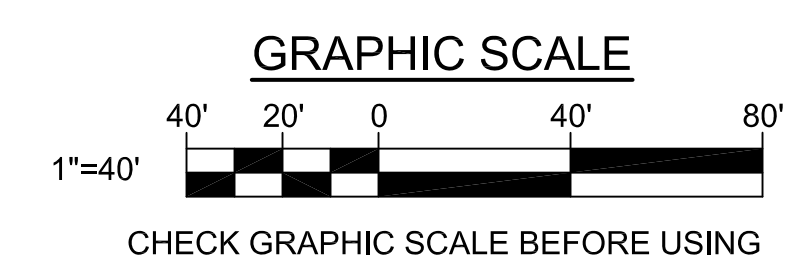

		<p>STATE OF MAINE PUBLIC SCHOOL PROJECT</p> <p>TITLE: NEW FRED P. HALL ELEMENTARY SCHOOL LOCATION: 23 ORONO ROAD, PORTLAND, ME TITLE THIS SHEET: NORTH SITE PLAN-PHASE 2</p>	
<p>DRAWN BY: JSD CHECKED BY: JLG</p>		<p>OAK POINT ASSOCIATES</p> <p>DRAWING NO. CS102 SHEET NO. 33 OF 312</p>	
NO.	DATE	DESCRIPTION	BY
<p>REVISIONS</p>			
		DATE: 03/17/17	