

KEYNOTES: (THIS SHEET ONLY.)

- 1 CONSTRUCTION FENCE: PROVIDE 6' TALL CHAIN LINK FENCING WITH DRIVEN POSTS IN LIEU OF MOVABLE FENCE PANELS WHERE INDICATED WITH "CLF". SEE DETAIL 4/C-505 (SIM)
- 2 PROTECT EXISTING TREE TO REMAIN. SEE DETAIL 2/CD104.
- 3 EXISTING ASPHALT CONCRETE PAVEMENT.
- 4 EXISTING GRAVEL/STONE DUST WALK.
- 5 EXISTING ASPHALT CONCRETE SIDEWALK.
- 6 EXISTING TURFGRASS/MEADOW.
- 7 EXISTING WOODED AREA.
- 8 EXISTING PLAYGROUND EQUIPMENT.
- 9 EXISTING PLANTING BED.
- 10 GRAVEL SURFACE. SEE DETAIL 2/C-503 (SIM, WITH AGGREGATE BASE SURFACE IN LIEU OF STONEDUST).
- 11 ASPHALT CONCRETE PAVEMENT (BINDER COURSE ONLY-PROVIDE WEARING COURSE IN PHASE 2). SEE DETAIL 1/C-503 (SIM).
- 12 NOT USED THIS SHEET.
- 13 TIPDOWN CONCRETE CURB. SEE DETAIL 10/C-503.
- 14 VERTICAL CONCRETE CURB. SEE DETAIL 10/C-503.
- 15 - 16 NOT USED THIS SHEET.
- 17 ASPHALT CONCRETE SIDEWALK. SEE DETAIL 5/C-503.
- 18 - 19 NOT USED THIS SHEET.
- 20 STONE DUST ACCESS ROAD. SEE DETAIL 2/C-503.
- 21 STORM WATER TREATMENT AREA: GRASSED UNDERDRAINED SOIL FILTER (INSTALLED IN PHASE 1). SEE SHEET CG101 AND DETAIL 1/C-510.
- 22 - 30 NOT USED THIS SHEET.
- 31 DUMPSTER PAD AND ENCLOSURE. SEE DETAIL 2/C-505.
- 32 REINFORCED CONCRETE PAD. SEE DETAIL 3/C-505.
- 33 TRANSFORMER PAD. SEE DETAIL 7/C-508.
- 34 - 35 NOT USED THIS SHEET.
- 36 BOLLARD. SEE DETAIL 13/C-503.
- 37 - 38 NOT USED THIS SHEET.
- 39 CHAIN LINK FENCE (HEIGHT AS INDICATED). SEE DETAIL 6/C-504.
- 40 - 47 NOT USED THIS SHEET.
- 48 TEMPORARY PRECAST CONCRETE BARRIER (JERSEY BARRIERS). INSTALL NEAR THE EDGE OF ROADWORK CONSTRUCTED IN PHASE IA.
- 49 REINSTALL EXISTING LANDSCAPE BOULDER. SEE DETAIL 10/L-501.
- 50 POSSIBLE CONTRACTOR STORAGE/STOCKPILE LOCATION.
- 51 3/4" CRUSHED STONE SURFACE ON WEED CONTROL BARRIER OVER 12" AGGREGATE BASE. MATCH EXISTING THICKNESS, +/- 4".
- 52 STONEDUST WALK. SEE DETAIL 4/C-503.
- 53 REINFORCED CONCRETE STOOP. SEE SHEETS SB101-SB104 AND DETAIL 5/SB501.
- 54 WOOD GUARDRAIL. SEE DETAIL 2/C-504.
- 55 PORTABLE CLASSROOM (BY OWNER - NOT IN CONTRACT).

NOTES:

- 1. SEE SHEET CL101 FOR LAYOUT INFORMATION.
- 2. SEE CM101 FOR PAVEMENT MARKING AND SIGNAGE INFORMATION.
- 3. SEE SHEET LS101 FOR PLANTING AND SEEDING/SODDING INFORMATION.

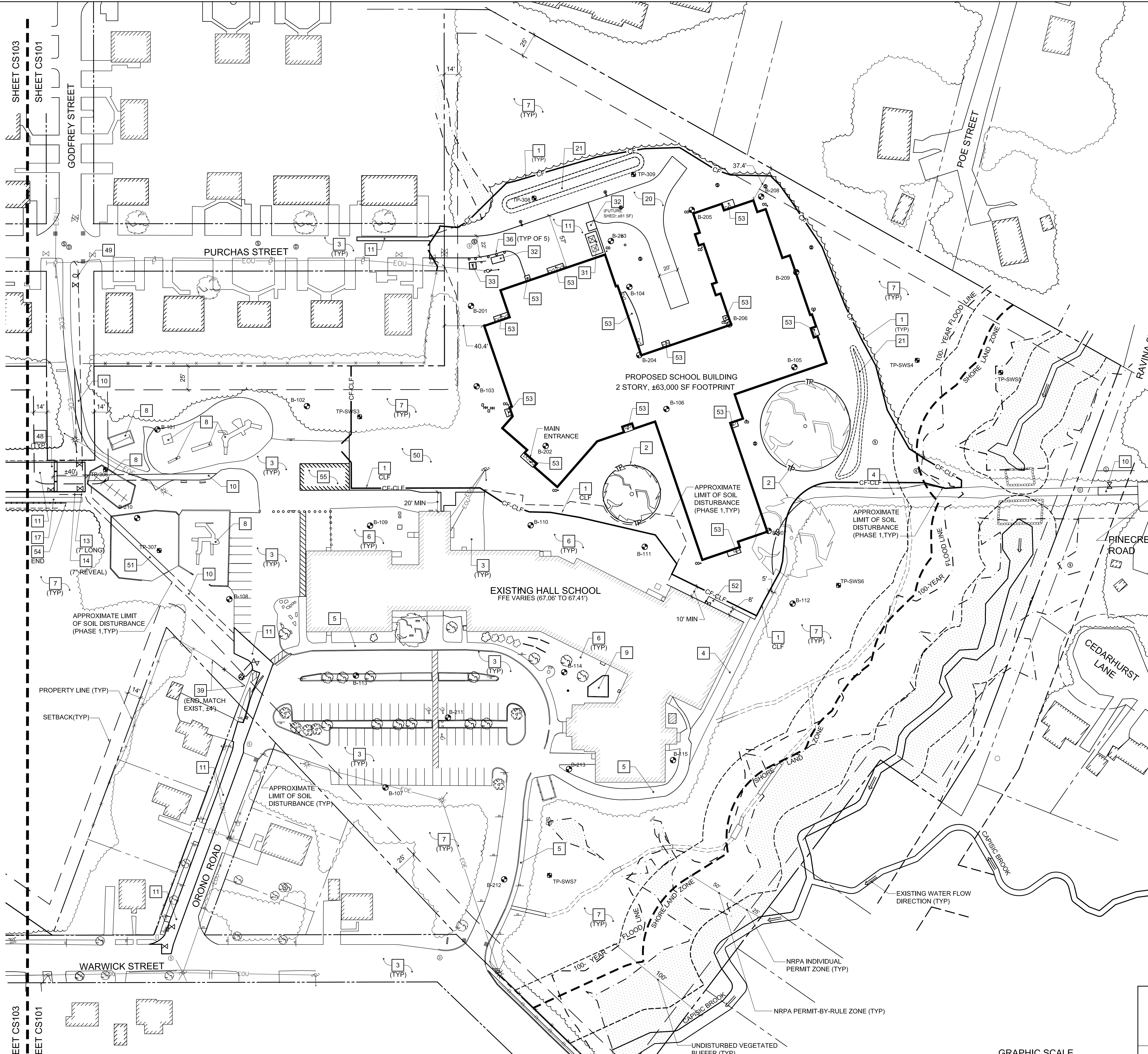

1 NORTH SITE PLAN-PHASE 1
CS101 SCALE: 1"=40'

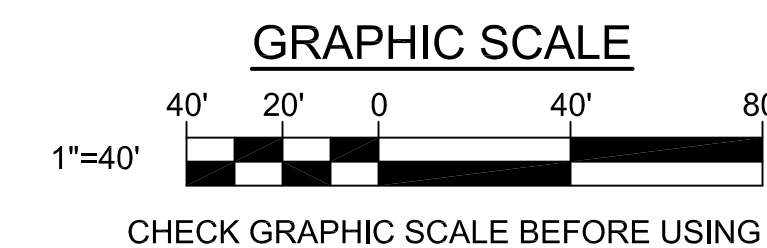

		STATE OF MAINE PUBLIC SCHOOL PROJECT	
		TITLE: NEW FRED P. HALL ELEMENTARY SCHOOL LOCATION: 23 ORONO ROAD, PORTLAND, ME TITLE THIS DATE: NORTH SITE PLAN-PHASE 1	
DRAWN BY: JSD CHECKED BY: JLG		OAK POINT ASSOCIATE DRAWING NO. CS101 SHEET NO. 32 OF 312	
NO.	DATE	DESCRIPTION	BY
		REVISIONS	DATE: 03/17/17