

EXISTING SEWER/DRAINAGE STRUCTURE SCHEDULE				
STRUCTURE	RIM ELEVATION	INVERT IN (SIZE)	INVERT OUT (SIZE)	NOTES
ECB1	64.88	60.7 (12")	60.6 (12")	
ECB2	66.18	60.6 (12")	±50.2	INVERT BASED ON CL INVERT
ECB3	64.76	57.5	57.4 (12")	
		57.6 (12")		
ECB4	63.99	58.2 (8")	59.3 (12")	
ECB5	64.76	60.4 (6")	60.1 (12")	
		60.3 (8")		
ECB6	63.62	59.7 (12")	58.6 (12")	
ECB7	62.79			UNABLE TO OPEN
ECB8	64.68	61.4 (8")	61.0 (8")	OUTLET INVERT BASED ON HOOD ELEVATION
ECB9	63.97		60.4	
ECB10	63.91		60.2	
ECB11	60.54		58.70 (12")	
ECB12	60.49			BURIED CATCH BASIN
EDMH1	65.32	56.90 (12")	±49.2	INVERT BASED ON CL INVERT
		±58.24 (6")		
		±58.62 (8")		
EDMH2	62.88	±48.96	±48.71 (30")	INVERT BASED ON CL INVERT
			48.79	
EDMH3	58.02		50.53 (8" OR 10")	
ESMH1	65.37		±54.87	INVERT BASED ON CL INVERT
ESMH2	66.31	53.9 (10")	53.8 (10")	
ESMH3				COVER BURIED
ESMH4	60.75	51.4 (10")	51.3 (8")	
ESMH5	54.28	46.28 (6")	441.53	INVERT BASED ON CL INVERT
ESMH6	65.30			
ESMH7	65.00	59.6 (8")	58.8 (8")	
		58.7 (8")		
		59.4		
ESMH8	65.29	55.29 (8")	54.39	DROP MANHOLE
		57.09 (8")		

KEYNOTES: (THIS SHEET ONLY.)

- 1 EXISTING ASPHALT CONCRETE PAVEMENT.
- 2 EXISTING GRAVEL/STONE DUST WALK.
- 3 EXISTING WALKING TRAIL.
- 4 EXISTING ASPHALT CONCRETE SIDEWALK.
- 5 EXISTING TURFGRASS/MEADOW.
- 6 EXISTING WOODED AREA.
- 7 EXISTING CHAIN LINK FENCE.
- 8 EXISTING PLAYGROUND EQUIPMENT.
- 9 EXISTING TREE TO REMAIN (APPROXIMATE DIAMETER AS INDICATED).
- 10 EXISTING RIP RAP.
- 11 EXISTING PLANTING BED.
- 12 EXISTING ERODED CHANNEL.
- 13 EXISTING BICYCLE RACKS.
- 14 EXISTING 8,000 GALLON UNDERGROUND FIBER GLASS FUEL OIL TANK.
- 15 EXISTING SEWER/STORM DRAINAGE STRUCTURE. NUMBER INDICATED WITH KEYNOTE.
- 16 - 19 NOT USED THIS SHEET.

- 20 SILT FENCE. SEE DETAIL 1/C-502.
- 21 REINFORCED SILT FENCE. SEE DETAIL 2/C-502.
- 22 SEDIMENT CONTROL WATTLE. SEE DETAIL 3/C-502.
- 23 CATCH BASIN INLET PROTECTION. SEE DETAIL 5/C-502.
- 24 POSSIBLE CONTRACTOR STORAGE/SOIL STOCKPILE LOCATION.
- 25 CONSTRUCTION FENCE. PROVIDE 6' TALL CHAIN LINK FENCING WITH DRIVEN POSTS IN LIEU OF MOVABLE FENCE PANELS WHERE INDICATED WITH "CLF". SEE DETAIL 4/C-505 (SM).
- 26 STABILIZED CONSTRUCTION ENTRANCE. SEE DETAIL 6/C-502.
- 27 TREE PROTECTION FENCE. SEE DETAIL 2/CD104.
- 28 DISCONNECT AND REMOVE EXISTING METAL SWING SET SUPPORT POLE AT BOLTED FITTING. PROVIDE TEMPORARY SUPPORT AS NECESSARY TO INSTALL STORM DRAIN LINE. REINSTALL SUPPORT POLE AFTER STORM DRAIN LINE IS INSTALLED.
- 29 NOT IN CONTRACT - EXISTING TREE BRANCHES WITHIN 12' OF PROPOSED BUILDING TO BE PRUNED BY CITY OF PORTLAND PRIOR TO THE START OF CONSTRUCTION.
- 30 SAWCUT AND REMOVE EXISTING ASPHALT CONCRETE PAVEMENT, ± 4" THICK.
- 31 NOT USED THIS SHEET.
- 32 SAWCUT AND REMOVE EXISTING ASPHALT CONCRETE SIDEWALK, ± 2" THICK.
- 33 REMOVE EXISTING SIDEWALK BENEATH TREE OVERHANG BY HAND. DO NOT DAMAGE EXISTING TREE OR TREE ROOTS DURING SIDEWALK REMOVAL.
- 34 REMOVE EXISTING STONE DUST SURFACE/WALK, ± 4" THICK.
- 35 GRUB OUT STUMPS FROM PREVIOUSLY WOODED AREA (TREE CLEARING IS NOT IN CONTRACT AND PERFORMED BY CITY OF PORTLAND PRIOR TO THE START OF CONSTRUCTION). REFER TO GEOTECHNICAL REPORT IN PROJECT SPECIFICATIONS FOR REQUIRED DEPTH OF TOPSOIL/ORGANIC-CONTAINING SOIL REMOVAL.
- 36 REMOVE EXISTING TREE (APPROXIMATE DIAMETER AS INDICATED). SEE ALSO SHEET CD104.
- 37 STRIP AND STOCKPILE EXISTING TOPSOIL. REFER TO GEOTECHNICAL REPORT IN PROJECT SPECIFICATIONS FOR REQUIRED DEPTH OF TOPSOIL/ORGANIC-CONTAINING SOIL REMOVAL.
- 38 REMOVE EXISTING WOOD CHIP PLAYGROUND SURFACE, ± 3" THICK AND EXISTING UNDERDRAINS.
- 39 REMOVE EXISTING GRAVEL SURFACE, ± 4" THICK.
- 40 NOT USED THIS SHEET.
- 41 FILL EXISTING WETLAND; STRIP EXISTING TOPSOIL AND ORGANIC MATERIAL. COMPLETELY DEWATER EXCAVATION AND FILL WITH 12" MINIMUM THICKNESS LAYER OF GRANULAR BORROW FOR UNDERWATER BACKFILL. THEN FILL TO SUBGRADE ELEVATION WITH GRANULAR BORROW.
- 42 - 43 NOT USED THIS SHEET.
- 44 REMOVE EXISTING TIMBER CURB/EDGING.
- 45 - 50 NOT USED THIS SHEET.
- 51 REMOVE EXISTING BOLLARD AND CONCRETE BASE.
- 52 - 54 NOT USED THIS SHEET.
- 55 REMOVE EXISTING METAL GUARD RAIL.
- 56 REMOVE EXISTING CHAIN LINK FENCE (HEIGHT AS INDICATED).
- 57 - 60 NOT USED THIS SHEET.
- 61 REMOVE EXISTING BASKETBALL HOOP AND METAL POST SET IN CONCRETE BASE.
- 62 REMOVE EXISTING JERSEY BARRIER DURING WATER LINE INSTALLATION. REINSTALL AFTER WATER LINE HAS BEEN INSTALLED AND BACKFILLED. SEE SHEET CU101.
- 63 NOT USED THIS SHEET.
- 64 REMOVE EXISTING WOOD BENCH.
- 65 NOT USED THIS SHEET.
- 66 STRIP EXISTING TURF GRASS UNDER TREE CANOPY BY HAND. DO NOT DAMAGE EXISTING TREE OR TREE ROOTS DURING TURF GRASS REMOVAL.
- 67 REMOVE EXISTING LANDSCAPE BOULDER (± 0.75 CY) AND STORE FOR REINSTALLATION.
- 68 REMOVE PORTION OF EXISTING BUILDING AND PROVIDE EXTERIOR WALL. SEE SHEET AD101.
- 69 REMOVE EXISTING UNDERDRAIN LINES AS NECESSARY FOR WATER MAIN INSTALLATION.
- 70 NOT USED THIS SHEET.
- 71 REMOVE EXISTING ±16' LONG x ±8' WIDE x ±8' DEEP PRECAST CONCRETE GRIT CHAMBER.
- 72 CUT AND REMOVE EXISTING SEWER LINE. PREP CUT ENDS FOR CONNECTION TO PROPOSED SEWER LINES/STRUCTURE WHERE INDICATED. BACKFILL TRENCH WITH 2" THICK (MINIMUM) LAYER OF GRANULAR BORROW UNDERWATER BACKFILL. THEN FILL TO SUBGRADE WITH GRANULAR BORROW FOR EMBANKMENT CONSTRUCTION.
- 73 CUT AND REMOVE EXISTING STORM DRAIN LINE/ UNDER DRAIN LINE. PROVIDE CAP/PLUG ON END OF LINE TO REMAIN OR PREP CUT ENDS FOR CONNECTION TO PROPOSED STORM DRAIN LINE/STRUCTURE WHERE INDICATED. BACKFILL TRENCH WITH 2" THICK (MINIMUM) LAYER OF GRANULAR BORROW UNDERWATER BACKFILL. THEN FILL TO SUBGRADE WITH GRANULAR BORROW FOR EMBANKMENT CONSTRUCTION.
- 74 REMOVE EXISTING SEWER/STORM DRAINAGE STRUCTURE (EXISTING STRUCTURE NUMBER INDICATED WITH KEYNOTE). BACKFILL WITH 2" THICK (MINIMUM) LAYER OF GRANULAR BORROW UNDERWATER BACKFILL. THEN FILL TO SUBGRADE WITH GRANULAR BORROW FOR EMBANKMENT CONSTRUCTION.
- 75 - 76 NOT USED THIS SHEET.
- 77 CAP/PLUG EXISTING STORM DRAIN LINE. FILL WITH PUMPED GROUT AND ABANDON IN PLACE IN ACCORDANCE WITH CITY OF PORTLAND'S WRITTEN REQUIREMENTS. SEE NOTIFICATION REQUIREMENTS. SHEET C-001.
- 78 PLUG EXISTING MANHOLE PENETRATION WITH NON-SHRINK GROUT.
- 79 REMOVE EXISTING RIP RAP (D₅₀=6").
- 80 CUT AND REMOVE EXISTING WATER LINE. COORDINATE SHUT OFF AND DISCONNECTION OF WATER LINE WITH PORTLAND WATER DISTRICT. CAP ENDS OF WATER LINE TO REMAIN IN ACCORDANCE WITH PORTLAND WATER DISTRICT'S WRITTEN REQUIREMENTS.
- 81 CAP EXISTING WATER LINE AND ABANDON IN PLACE. CAP ENDS OF WATER LINE TO REMAIN IN ACCORDANCE WITH PORTLAND WATER DISTRICT'S WRITTEN REQUIREMENTS.
- 82 REMOVE EXISTING WATER VALVE.
- 83 REMOVE EXISTING FIRE HYDRANT.
- 84 SALVAGE EXISTING WATER LINE MARKER POST AND DELIVER TO PORTLAND WATER DISTRICT OFFICE (225 DOUGLASS ST, PORTLAND, ME).

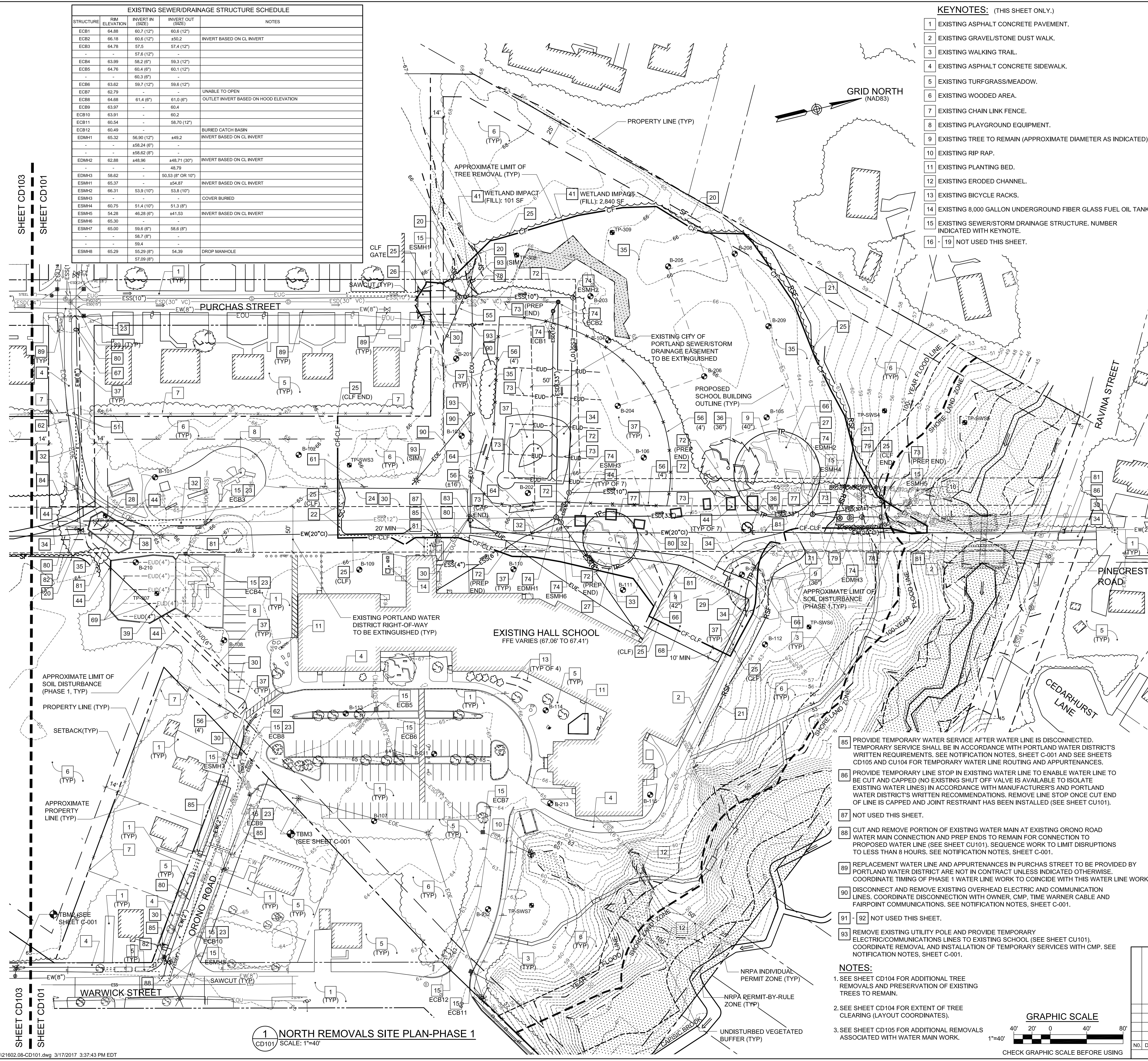

NOTES:

1. SEE SHEET CD104 FOR ADDITIONAL TREE REMOVALS AND PRESERVATION OF EXISTING TREES TO REMAIN.
2. SEE SHEET CD104 FOR EXTENT OF TREE CLEARING (LAYOUT COORDINATES).
3. SEE SHEET CD105 FOR ADDITIONAL REMOVALS ASSOCIATED WITH WATER MAIN WORK.

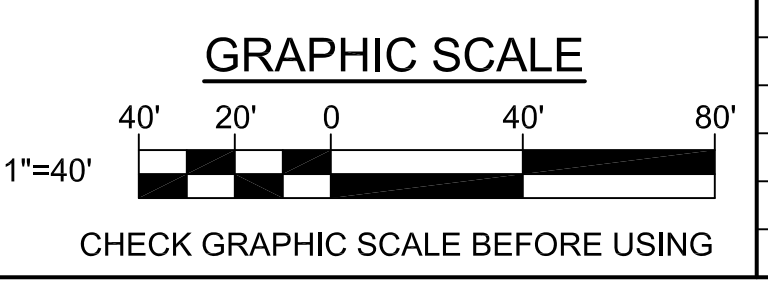

1 NORTH REMOVALS SITE PLAN-PHASE 1
SCALE: 1"=40'

		STATE OF MAINE PUBLIC SCHOOL PROJECT	
		TITLE: NEW FRED P. HALL ELEMENTARY SCHOOL LOCATION: 23 ORONO ROAD, PORTLAND, ME TITLE THIS DATE: NORTH REMOVALS SITE PLAN - PHASE I	
DRAWN BY: JSD CHECKED BY: JLG	DATE: 03/17/17	DRAWING NO.: CD101	SHEET NO.: 27 OF 312