

DISPLAY THIS CARD ON PRINCIPAL FRONTAGE OF WORK

CITY OF PORTLAND

Please Read
Application And
Notes, If Any,
Attached

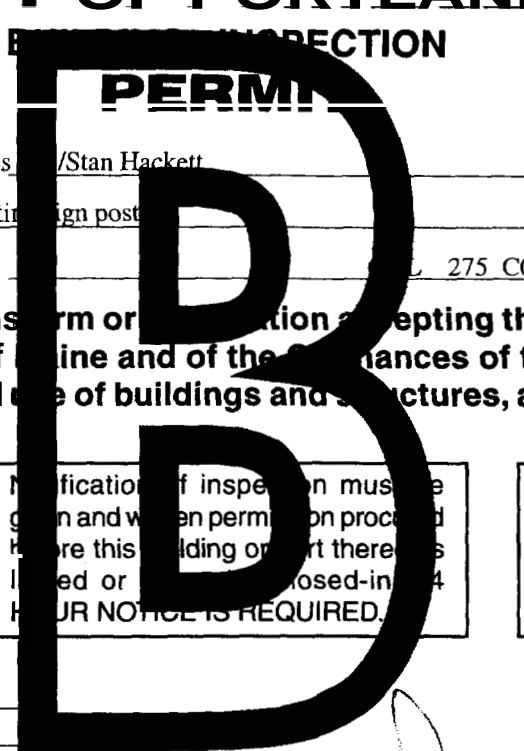

PERMIT ISSUED
Permit Number: 051659
NOV 17 2005
CITY OF PORTLAND

This is to certify that Wise Investment Properties / Stan Hackett
 has permission to Change sign insert on existing sign post
 AT 977 Brighton Ave Portland, OR 97209 275 C001001

provided that the person or persons who accept this permit shall comply with all of the provisions of the Statutes of the State of Oregon and of the Ordinances of the City of Portland regulating the construction, maintenance and use of buildings and structures, and of the application on file in this department.

Apply to Public Works for street line and grade if nature of work requires such information.

Notification of inspection must be given and when permission is procured before this building or part thereof is altered or closed-in. 4 HOUR NOTICE IS REQUIRED.

A certificate of occupancy must be procured by owner before this building or part thereof is occupied.

OTHER REQUIRED APPROVALS

Fire Dept _____
 Health Dept _____
 Appeal Board _____
 Other _____
 Department Name _____

Jamie Bourke 11/16/05
 Director - Building & Inspection Services

PENALTY FOR REMOVING THIS CARD

City of Portland, Maine - Building or Use Permit Application

389 Congress Street, 04101 Tel: (207) 874-8703, Fax: (207) 874-8716

PERMIT ISSUED

Permit No: 05-1689	Issue Date: NOV 17 2005	CBL: 275	C00:001
Owner Address: 36 Clearwater Dr Portland		Phone: 2078797425	

Location of Construction: 977 Brighton Ave	Owner Name: Wise Investment Properties Inc
Business Name:	Contractor Name: Stan Hackett

Signs - Permanent	RP
-------------------	----

Commercial <i>Business</i>	Commercial change sign insert on existing sign post <i>Business Service</i>
-------------------------------	--

\$90.00	\$90.00	3
---------	---------	---

FIRE DEPT: <input type="checkbox"/> Approved <input type="checkbox"/> Denied	INSPECTION: Use Group <i>B</i> Type: <i>Sign</i> <i>IBC-2003</i> Signature: <i>JMB 11/16/05</i>
---	--

Change sign insert on existing sign post

PEDESTRIAN ACTIVITIES DISTRICT (P.A.D.)

Action: Approved Approved w/Conditions Denied

Signature: _____ Date: _____

Permit Taken By: dmartin	Date Applied For: 11/10/2005
-----------------------------	---------------------------------

Zoning Approval

1. 2 Building permits do not include plumbing, septic or electrical work. 3 Building permits are void if work is not started within six (6) months of the date of issuance. False information may invalidate a building permit and stop all work..	Special Zone or Reviews <input type="checkbox"/> Shoreland <input type="checkbox"/> Wetland <input type="checkbox"/> Flood Zone <input type="checkbox"/> Subdivision <input type="checkbox"/> Site Plan Maj <input type="checkbox"/> Minor <input type="checkbox"/> MM <input type="checkbox"/> <i>OK w/ conditions</i> Date: <i>11/16/05</i> <i>ASB</i>	Zoning Appeal <input type="checkbox"/> Variance <input type="checkbox"/> Miscellaneous <input type="checkbox"/> Conditional Use <input type="checkbox"/> Interpretation <input type="checkbox"/> Approved <input type="checkbox"/> Denied	Historic Preservation <input checked="" type="checkbox"/> Not in District or Landmark <input type="checkbox"/> Does Not Require Review <input type="checkbox"/> Requires Review <input type="checkbox"/> Approved <input type="checkbox"/> Approved w/Conditions <input type="checkbox"/> Denied Date: <i>ASB</i>
	Date: _____		

CERTIFICATION

I hereby certify that I am the owner of record of the named property, or that the proposed work is authorized by the owner of record and that I have been authorized by the owner to make this application as his authorized agent and I agree to conform to all applicable laws of this jurisdiction. In addition, if a permit for work described in the application is issued, I certify that the code official's authorized representative shall have the authority to enter all areas covered by such permit at any reasonable hour to enforce the provision of the code(s) applicable to such permit.

SIGNATURE OF APPLICANT	ADDRESS	DATE	PHONE
RESPONSIBLE PERSON IN CHARGE OF WORK, TITLE		DATE	PHONE

City of Portland, Maine - Building or Use Permit

389 Congress Street, 04101 Tel: (207) 874-8703, Fax: (207) 874-8716

Permit No: 05-1659	Date Applied For: 11/08/2005	CBL: 275 C001001
------------------------------	--	----------------------------

Location of Construction: 977 Brighton Ave	Owner Name: Wise Investment Properties Inc	Owner Address: 36 Clearwater Dr	Phone:
Business Name:	Contractor Name: Stan Hackett	Contractor Address: Portland	Phone (207) 879-7425
Lessee/Buyer's Name	Phone:	Permit Type: Signs - Permanent	

Commercial change sign insert on existing sign post	Change sign insert on existing sign post
---	--

Dept: Zoning **Status:** Approved with Conditions **Reviewer:** Ann Machado **Approval Date:** 11/16/2005
Note: **Ok to Issue:**

1) The proposed sign shall be set back five (5) feet from the front property line.

ADDRESS is allowed in this area. If any other signage is extended into this area, it would be deemed an extension of your allowable signage. NO OTHER messages shall be present in this area.





Signage/Awning Permit Application

If you or the property owner owes real estate or personal property taxes or user charges on any property within the City, payment arrangements must be made before permits of any kind are accepted.

Location/Address of Construction: <u>977 Brighton Ave</u>		
Total Square Footage of Proposed Structure <u>Changing Sign Panels to Existing SIGN 30 Square Feet</u>	Square Footage of Lot <u>±2,000 SF</u>	
Tax Assessor's Chart, Block & Lot Chart# <u>215</u> Block# <u>C</u> Lot# <u>1,2,3, 6,7,8,9,10</u>	Owner: <u>CHASE ME LLC 24 Willow Lane South, Portland, ME 04106</u>	Telephone: <u>207-831-5472</u>
Lessee/Buyer's Name (If Applicable) <u>STANDARDIZED HOME MAINTENANCE, LLC D/B/A RENTA HUSBAND OF ETR</u>	Applicant name, address & telephone: <u>PORTLAND 977 Brighton Ave PORTLAND, ME 04103 207-879-7425</u>	Total s.f. of signage x \$2.00 Per s.f. plus \$30.00/\$65.00 For H.D. signage= Total Fee: \$ <u>90.00</u> Awning Fee= cost of work _____ Total Fee: \$ <u>90</u>
Current Specific use: <u>Telecommunications</u>		
If vacant, what was prior use: _____		
How long has it been vacant? _____		
Proposed Use: <u>Handyman Shop & Office</u>		
Project Description: <u>Change Existing Sign Panels to New Sign Panels</u>		
Contractor's name, address & telephone:		
Who should we contact when the permit is ready: <u>STAN HACKETT</u>		
Mailing address: _____ Phone: <u>207-879-7425</u>		

Please submit all of the information outlined in the Sign/Awning Application Checklist. Failure to do so will result in the automatic denial of your permit.

In order to be sure the City fully understands the full scope of the project, the Planning and Development Department may request additional information prior to the issuance of a permit. For further information visit us on-line at www.portlandmaine.gov, stop by the Building Inspections office, room 315 City Hall or call 8748703.

I hereby certify that I am the Owner of record of the named property, or that the owner of record authorizes the proposed work and that I have been authorized by the owner to make this application as his/her authorized agent. I agree to conform to all applicable laws of this jurisdiction. In addition, if a permit for work described in this application is issued, I certify that the Code Official's authorized representative shall have the authority to enter all areas covered by this permit at any reasonable hour to enforce the provisions of the codes applicable to this permit.

Signature of applicant: <u>Stan Hackett</u>	Date: <u>11/8/2005</u>
---	------------------------

This is not a permit; you may not commence ANY WORK until the permit is issued.

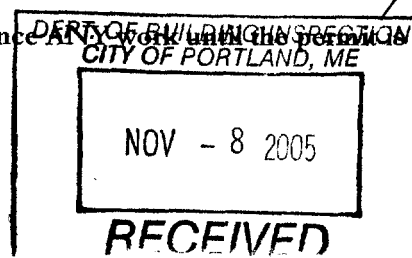



Signage/Awning Pre-Application Questionnaire

Please complete all of the following information.

Address: 977 Brighton Ave Zone: RP
CBL 275 C 002, 1, 2, 3, 6, 7, 8, 9, 10

Single Tenant Lot? Yes No Multi Tenant Lot? Yes No

Tenant/allocated building space frontage (feet): Length: _____ Height _____

Information on proposed sign(s):

Freestanding (e.g., pole) sign? Yes No Dimensions proposed 59' x 72"
Bldg. wall sign? (attached to bldg) Yes No Dimensions proposed: _____

height?
8' off
permit #
02-0134

Information on already existing and permitted sign(s):

Freestanding (e.g., pole) sign? Yes No Dimensions proposed 30 sq
Bldg. wall sign? (attached to bldg) Yes No Dimensions proposed _____
Awning? Yes No Dimensions: _____
Lot frontage (feet): 20 ft

Awning? Yes No Is awning backlit? Yes No
Height of awning: _____ Length of awning: _____ Depth: _____
Is there any communication, message, trademark or symbol on it? Yes No
If yes, total s.f. of panels w/communications, message, trademark or symbol _____ s.f.

A site sketch and building sketch showing exactly where existing and new signage is located must be provided. Sketches and/or pictures of proposed signage are also required.

Signature of applicant: Henry K. Hubert Date: 11/8/05

-For office use only-
max. area 30 sq
Height 8'
setback 5'
 $59" \times 72" = 4248 / 144 = 29.5 \text{ sq}$
sign panel = 6' high
base?

permit #

02-0134
original sign

SIGNAGE PRE-APPLICATION

PLEASE ANSWER ALL QUESTIONS

ADDRESS: 977 BRIGHTON AVE ZONE: RP

OWNER: WISE INVESTMENT PROPERTIES

APPLICANT: BURR SIGNS

ASSESSOR NO. _____

PLEASE CIRCLE APPROPRIATE ANSWER

SINGLE TENANT LOT? YES NO

MULTI-TENANT LOT? YES NO

FREESTANDING SIGN? (ex. Pole Sign) YES NO --- DIMENSIONS 6' x 5' HEIGHT 8'

MORE THAN ONE SIGN? YES NO DIMENSIONS _____ HEIGHT _____

SIGN ATTACHED TO BLDG.? YES NO DIMENSIONS _____

MORE THAN ONE SIGN? YES NO DIMENSIONS _____

AWNING: YES IS AWNING BACKLIT? YES HEIGHT OFF SIDEWALK _____

IS THERE ANY MESSAGE, TRADEMARK OR SYMBOL ON IT?

LIST ALL EXISTING SIGNAGE AND THEIR DIMENSIONS:

*** TENANT BLDG. FRONTAGE (IN FEET): _____
REQUIRED INFORMATION

only Free Standing Signs Permitted

AREA FOR COMPUTATION

Allowed 30' MAX - 30' show.
8' max height - 8' show.
5' set back from property line

YOU SHALL PROVIDE:

A SITE SKETCH AND BUILDING SKETCH SHOWING EXACTLY WHERE EXISTING AND NEW SIGNAGE IS LOCATED MUST BE PROVIDED. SKETCHES AND/OR PICTURES OF PROPOSED ARE ALSO REQUIRED.

SIGNATURE OF APPLICANT: [Signature] DATE: 02/11/00



Signage/Awning Permit Application Checklist

All of the following information is required and must be submitted. Checking off each item as you prepare your application package will ensure your package is complete and will help to expedite the permitting process.

- Certificate of Liability listing the City as additional insured if any portion of the sign abuts or encroaches on any public right of way, or can fall into any public right of way.
- Letter of permission from the owner indicating the permissions granted and the tenant/space building frontage.
- A sketch plan of lot indicating location of buildings, driveways and any abutting streets or rights of way, lengths of building frontages, street frontages and all existing setbacks. Please indicate on the plan all existing and proposed signs with their dimensions and specific locations. Be sure to include distance from the ground and building façade dimensions for any signage attached to the building.
- A sketch or photo of any proposed sign(s) indicating content, dimensions, materials, source of illumination, construction method as well as specifics of installation/attachment.
- Certificate of flammability required for awning or canopy.
- A UL# is required for lighted signs at the time of final inspection,
- Pre-application questionnaire completed and attached.
- Photos of existing signage
- A complete set of plans that include structural details, size and dimensions and a cross section showing the slope and depth ratios, or for above ground pool, design specifications. Often this information can be obtained from the manufacturer.

Permit fee for signage or awning-with-signage: **\$30.00** plus \$2.00 per square foot of sign.

Permit fee for awning-without-signage is based on cost of work:
\$30.00 for the first \$1,000.00, **\$9.00** per additional **\$1,000.00** of cost.

Base application fee for any Historic District signage is **\$65.00**.

29-2-1974

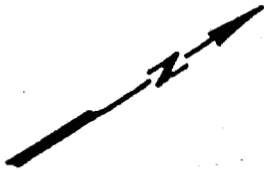

Wessex Street

29-2-1974

977 Brighton Avenue

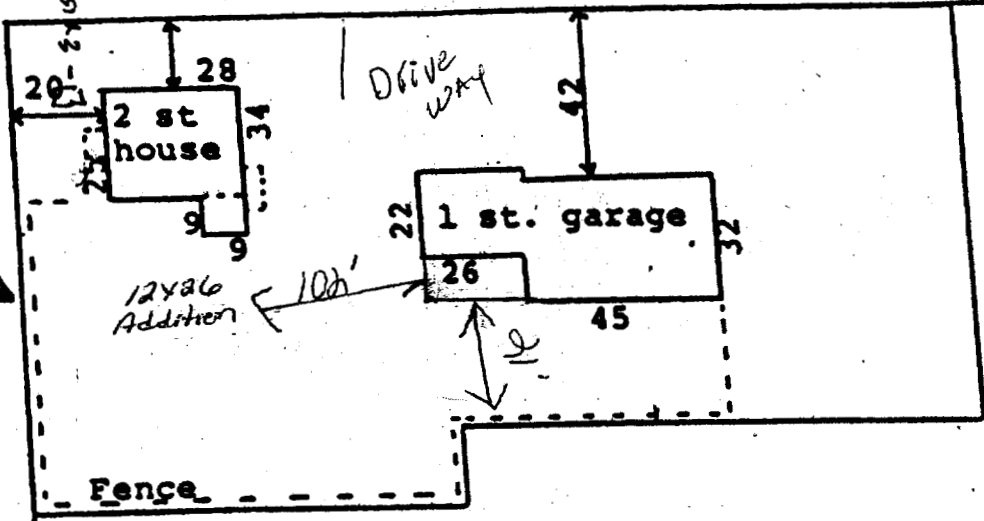

34
 25

 170
 48

 850
 850

Lomond Street



FASTSIGNS®
413 Western Ave Jetport Plaza
S Portland, ME 04106

Tel: (207)773-5499
Fax: (207)773-9802



This FASTSIGNS® Store is
E-Media Friendly!

Adobe
Solutions Network
Adobe Solutions Network, Service
Provider



Corel Authorized Service Bureau

Additional Services:

- Architectural Signs and Graphics
- Banners
- Custom Ready-To-Apply Lettering
- Full Color Digital Graphics
- Installation and Service
- Labels and Decals
- Magnetic Signs
- Real Estate and Property Management Signs
- Safety and I.D. Signage
- Special Events and Presentation Signs
- Trade Show Displays and Graphics
- Vehicle Graphics
- Vehicle Lettering

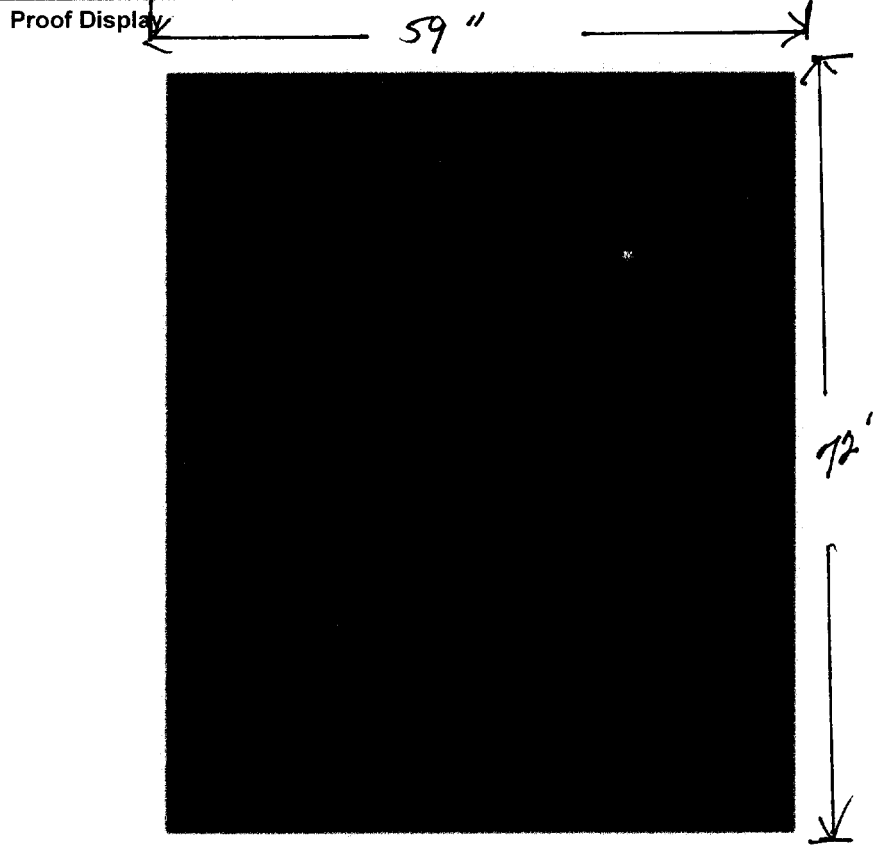

[Click to enlarge](#)
[Download](#)

*Sign fixture is already there
Just replacing panels.*

Approve

Approve with Changes

Decline (Please provide reasons for declined proof)

Our Proof and Production Policy
At FASTSIGNS®, we take pride in precision, but the final examination for accuracy is your responsibility. Before giving approval, please examine all proofs carefully for the accuracy of information presented, as well as



Existing Sign

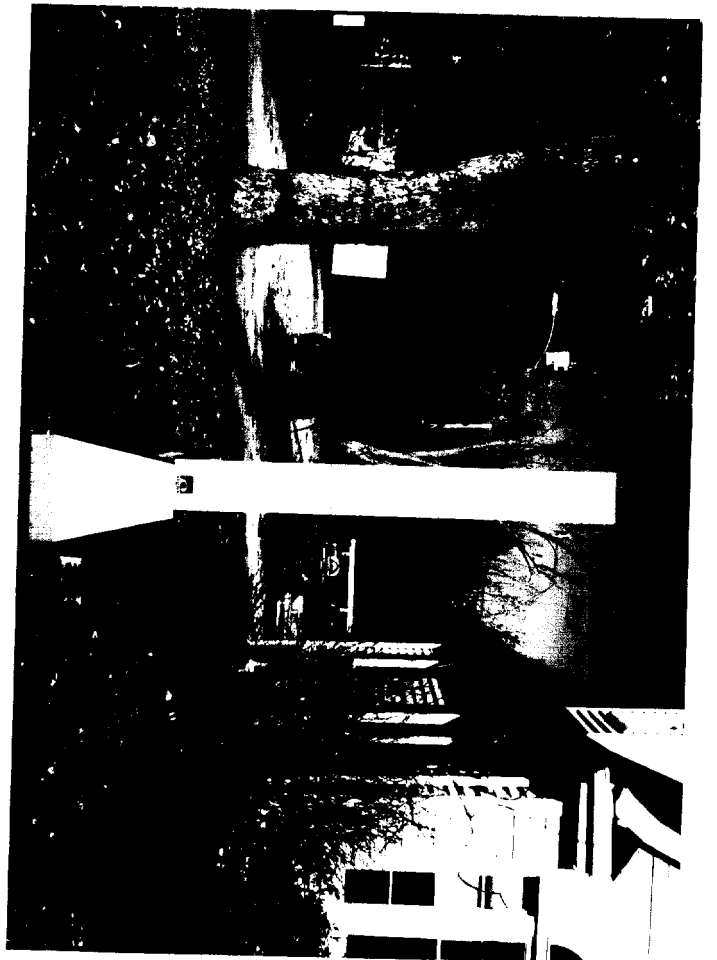

November 7, 2005

Chase Me, LLC
24 Willow Lane
South Portland, Me 04106

To Whom It May Concern:

Regarding: Signage at 977 Brighton Ave, Portland, Me.

This letter authorizes Standardized Home Maintenance, LLC d/b/a Rent-A-Husband of Greater Portland to use the existing lighted sign structure located at my property located at 977 Brighton Ave, Portland, Me 04103 to hold their signage for their business. They will be responsible for all fees and taxes for the sign.

Best Regards

A handwritten signature in black ink, appearing to read "Mark Chase", with a long, sweeping underline.

Mark Chase
President
Chase Me, LLC

ACORD CERTIFICATE OF LIABILITY INSURANCE

DATE (MM/DD/YYYY)
11/08/2005

PRODUCER (207) 774-5653 FAX (207) 871-0236
C.M. Bowker Co.
835 Forest Avenue
Portland, ME 04103
Nannette Wirth CZSR

THIS CERTIFICATE IS ISSUED AS A MATTER OF INFORMATION ONLY AND CONFERS NO RIGHTS UPON THE CERTIFICATE HOLDER. THIS CERTIFICATE DOES NOT AMEND, EXTEND OR ALTER THE COVERAGE AFFORDED BY THE POLICIES BELOW.

INSURED Rent A Husband of Greater Portland
Standardized Home Maintenance LLC dba
173 Neal Street
Portland, ME 04102

INSURERS AFFORDING COVERAGE		NAIC #
INSURER A	National Grange Insurance Co	14788
INSURER B	Maine Employers Mutual	0025
INSURER C		
INSURER D		
INSURER E		

COVERAGES

THE POLICIES OF INSURANCE LISTED BELOW HAVE BEEN ISSUED TO THE INSURED NAMED ABOVE FOR THE POLICY PERIOD INDICATED. NOTWITHSTANDING ANY REQUIREMENT, TERM OR CONDITION OF ANY CONTRACT OR OTHER DOCUMENT WITH RESPECT TO WHICH THIS CERTIFICATE MAY BE ISSUED OR MAY PERTAIN, THE INSURANCE AFFORDED BY THE POLICIES DESCRIBED HEREIN IS SUBJECT TO ALL THE TERMS, EXCLUSIONS AND CONDITIONS OF SUCH POLICIES. AGGREGATE LIMITS SHOWN MAY HAVE BEEN REDUCED BY PAID CLAIMS.

INSR ADD'L LTR	TYPE OF INSURANCE	POLICY NUMBER	POLICY EFFECTIVE DATE (MM/DD/YYYY)	POLICY EXPIRATION DATE (MM/DD/YYYY)	LIMITS	
A	GENERAL LIABILITY <input checked="" type="checkbox"/> COM... <input type="checkbox"/> CLAIMS MADE <input checked="" type="checkbox"/> OCCUR	MPB55580	05/28/2005	05/28/2006	EACH OCCURRENCE	\$ 1,000,000
	DAMAGE TO RENTED PREMISES (Ea occurrence)				\$ 500,000	
					MED EXP (Any one person)	\$ 10,000
					PERSONAL & ADV INJURY	\$ 1,000,000
					GENERAL AGGREGATE	\$ 2,000,000
					PRODUCTS - COMP/OP AGG	\$ 2,000,000
A	AUTOMOBILE LIABILITY <input checked="" type="checkbox"/> ANY AUTO	BIB55580	05/28/2005	05/28/2006	COMBINED SINGLE LIMIT (Ea accident)	\$ 1,000,000
					BODILY INJURY (Per person)	\$
					BODILY INJURY (Per accident)	\$
					PROPERTY DAMAGE (Per accident)	\$
	GARAGE LIABILITY <input type="checkbox"/> ANY AUTO				AUTO ONLY - EA ACCIDENT	\$
					OTHER THAN AUTO ONLY: EA ACC	\$
					AGG	\$
	EXCESS/UMBRELLA LIABILITY <input type="checkbox"/> OCCUR <input type="checkbox"/> CLAIMS MADE				EACH OCCURRENCE	\$
					AGGREGATE	\$
						\$
						\$
B	WORKERS COMPENSATION AND EMPLOYERS' LIABILITY ANY PROPRIETOR/PARTNER/EXECUTIVE OFFICER/MEMBER EXCLUDED? If yes, describe under SPECIAL PROVISIONS below	1810073757	05/27/2005	05/27/2006	WC STATUTORY LIMITS	OTHER
					E.L. EACH ACCIDENT	\$ 500,000
					E.L. DISEASE - EA EMPLOYEE	\$ 500,000
					E.L. DISEASE - POLICY LIMIT	\$ 500,000
	OTHER					

DESCRIPTION OF OPERATIONS / LOCATIONS / VEHICLES / EXCLUSIONS ADDED BY ENDORSEMENT / SPECIAL PROVISIONS
THE POLICY COVERAGE INDICATED BY THIS CERTIFICATE IS SUBJECT TO POLICY

AS RESPECTS OPERATIONS USUAL TO INSURED'S BUSINESS.

CITY OF PORTLAND NAMED AS ADDITIONAL INSURED FOR GENERAL LIABILITY COVERAGE ONLY

RE: PLACEMENT OF SIGN

CITY OF PORTLAND
P.O. BOX 544
PORTLAND, ME 04112

SHOULD ANY OF THE ABOVE DESCRIBED POLICIES BE CANCELLED BEFORE THE EXPIRATION DATE THEREOF, THE ISSUING INSURER WILL ENDEAVOR TO MAIL 10 DAYS WRITTEN NOTICE TO THE CERTIFICATE HOLDER NAMED TO THE LEFT, BUT FAILURE TO MAIL SUCH NOTICE SHALL IMPOSE NO OBLIGATION OR LIABILITY OF ANY KIND UPON THE INSURER, ITS AGENTS OR REPRESENTATIVES.

AUTHORIZED REPRESENTATIVE
Nannette Wirth CISR