

PERMIT ISSUED

City of Portland, Maine - Building or Use Permit Application
389 Congress Street, 04101 Tel: (207) 874-8703, Fax: (207) 874-8716

Permit No: 03-0354	Issue Date: APR 18 2003	CBL: 275 I032001
-----------------------	-----------------------------------	---------------------

Location of Construction: 94 Dorset St	Owner Name: Buckley John &	Owner Address: 94 Dorset St CITY OF PORTLAND	Phone: 207-780-6321
Business Name:	Contractor Name:	Contractor Address:	Phone:
Lessee/Buyer's Name	Phone:	Permit Type: Sheds	Zone: R3

Past Use: single family	Proposed Use: single family - add 8' x 12' shed	Permit Fee: \$37.00	Cost of Work: \$1,750.00	CEO District: 3
----------------------------	--	------------------------	-----------------------------	--------------------

FIRE DEPT: <input type="checkbox"/> Approved <input checked="" type="checkbox"/> Denied N/A	INSPECTION: Use Group: U Type: SB BOCA 99
Signature:	Signature:

Proposed Project Description:
build 8' x 12' shed

PEDESTRIAN ACTIVITIES DISTRICT (P.A.D.)

Action: Approved Approved w/Conditions Denied

Signature: _____ Date: _____

Permit Taken By: gg	Date Applied For: 04/18/2003	Zoning Approval	
------------------------	---------------------------------	------------------------	--

- This permit application does not preclude the Applicant(s) from meeting applicable State and Federal Rules.
- Building permits do not include plumbing, septic or electrical work.
- Building permits are void if work is not started within six (6) months of the date of issuance. False information may invalidate a building permit and stop all work..

Special Zone or Reviews <input type="checkbox"/> Shoreland <input type="checkbox"/> Wetland <input checked="" type="checkbox"/> Flood Zone <input type="checkbox"/> Subdivision <input type="checkbox"/> Site Plan Maj <input type="checkbox"/> Minor <input type="checkbox"/> MM <input type="checkbox"/> Date: 4/18/03	Zoning Appeal <input type="checkbox"/> Variance <input type="checkbox"/> Miscellaneous <input type="checkbox"/> Conditional Use <input type="checkbox"/> Interpretation <input type="checkbox"/> Approved <input type="checkbox"/> Denied Date: _____	Historic Preservation <input checked="" type="checkbox"/> Not in District or Landmark <input type="checkbox"/> Does Not Require Review <input type="checkbox"/> Requires Review <input type="checkbox"/> Approved <input type="checkbox"/> Approved w/Conditions <input type="checkbox"/> Denied Date: 4/18/03
---	---	---

CERTIFICATION

I hereby certify that I am the owner of record of the named property, or that the proposed work is authorized by the owner of record and that I have been authorized by the owner to make this application as his authorized agent and I agree to conform to all applicable laws of this jurisdiction. In addition, if a permit for work described in the application is issued, I certify that the code official's authorized representative shall have the authority to enter all areas covered by such permit at any reasonable hour to enforce the provision of the code(s) applicable to such permit.

SIGNATURE OF APPLICANT	ADDRESS	DATE	PHONE
------------------------	---------	------	-------

RESPONSIBLE PERSON IN CHARGE OF WORK, TITLE	DATE	PHONE
---	------	-------

BUILDING PERMIT INSPECTION PROCEDURES

Please call 874-8703 or 874-8693 to schedule your inspections as agreed upon

Permits expire in 6 months, if the project is not started or ceases for 6 months.

The Owner or their designee is required to notify the inspections office for the following inspections and provide adequate notice. Notice must be called in 48-72 hours in advance in order to schedule an inspection:

By initializing at each inspection time, you are agreeing that you understand the inspection procedure and additional fees from a "Stop Work Order" and "Stop Work Order Release" will be incurred if the procedure is not followed as stated below.

_____ **Pre-construction Meeting:** Must be scheduled with your inspection team upon receipt of this permit. Jay Reynolds, Development Review Coordinator at 874-8632 must also be contacted at this time, before any site work begins on any project other than single family additions or alterations.

- Footing/Building Location Inspection:** Prior to pouring concrete
- _____ **Re-Bar Schedule Inspection:** Prior to pouring concrete
- _____ **Foundation Inspection:** Prior to placing ANY backfill
- Framing/Rough Plumbing/Electrical:** Prior to any insulating or drywalling
- _____ **Final/Certificate of Occupancy:** Prior to any occupancy of the structure or use. NOTE: There is a \$75.00 fee per inspection at this point.

Certificate of Occupancy is not required for certain projects. Your inspector can advise you if your project requires a Certificate of Occupancy. All projects DO require a final inspection

_____ **If any of the inspections do not occur, the project cannot go on to the next phase, REGARDLESS OF THE NOTICE OR CIRCUMSTANCES.**

_____ **CERIFICATE OF OCCUPANICES MUST BE ISSUED AND PAID FOR, BEFORE THE SPACE MAY BE OCCUPIED**

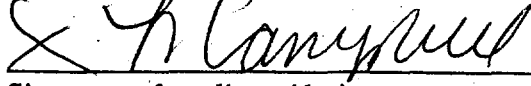

Signature of applicant/designee

Date
4/18/03



Signature of Inspections Official

Date

CBL: 215-I-032 Building Permit #: 03-0354

DISPLAY THIS CARD ON PRINCIPAL FRONTAGE OF WORK CITY OF PORTLAND

Please Read Application And Notes, If Any, Attached

BUILDING DEPARTMENT

PERMIT

Permit Number: 030354

This is to certify that Buckley John &
has permission to build 8' x 12' shed
AT 94 Dorset St 275 I032001

provided that the person or persons, firm or corporation accepting this permit shall comply with all of the provisions of the Statutes of Maine and of the ordinances of the City of Portland regulating the construction, maintenance and use of buildings and structures, and of the application on file in this department.

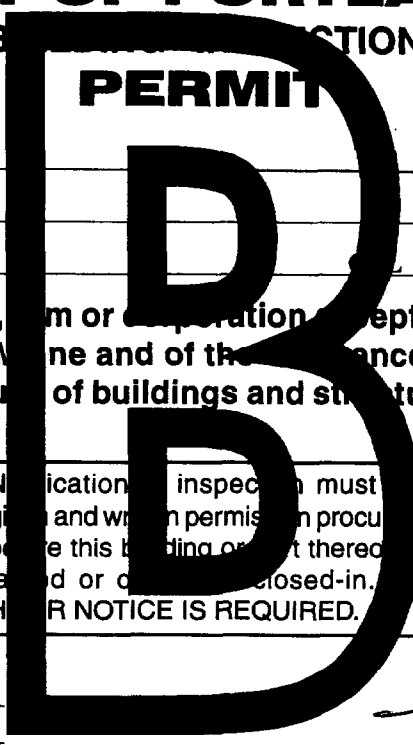

Apply to Public Works for street line and grade if nature of work requires such information.

Notification of inspection must be given and written permission procured before this building or part thereof is occupied or closed-in. **HEAVY NOTICE IS REQUIRED.**

A certificate of occupancy must be procured by owner before this building or part thereof is occupied.

OTHER REQUIRED APPROVALS

Fire Dept. PERMIT ISSUED
Health Dept. _____
Appeal Board _____
Other APR 18 2003
Department Name

Director - Building & Inspection Services

CITY OF PORTLAND

PENALTY FOR REMOVING THIS CARD



Residential Building Permit Application

If you or the property owner owes real estate or personal property taxes or user charges on any property within the City, payment arrangements must be made before permits of any kind are accepted.

Location/Address of Construction: <u>94 Dorset St</u>		
Total Square Footage of Proposed Structure <u>96</u>	Square Footage of Lot <u>6400</u>	
Tax Assessor's Chart, Block & Lot Chart# <u>275</u> Block# <u>I</u> Lot# <u>032</u>	Owner: <u>John Buckley/Launie Campbell</u>	Telephone: <u>780-6321</u>
Lessee/Buyer's Name (If Applicable) <u>N/A</u>	Applicant name, address & telephone: <u>Launie Campbell 94 Dorset St Portland</u>	Cost Of Work: \$ <u>1,750.00</u> Fee: \$
Current Specific use: <u>S I F</u>		
Proposed Specific use: <u>S I F</u>		
Project description: <u>Replace existing 8x10 shed with 8x12 shed</u>		
Contractor's name, address & telephone: <u>Sheds USA, 655 Portsmouth Avenue, Greenland NH (603) 616-2687</u>		
Who should we contact when the permit is ready: <u>Launie Campbell</u>		
Mailing address: <u>94 Dorset St Portland ME 04102</u>		Phone: <u>780-6321</u>

Please submit all of the information outlined in the Residential Application Checklist. Failure to do so will result in the automatic denial of your permit.

At the discretion of the Planning and Development Department, additional information may be required prior to permit approval. For further information stop by the Building Inspections office, room 315 City Hall or call 874-8703.

I hereby certify that I am the Owner of record of the named property, or that the owner of record authorizes the proposed work and that I have been authorized by the owner to make this application as his/her authorized agent. I agree to conform to all applicable laws of this jurisdiction. In addition, if a permit for work described in this application is issued, I certify that the Code Official's authorized representative shall have the authority to enter all areas covered by this permit at any reasonable hour to enforce the provisions of the codes applicable to this permit.

Signature of applicant: <u>[Signature]</u>	Date: <u>4.18.03</u>
--	----------------------

Permit Fee: \$30.00 for the first \$1000.00 Construction Cost, \$7.00 per additional \$1000.00 cost

This is not a Permit; you may not commence any work until the Permit is

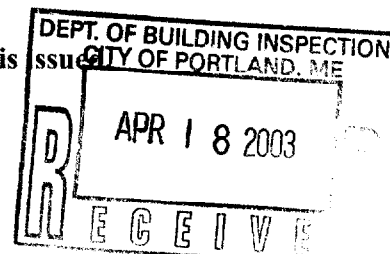

For Mortgage Lender Use Only

General Notes: (1) Distances shown are taken from provided title references shown below. (2) The purpose of this inspection is to render an opinion as follows: A) dwelling and accessory structure's compliance with respect to municipal zoning setbacks and B) flood zone determination by horizontal scaling on below referenced FEMA Map. (3) This inspection excepts out all technical standards as set forth by State of Maine Board of Licensure for Professional Land Surveyors. (4) This inspection is to be used only by the below listed lender, title attorney and title insurer and shall not be used by another party for boundary line locations or land title opinions. (5) A boundary survey should be performed to render a professional opinion pertaining to boundary line locations, easements, rights of way, encumbrances and/or encroachments.

Address: 94 Dorset Street
Portland, Maine

Inspection Date: May 14, 2001
Scale: 1" = 30'

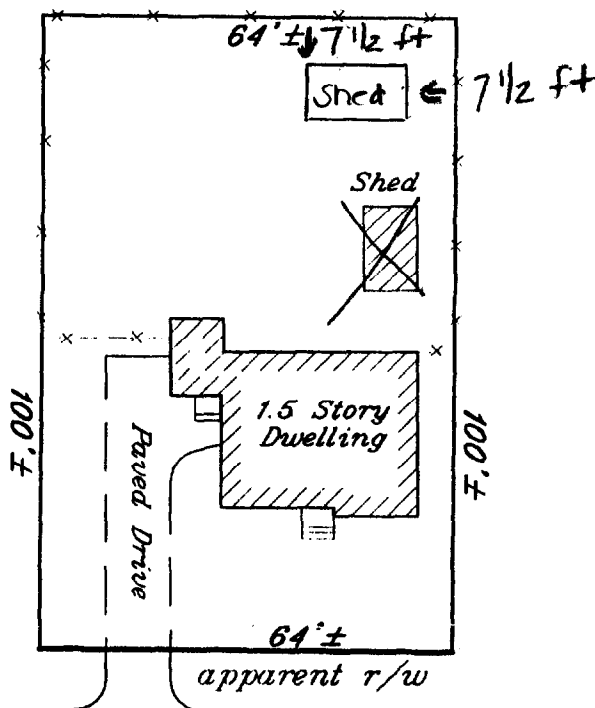
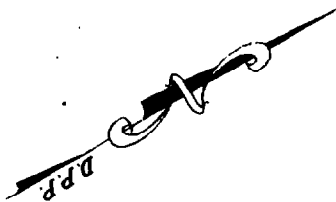

Dorset Street

Notes:

The dwelling pre-dates zoning setbacks.

Apparent lines of occupation are shown on this sketch.

A Boundary Survey is recommended for accurate location.

Applicant: John Buckley & Laurie Campbell Requesting Party: Cumb. Cty. Mortgage

Owner: Ann Marie & Timothy Bolduc Attorney: _____

Lender: Cumberland County Mortgage File No. 2019855 Field Book: 197-33

Title References:

Deed Book: 11249 Page: 100
Plan Book: 8 Page: 11 Lot: p/o
County: Cumberland

Municipal References:

Map: 275 Block: 1 Lot: 32 & 33

The dwelling does not fall within a Special Flood Hazard Zone Per Fema Community Map No. 230051
Panel: 0006C Zone: X Date: December 8, 1998

The dwelling was in compliance with municipal zoning setback requirements at the time of construction.

Comments: See above notes.

Nadeau & Lodge, Inc.
Professional Land Surveyors

844 Stevens Avenue
Portland, Maine 04103
Ph. (207)878-7870 Fax (207)878-7871

James P. Nadeau

This Is Not A Boundary Survey

Not For Recording

Built To Last

Sheds USA® stands out in both quality and service. Our sheds are built with your specifications in mind—all made with the finest quality material and backed up with our lifetime warranty. Unlike most shed companies, Sheds USA will deliver and assemble your shed for you, at no extra charge*. From gardening tools to art supplies to sporting equipment, we have a shed for your storage needs.

How To Order Your Shed

Sheds USA offers a uniquely flexible program for customizing a shed to both your individual budget and needs—and it's easy.

- A To choose a shed size and style, review Standard Sizes and Pricing to determine which size shed will fit your needs and budget. See Standard Features and Materials for more information about standard sheds.
- B Pick the roof style and shingle color.
- C Customize the placement of your doors & windows.
- D If you have specific requirements, see Options & Upgrades for details.
- E Read Site Requirements carefully.
- F Read our Delivery information carefully for certain requirements.
- G See a store associate to fill out the Sheds USA Order Form.

Standard Features & Materials

- 1/2" plywood
- 2"x4" construction, 24" on center
- Self-sealing shingles with 20-year warranty available in black, white/gray or brown
- 6' wide sheds available in peak roof only

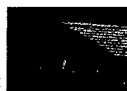

Peak



Extended Peak



Gambrel

- 6' wide peak = 8"
- 8' wide peak = 8' 3"
- 10' wide peak = 8' 11"
- 12' wide peak = 9' 6"
- 8' wide gambrel = 9"
- 10' wide gambrel = 9' 5"
- 12' wide gambrel = 9' 10"

- 2"x4" construction, 24" on center
- Shed Panel: pre-primed sheathing (vertical)
- Pine: 6" tongue & groove (horizontal)
- Cedar: 6" or 8" tongue & groove (horizontal)
- Wall height = 71"
- Vinyl siding applied over 1/2" plywood

- 5/8" plywood
- 2"x4" construction, 16" on center for 6' & 8' wide units
- 2"x6" construction, 16" on center for 10' & 12' wide units
- Concrete block supports—4 corners, front & back center of outside frame

If preparing your own foundation/footing, please call Sheds USA for exact outside floor dimensions.



Heavy Duty PT 2x4 or 2x6 Floor Construction

- All windows come with flower boxes and shutters
- 6x6, 6x8, 8x8, 8x10 and 10x10 units include one window—all others include two
- Wooden sheds come standard with functional windows.
- Vinyl sheds come standard with non-functional windows (functional windows available as an option)



Window (optional screen)

- 40" double door standard (6x6 sheds come with 26" single door standard)



Standard 40" Double Door

Delivery

- Sheds USA will acknowledge the receipt of your order by phone or by mail. Please provide a daytime phone number at time of purchase.
- Delivery schedule will be established by Sheds USA. You will be contacted by phone 1 to 2 weeks in advance.
- Delivery time will fluctuate based on seasonal volume, weather conditions, etc.
- Delivery date and installation date may differ.
- Rescheduling of the delivery/install date will only occur if Sheds USA is forced to so by events out of our control (weather concerns, illness, mechanical or other difficulties). Sheds USA crews deliver/install several sheds per day; therefore the status of one customer's order affects many others. To provide the best service for all of our customers, once a delivery/install date has been agreed to and scheduled by the customer and Sheds USA, postponement or cancellation by the customer will result in a 20% restocking fee.

Sheds USA takes pride in its experienced staff of builders.

Most sheds are built within 3 hours of arrival—backed by our outstanding LIFETIME warranty.

207-885-9200
207-885-9604 FAX



SEAN CROWLEY

415 PAYNE RD.
SCARBOROUGH, ME 04074



LIFETIME

DELIVERED and BUILT ON SITE



8 x 14' vinyl shed shown, gambrel roof

MAINTENANCE-FREE

your shed is DELIVERED
and BUILT ON SITE,

Customize your shed...

VINYL

CEDAR

PINE

SHED PANEL

- Pleasant aroma naturally repels insects and resists rotting
- Ages beautifully
- Excellent base for stain and paint
- Very stable—resists warping and buckling.

- Vertical exterior sheathing
- Durable and economical
- Pre-primed surface makes an excellent base for paint
- Upgraded and improved (from Texture T-111)

Vinyl Colors



SIZES

- 6x6
- 8x8
- 8x12
- 8x16
- 10x12
- 10x16
- 10x20
- 12x14
- 12x18

6x6	\$1,179.00
8x8	\$1,379.00
8x12	\$1,829.00
8x16	\$2,339.00
10x12	\$2,279.00
10x16	\$2,939.00
10x20	\$3,635.00
12x14	\$2,999.00
12x18	\$3,749.00

6x6	\$ 895.00
8x8	\$ 999.00
8x12	\$1,469.00
8x16	\$1,999.00
10x12	\$1,889.00
10x16	\$2,375.00
10x20	\$2,899.00
12x14	\$2,399.00
12x18	\$3,049.00

Sizes, Pricing and Siding Options

Note: Shed sizes are approximate. Exact measurements for placement of door(s) and window(s) will not be honored.

Standard Program Custom Design Options

- Door & Window Layouts (Positioning)
- Roof Style (Gambrel, Peak, Extended Peak)
- Shingle Color (Black, white/gray, brown)
- Several Siding Options (See above chart for samples)

- Options & Upgrades (Window Screens, Ramps, Door Enlargements, and more)

Note: Options and upgrades are an additional cost to the standard pricing.

DELIVERED and BUILT ON SITE, FREE OF CHARGE*

LIFETIME WARRANTY

Payment?

Options & Upgrades

Note: Options and upgrades are an additional cost to the standard pricing.

Pressure treated plywood floor	\$ 1.20/sq ft
2"x6" floor joists upgrade for 6'x8' wide units (upgraded joists are pressure treated)	\$.92/sq ft

6x6	\$ 25.00	10x14	\$ 70.00
8x8	\$ 30.00	10x16	\$ 75.00
8x12	\$ 40.00	10x18	\$ 100.00
8x16	\$ 50.00	12x12	\$ 76.00
10x12	\$ 60.00	12x16	\$ 100.00
		12x20	\$ 150.00

Note: Larger door sizes may not fit on all shed walls.

Size	Wood Price	Vinyl Price
Exchange standard 40" double door for 54"	\$ 50.00	\$ 79.00
Exchange standard 40" double door for 66"	\$ 95.00	\$ 99.00
Exchange standard 40" double door for 78"	\$ 125.00	\$ 129.00
6x6 shed size only		
Exchange 26" single door for 40" double door	\$ 40.00	\$ 60.00

Item	Wood Price	Vinyl Price
4' pressure-treated ramp	FREE	FREE
Additional 26" single door	\$ 79.00	\$ 99.00
Additional 40" double door	\$ 108.00	\$ 149.00
Additional 54" double door	\$ 120.00	\$ 179.00
Additional 66" double door	\$ 150.00	\$ 199.00
Additional 78" double door	\$ 160.00	\$ 229.00
Additional window (includes flower box and shutters)	\$ 60.00	\$ 69.00
Vinyl shed window upgrade (functional)	n/a	\$ 49.00
Window screen (each)	\$ 15.00	\$ 15.00
Aluminum gable vents (pair)	\$ 30.00	\$ 30.00
12" x 8' Shelf	\$ 45.00	\$ 45.00
4' storage loft for 8' wide sheds	\$ 65.00	\$ 65.00
4' storage loft for 10' wide sheds	\$ 80.00	\$ 80.00
4' storage loft for 12' wide sheds (loft storage space will vary with roof style)	\$ 95.00	\$ 95.00

Site Requirements

- **Clearance** Shed site needs to be located at least 3' from any fences, trees, etc. Please remove tree branches, brush or other obstacles 3' around perimeter of shed and 12' above ground.
- **Land Grade** Must be less than 6" slope from highest to lowest point, with no protruding rocks or stumps in the area.
- **Access** Shed is delivered in prefab panels; clear access to site is necessary—stairs, narrow walkways, fences, gates, shrubs, carports, awnings, arbors, etc. may present difficulties and should be brought to the attention of Sheds USA prior to delivery.
- **Land Quality** Consider all factors when choosing your site, including proper drainage, firmness of earth, etc.
- **Permits** are the sole responsibility of the homeowner. Please contact your local town office soon after ordering your shed to determine any restrictions or setback requirements.
- **Shed site** must be 150' or less from where a large tractor-trailer can park. Shed sites 150' - 300' from truck parking area will incur a \$50.00 fee payable to the delivery crew. If your site is farther than 300' please contact our main office.

The above site requirements allow us to build a safe, sturdy shed for our customers. If any of these requirements are not met, your shed may not be built and a fee of \$150.00 will be charged for our crew to return and construct your shed once conditions are met. If this occurs, delivery of your shed materials must be completed and placed on your property, in a location accessible to the final shed site to avoid a 20% re-delivery fee. It is the customers responsibility to cover the materials with a non-transparent, waterproof material to prevent unnecessary weathering and or discoloration. All fees are due at time of notification.