

# DISPLAY THIS CARD ON PRINCIPAL FRONTAGE OF WORK CITY OF PORTLAND

BU **INSPECTION**

## PERMIT

Permit Number: 090295

Please Read  
Application And  
Notes, If Any,  
Attached

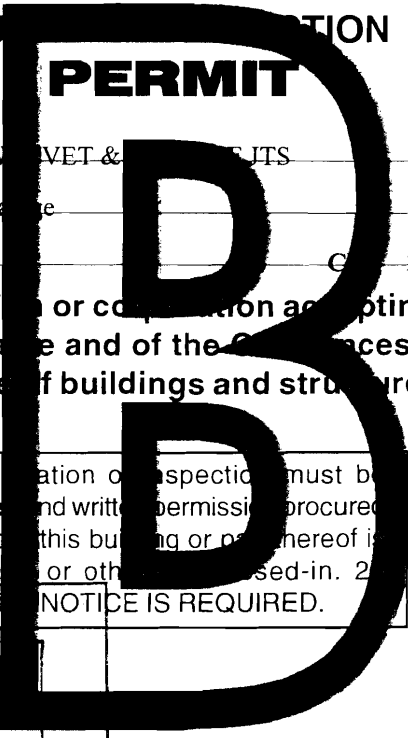

This is to certify that WEATHERBEE JOHN R WILSON VET & ASSOCIATES

has permission to install a 4' x 8' Shed next to Garage

AT 108 DORSET ST Call 275 1027001

provided that the person or persons, firm or corporation accepting this permit shall comply with all of the provisions of the Statutes of Maine and of the Ordinances of the City of Portland regulating the construction, maintenance and use of buildings and structures, and of the application on file in this department.

Apply to Public Works for street line and grade if nature of work requires such information.

Notification of inspection must be given and written permission procured before this building or part thereof is lathed or otherwise closed-in. 24 HOUR NOTICE IS REQUIRED.

A certificate of occupancy must be procured by owner before this building or part thereof is occupied.

PERMIT ISSUED

APR 10 2009

CITY OF PORTLAND

**OTHER REQUIRED APPROVALS**

Fire Dept. \_\_\_\_\_  
Health Dept. \_\_\_\_\_  
Appeal Board \_\_\_\_\_  
Other \_\_\_\_\_

Department Name

*Cheryl L. Park* 4/10/09  
Director - Building & Inspection Services

**PENALTY FOR REMOVING THIS CARD**

**City of Portland, Maine - Building or Use Permit Application**

389 Congress Street, 04101 Tel: (207) 874-8703, Fax: (207) 874-8716

Permit No: 09-0295	Issue Date: 4/10/09	CBL: 275 1027001
-----------------------	------------------------	---------------------

Location of Construction: 108 DORSET ST	Owner Name: WEATHERBEE JOHN R WWII V	Owner Address: 108 DORSET ST	Phone:
Business Name:	Contractor Name:	Contractor Address:	Phone
Lessee/Buyer's Name	Phone:	Permit Type: Sheds	Zone:

Past Use: single Family Home	Proposed Use: Single Family Home - install a 4' x 8' Shed next to Garage	Permit Fee: \$30.00	Cost of Work: \$200.00	CEO District: 3
		FIRE DEPT: <input type="checkbox"/> Approved <input type="checkbox"/> Denied	INSPECTION: Use Group: R-3 Type: SB3 IRC-2003 Detached Shed	

Proposed Project Description: install a 4' x 8' Shed next to Garage	Signature:	Signature:
PEDESTRIAN ACTIVITIES DISTRICT (P.A.D.)		
Action: <input type="checkbox"/> Approved <input type="checkbox"/> Approved w/Conditions <input type="checkbox"/> Denied		
Signature:	Date:	

Permit Taken By: Ldobson	Date Applied For: 04/10/2009	<b>Zoning Approval</b>
-----------------------------	---------------------------------	------------------------

- This permit application does not preclude the Applicant(s) from meeting applicable State and Federal Rules.
- Building permits do not include plumbing, septic or electrical work.
- Building permits are void if work is not started within six (6) months of the date of issuance. False information may invalidate a building permit and stop all work..

Special Zone or Reviews	Zoning Appeal	Historic Preservation
<input type="checkbox"/> Shoreland <input type="checkbox"/> Wetland <input type="checkbox"/> Flood Zone <input type="checkbox"/> Subdivision <input type="checkbox"/> Site Plan Maj <input type="checkbox"/> Minor <input type="checkbox"/> MM <input type="checkbox"/>	<input type="checkbox"/> Variance <input type="checkbox"/> Miscellaneous <input type="checkbox"/> Conditional Use <input type="checkbox"/> Interpretation <input type="checkbox"/> Approved <input type="checkbox"/> Denied	<input type="checkbox"/> Not in District or Landmark <input checked="" type="checkbox"/> Does Not Require Review <input type="checkbox"/> Requires Review <input type="checkbox"/> Approved <input type="checkbox"/> Approved w/Conditions <input type="checkbox"/> Denied
Date: 9/10/09	Date:	Date:

*5 min  
Setback  
OK.  
Detached  
Shed*

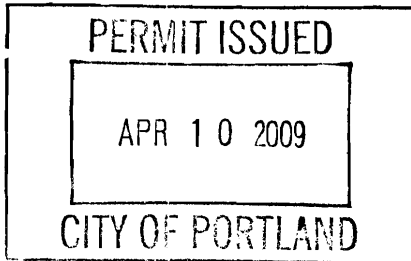

**CERTIFICATION**

I hereby certify that I am the owner of record of the named property, or that the proposed work is authorized by the owner of record and that I have been authorized by the owner to make this application as his authorized agent and I agree to conform to all applicable laws of this jurisdiction. In addition, if a permit for work described in the application is issued, I certify that the code official's authorized representative shall have the authority to enter all areas covered by such permit at any reasonable hour to enforce the provision of the code(s) applicable to such permit.

SIGNATURE OF APPLICANT	ADDRESS	DATE	PHONE
RESPONSIBLE PERSON IN CHARGE OF WORK, TITLE		DATE	PHONE

**City of Portland, Maine - Building or Use Permit**

389 Congress Street, 04101 Tel: (207) 874-8703, Fax: (207) 874-8716

<b>Permit No:</b> 09-0295	<b>Date Applied For:</b> 04/10/2009	<b>CBL:</b> 275 I027001
------------------------------	--	----------------------------

<b>Location of Construction:</b> 108 DORSET ST	<b>Owner Name:</b> WEATHERBEE JOHN R WWII V	<b>Owner Address:</b> 108 DORSET ST	<b>Phone:</b>
<b>Business Name:</b>	<b>Contractor Name:</b>	<b>Contractor Address:</b>	<b>Phone:</b>
<b>Lessee/Buyer's Name</b>	<b>Phone:</b>	<b>Permit Type:</b> Sheds	

<b>Proposed Use:</b> Single Family Home - install a 4' x 8' Shed next to Garage	<b>Proposed Project Description:</b> install a 4' x 8' Shed next to Garage
--	---

**Dept:** Zoning      **Status:** Approved with Conditions      **Reviewer:** Chris Hanson      **Approval Date:** 04/10/2009

**Note:** **Ok to Issue:**

- 1) Shed may not be attached to garage.

**Dept:** Building      **Status:** Approved with Conditions      **Reviewer:** Chris Hanson      **Approval Date:** 04/10/2009

**Note:** **Ok to Issue:**

- 1) Shed must be min.of 5' from property line.
- 2) This structure is exempt from meeting the City of Portland Building Code based on size.
- 3) Application approval based upon information provided by applicant. Any deviation from approved plans requires separate review and approval prior to work.



# General Building Permit Application

If you or the property owner owes real estate or personal property taxes or user charges on any property within the City, payment arrangements must be made before permits of any kind are accepted.

Location/Address of Construction: <u>108 Dorset St</u>		
Total Square Footage of Proposed Structure/Area <u>34 sq ft</u>	Square Footage of Lot <u>8000</u>	Number of Stories <u>1</u>
Tax Assessor's Chart, Block & Lot Chart# <u>975</u> Block# <u>I</u> Lot# <u>27</u>	Applicant * <b>must be owner, Lessee or Buyer</b> * Name <u>John Weatherbee</u> Address <u>108 Dorset St</u> City, State & Zip <u>Portland Me 04102</u>	Telephone: <u>207-774-0578</u>
Lessee/DBA (If Applicable)	Owner (if different from Applicant) Name <u>Same</u> Address City, State & Zip	Cost Of Work: \$ <u>200-300</u> C of O Fee: \$ _____ Total Fee: \$ <u>30</u>
Current legal use (i.e. single family) <u>Single Family</u> Number of Residential Units <u>1</u> If vacant, what was the previous use? _____ Proposed Specific use: _____ Is property part of a subdivision? <u>No</u> If yes, please name _____ Project description: <u>Simple Family Home 4x8 Shed</u>		
Contractor's name: <u>John Weatherbee</u> Address: <u>108 Dorset St</u> City, State & Zip <u>Portland Me 04102</u> Telephone: <u>207 774 0578</u> Who should we contact when the permit is ready: <u>Same</u> Telephone: <u>300,110</u> Mailing address: <u>Same</u>		

**Please submit all of the information outlined on the applicable Checklist. Failure to do so will result in the automatic denial of your permit.**

In order to be sure the City fully understands the full scope of the project, the Planning and Development Department may request additional information prior to the issuance of a permit. For further information or to download copies of this form and other applications visit the Inspections Division on-line at [www.portlandmaine.gov](http://www.portlandmaine.gov), or stop by the Inspections Division office, room 315 City Hall or call 874-8703.

I hereby certify that I am the Owner of record of the named property, or that the owner of record authorizes the proposed work and that I have been authorized by the owner to make this application as his/her authorized agent. I agree to conform to all applicable laws of this jurisdiction. In addition, if a permit for work described in this application is issued, I certify that the Code Official's authorized representative shall have the authority to enter all areas covered by this permit at any reasonable hour to enforce the provisions of the codes applicable to this permit.

Signature: John Weatherbee Date: 4/9/09

**This is not a permit; you may not commence ANY work until the permit is issue**

20' 20' 20'

# WEATHER REPORT AT 109 JORDON ST

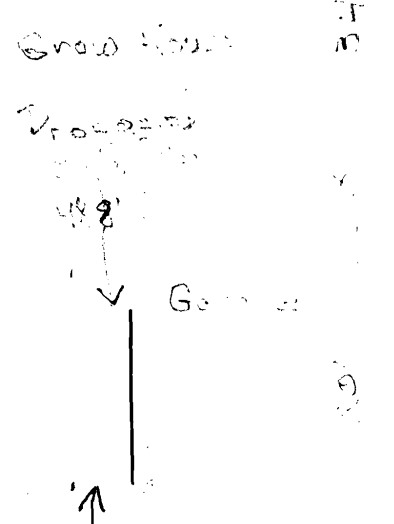

1955 in 1955 in 1955

Detached shed

King's 12th House

1216'

1955 in 1955 in 1955

50'

1955 in 1955 in 1955

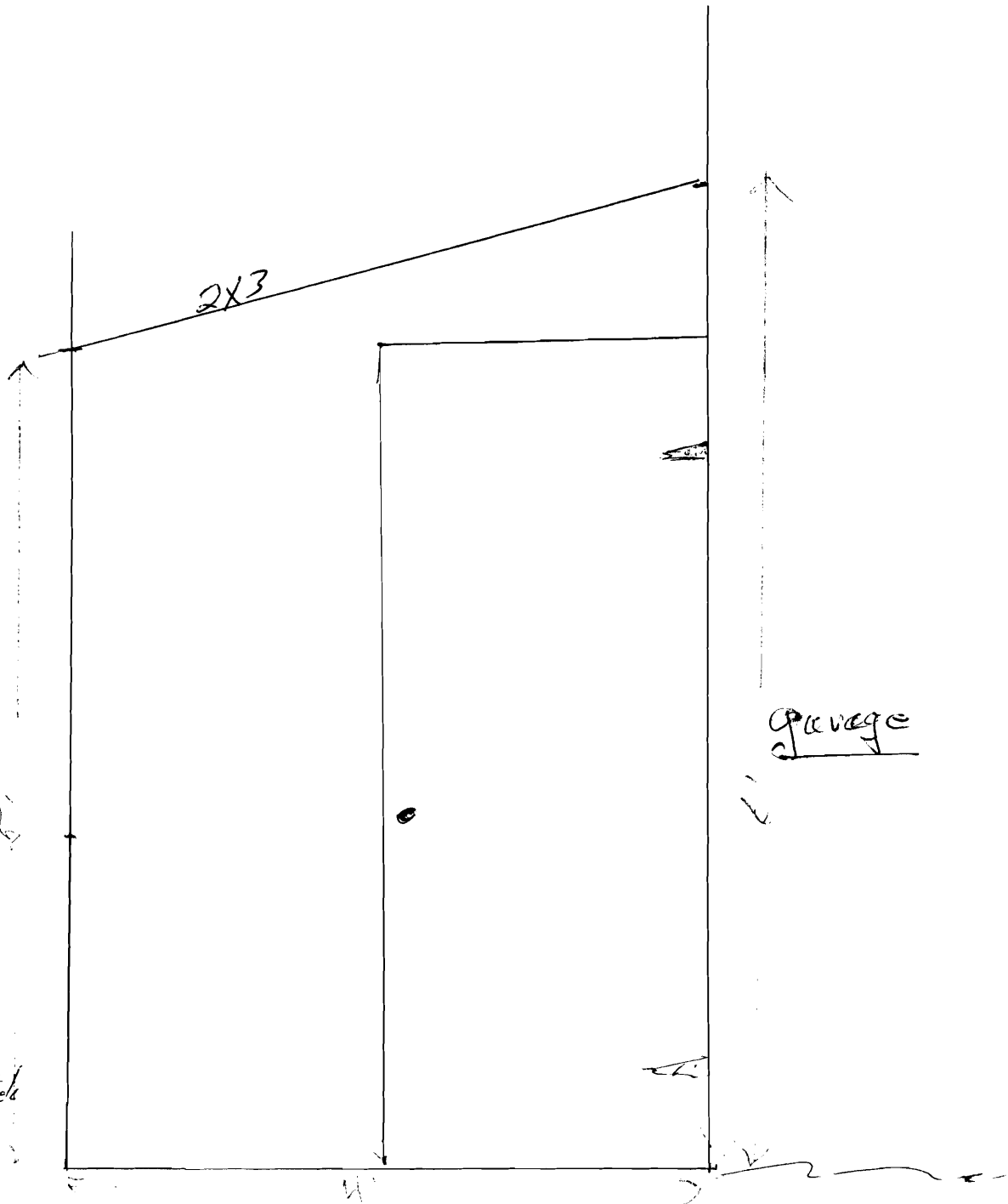

2x4 framing  
20 plywood  
siding  
with 2x8 treated  
wood base

Side

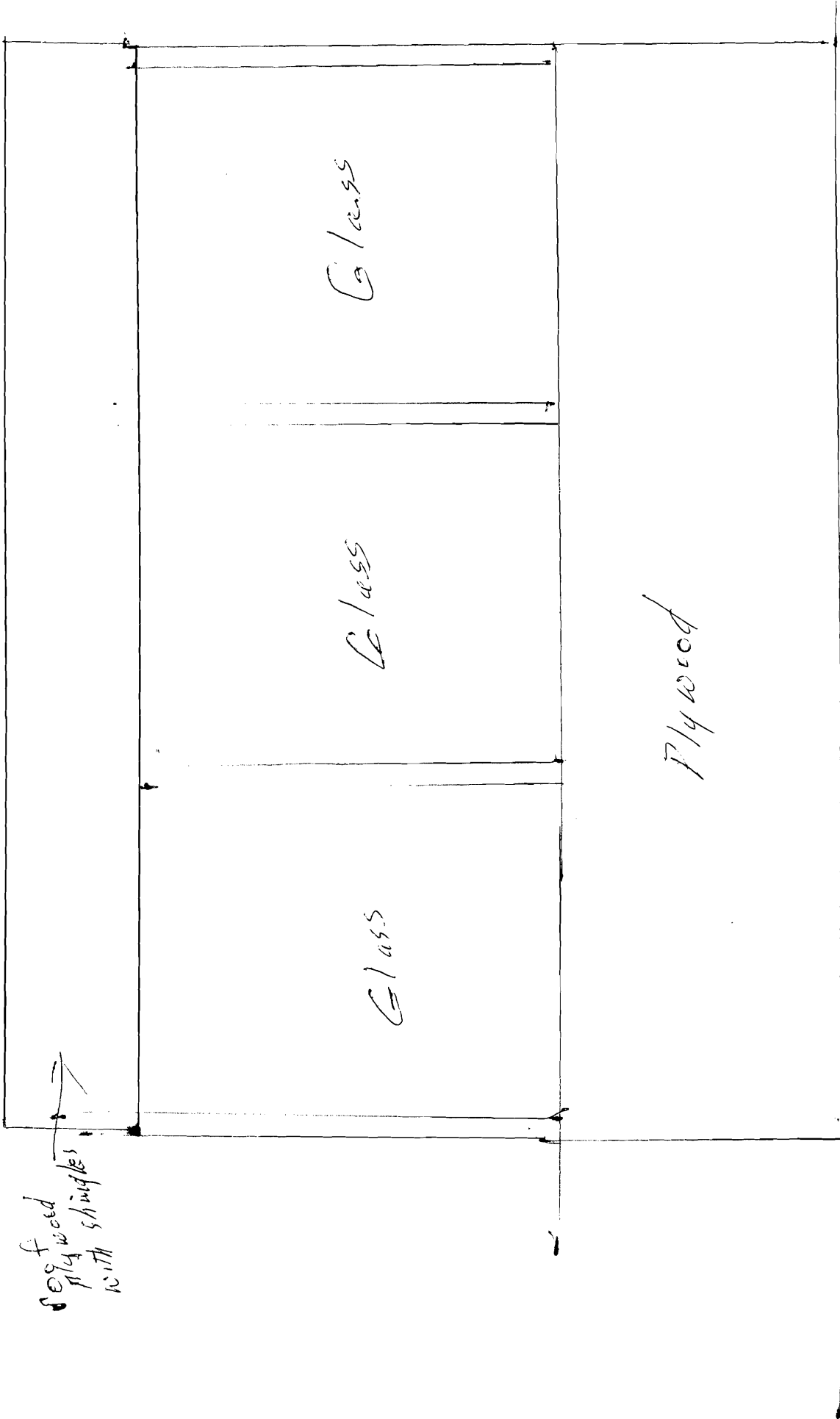

2x4 front frame  
 sets on 2x8 treated wood  
 Front

**BUILDING PERMIT INSPECTION PROCEDURES**

**Please call 874-8703 or 874-8693 (ONLY)**

**to schedule your inspections as agreed upon**

**Permits expire in 6 months, if the project is not started or ceases for 6 months.**

The Owner or their designee is required to notify the inspections office for the following inspections and provide adequate notice. Notice must be called in 48-72 hours in advance in order to schedule an inspection:

**By initializing at each inspection time, you are agreeing that you understand the inspection procedure and additional fees from a "Stop Work Order" and "Stop Work Order Release" will be incurred if the procedure is not followed as stated below.**

**A Pre-construction Meeting will take place upon receipt of your building permit.**

  X   **Final inspection required at completion of work.**

Certificate of Occupancy is not required for certain projects. Your inspector can advise you if your project requires a Certificate of Occupancy. All projects DO require a final inspection.

**If any of the inspections do not occur, the project cannot go on to the next phase, REGARDLESS OF THE NOTICE OR CIRCUMSTANCES.**

**CERIFICATE OF OCCUPANICES MUST BE ISSUED AND PAID FOR, BEFORE THE SPACE MAY BE OCCUPIED.**

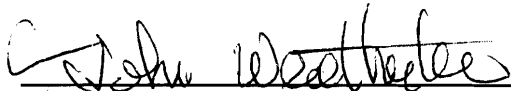

Signature of Applicant/Designee

\_\_\_\_\_

Date

\_\_\_\_\_

Signature of Inspections Official

\_\_\_\_\_

Date