

DRIVE-THRU SIGN CONTROL DIAGRAM
 SCALE: NONE
 (TYPICAL OF TWO SIGNS)

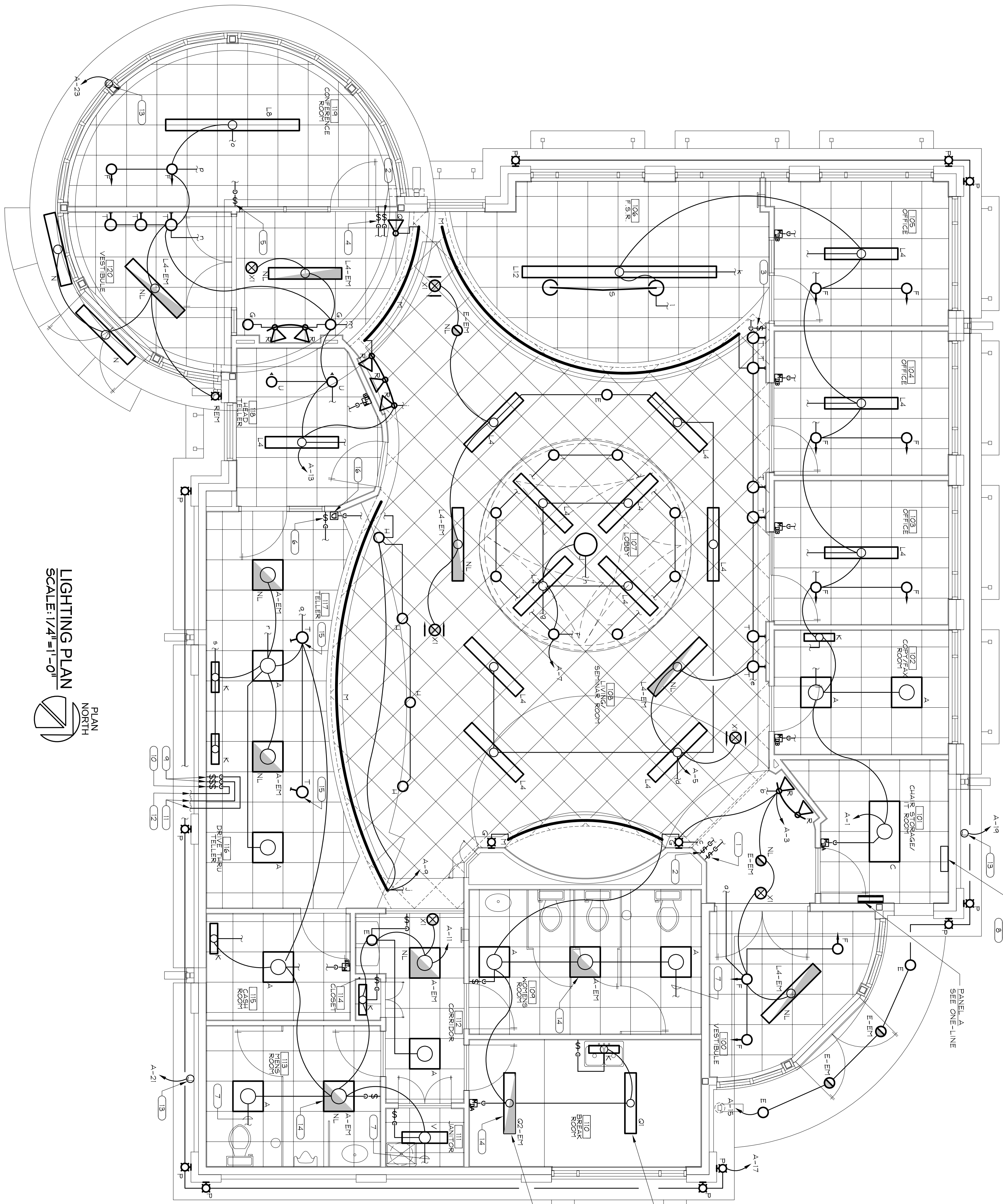

LIGHTING PLAN
 SCALE: 1/4" = 1'-0"
 PLAN NORTH

GENERAL NOTES

- UNLESS OTHERWISE NOTED, CONNECT NIGHT LIGHTS (FIXTURES MARKED "NL") EXIT SIGNS, AND EMERGENCY BATTERY PACKS OF ALL SHADED FIXTURES TO LOCAL LIGHTING CIRCUIT AHEAD OF ALL SWITCHING.
- COORDINATE AND SCHEDULE ALL WORK WITH OTHER TRADES AND OWNER.
- ALL ELECTRICAL INSTALLATIONS SHALL COMPLY WITH LOCAL AND STATE CODES.
- NOTE THAT FIXTURE DESIGNATIONS, LOCATIONS, ETC., ARE FROM ARCHITECTURAL AND LIGHTING CONSULTANT'S DRAWINGS. VERIFY ALL COORDINATE AND INSTALLATION PROVIDED INCLUDING ACCESSORIES REQUIRED FOR COMPLETE INSTALLATIONS PER PROJECT REQUIREMENTS.
- UNLESS NOTED OTHERWISE, ALL LIGHTING CIRCUITS SHOWN ON THIS PLAN SHALL BE CONNECTED TO THEIR RESPECTIVE CIRCUITS THROUGH RELAY PANEL RPI.
- REPRESENTS OCCUPANCY SENSOR, LEVITON MODEL # 00915-1D1 WITH RECOMMENDATIONS.
- REPRESENTS OCCUPANCY SENSOR, LEVITON MODEL # 00905-1D1 WITH 2 OVERRIDE BUTTONS FOR TWO LIGHTING CIRCUITS SHOWN IN SPACE. CONNECT TO FIXTURES PER MANUFACTURER'S RECOMMENDATIONS.
- DEVICES SHALL NOT BE INSTALLED BACK-TO-BACK IN ADJACENT ROOMS. ADJUST LOCATIONS AS NECESSARY TO AVOID THIS CONDITION.
- UNLESS NOTED OTHERWISE, CIRCUITS SERVING BUILDING SIGNS, EXTERIOR LIGHTS, RELAY PANEL RPI, LIGHT SCHEDULES, CONTROLLED TO-DAYN ILLUMINATION, COORDINATE PROGRAMMING SCHEDULE WITH OWNER.
- PROVIDE CUSTOM LABELING ON ALL MULTIPLE-CIRCUIT DIGITAL SWITCHES FOR IDENTIFICATION OF LIGHT FIXTURES CONTROLLED BY THE SWITCHES.
- RUN (2) #10 AND (1) #10 GROUND IN 3/4" CONDUIT FOR ALL EMERGENCY LIGHTING EXTERIOR LIGHTING, BUILDING SIGN, AND DRIVER-THRU CANOPY LIGHTING CIRCUITS.
- UNLESS NOTED OTHERWISE, SWITCHES SHOWN ON THIS PLAN SHALL BE PROGRAMMING FOR ON/OFF OVERRIDE SWITCHING OF LIGHTING FIXTURE(S) AS SHOWN.

CODED NOTES

- PROVIDE 2-BUTTON LOW VOLTAGE SWITCH, LEVITON MODEL # LVS-02M CIRCUITS LABELED "A" AND "B". (ONE BUTTON PER CIRCUIT.)
- PROVIDE 2-BUTTON LOW VOLTAGE SWITCH, LEVITON MODEL # LVS-02M CIRCUITS LABELED "M" AND "N". (ONE BUTTON PER CIRCUIT.)
- PROVIDE 4-BUTTON LOW VOLTAGE SWITCH, LEVITON MODEL # LVS-04M CIRCUITS LABELED "A", "B", "C", AND "D". (ONE BUTTON PER CIRCUIT.)
- PROVIDE 3-BUTTON LOW VOLTAGE SWITCH, LEVITON MODEL # LVS-03M CIRCUITS LABELED "A", "B", AND "C". (ONE BUTTON PER CIRCUIT.)
- EXTEND CIRCUITRY TO EXHAUST FAN SERVING THIS SPACE. LIGHTS AND FAN SHALL BE SWITCHED TOGETHER. SEE SHEET E21. COORDINATE WITH HVAC CONTRACTOR.
- RELAY PANEL RPI SHALL BE LEVITON Z-MAX TYPE R8BD-136, WITH INTEGRATED ASTRONOMIC TIME CLOCK AND (24) SINGLE-POLE RELAYS COMPLETELY INSTALLED. FULLY FUNCTIONAL LIGHTING CONTROL SYSTEM PER MANUFACTURER'S RECOMMENDATIONS AND SPECIFICATIONS. PROVIDE ADDITIONAL (3) TWO-POLE RELAYS IN RPI.
- PROVIDE 3-POSITION (OPEN/OFF/CLOSED) DRIVE-THRU LANE SWITCH FOR CONTROL OF DRIVE-THRU LANE SIGN. SWITCH SHALL BE SIGNAL-TECH MODEL # SG. INSTALL PER MANUFACTURER'S RECOMMENDATIONS AND SPECIFICATIONS. SEE LOCATION OF SIGNS ON ENLARGED DRIVER-THRU LIGHTING PLAN ON SHEET E01. COORDINATE WITH SIGN INSTALLER.
- PROVIDE TOGGLE SWITCH TO CONTROL ATM LANE SIGN. SEE LOCATION OF ATM SIGN ON ENLARGED DRIVER-THRU LIGHTING PLAN ON SHEET E01. COORDINATE WITH SIGN INSTALLER.
- EXTEND SWITCHING TO DRIVE-THRU LANE SIGNS. SEE SHEET E01 FOR SIGN LOCATIONS.
- EXTEND SWITCHING TO ATM SIGN. SEE SHEET E01 FOR SIGN LOCATION.
- PROVIDE 120V CONNECTION TO ILLUMINATED BUILDING SIGN.
- COORDINATE WITH SIGN INSTALLER.
- PROVIDE FIXTURE WITH SWITCHED AND UNSWITCHED CIRCUIT. CONNECT UNSWITCHED CIRCUIT TO EMERGENCY BATTERY.
- FIXTURE INSTALLED ON MILKWORK BY G.C. COORDINATE IN FIELD. IP68-PLM, SWITCH TYPE "H" FIXTURES AS SHOWN.

brandpartners
 BrandPartners Group, Inc.
 10 Main Street
 Rochester, NH 03389
 Phone: 603.335.1400
 Fax: 603.335.1765

ENGINEER

SHREWSBURY ENGINEERING, INC.
 6130 S. Sumbury Road
 Waverille, OH 43081
 (614)545-4550 P
 (614)545-4555 F
 info@shrewnh.com
 www.shrewnh.com

TITLE PLAN
 SAI 07239

SCALE
 1/4" = 1'-0"

CLIENT
UNIVERSITY CREDIT UNION
 1071 BRIGHTON AVENUE
 PORTLAND, ME 04102

DATE

NO.	DATE	DESCRIPTION
1.	06/11/07	ISSUE DATE
2.		DRAWN BY: BAO
3.		CHECKED BY: RPP
4.		REVISION
5.		
6.		
7.		
8.		
9.		
10.		
11.		
12.		
13.		

E1.1