

UNIVERSITY CREDIT UNION

BRIGHTON AVENUE
PORTLAND, MAINE

APPLICANT:

UNIVERSITY CREDIT UNION
RANGELEY ROAD
UNIVERSITY OF MAINE
ORONO, MAINE 04469-5119

ENGINEER / SURVEYOR:

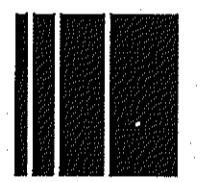

Sebago Technics
Engineering & Planning for the Future
ONE CHABOT STREET
WESTBROOK, ME 04098-1339
TEL (207) 856-0277

TRAFFIC ENGINEER:

WILBUR SMITH ASSOCIATES
59 MIDDLE STREET
PORTLAND, MAINE 04101

PROJECT ARCHITECT:

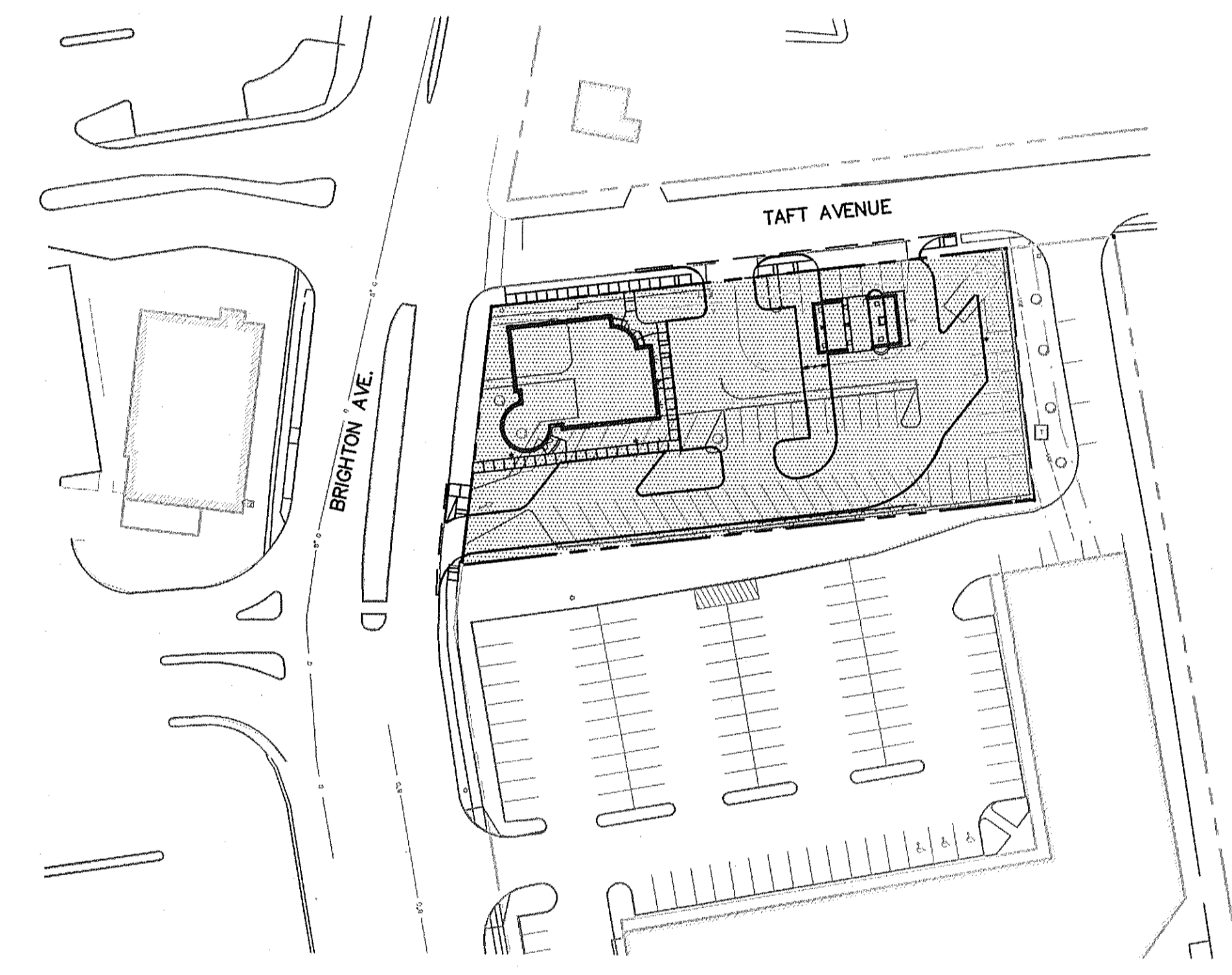
BRANDPARTNERS
10 MAIN STREET
ROCHESTER, NH 03839



SCALE: 1"=60'

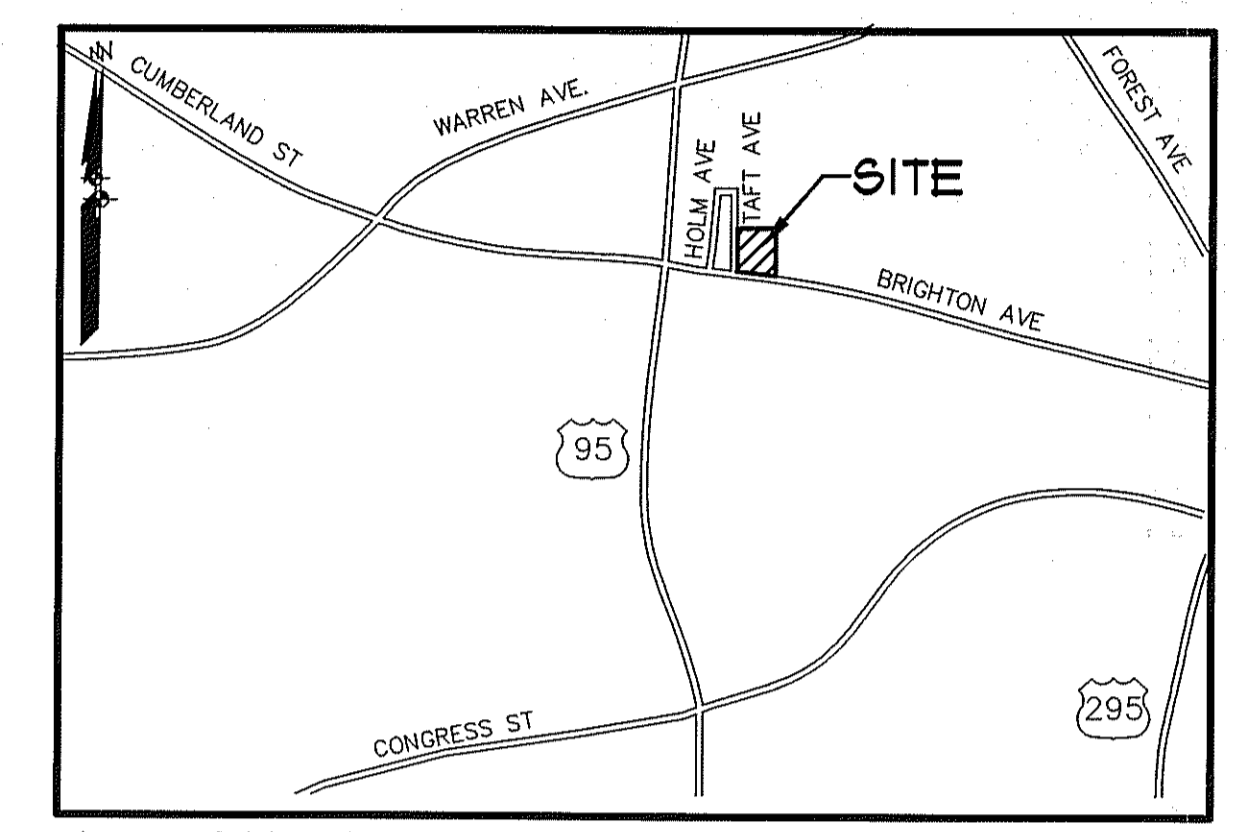

LOCATION MAP

N.T.S.

SHEET INDEX:

| SHEET | DESCRIPTION |
|-------|--------------------------|
| 1 | COVER SHEET |
| 2 | EXISTING CONDITIONS PLAN |
| 3 | SITE PLAN |
| 4 | GRADING & UTILITIES PLAN |
| 5 | LANDSCAPING PLAN |
| 6 | LIGHTING PLAN |
| 7 | DETAILS |
| 8 | DETAILS |