

DISPLAY THIS CARD ON PRINCIPAL FRONTAGE OF WORK



CITY OF PORTLAND BUILDING PERMIT

This is to certify that 1041 Brighton Ave. LLC

Located At 1041 BRIGHTON AVE

Job ID: 2011-10-2408-SIGN

CBL: 274- D-001-001

has permission to New Signage for Diamond and Gold Mine Outlet
provided that the person or persons, firm or corporation accepting this permit shall comply with all of the provisions of the Statues of Maine and of the Ordinances of the City of Portland regulating the construction, maintenance and use of the buildings and structures, and of the application on file in the department.

Notification of inspection and written permission procured before this building or part thereof is lathed or otherwise closed-in. 48 HOUR NOTICE IS REQUIRED.

A final inspection must be completed by owner before this building or part thereof is occupied. If a certificate of occupancy is required, it must be

Fire Prevention Officer

Code Enforcement Officer / Plan Reviewer

THIS CARD MUST BE POSTED ON THE STREET SIDE OF THE PROPERTY
PENALTY FOR REMOVING THIS CARD

BUILDING PERMIT INSPECTION PROCEDURES

Please call 874-8703 or 874-8693 (ONLY)

or email: buildinginspections@portlandmaine.gov

With the issuance of this permit, the owner, builder or their designee is required to provide adequate notice to the city of Portland Inspections Services for the following inspections. Appointments must be requested 48 to 72 hours in advance of the required inspection. The inspection date will need to be confirmed by this office.

- **Please read the conditions of approval that is attached to this permit!! Contact this office if you have any questions.**
- **Permits expire in 6 months. If the project is not started or ceases for 6 months.**
- **If the inspection requirements are not followed as stated below additional fees may be incurred due to the issuance of a "Stop Work Order" and subsequent release to continue.**



The project cannot move to the next phase prior to the required inspection and approval to continue, REGARDLESS OF THE NOTICE OF CIRCUMSTANCES.

IF THE PERMIT REQUIRES A CERTIFICATE OF OCCUPANCY, IT MUST BE PAID FOR AND ISSUED TO THE OWNER OR DESIGNEE BEFORE THE SPACE MAY BE OCCUPIED.

City of Portland, Maine - Building or Use Permit Application

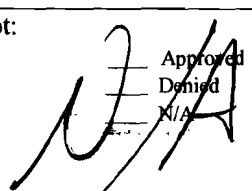
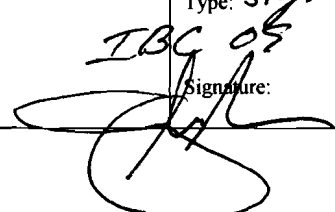
389 Congress Street, 04101 Tel: (207) 874-8703, FAX: (207) 8716

Job No: 2011-10-2408-SIGN	Date Applied: 10/4/2011	CBL: 274- D-001-001	
Location of Construction: 1041 BRIGHTON AVE – suite 8	Owner Name: 1041 BRIGHTON AVE., LLC	Owner Address: 1 CANAL PLAZA PORTLAND, ME 04101	Phone: 207-772-1333
Business Name: Diamond & Gold Mine Outlet	Contractor Name:	Contractor Address:	Phone:
Lessee/Buyer's Name: Mark Dube	Phone: 207-631-6444	Permit Type: SIGN - PERM - Signage - Permanent	Zone: B-2
Past Use: Change of Use permit to retail – 2011-10-2407	Proposed Use: Retail – “Diamond & Gold Mine Outlet” – install one panel in empty sign box on wall – 95” x 28” & replace panel in free standing sign – 94” x 21”	Cost of Work:	CEO District:
		Fire Dept: <input checked="" type="checkbox"/> Approved <input type="checkbox"/> Denied <input type="checkbox"/> N/A Signature: 	Inspection: Use Group: <input checked="" type="checkbox"/> Type: Sign Signature: 
Proposed Project Description: New Signage for Diamond and Gold Mine Outlet		Pedestrian Activities District (P.A.D.)	

Permit Taken By:	Zoning Approval		
<p>1. This permit application does not preclude the Applicant(s) from meeting applicable State and Federal Rules.</p> <p>2. Building Permits do not include plumbing, septic or electrical work.</p> <p>3. Building permits are void if work is not started within six (6) months of the date of issuance. False informatin may invalidate a building permit and stop all work.</p>	Special Zone or Reviews <input type="checkbox"/> Shoreland <input type="checkbox"/> Wetlands <input type="checkbox"/> Flood Zone <input type="checkbox"/> Subdivision <input type="checkbox"/> Site Plan <input type="checkbox"/> Maj <input type="checkbox"/> Min <input type="checkbox"/> MM Date: OK 10/14/11 	Zoning Appeal <input type="checkbox"/> Variance <input type="checkbox"/> Miscellaneous <input type="checkbox"/> Conditional Use <input type="checkbox"/> Interpretation <input type="checkbox"/> Approved <input type="checkbox"/> Denied Date:	Historic Preservation <input checked="" type="checkbox"/> Not in Dist or Landmark <input type="checkbox"/> Does not Require Review <input type="checkbox"/> Requires Review <input type="checkbox"/> Approved <input type="checkbox"/> Approved w/Conditions <input type="checkbox"/> Denied Date: 
	CERTIFICATION		

I hereby certify that I am the owner of record of the named property, or that the proposed work is authorized by the owner of record and that I have been authorized by the owner to make this application as his authorized agent and I agree to conform to all applicable laws of this jurisdiction. In addition, if a permit for work described in the appication is issued, I certify that the code official's authorized representative shall have the authority to enter all areas covered by such permit at any reasonable hour to enforce the provision of the code(s) applicable to such permit.

SIGNATURE OF APPLICANT	ADDRESS	DATE	PHONE
RESPONSIBLE PERSON IN CHARGE OF WORK, TITLE		DATE	PHONE



CITY OF PORTLAND, MAINE

Department of Building Inspections

Original Receipt

10.4.2011

Received from

The Diamond Gold-

Location of Work

1041 Brighton

Cost of Construction

\$ _____

Building Fee:

10530

Permit Fee

\$ _____

Sign

Site Fee:

96-

Certificate of Occupancy Fee:

75

Total:

Building (IL)

Plumbing (IS)

Electrical (I2)

Site Plan (U2)

Other _____

CBL:

274.D-1

Check #:

2991

Total Collected \$

201

**No work is to be started until permit issued.
Please keep original receipt for your records.**

Taken by:

[Signature]

WHITE - Applicant's Copy
YELLOW - Office Copy
PINK - Permit Copy



B-2

2011-10-24 09

Signage/Awning Permit Application

If you or the property owner owes real estate or personal property taxes or user charges on any property within the City, payment arrangements must be made before permits of any kind are accepted.

Location/Address of Construction: <u>1041 Brighton Ave #8 Portland 04102</u>		
Tax Assessor's Chart, Block & Lot Chart# <u>274</u> Block# <u>D</u> Lot# <u>1</u>	Owner: <u>CBRE - The Boulos Co.</u> <u>Joe Porta - Broker</u> <u>772-1333</u>	Telephone: <u>B-772-1333</u> <u>C-</u>
Lessee/Buyer's Name (If Applicable) <u>Diamond & Gold Mine Outlet</u> <u>Mark A Dube</u>	Contractor name, address & telephone: <u>Using existing wall sign</u> <u>on building & freestanding</u> <u>sign</u>	Total s.f. of signage x \$2.00 Per s.f. plus \$30.00 For H.D. signage \$75.00 Fee: \$ _____ Awning Fee = cost of work <input checked="" type="checkbox"/> Total Fee: \$ _____

Who should we contact when the permit is ready: Mark Dube phone: 631-6444

Tenant/allocated building space frontage (feet): Length: 15.5' Height: 8'
Lot Frontage (feet) 15.5' Single Tenant or Multi Tenant Lot Multi

Current Specific use: Vacant
If vacant, what was prior use: Jackson Hewitt Tax preparer
Proposed Use: Jewelry Store

Information on proposed sign(s):
Freestanding (e.g., pole) sign? Yes No Dimensions proposed: _____ Height from grade: _____
Bldg. wall sign? (attached to bldg) Yes No Dimensions proposed: _____

Proposed awning? Yes No Is awning backlit? Yes No
Height of awning: _____ Length of awning: _____ Depth: _____
Is there any communication, message, trademark or symbol on it? Yes No
If yes, total s.f. of panels w/communications, message, trademark or symbol: _____ s.f.

* Information on existing and previously permitted sign(s):
Freestanding (e.g., pole) sign? Yes No Dimensions: 94" x 21" = 16.52ft = 16.5ft
Bldg. wall sign? (attached to bldg) Yes No Dimensions: 95" x 28" = 17.52ft = 17.5ft
Awning? Yes No Sq. ft. area of awning w/communication: N/A

A site sketch and building sketch showing exactly where existing and new signage is located must be provided. Sketches and/or pictures of proposed signage and existing building are also required.

Please submit all of the information outlined in the Sign/Awning Application Checklist. Failure to do so may result in the automatic denial of your permit.

In order to be sure the City fully understands the full scope of the project, the Planning and Development Department may request additional information prior to the issuance of a permit. For further information visit us on-line at www.portlandmaine.gov, stop by the Building Inspections office, room 315 City Hall or call 874-8703.

I hereby certify that I am the Owner of record of the named property, or that the owner of record authorizes the proposed work and that I have been authorized by the owner to make this application as his/her authorized agent. I agree to conform to all applicable laws of this jurisdiction. In addition, if a permit for work described in this application is issued, I certify that the Code Official's authorized representative shall have the authority to enter all areas covered by this permit at any reasonable hour to enforce the provisions of the codes applicable to this permit.

Signature of applicant: Mark A Dube Date: 9/29/11

This is not a permit; you may not commence ANY work until the permit is issued.

building sign permit frontage x 1.5 = 23.25 (13.5) 95" x 28" = 2660 ft = 18.47 ft

409 x 2 + 30 918
33 10.7.11

RECEIVED

2011 Building Inspections Portland, Maine

1041 BRIGHTON AVENUE
RETAIL SPACE FOR LEASE
PORTLAND, ME 04102

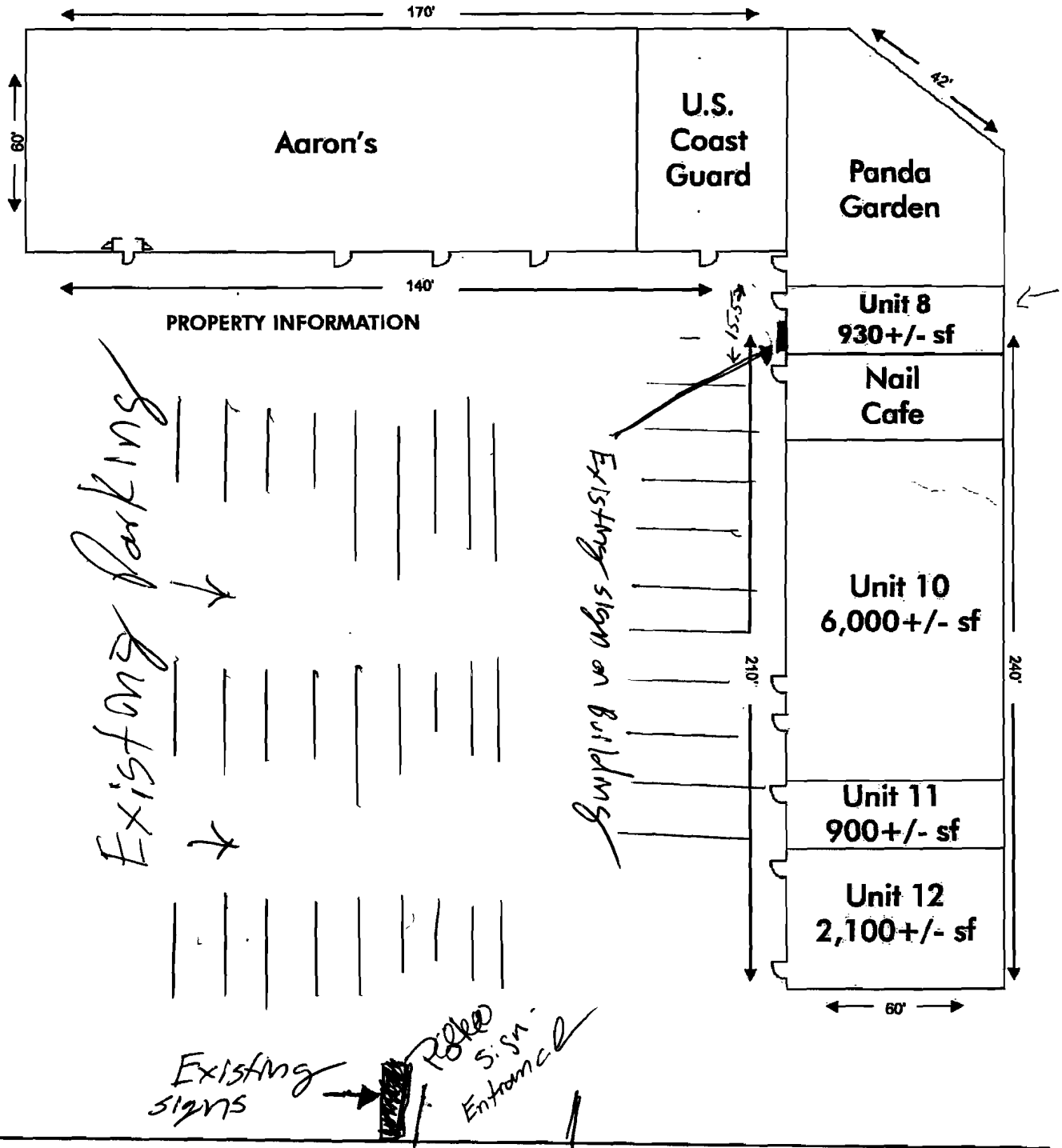

Brighton Ave

**S
I
L
V
E
R**

**BUY • SELL • TRADE • CONSIGNMENT • REPAIRS
OUTLET**

one for box sign over door.

one for freestanding sign



RECEIVED

OCT 17 2011

Dept. of Building Inspections
City of Portland Maine

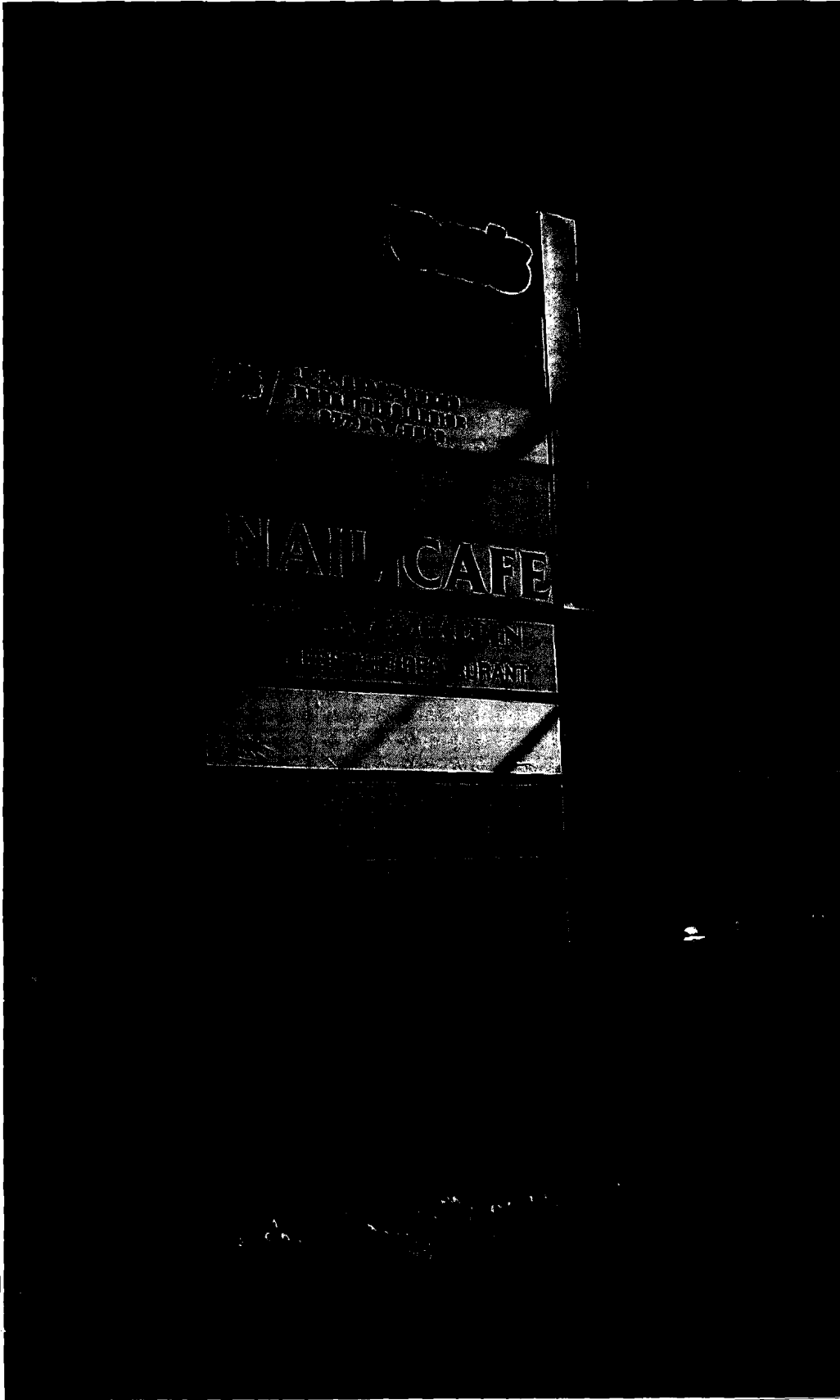

RECEIVED

OCT 17 2011

Dept. of Building Inspections
City of Portland Maine