

DISPLAY THIS CARD ON PRINCIPAL FRONTAGE OF WORK CITY OF PORTLAND

BUILDING INSPECTION

PERMIT

Permit Number: 061440

Please Read Application And Notes, If Any, Attached

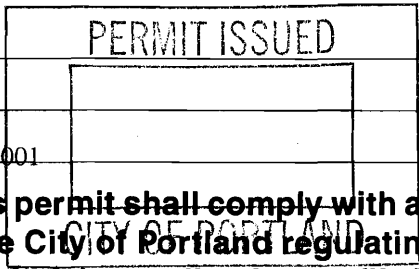

This is to certify that MCLAUGHLIN MARY A / d Thompson

has permission to build a 8' x 24' covered deck

AT 145 TAFT AVE

273 E001001

provided that the person or persons firm or corporation accepting this permit shall comply with all of the provisions of the Statutes of this State and of the Ordinances of the City of Portland regulating the construction, maintenance and use of buildings and structures, and of the application on file in this department.

Apply to Public Works for street line and grade if nature of work requires such information.

Notification of inspection must be given and when permission procedure before this building or part thereof is started or service closed-in. 4 HOUR NOTICES REQUIRED.

A certificate of occupancy must be procured by owner before this building or part thereof is occupied.

OTHER REQUIRED APPROVALS

Fire Dept. _____

Health Dept. _____

Appeal Board _____

Other _____

Department Name

[Handwritten Signature]
10/12/04
Director - Building & Inspection Services

PENALTY FOR REMOVING THIS CARD

City of Portland, Maine - Building or Use Permit Application

389 Congress Street, 04101 Tel: (207) 874-8703, Fax: (207) 874-8716

Permit No: 06-1440	Issue Date:	CBL: 273 E00.001
-----------------------	-------------	---------------------

Location of Construction: 145 TAFT AVE	Owner Name: MCLAUGHLIN MARY A	Owner Address: 145 TAFT AVE	Phone:
Business Name:	Contractor Name: Fred Thompson	Contractor Address: 317 Brown Street Westbrook	Phone: 207.831.2564
Lessee/Buyer's Name	Phone:	Permit Type: Additions - Dwellings	Zone: R3

Past Use: Single Family Home	Proposed Use: Single Family Home/ build a 8' x 24' covered deck	Permit Fee: \$70.00	Cost of Work: \$5,000.00	CEO District: 3
---------------------------------	--	------------------------	-----------------------------	--------------------

FIRE DEPT: <input type="checkbox"/> Approved <input type="checkbox"/> Denied <i>NA</i>	INSPECTION: Use Group: <i>R-3</i> Type: <i>SB</i> <i>IRC 2003</i>
Signature:	Signature:

Proposed Project Description:
build a 8' x 24' covered deck

PEDESTRIAN ACTIVITIES DISTRICT (P.A.D.)

Action: Approved Approved w/Conditions Denied

Signature: _____ Date: _____

Permit Taken By: Idobson	Date Applied For: 10/02/2006	Zoning Approval
-----------------------------	---------------------------------	------------------------

<ol style="list-style-type: none"> This permit application does not preclude the Applicant(s) from meeting applicable State and Federal Rules. Building permits do not include plumbing, septic or electrical work. Building permits are void if work is not started within six (6) months of the date of issuance. False information may invalidate a building permit and stop all work.. 	<p>Special Zone or Reviews</p> <input type="checkbox"/> Shoreland <input type="checkbox"/> Wetland <input type="checkbox"/> Flood Zone <input type="checkbox"/> Subdivision <input type="checkbox"/> Site Plan Maj <input type="checkbox"/> Minor <input type="checkbox"/> .MM <input type="checkbox"/> <i>OK w/ conditions</i> Date: <i>10/16/06</i> <i>AFM</i>	<p>Zoning Appeal</p> <input type="checkbox"/> Variance <input type="checkbox"/> Miscellaneous <input type="checkbox"/> Conditional Use <input type="checkbox"/> Interpretation <input type="checkbox"/> Approved <input type="checkbox"/> Denied Date: _____	<p>Historic Preservation</p> <input checked="" type="checkbox"/> Not in District or Landmark <input type="checkbox"/> Does Not Require Review <input type="checkbox"/> Requires Review <input type="checkbox"/> Approved <input type="checkbox"/> Approved w/Conditions <input type="checkbox"/> Denied <i>AFM</i> Date: _____
---	--	---	--

CERTIFICATION

I hereby certify that I am the owner of record of the named property, or that the proposed work is authorized by the owner of record and that I have been authorized by the owner to make this application as his authorized agent and I agree to conform to all applicable laws of this jurisdiction. In addition, if a permit for work described in the application is issued, I certify that the code official's authorized representative shall have the authority to enter all areas covered by such permit at any reasonable hour to enforce the provision of the code(s) applicable to such permit.

SIGNATURE OF APPLICANT	ADDRESS	DATE	PHONE
RESPONSIBLE PERSON IN CHARGE OF WORK, TITLE		DATE	PHONE

LOT 11, 01/4 sq. ft.

$R3 = 11,175\phi$
 front row 25' - 30' given
 rear row 25' - 36' given
 side street 20' - 25' given
 lot coverage 35% = 3911 sq. ft.

OK.

900A
 192 addition
 96. shed
 (1248 sq. ft.)

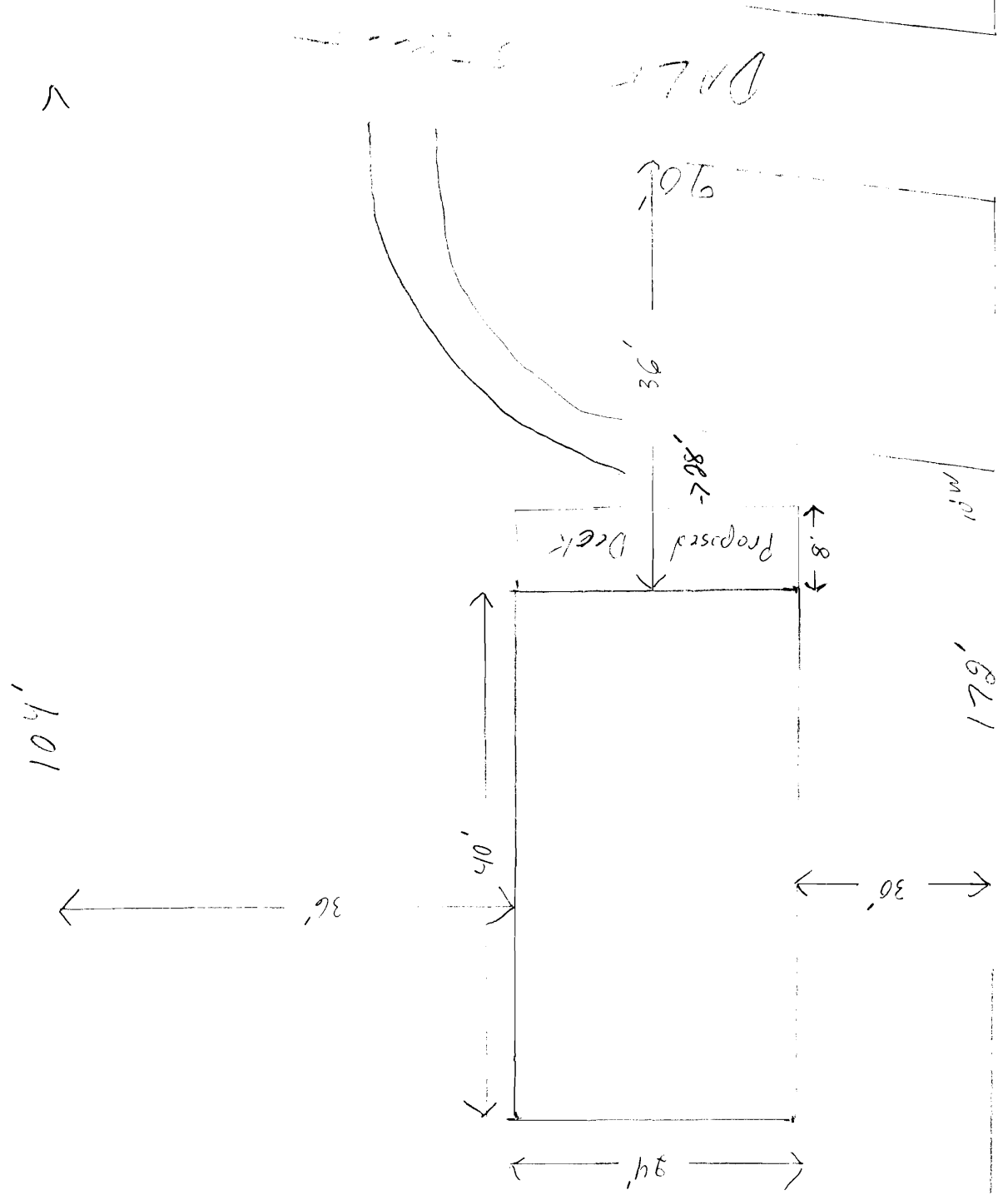

T-1-T 4/10

City of Portland, Maine - Building or Use Permit

389 Congress Street, 04101 Tel: (207) 874-8703, Fax: (207) 874-8716

Permit No: 06-1440	Date Applied For: 10/02/2006	CBL: 273 E001001
------------------------------	--	----------------------------

Location of Construction: 145 TAFT AVE	Owner Name: MCLAUGHLIN MARY A	Owner Address: 145 TAFT AVE	Phone:
Business Name:	Contractor Name: Fred Thompson	Contractor Address: 317 Brown Street Westbrook	Phone: (207) 831-2564
Lessee/Buyer's Name	Phone:	Permit Type: Additions - Dwellings	

Proposed Use: Single Family Home/ build a 8' x 24' covered deck	Proposed Project Description: build a 8' x 24' covered deck
---	---

Dept: Zoning **Status:** Approved with Conditions **Reviewer:** Ann Machado **Approval Date:** 10/10/2006

Note: There was an existing 8' x 16' deck. It has been removed.

Ok to Issue:

- 1) This permit is being approved on the basis of plans submitted. Any deviations shall require a separate approval before starting that work.
- 2) This permit is being issued with the understanding that the front setback is 30' to the property line and not the street. The front setback will be verified at the footings inspection.

Dept: Building **Status:** Approved with Conditions **Reviewer:** Tammy Munson **Approval Date:** 10/12/2006

Note:

Ok to Issue:

- 1) The carrying beam for the floor system must be 2- 2"x 8"-s.

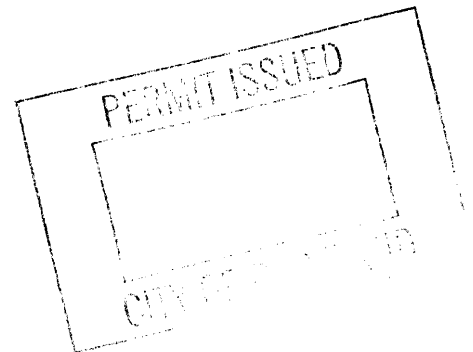



General Building Permit Application

If you or the property owner owns real estate or personal property taxes or user charges on any property within the City, payment arrangements must be made before permits of any kind are accepted.

Location/Address of Construction: 145 text Ave Portland		Square Footage of Lot: 11,044	
Total Square Footage of Proposed Structure: 1,192		Telephone: 761-4429	
Tax Assessor's Chart, Block & Lot Chart# 293 Block# E Lot# 1	Owner: MARY HUNTINGTON	Cost Of Work: \$5,000.00 Fee: \$ Colo Fee: \$	
License/Buyer's Name (If Applicable)	Applicant name, address & telephone: Fred Thompson 317 Brown St Westbrook, Me. 04092	Current Specific use: OPEN Deck SH	



CITY OF PORTLAND, MAINE

Department of Building Inspections

20

Received from _____

Location of Work _____

Cost of Construction \$ _____

Permit Fee \$ _____

Building (IL) _____ Plumbing (IS) _____ Electrical (I2) _____ Site Plan (U2) _____

Other _____

CBL: _____

Check #: _____ Total Collected \$ 1100

THIS IS NOT A PERMIT

No work is to be started until PERMIT CARD is actually posted upon the premises. Acceptance of fee is no guarantee that permit will be granted. PRESERVE THIS RECEIPT. In case permit cannot be granted the amount of the fee will be refunded upon return of the receipt less \$10.00 or 10% whichever is greater.

WHITE - Applicant's Copy
YELLOW - Office Copy
PINK - Permit Copy

1/2" x 4 85'
 1/2" x 6 172'
 1/2" x 8 218'
 Ceiling Board Board

36" Brackets 55
 Hand Screws 4) 8' 1) 5'
 Deck Plank 33 8'
 Screws 500
 Lattice 4x8 6

2x4 ceiling
 4" x 4" 3x5 Joist - 4x8
 8" on edge
 6 O.K.

1/2 CDK Screws
 2x4 Brackets
 + Ceiling Frame
 2x8 Ceiling
 3-2x8 - 8'

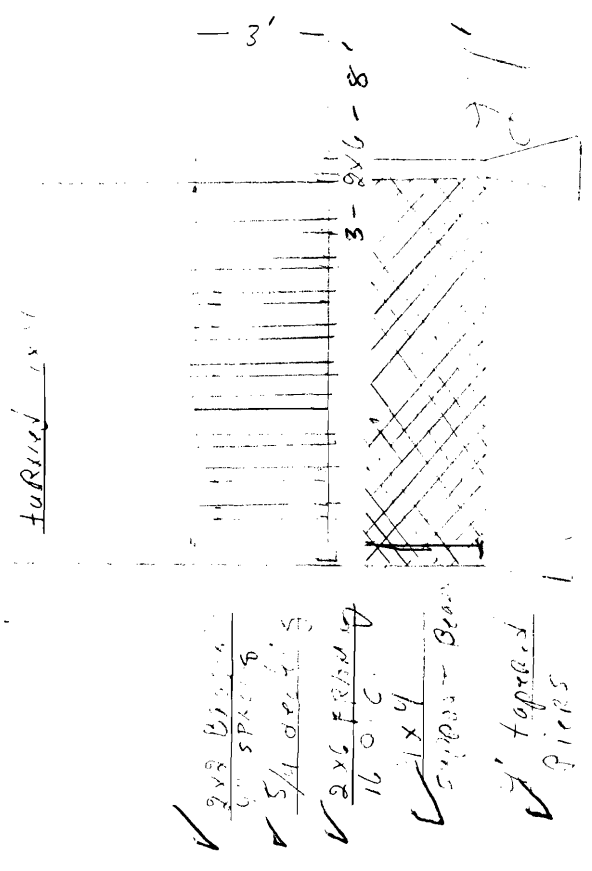

2x8 Brackets
 5 BRACKETS
 5/16 BRACKETS
 2x8 FRAME
 2 O.K.
 4x4
 5x8 BRACKETS
 2x4 TOP BOARD
 PIERCE

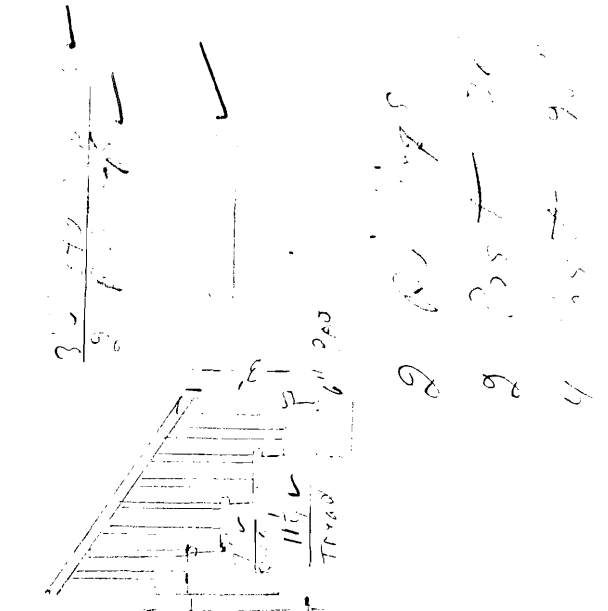

2 BRACKETS
 2 BRACKETS
 4 BRACKETS



This page contains a detailed description of the Parcel ID you selected. Press the **New Search** button at the bottom of the screen to submit a new query.

Current Owner Information

Card Number	1001
Parcel ID	E001001
Location	145 WABE AVE
Land Use	SINGLE FAMILY
Owner Address	145 WABE AVE 145 WABE AVE PORTLAND ME 04107
Book/Page	12217201
Legal	1-1-B-1 TO 1 TRUST A/C 145 WABE AVE WABE SUB 1-1-1 1117 sq

Current Assessed Valuation

Land	Building	Total
\$40,000	\$151,000	\$191,000

Property Information

Year Built 1980	Style Colonial	Story Height 2	Sq. Ft. 1900	Total Acres 0.407
Bedrooms 4	Full Baths 3	Half Baths	Total Rooms 7	Attic None
				Basement Full

Outbuildings

Type SHED-FRAME	Quantity 1	Year Built 1980	Size 3012	Grade 0	Condition F
---------------------------	----------------------	---------------------------	---------------------	-------------------	-----------------------

Sales Information

Date 12/02/1996	Type LAND + BLDING	Price \$60,000	Book/Page 22014+288
---------------------------	------------------------------	--------------------------	-------------------------------

Picture and Sketch

Picture	Sketch	Tax Map
-------------------------	------------------------	-------------------------

[Click here](#) to view Tax Roll Information.

Any information concerning tax payments should be directed to the Treasury office at 874-8490 or e-mailed.

New Search!