

923788

Permit # 923788 City of Portland

Building Permit Application Fee \$25.00 Zone Map # Lot #

272-N-012

PERMIT ISSUED

Owner: Mark McCracken Phone # 874-0931
Address: 57 Birchvale Drive 04102
LOCATION OF CONSTRUCTION 57 Birchvale Drive
Contractor: Mark McCracken Sub:
Address: same as above Phone #

Est. Construction Cost: \$1470.00 Proposed Use: single fam w/ exterior renovation
Past Use: single fam.
# of Existing Res. Units # of New Res. Units
Building Dimensions L W Total Sq. Ft.
# Stories: # Bedrooms Lot Size:
Is Proposed Use: Seasonal Condominium Conversion
Explain Conversion replacing retaining wall 20' x 4' x 6"

For Official Use Only
Date:
Inside Fire Limits:
Bldg Code:
Time Limit:
Estimated Cost:
Name:
Subdivision:
Lot:
Ownership: Public Private

JUN 10 1992

Zoning:

Street Frontage Provided:
Provided Setbacks: Front Back Side Side

Review Required:

Planning Board Approval: Yes No Date:
Zoning Board Approval: Yes No Date:
Conditional Use: Variance Site Plan Subdivision
Shoreland Zoning Yes No Floodplain Yes No
Special Exception
Other (Explain)

HISTORIC PRESERVATION

Ceiling:

1. Ceiling Joists Size:
2. Ceiling Strapping Size Spacing
3. Type Ceilings: Size
4. Insulation Type
5. Ceiling Height:

Roof:

1. Truss or Rafter Size Span
2. Sheathing Type Size
3. Roof Covering Type

Floor:

1. Sills Size: Sills must be anchored.
2. Girder Size:
3. Lally Column Spacing: Size: Spacing 16" O.C.
4. Joists Size:
5. Bridging Type: Size:
6. Floor Sheathing Type: Size:
7. Other Material:

Exterior Walls:

1. Studding Size Spacing
2. No. windows
3. No. Doors
4. Header Sizes Yes No. Span(s)
5. Bracing: Yes No.
6. Corner Posts Size
7. Insulation Type Size
8. Sheathing Type Size
9. Siding Type Weather Exposure
10. Masonry Materials
11. Metal Materials

Interior Walls:

1. Studding Size Spacing
2. Header Sizes Span(s)
3. Wall Covering Type
4. Fire Wall if required
5. Other Materials

Heating:

Type of Heat:
Type of Heat:
Service Entrance Size: Smoke Detector Required Yes No

Electrical:

1. Approval of soil test if required
2. No. of Tubs or Showers
3. No. of Flushes
4. No. of Lavatories
5. No. of Other Fixtures

Plumbing:

1. Type:
2. Pool Size: x Square Footage
3. Must conform to National Electrical Code and State Law.

Swimming Pools:

1. Type:
2. Pool Size: x Square Footage
3. Must conform to National Electrical Code and State Law.

Permit Issued By J. Foss

Date 6/12/92

Name of Applicant MARK MCCracken

CEOs District

CONTINUED TO REVERSE SIDE

White - Tax Assessor

Ivory Tag - CEO

PLOT PLAN

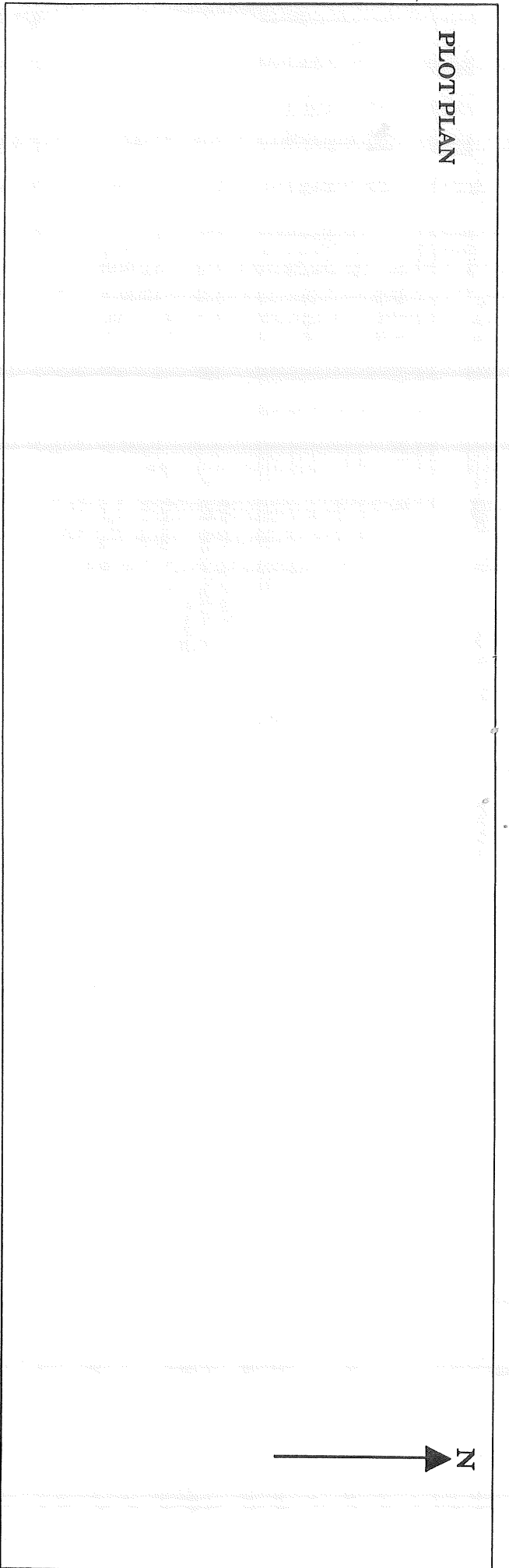

FEEES (Breakdown From Front)

Base Fee \$ \_\_\_\_\_  
 Subdivision Fee \$ \_\_\_\_\_  
 Site Plan Review Fee \$ \_\_\_\_\_  
 Other Fees \$ \_\_\_\_\_  
 (Explain) \_\_\_\_\_  
 Late Fee \$ \_\_\_\_\_

Type \_\_\_\_\_  
 Inspection Record \_\_\_\_\_

Date \_\_\_\_\_  
 \_\_\_\_\_  
 \_\_\_\_\_  
 \_\_\_\_\_  
 \_\_\_\_\_  
 \_\_\_\_\_  
 \_\_\_\_\_

COMMENTS

*1/25/16 Permit Called - General of department - doesn't open  
 what work was done - Permit expired*

CERTIFICATION

I hereby certify that I am the owner of record of the named property, or that the proposed work is authorized by the owner of record and that I have been authorized by the owner to make this application as has authorized agent and I agree to conform to all applicable laws of this jurisdiction. In addition, if a permit for work described in this application is issued, I certify that the code official or the code official's authorized representative shall have the authority to enter areas covered by such permit at any reasonable hour to enforce the provisions of the code(s) applicable to such permit.

SIGNATURE OF APPLICANT *W. M. ...*

ADDRESS

PHONE NO.

RESPONSIBLE PERSON IN CHARGE OF WORK, TITLE

PHONE NO.

Mark McCracken  
57 Birchvale Drive  
Portland, ME 04102  
874-0931

Proposal to Replace an Existing Concrete Retaining Wall.

Location: 57 Birchvale Drive, Portland, ME.

Existing wall: 26' x 4' x 8" poured concrete

Earth behind wall has settled causing the wall to lean approximately 4" from center. The concrete has fractured in several places. The wall is at risk of collapse.

Proposed replacement: A 20' x 4' x 6" wall constructed from 6" x 6" x 10' pressure treated timber. Wall to be set on 6" crushed stone base, and anchored to the foundation of the house. It consists of ten courses of timber, including two courses below grade. The wall has three deadmen buried in the slope. The project includes removing the existing cast steps and slap stoop and replacement with wood construction of identical dimensions.

Removal of concrete wall and preparation of stone base to be done by Blue Rock Industries, Westbrook, ME. Construction of timber wall, steps and stoop, and landscaping to be done by property owner.

List of materials and approximate cost:

Remove wall, stone base	\$832.00
Pressure treated timber	500.00
Step stringer	18.00
Treads	30.00
12" galvanized spikes	50.00
6' angle iron	40.00
Total	<u>\$1470.00</u>

Included: Pictorial and orthographic drawings of proposed construction and dimensions. Plot plan.

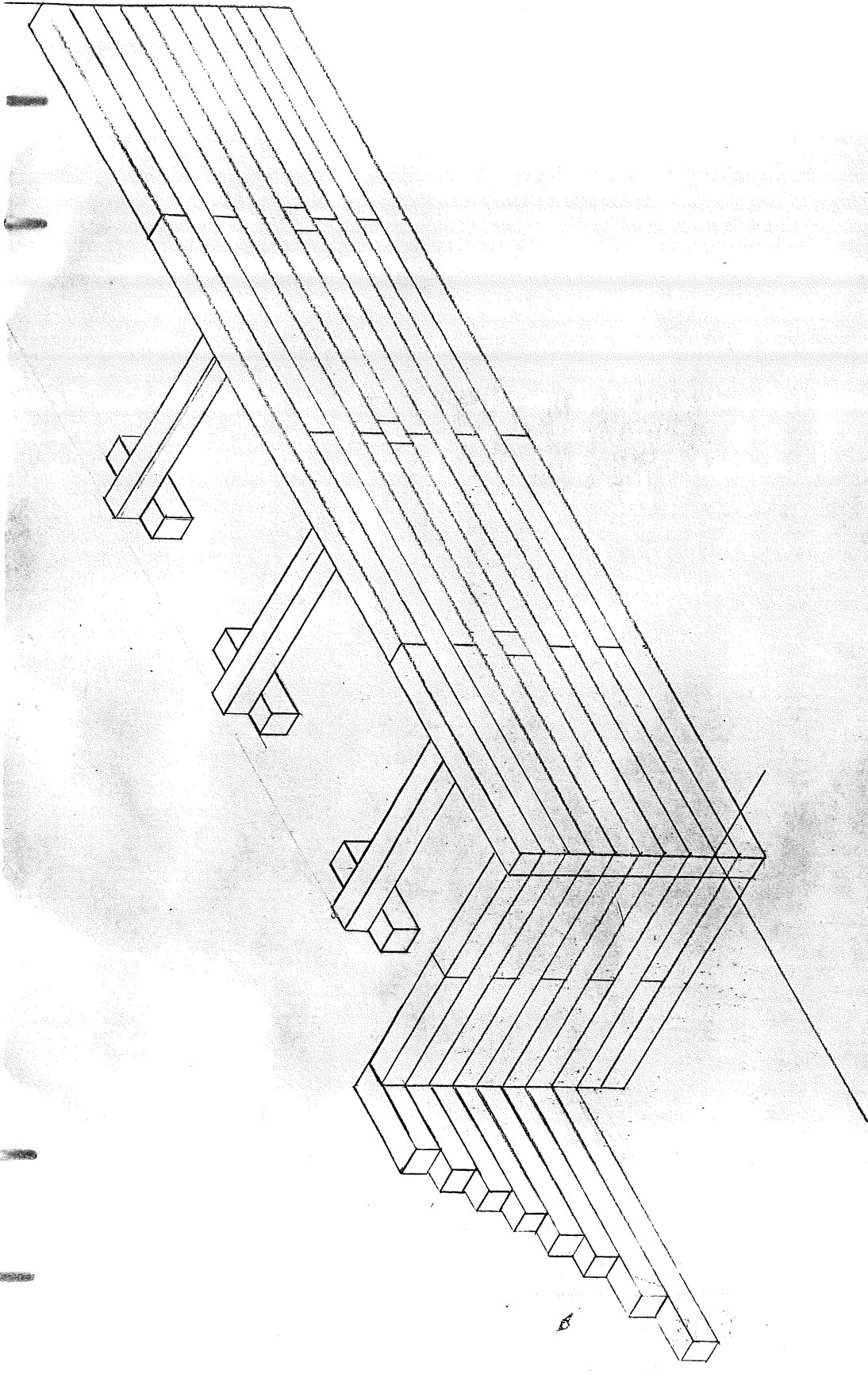

RETAINING WALL  
 $\frac{1}{2}'' = 1'$  M McCracken  
4 JUNE 1992

McCracken  
57 Birchvale Dr.

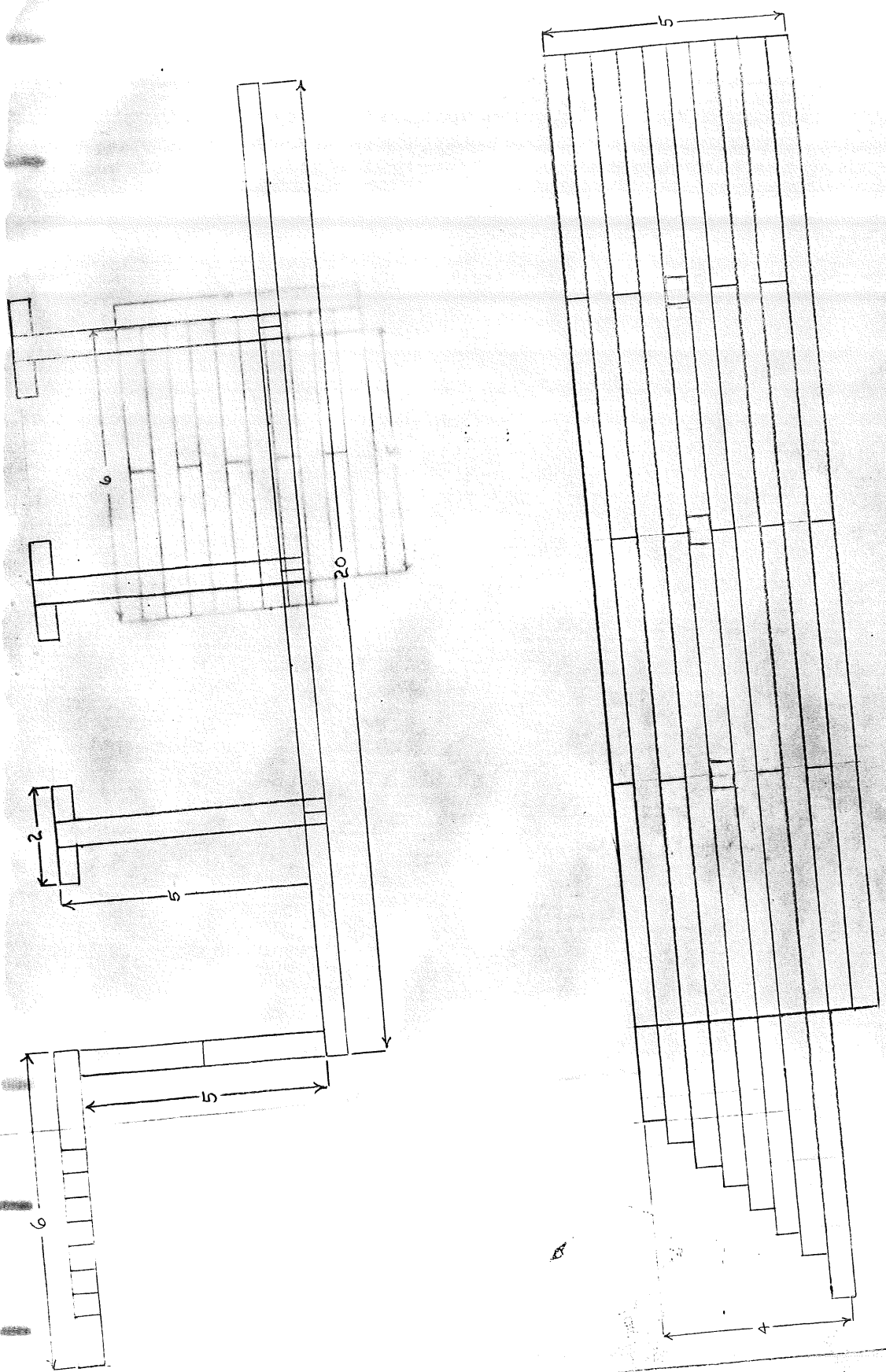

RETAINING WALL  
 $\frac{1}{2}'' = 1'$  M. McCracken 430

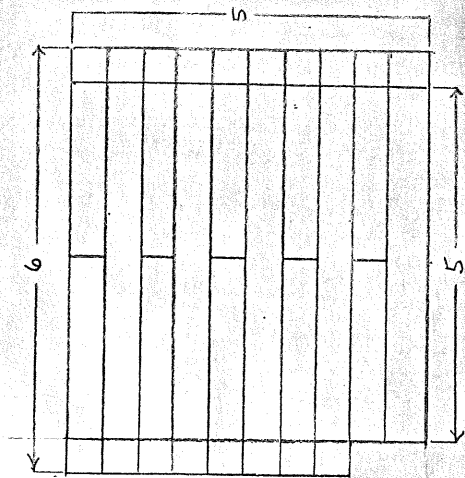

Plot Plan  
S7 BRANCHING DIC

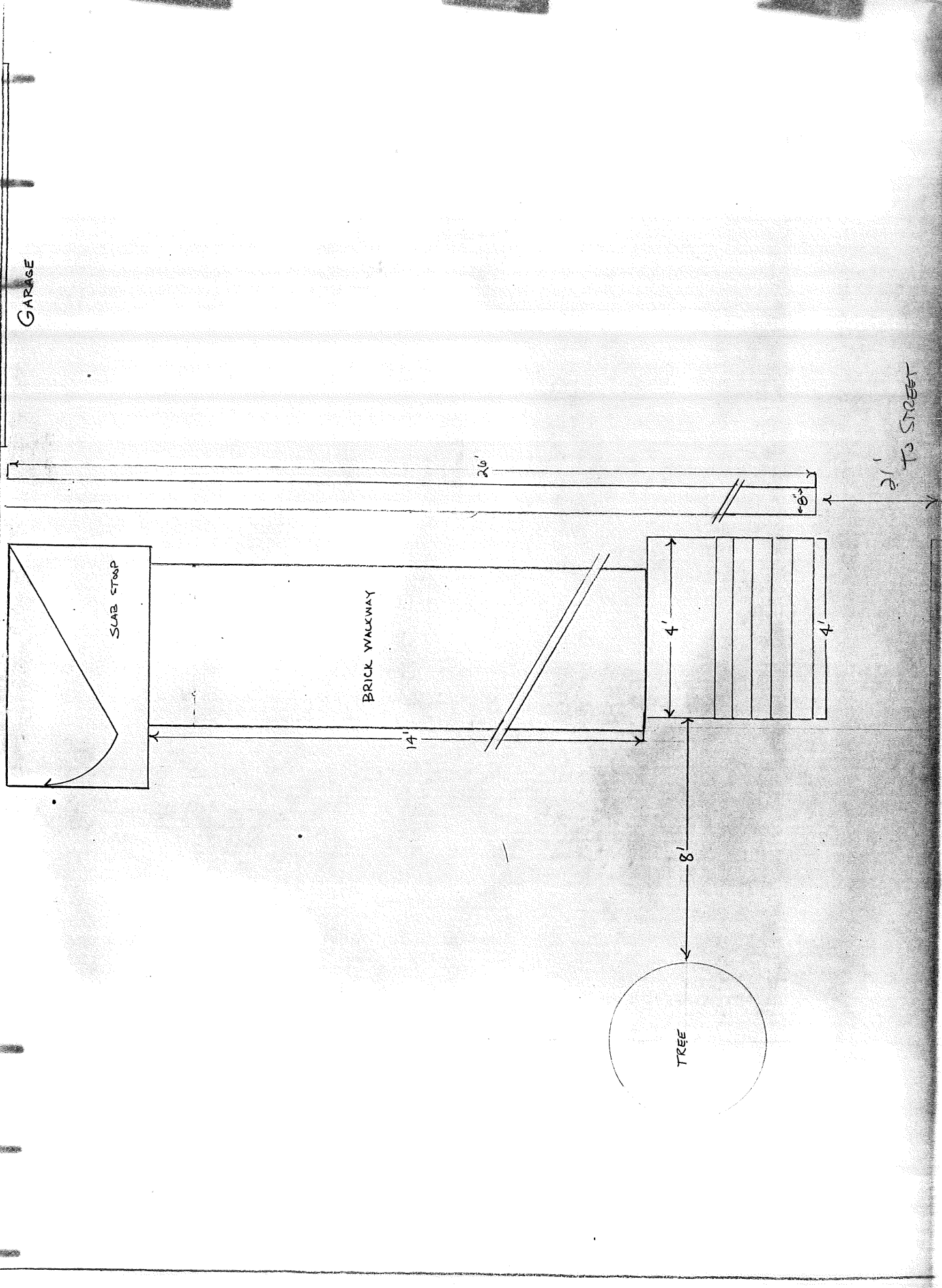

PRESENT COM out

10/11/2023

NOTES

Permit No. 74/422

Location Lot 9 Bismarck Dale

Owner William Down

Date of permit 5/17/74

Approved

SM

6-24-74 ~~work~~ ~~completed~~ ~~on~~ ~~land~~ ~~and~~ ~~finally~~ ~~about~~ ~~completed~~ ~~weather~~ ~~inspected~~ ~~main~~ ~~fully~~ ~~under~~ ~~range~~ ~~seating~~ ~~on~~ ~~2x4~~, ~~beams~~ ~~over~~ ~~gutter~~ ~~and~~ ~~filler~~ ~~ripping~~ ~~strip~~ ~~by~~ ~~floor~~

6-25-74 talked to ~~Mr. T.~~ ~~Wood~~ ~~about~~ ~~above~~ ~~problem~~ ~~he~~ ~~will~~ ~~have~~ ~~same~~ ~~corrected~~

7-8-74 same ~~work~~

7-19-74 GAVE OK TO CLOSE IN SUBJECT TO ELEC AND PLUMBING INSPECTION. RAY B.

7-23-74 about ~~completed~~

8-12-74 same ~~work~~

8-26-74 Completed ~~work~~

Worked 5/27/74  
Just

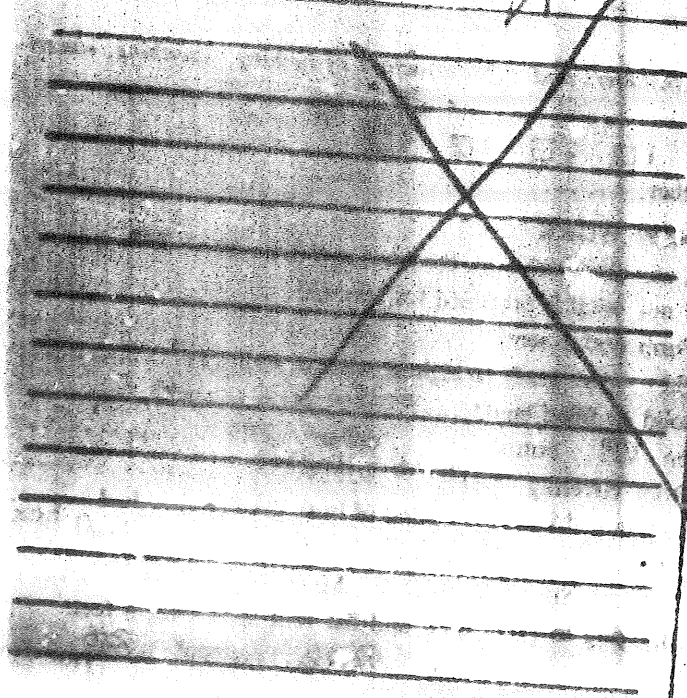

PERMIT  
NO. 74/422

DATE OF PERMIT