

SUBSURFACE WASTEWATER DISPOSAL SYSTEM APPLICATION

Maine Department of Human Services
 Division of Health Engineering, Station 10 SHS
 (207) 287-5672 FAX (207) 287-4172

Town, City, Plantation
PORTLAND

Street, Road, Subdivision
TAFT AVENUE

Owner's Name
FRANCIS JAMES DRAKE

SUBSURFACE WASTEWATER DISPOSAL PLAN

SCALE 1" = 20 FT.

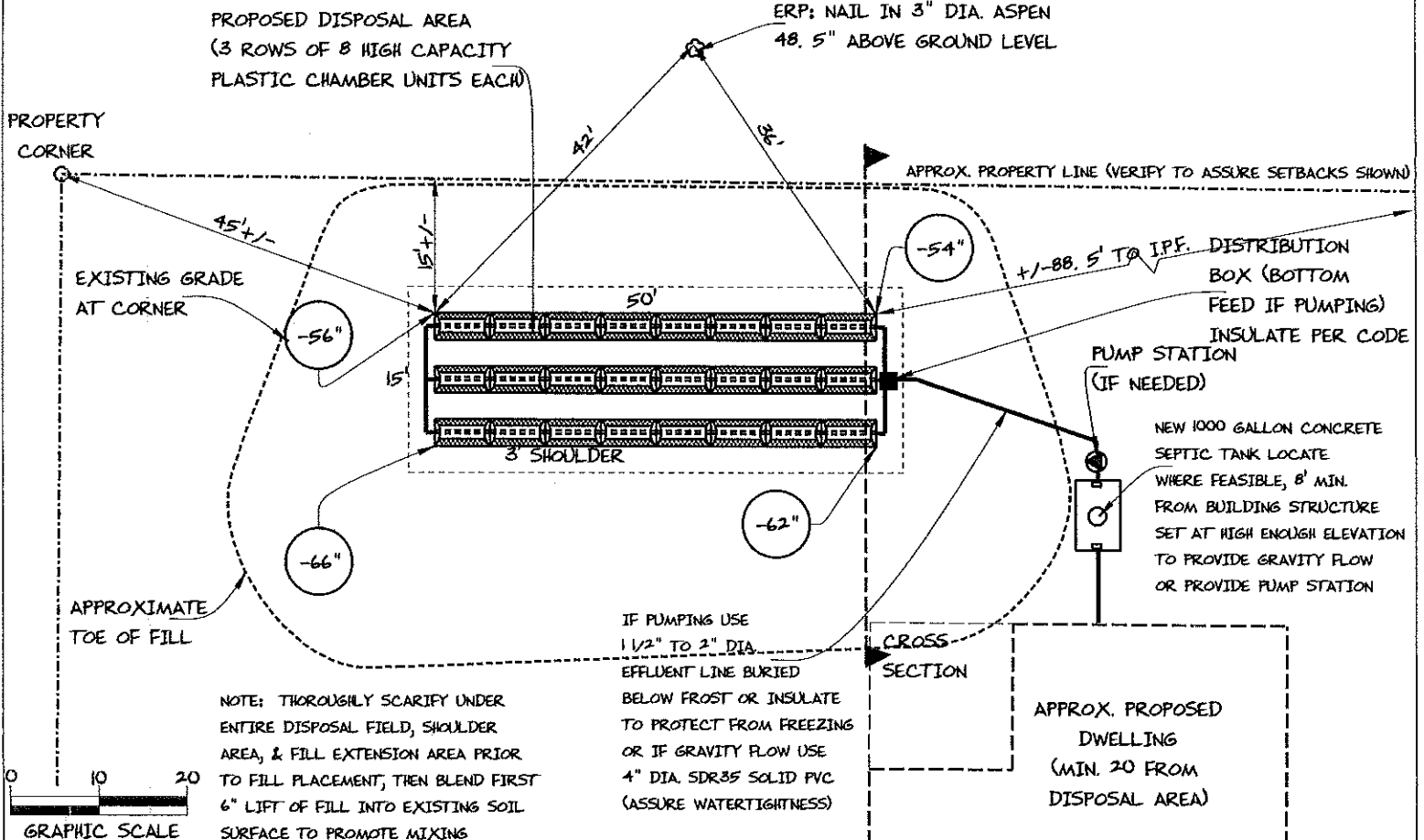

FILL REQUIREMENTS

CONSTRUCTION ELEVATIONS

ELEVATION REFERENCE POINT

Depth of Fill (Upstope)	: 42" - 44" Finished Grade Elevation
Depth of Fill (Downslope)	: 50" - 54" Top of Distribution Pipe or Proprietary Device
DEPTHS AT CROSS-SECTION (shown below)	Bottom of Disposal Area

SEE
 DETAIL
 BELOW

Location & Description 3" DIA. ASPEN NAIL 48.5" ABOVE BASE
 Reference Elevation is: 0.0" or -----

SCALE:
 VERTICAL: 1" = 5 FT
 HORIZONTAL: 1" = 10 FT

DISPOSAL AREA CROSS SECTION

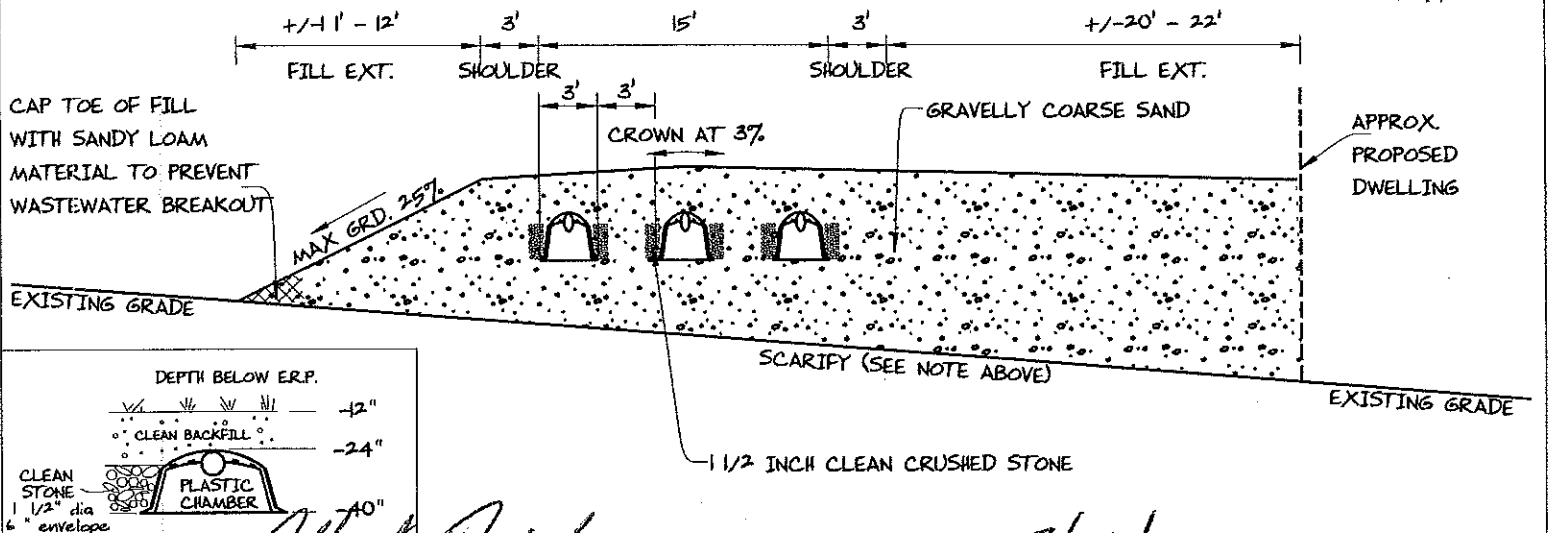

Albert Frick
 Site Evaluator Signature

163
 SE *

7/22/2016
 Date