

- LEGEND**
- EXIT EXIT SIGN TO BE SELF ILLUMINATED
 - ADA EXIT SIGN TO BE LOCATED ON THE WALL ON THE LATCH SIDE 5' TO THE CENTER FROM THE FLOOR
 - EMERGENCY LIGHTS
 - PH ADA APPROVED PANIC HARDWARE
 - ONE HOUR FIREWALL
 - PULL STATION THE WALL ON THE LATCH SIDE 5' TO THE CENTER FROM THE FLOOR
 - STROBE & HORN
 - DESIGNED OR EXISTING WALLS
 - WALLS TO REVISE
 - 1 HR RATED WALLS

NOTES

ALL DOORS TO BE 36" WIDE WITH APPROVED LEVER HANDLE SETS

PROVIDE LOW PROFILE THRESHOLDS WHERE APPLICABLE (1/2" MAX HIGH)

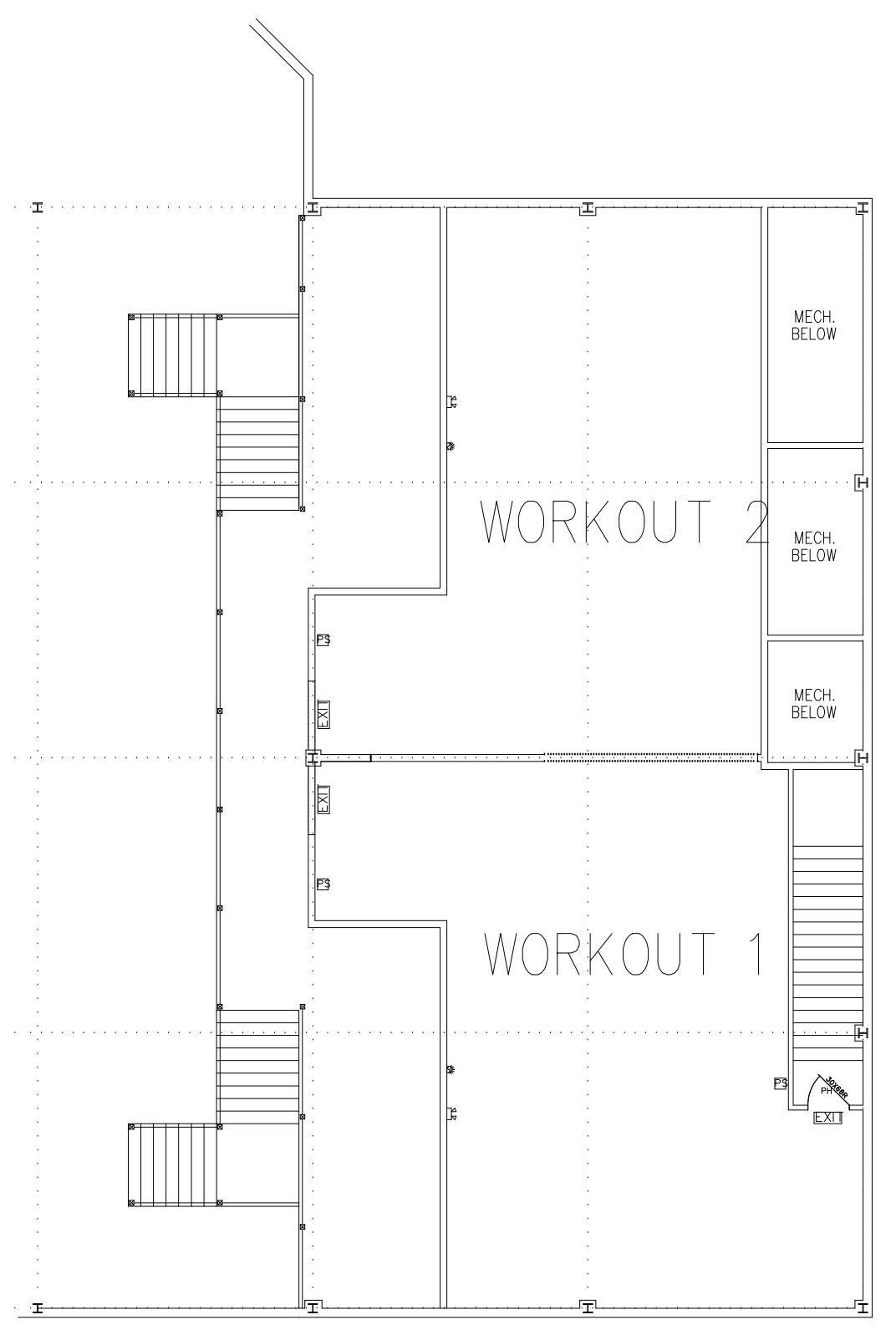

FIRST FLOOR PLAN

SECOND FLOOR PLAN

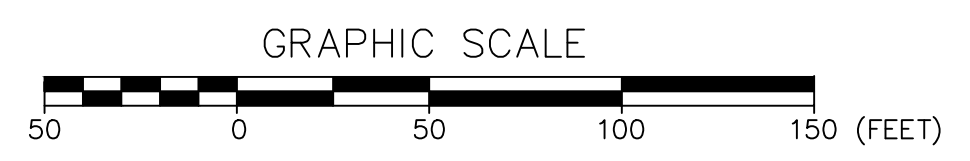

NO.	DESCRIPTION	DATE

FLOOR PLAN
PORTLAND SPORTS CENTER
WARREN AVENUE PORTLAND, MAINE

FOR: JIM GRATELO
 PORTLAND SPORTS REALTY, LLC
 550 WARREN AVE
 PORTLAND, MAINE 04103

ATTAR ENGINEERING, INC.
 CIVIL • STRUCTURAL • MARINE
 1284 STATE ROAD - ELIOT, MAINE 03903
 PHONE: (207)439-6023 FAX: (207)439-2128

SCALE: -	APPROVED BY:	DRAWN BY:
DATE: 9/23/14		REVISION : DATE
JOB NO: C068-14	CAD FILE: DOME_CEILING	SHEET 1