



**BENNETT  
ENGINEERING**

CONSULTING ENGINEERS

Bennett Road, P.O. Box 297, Freeport, Maine 04032  
Tel - (207) 865-9475  
Fax - (207) 865-1800  
Email - office@bennettengineering.net

PROGRESS PRINT  
NOT FOR CONSTRUCTION  
04 AUG 03

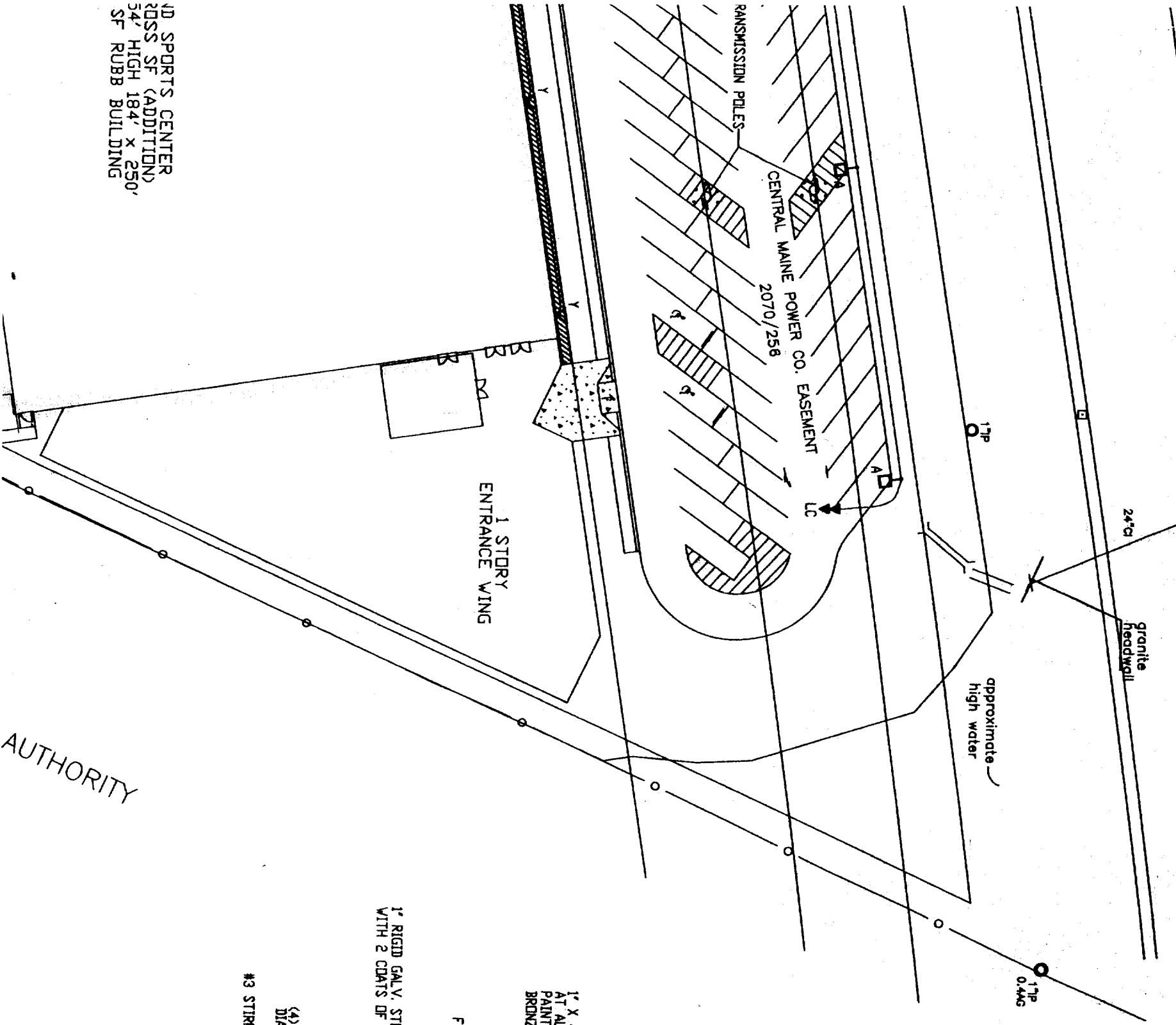

10 SPORTS CENTER  
2055 SF (ADDITION)  
34' HIGH 184' x 250'  
SF RUBB BUILDING

AUTHORITY

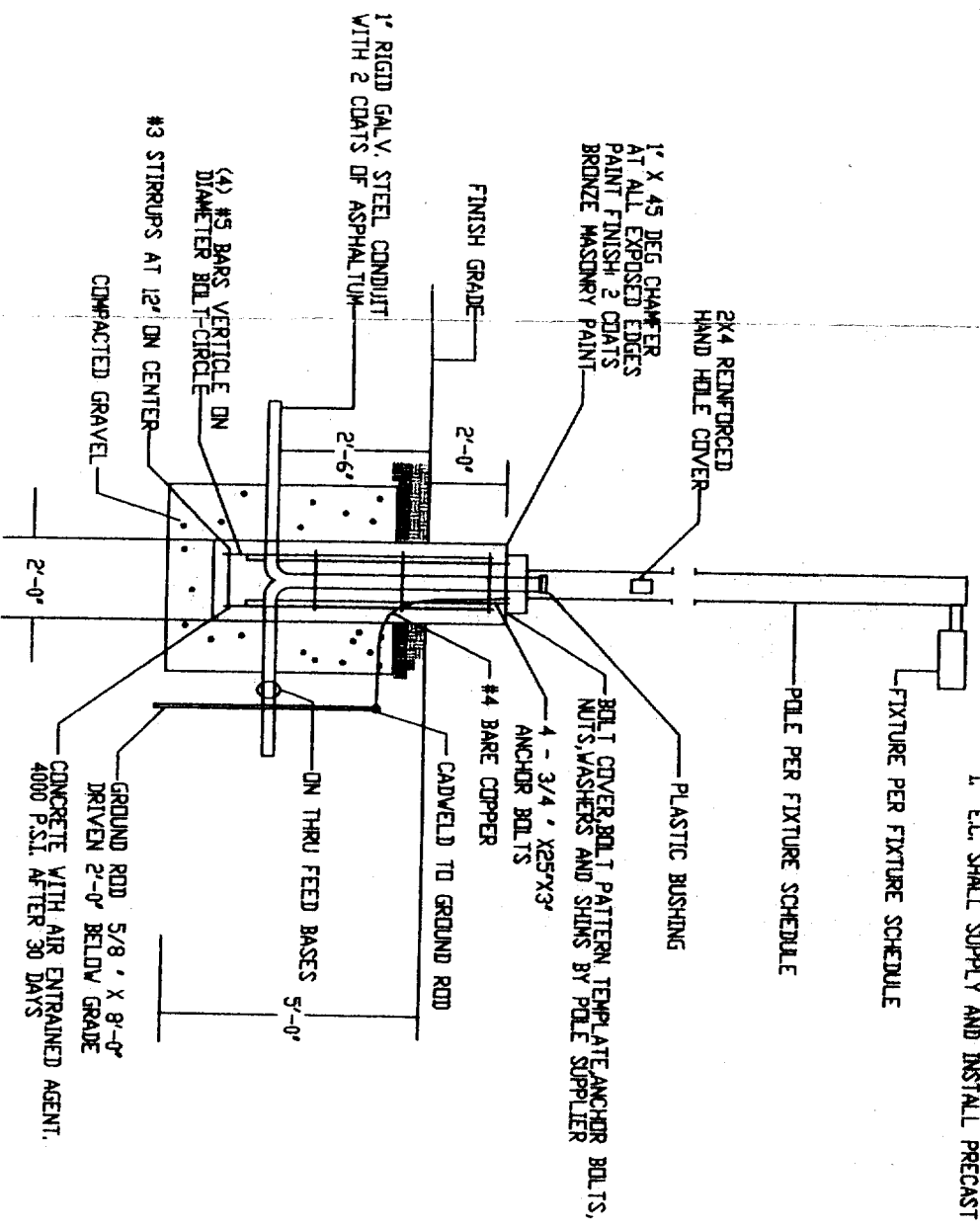

NOTE:  
1. E.C. SHALL SUPPLY AND INSTALL PRECAST POLE BASE.

POLE BASE DETAIL  
SCALE NONE

Contractor:  
DESTEFAN  
ASSOCIATES

Owner:

MAI

LEGEND

\_\_\_\_ DENOTES 1" - 2, #10 & 1, #12 GND UNDERGROUND

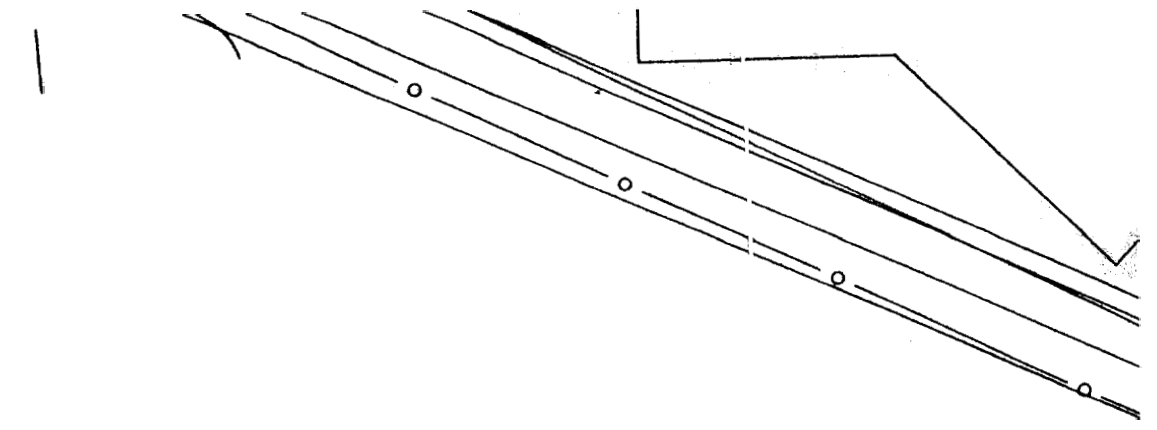

LIGHTING FIXTURE SCHEDULE

TYPE	DESCRIPTION	LAMPS QUANTITY & TYPE	REMARKS
A	LSI (CITATION SERIES) #CT2H-FT-250-MH-F-MT-BRZ	1 - 250W MH	MOUNTED ON 20'-0" SQUARE STEEL POLE
Y	LSI GREENBRIAR WALL SERIES	1 - 250W MH	MOUNTED AT 18'-0" AFG
X	EXISTING FIXTURE TO BE RELOCATED		

NOTE:

1. INSTALL 8 POLE LIGHTING CONTACTOR IN ELECTRICAL ROOM. INSTALL (4) 1P, 20A BREAKERS IN MAIN PANEL. INSTALL TIME CLOCK/PHOTOCELL COMBINATION FOR CONTROL OF ALL NEW EXTERIOR LIGHTING.

CENTER AT JOKER'S PORTLAND, MAINE

Project No: 03406 PSC

Drawing Title: EXTERIOR ELECTRICAL PLAN

Scale: AS NOTED

Date: August 04, 2003

Revision Dates:

Drawing Number:

E1.0

N/F  
GEORGIA PACIFIC CORP.  
(G.P. CORP.)

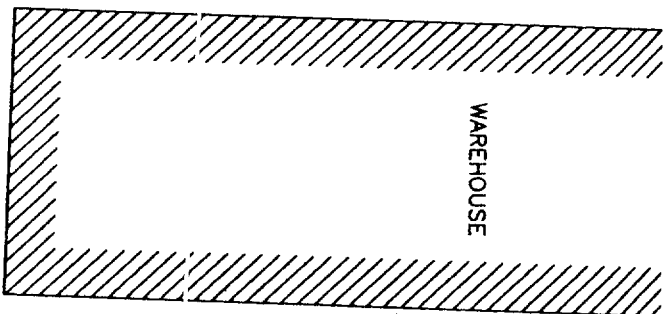

N/F  
VERETT J. PRESCOTT, INC.

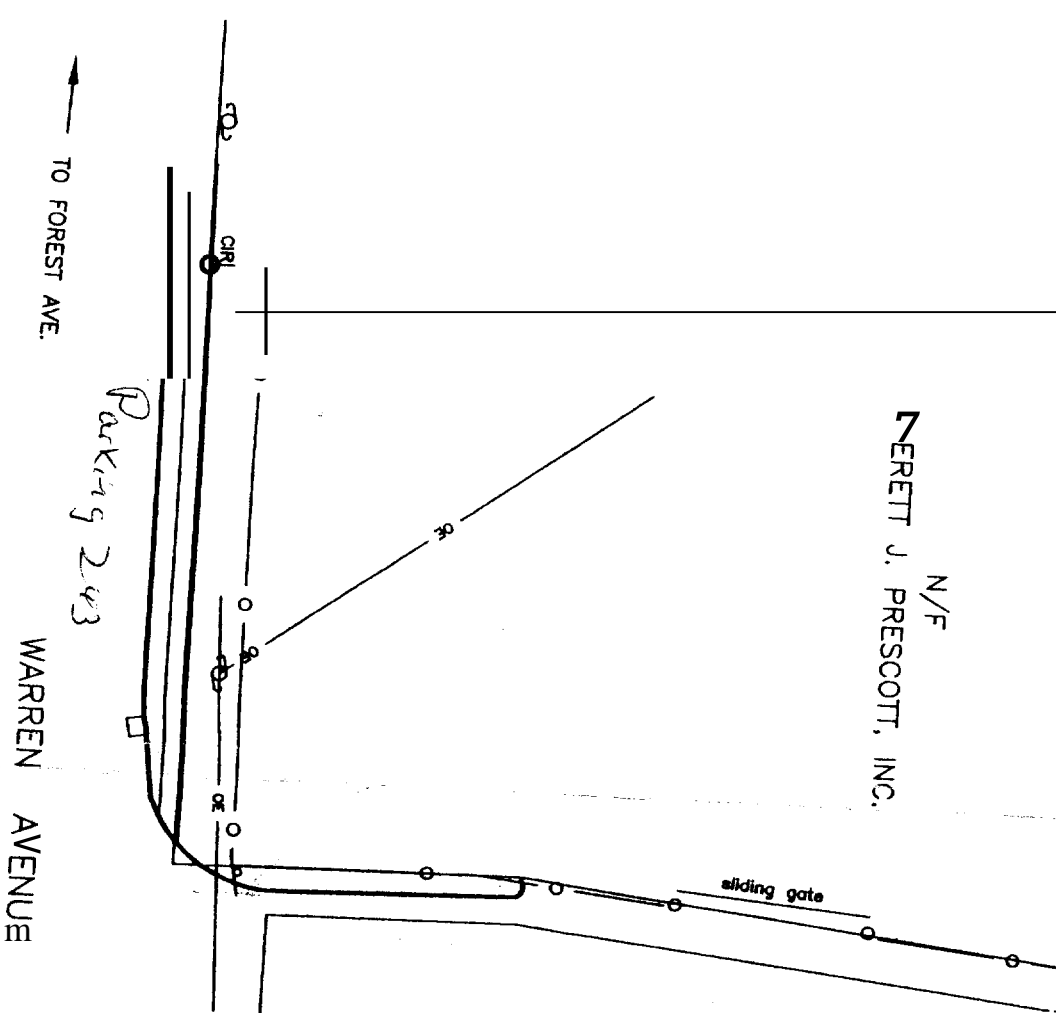

ACCESS RIGHT OF WAY  
12825/252

PROTECT LIGHT POLE TO  
REMAIN.

RELOCATED LIGHT FIXTURE

E.C. SHALL SUPPLY &  
INSTALL 24"x24" PULL BOX  
SPLICE WIRING AND EXTEND  
TO NEW LOCATION.

RELOCATED LIGHT FIXTURE

TO NEW LOCATION.

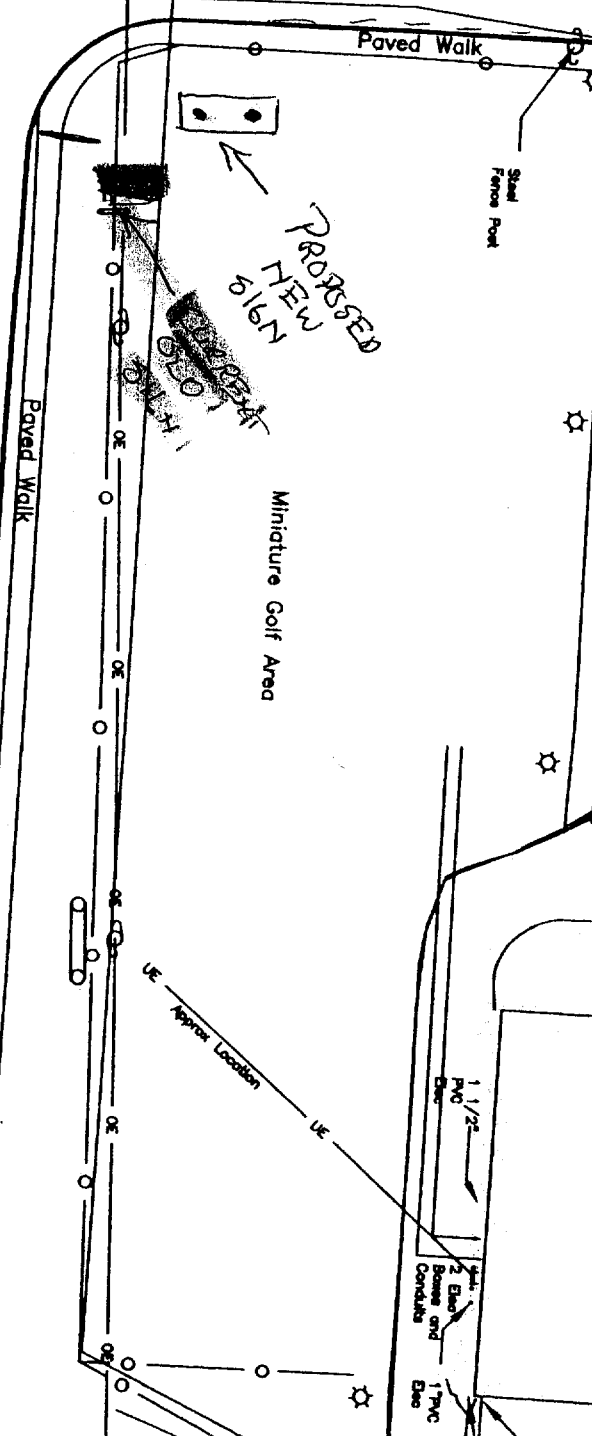

28,400 ± SF

ORIGINAL  
BUILDING



EXTERIOR ELECTRICAL PLAN  
SCALE: 1" = 40'-0"



RAILS

N/F  
PORTLAND TERMINAL COMPANY

CIR  
509  
Overhead

N/F  
EVERETT J. PRESCOTT, INC.

EASEMENT  
15917/348

E.C. SHALL SUPPLY &  
INSTALL 24"x24" PULL BOX  
SPICE WIRING AND EXTEND  
TO NEW LOCATION.

RELOCATED LIGHT  
FIXTURE

LIGHT FIXTURE TO BE RELOCATED,  
FOR RELOCATED LIGHT, DISPOSE OF  
(TYP)

#10 AWG

CHP TRANSMISSION POLES

OVERHEAD POWER LINE

OVERHEAD POWER LINES

garage

