

03-1291

# All Purpose Building Permit Application

If you or the property owner owes real estate or personal property taxes or user charges on any property within the City, payment arrangements must be made before permits of any kind are accepted.

Location/Address of Construction: <u>512 Warren Ave</u>		
Total Square Footage of Proposed Structure <u>3200</u>	Square Footage of Lot <u>184,000</u>	
Tax Assessor's Chart, Block & Lot Chart#      Block#      Lot# <u>271            A            2</u>	Owner: <u>SMG Sportsplex Management Group</u>	Telephone: <u>207-363-1345</u>
Lessee/Buyer's Name (If Applicable) <u>Turf's Sports Pub</u>	Applicant name, address & telephone: <u>Turf's Sports Pub 512 Warren Ave Portland, Me. 04103</u>	Cost Of Work: \$ <u>40,000</u>  Fee: \$ <u>381.00</u>
Current use: <u>(new)</u> <u>878-5800 x 22</u>		
If the location is currently vacant, what was prior use: _____		
Approximately how long has it been vacant: _____		
Proposed use: <u>Sports Pub</u>		
Project description: <u>Install Vertical Wheelchair lift.</u>		
Contractor's name, address & telephone:  Who should we contact when the permit is ready: <u>James Grathels</u> Mailing address: <u>512 Warren Ave</u> Please telephone when permit is ready. <u>Portland, Maine, 04103</u>		
We will contact you by phone when the permit is ready. You must come in and pick up the permit and review the requirements before starting any work, with a Plan Reviewer. A stop work order will be issued and a \$100.00 fee if any work starts before the permit is picked up.      PHONE: <u>878-5800 x 22</u>		

*Handwritten note:* I was merged 053 3630

**IF THE REQUIRED INFORMATION IS NOT INCLUDED IN THE SUBMISSIONS THE PERMIT WILL BE AUTOMATICALLY DENIED AT THE DISCRETION OF THE BUILDING/PLANNING DEPARTMENT, WE MAY REQUIRE ADDITIONAL INFORMATION IN ORDER TO APPROVE THIS PERMIT.**

I hereby certify that I am the Owner of record of the named property, or that the owner of record authorizes the proposed work and that I have been authorized by the owner to make this application as his/her authorized agent. I agree to conform to all applicable laws of this jurisdiction. In addition, if a permit for work described in this application is issued, I certify that the Code Enforcement Department shall have the authority to enter all areas covered by this permit at any reasonable hour to enforce the provisions of the applicable laws of this permit.

Signature of applicant: _____	Date: _____
-------------------------------	-------------

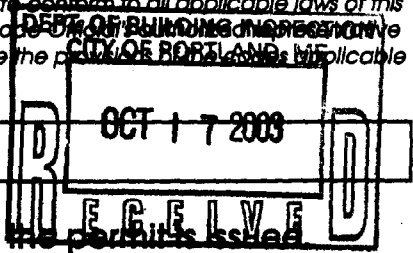

This is NOT a permit, you may not commence ANY work until the permit is issued. If you are in a Historic District you may be subject to additional permitting and fees with the Planning Department on the 4th floor of City Hall



# **BENNETT ENGINEERING**

## **CONSULTING ENGINEERS**

**Bennett Road, P.O. Box 297, Freeport, Maine 04032**

**Tel - (207) 865-9475**

**Fax - (207) 865-1800**

**Email - office@bennettengineering.net**

### **Facsimile Cover Sheet**

**Date/ Time: 10/21/03 / 5:05 PM**

**Number of Pages: 1**

**Company: City Of Portland**

**Fax Number:**

**Attention: Michael Collins, Chief Electrical Inspector**

**From: Will Bennett**

**Subject: Portland Sports Center**

**Comments:**

**1. The main distribution panel is rated for 800A and is not even half loaded. The new portion of the building is being served by a 400A breaker in the existing panel. The existing 800A distribution panel has more than enough capacity to serve the new sports center and bar addition according to Central Maine Power records of peak load.**

**Cc: Jim Granello  
John Destefano**

510 Warren Ave.  
Portland, ME 04103  
P. (207) 878-5800  
F. (207) 878-0335



Route 1  
Walmart Shopping Center  
Portsmouth, NH 03801  
P. (603) 431-7770  
F. (603) 431-4984

Mike Nugent (877-8703)

- ATTACHED is our Fire Marshall's Permit
- Also we talked to Mike Collins - also
- McDoyle visited our site last week
- We would like to start the platform Tuesday.

RLB

J. L. [Signature]

Mike Nyant -



# Application for Construction Permit

Department of Public Safety  
State Fire Marshal's Office  
52 State House Station  
Augusta, Maine 04333-0052  
Tel: 207-624-8744 x 1  
Fax: 207-624-8767

### Project Information

Project Name: Turf's Sports Pub  
Street Location: 512 Warren Ave Town Location: Portland  
County: Cumberland  
New Building:  Renovation:  Addition:  Occupancy Change:   
Sprinkler System:  No  Sprinkler System Supervised:  No   
Date of Construction Start-up: 11/1/03 Estimated Project Cost: \$0,000  
Date of Construction Completion: 12/1/03 Construction Permit Fee: 75.00  
(Fee schedule is on back)

### Occupancy Classification

Apartments  Nursing Home  Educational   
Hotel / Motel  Industrial  Daycare   
Rooming & Lodging  Residential Care Level I  Detention   
Congregate Housing  Residential Care Level II  Business   
Hospital  Assembly Class ≥1000  >300<1000  ≤300  Other   
Limited Care  Mercantile A  B  C

### Construction Type

Fire Resistive: Type I (443), (332)  Unprotected Ordinary: Type III (200)   
Protected Non-Combustible: Type II (222), (111)  Heavy Timber: Type IV (2HH)   
Unprotected Non-Combustible: Type II (000)  Protected Wood Frame: Type V (111)   
Protected Ordinary: Type III (211)  Unprotected Wood Frame: Type V (000)

### Addresses

Owner's Name: James Grottel Telephone: 207-878-5910 Fax: 207-878-0335  
Mailing Address: 512 Warren Ave Zip Code: 04103  
Town: Portland State: Maine  
Design Professional: Curtis Walter Stewart Telephone: 207-774-4441 Fax: 207-774-4016  
(Concept + Sketch)  
Maine Registration Number: N/A E-mail: \_\_\_\_\_  
Mailing Address: 434 Cumberland Ave Zip Code: 04101  
Town: Portland State: Maine  
General Contractor: Wes Meyer Construction Inc Telephone: 1-207-655-8630 Fax: \_\_\_\_\_  
Mailing Address: Po Box 2213 Zip Code: 04052  
Town: Windham State: Maine

Signature of Applicant: [Signature] - Principal

Preliminary Approval:  Date: \_\_\_\_\_ Approved By: \_\_\_\_\_  
Construction Permit:  Date: 10/24/03 Approved By: [Signature]  
Approval Letter:  Date: \_\_\_\_\_ Approved By: \_\_\_\_\_  
When a permit is not required

LOG #	DATE PLANS RECEIVED	REVIEW FEE	DATE FEE RECEIVED	CHECK #	PLAN REVIEWER	DATE PERMIT ISSUED	PERMIT #
	<u>10/24/03</u>	<u>75.00</u>	<u>10/24/03</u>	<u>1022</u>	<u>R.M</u>		



# Application for Barrier-Free Permit

Department of Public Safety  
Licensing & Inspections  
164 State House Station  
Augusta, Maine 04333-0164

Tel: 207-624-8744 x 1  
Fax: 207-624-8767



Project Name: Turf's Sports Pub  
Street Location: 512 Warren Ave Town Location: Portland  
County: Cumberland State: Maine Zip Code: 04103

New Building:  Renovation:  Change of Use:

Project Cost: \$30,000 Fee (fee schedule is on back): \$9.00

Design Professional's Name: Curtis Walter Stewart  
(Concrete Sketch)  
Mailing Address: 434 Cumberland Ave  
Town: Portland State: Maine Zip Code: 04101  
Maine Registration Number: NIA  
Design Professional's Signature: NIA Date: \_\_\_\_\_

Approved for Permit:  Date: 10/24/03 Plan Reviewer: [Signature]

Comments:

LOG #	DATE PLANS RECEIVED	REVIEW FEE	DATE FEE RECEIVED	CHECK #	PLAN REVIEWER	DATE PERMIT ISSUED	PERMIT #
	10/24/03	25.00	10/24/03	1022	R.M		

RE-ARRANGED DINING - (PLAN)

PROG

1/8" = 1' FOOT

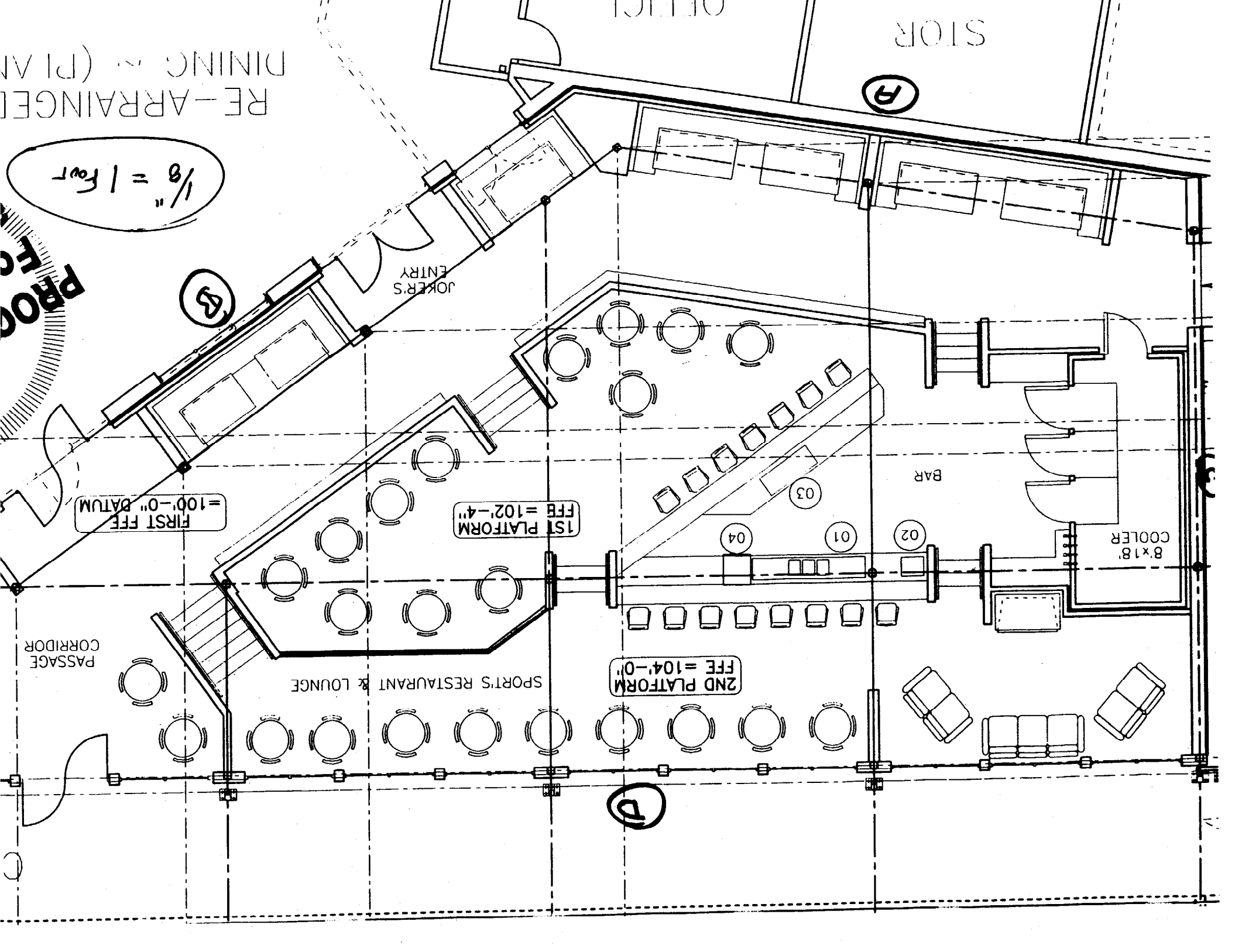

PASSAGE CORRIDOR

SPORTS RESTAURANT & LOUNGE

JOCKEY'S ENTRY

BAR

8'x18' COOLER

FIRST FFB = 100'-0" DATUM

1ST PLATFORM FFB = 102'-4"

2ND PLATFORM FFB = 104'-0"

(A)

(B)

(A)

(04)

(01)

(02)

(03)

STOR

OFFICE

*CHAIR LIFT*



**All-Ways Accessible, Inc.**  
128 Hall Street, Suite F, Concord, NH 03301  
1-800-72-LIFTS (725-4387)  
(603) 224-9875 FAX  
[www.all-waysaccessible.com](http://www.all-waysaccessible.com)

### Fax Cover Sheet

<b>TO:</b>	<b>BILL LATVIS</b>
<b>ORGANIZATION:</b>	<b>JOKERS</b>
<b>FAX NUMBER:</b>	<b>207-878-0335</b>
<b>DATE:</b>	<b>October 13, 2003</b>
<b>FROM:</b>	<b>Jeff Lavoie</b>
<b>SUBJECT:</b>	<b>Proposal for Vertical Wheelchair Lift</b>
<b># OF PAGES (Including this one):</b>	<b>five pages</b>

Bill,

Please find to follow the proposal for the vertical wheelchair lift for Jokers. After reviewing if you have any questions or require additional information please give me a call at 1-800-725-4387, Ext 102. The original proposal will follow in the mail tomorrow.

Thank you, I look forward to hearing back from you.

Jeff Lavoie  
Accessibility Specialist

Residential Elevators • Wheelchair Lifts • LULA Elevators • Stairway Lifts  
Personal Transfer Lifts • Bath Tub Lifts • Ramps  
*"Your Accessibility Solution Provider"*



All-ways Accessible, Inc.  
128 Holl Street, Suite F, Concord, NH 03301  
1-800-72-LIFTS (725-4387)  
603-224-9875 FAX  
www.all-waysaccessible.com

# PROPOSAL

Prepared for: Bill Latvia  
Jokers  
510 Warren Avenue  
Portland ME 04103

Equipment is for: Same  
Date: 10/13/03 Doc #: 0310130400JL  
Project: Install vertical wheelchair lift at restaurant bar  
Installed at: Same  
Job Code: VWNC VWL/New/Comm  
Rep ID: JNL

### 1) Job Summary:

All-Ways Accessible proposes to supply and install a wheelchair lift as indicated on the addendum A of this proposal. This lift will be installed on the right side of the bar next to the stairs and installed by licensed elevator mechanics. This proposal includes the permits required by the State of ME, all local and other permits by others. Work to be included by others includes: emergency lighting, preparations to upper landing for acceptance of upper landing gate and finish work to railing, installation of 110vac, 20amp electrical line with lockable fused disconnect.

### 2) Detail of Make, Model and Materials:

Addendum A

### 3) Drawings, Specifications and/or Layout Sketches:

Addendum B

### 4) Proposal Amount:

Proposal:	Sales Tax:	Total Proposal:
\$ 8,632.00	\$ 324.10	\$ 8,956.10

### 5) Payment Terms:

50/40/10  
30% deposit, 40% upon substantial completion, 10% upon inspection and turn over. \*Please see Terms & Conditions of reverse side.

Proposal Prepared by:

Jeff Lavole  
Accessibility Specialist

Proposal Accepted by:

I have read and understand the Terms & Conditions of this agreement.

Signature \_\_\_\_\_

Date \_\_\_\_\_

Please Print Name \_\_\_\_\_

Title \_\_\_\_\_

Please see Terms & Conditions on reverse side



*Terms & Conditions*

- 1) Quoted price includes installation by qualified and licensed technicians during normal business hours. Any work performed outside normal business hours will be subject to additional charges.
- 2) All equipment is custom built for each application. Once the authorization is given to order equipment, the product is not returnable, and neither are any deposits on account.
- 3) Customer will be notified when the equipment has been ordered and will be provided with an estimated arrival date. If the customer is responsible for any site work, then the customer must take steps to ensure that the site is ready for installation upon arrival of the equipment. If the site is not ready for installation when the equipment arrives, then the equipment will be delivered and stored at the customer's site. In accordance with the payment terms, 40% of the balance will be due at that time. If the site is not ready for installation and the customer can not take delivery of the equipment, then the 40% installment would be due and a storage fee of \$99.00 per week would be added to the total cost of the proposal.
- 4) All materials and work to be provided are specified in the Addendum A & B portion of this agreement. Any alteration or deviation from those specifications will be executed only upon written orders and are subject to additional charges above and beyond the original proposal amount.
- 5) All work is to be completed in a workman like manner in accordance with local and national codes.
- 6) This agreement will be governed by New Hampshire law and the parties agree that the appropriate forum for the resolution of disputes to be a court of appropriate jurisdiction in the State of New Hampshire
- 7) This agreement represents the sole and complete understanding of the parties and there are not other agreements or understandings prior to or contemporaneous with this one which do not include within the terms of this agreement. In the event All-Ways Accessible, Inc. attempts to collect the funds due under this contract, they shall be entitled to the costs of collection, including, but not limited to, reasonable attorneys fees.
- 8) All-Ways Accessible, Inc. can not be held responsible for concealed issues. Additional charges may apply if a concealed issue presents itself during the installation of any equipment.
- 9) This proposal is valid for 30 days.
- 10) Insurance certificates can be provided upon request
- 11) Bonds are not included in this proposal.
- 12) A sales tax of 5% is due on all products sold in the state of Maine or Vermont. Sales tax can only be excused when an exception certificate has been provided by the customer.

<b>National Wheel-O-Vator Brand Products</b>			
<b>CUSTOMER:</b>	BN Latvia - Jokers		
<b>JOB:</b>	Vertical Wheelchair Lift		
<b>STATE:</b>	Maine		
<b>DATE:</b>	10/13/2003		
<b>REP ID:</b>	JNL		
<b>Addendum:</b>	A		
<b>Proposal #</b>	0310130400JL		
<b>ITEM</b>	<b>DESCRIPTION</b>	<b>QTY</b>	<b>UNIT</b>
	<b>SCREW DRIVE LIFTS</b>		
	Models RE, BC, CDE and PCDE use a 115vac powered Acme Screw Drive. Auto lubrication (lift nut) is standard on all models except the RE. Lift capacity is 750 lbs. (700 lbs. on RE), with operating speed of 9 fpm and the Simplex base and carriage. Outdoor units are equipped with aluminum tubing in platform side guards, enclosure walls and gates/doors.		
	<b>Unenclosed Lift (Model BC)</b>		
BCI-80	Standard features include a keyed up/down control with emergency stop on the car, 750 lbs. of capacity, 63" of lifting height, an under platform sensing device (safety pan) if unit is not to be installed in a hoistway and a stationary or flip up ramp if unit is not pitted. Other options must be added to fully comply with A17.1/A18.1 and ADAAG requirements	1	EA
	<b>DOOR / GATE / LOCK OPTIONS</b>		
	Standard 42" Landing Gate	1	EA
	Standard 42" Platform Gate	1	EA
	<b>OTHER OPTIONS</b>		
	Public building package for BC/MBC model units (includes 2 call/sends, grab rail and DC alarm control)	1	EA
	<b>Installation</b>		
Labor	Installation of lift by licensed mechanics	1	EA
	<b>Permits</b>		
ME Permit	Permit Fee	1	EA
	<b>WARRANTY</b>		
	Labor Warranty - 1 year	1	EA
	Manufacturer's Warranty - 1 year, 2 years on drive train	1	EA
	<b>WORK TO BE DONE BY OTHERS:</b>		
	All site preparation	1	
	Electrical requirements	1	
	Concrete work	1	
	Blocking	1	
	Emergency lighting	1	

ADDENDUM B

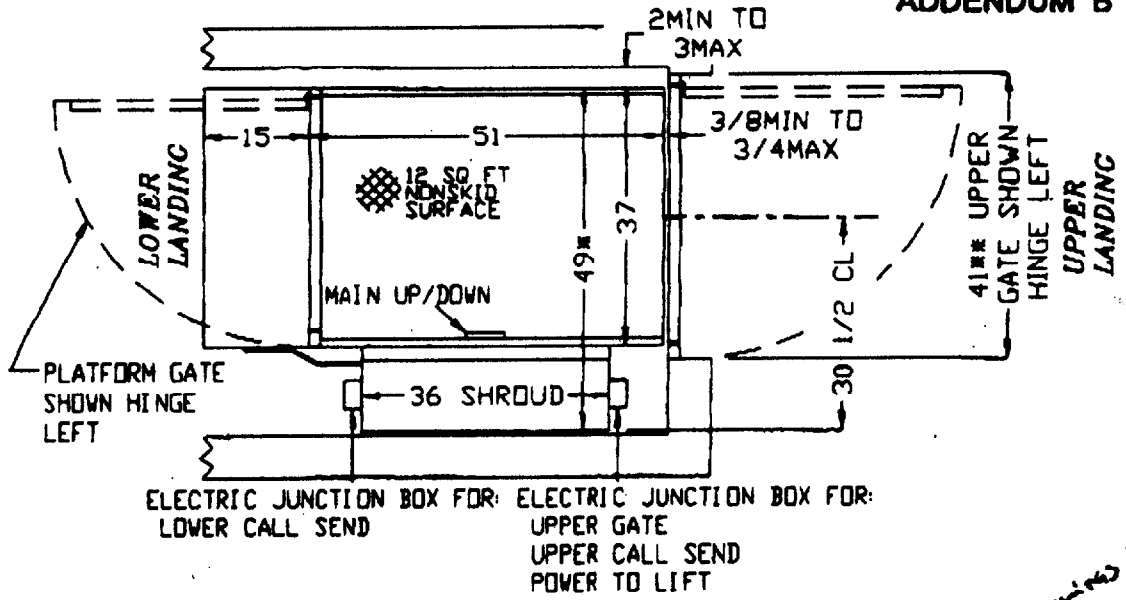

PLAN VIEW

*Sample Job specific Drawings to Follow*

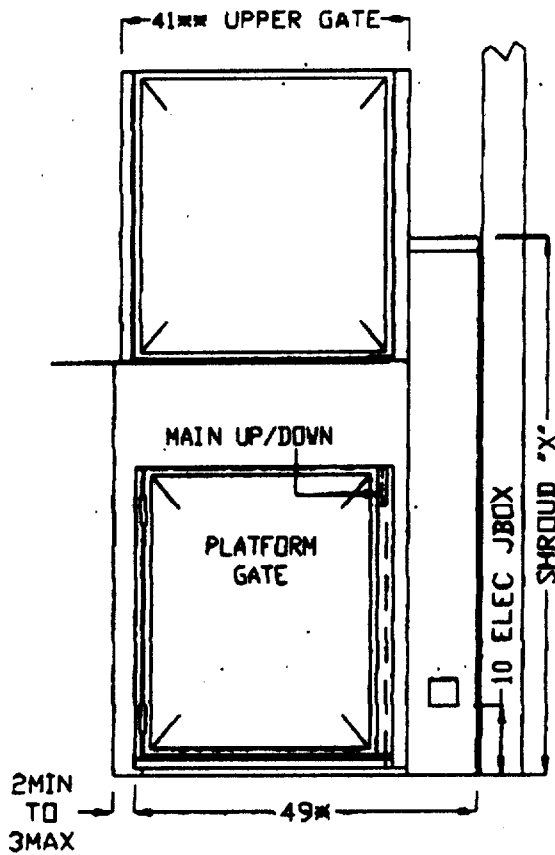

FRONT VIEW

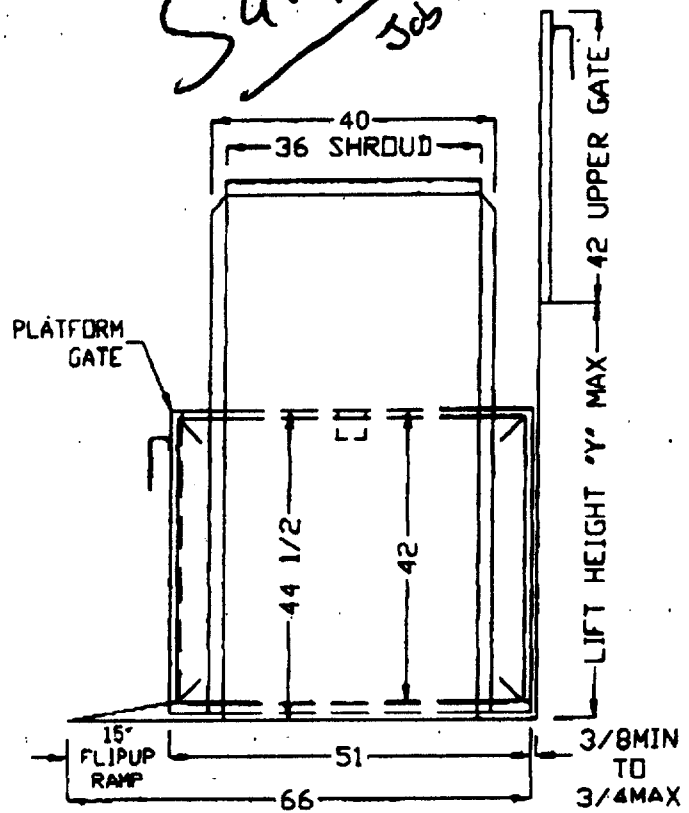

SIDE VIEW

MODEL	X'IN.	Y'IN.	MODEL	X'IN.	Y'IN.	DIMENSIONS SUBJECT TO CHANGE WITHOUT NOTIFICATION.	
BC-42	60	42	BC-108	130	111	NATIONAL WHEEL-O-VATOR	
BC-60	78	60	BC-120	142	123	SEPTEMBER 1998	
BC-72	90	72	BC-144	171	147	MODEL: BC SHROUD RIGHT	
BC-96	118	99				C-1070	

WHEN TOP CAP SPACERS ARE USED, PLEASE ALLOW AN EXTRA 1/2" ON THE 3 DIMENSION.

UPPER GATE DIMENSION, PLEASE ALLOW 1/4"-1/2" IN. FOR SWAGING OF GATE.

ALLOWABLE VARIATION ON ALL DIMENSIONS IS PLUS OR MINUS .12" UNLESS OTHERWISE SPECIFIED.

STAIR + RAILING  
DETAIL

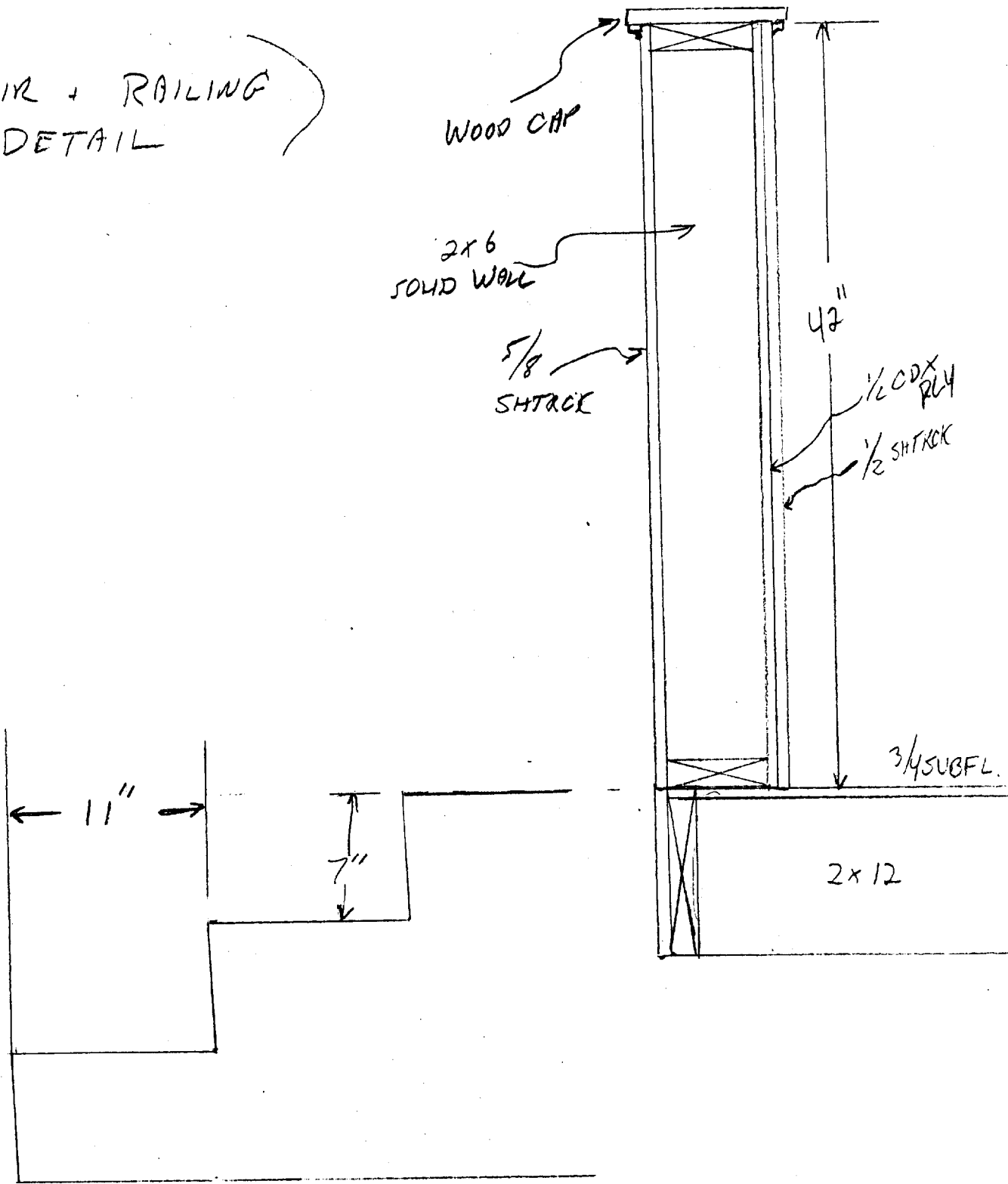

SCALE - 1/8" = 1"

JURF'S BAR

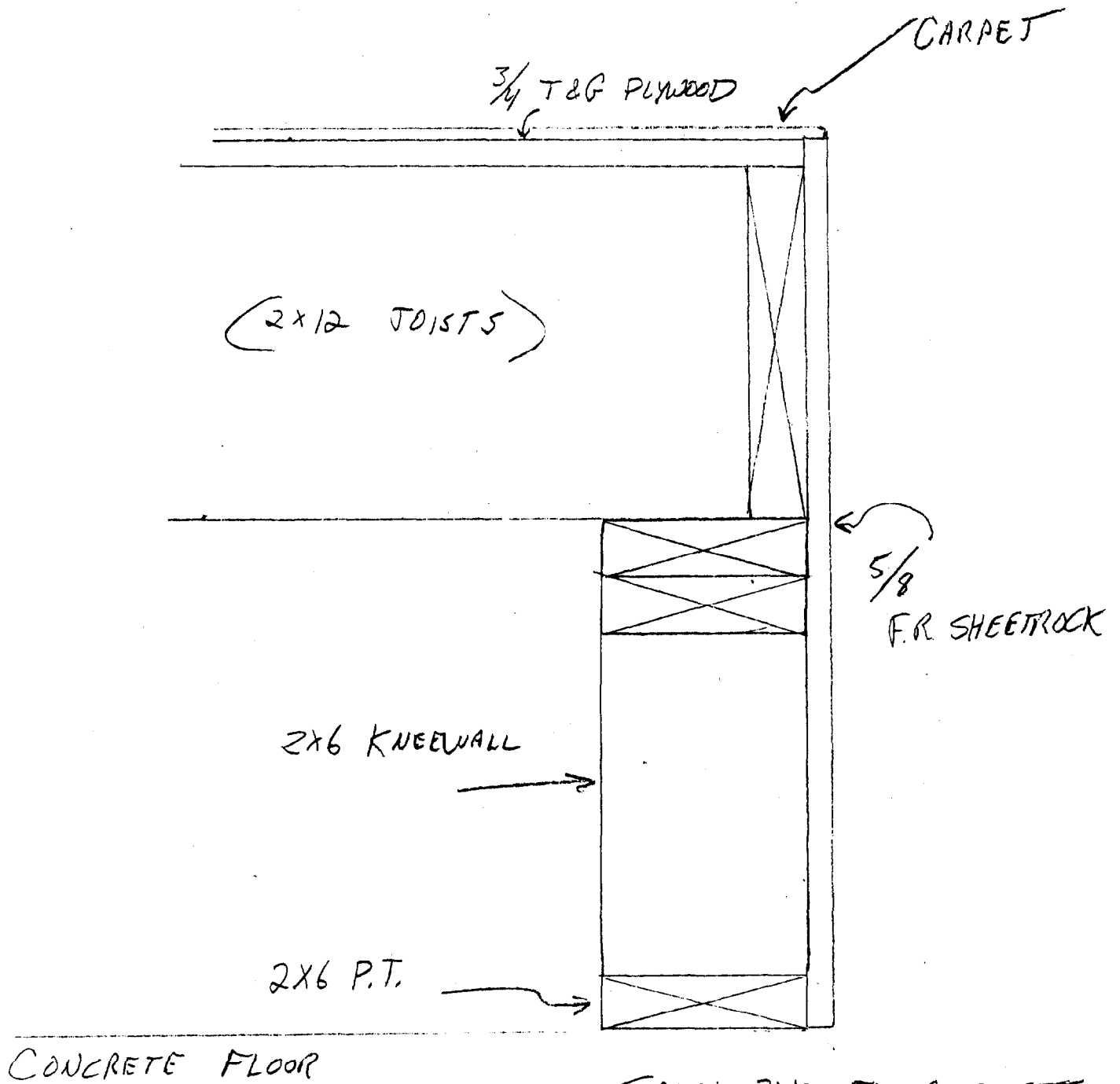

SPEC: 2x12 FLOOR JOISTS  
 AT 16" O.C., 10' SPAN  
 MEETS THE RESTAURANT  
 LOUNGE CODE OF  
 100 PSF.

(TURF'S BAR)

SCALE: 1/4" = 1"