

Consultant:

Richard Melling, PE
MEP DESIGN CONSULTANT
8824 Gotherstone Ct.
Raleigh, NC 27615
email: rmelling@mellingengineering.com

Revision:

Engineer of Record:

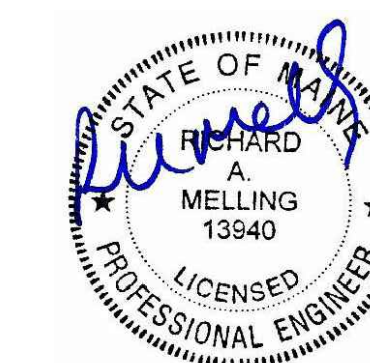

11/25/15

Drawn: RM

Checked: RM

Scale: 1/4" = 1'-0"

Key Plan:

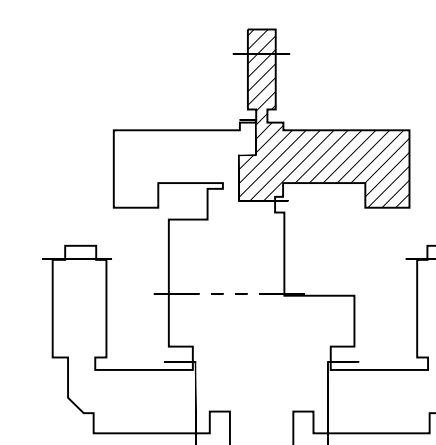

Project Name:

LORING HOUSE

1125 Brighton Avenue
Portland, ME 04102

Sheet Name:

**Part Plan E
Third Floor**

Project Number:

14165

Issue Date:

October 19, 2015

Sheet Number:

M2.03e

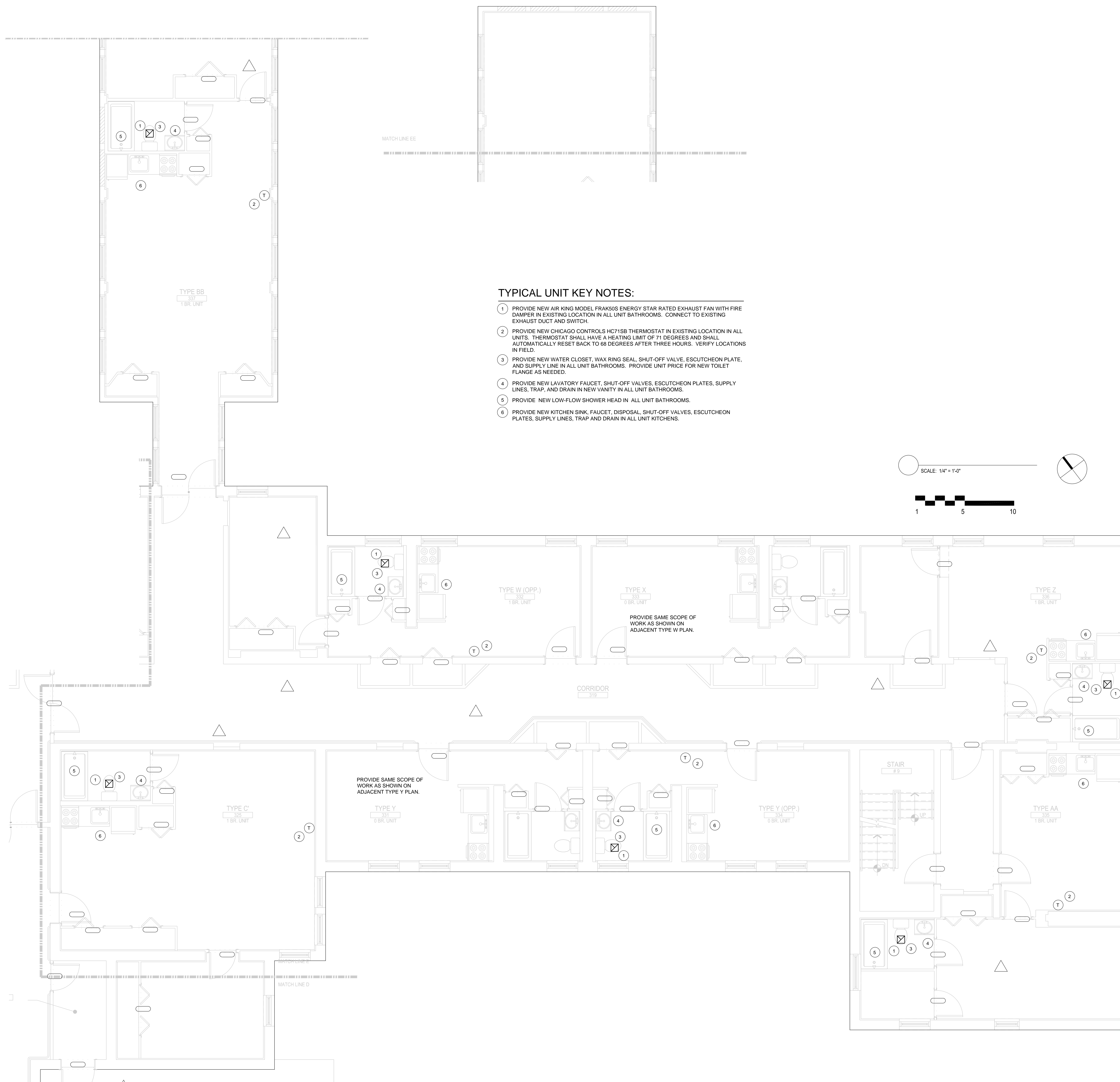

TYPICAL UNIT KEY NOTES:

- 1 PROVIDE NEW AIR KING MODEL FRAK50S ENERGY STAR RATED EXHAUST FAN WITH FIRE DAMPER IN EXISTING LOCATION IN ALL UNIT BATHROOMS. CONNECT TO EXISTING EXHAUST DUCT AND SWITCH.
- 2 PROVIDE NEW CHICAGO CONTROLS HC71SB THERMOSTAT IN EXISTING LOCATION IN ALL UNITS. THERMOSTAT SHALL HAVE A HEATING LIMIT OF 71 DEGREES AND SHALL AUTOMATICALLY RESET BACK TO 68 DEGREES AFTER THREE HOURS. VERIFY LOCATIONS IN FIELD.
- 3 PROVIDE NEW WATER CLOSET, WAX RING SEAL, SHUT-OFF VALVE, ESCUTCHEON PLATE, AND SUPPLY LINE IN ALL UNIT BATHROOMS. PROVIDE UNIT PRICE FOR NEW TOILET FLANGE AS NEEDED.
- 4 PROVIDE NEW LAVATORY FAUCET, SHUT-OFF VALVES, ESCUTCHEON PLATES, SUPPLY LINES, TRAP, AND DRAIN IN NEW VANITY IN ALL UNIT BATHROOMS.
- 5 PROVIDE NEW LOW-FLOW SHOWER HEAD IN ALL UNIT BATHROOMS.
- 6 PROVIDE NEW KITCHEN SINK, FAUCET, DISPOSAL, SHUT-OFF VALVES, ESCUTCHEON PLATES, SUPPLY LINES, TRAP AND DRAIN IN ALL UNIT KITCHENS.